



PROFESSIONAL UHF DUAL-CHANNEL WIRELESS
MICROPHONE SYSTEM WITH SELECTABLE FREQUENCIES

SWM26-U2 SERIES

- SWM26-U2HH
- SWM26-U2HL
- SWM26-U2LL



FEATURES

- This Ultra-High Frequency (UHF) microphone system minimizes radio frequency interference and noises generated by other electronic equipment and digital devices, compared with a Very High Frequency (VHF) system. The wireless system provides cordless freedom and ease of use.
- Easy to set up and operate with dual channels and 200 selectable UHF frequencies and independent volume controls.
- Quartz crystal oscillation stabilizes frequency transmitting and receiving with two detachable antennas, making sure the sound quality is reliable and consistent.
- Audio compressing-expanding technology can minimize noises and boost dynamic range. The cardioid microphone pickup pattern produces superb feedback and off-axis rejection.
- Up to 200 feet line-of-sight operation range with stellar sound quality.
- Ideal for conferences, broadcasting, wedding, karaoke, social event and any small to medium-sized venues including meeting rooms, auditoriums, schools, churches and stage.

How can we help you?

CONTACT OUR US-BASED SUPPORT TEAM

Simple or complex, your questions are important to us. For service, support or more information, please contact the Sound Town support team:

Email: support@soundtown.com

RECEIVER

Front Panel

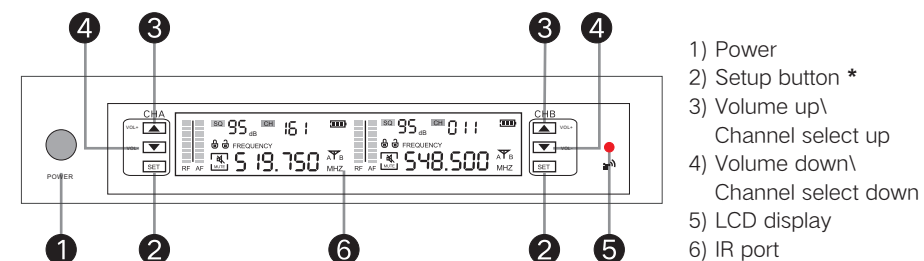

* Long pressing the set button will lock or unlock the system setting. Please make sure the system is unlocked when adjusting system volume or channel frequencies. The lock and unlock icons will show and change accordingly on the receiver when you long press the set button.

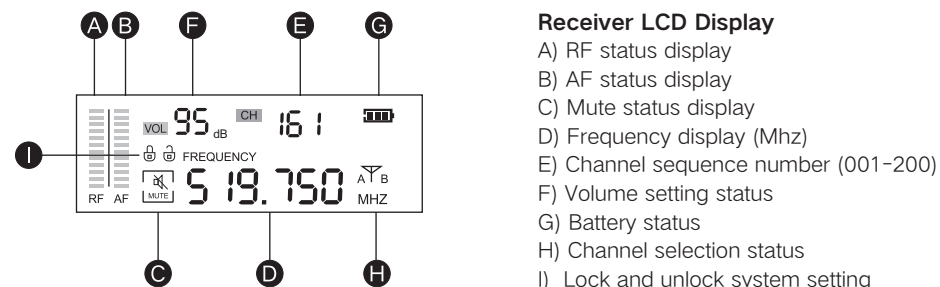

Rear Panel

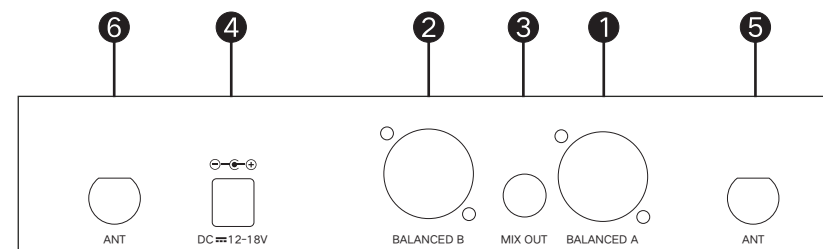

TRANSMITTER

Handheld Microphone

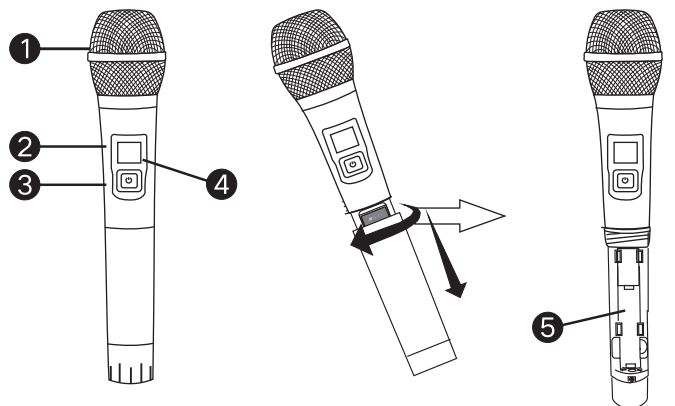

- 1) Windscreen and pop filter
- 2) LCD display
- 3) Power switch
- 4) Infrared receiving window
- 5) Battery compartment

Microphone LCD Display

- 1) Channel frequency
- 2) Battery level

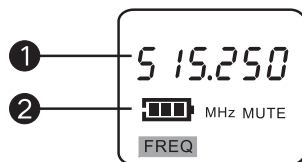

How to Replace Batteries

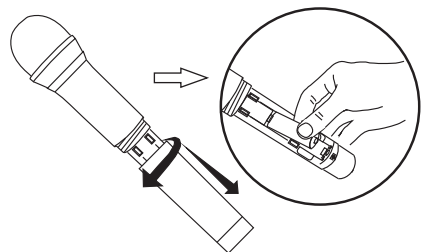

Two alkaline AA batteries usually last for 8 hours. When the battery level displays , please replace the batteries immediately. Unscrew the battery cover and insert two AA alkaline batteries into the compartment. Please make sure the positive and negative ends are facing the right directions.

Bodypack Transmitter

- 1) Antenna
- 2) Mini-XLR input
- 3) Power switch (ON/OFF)
- 4) Power indicator
- 5) LCD display
- 6) IR port
- 7) Battery tray
- 8) Battery cover
- 9) Pick-up head

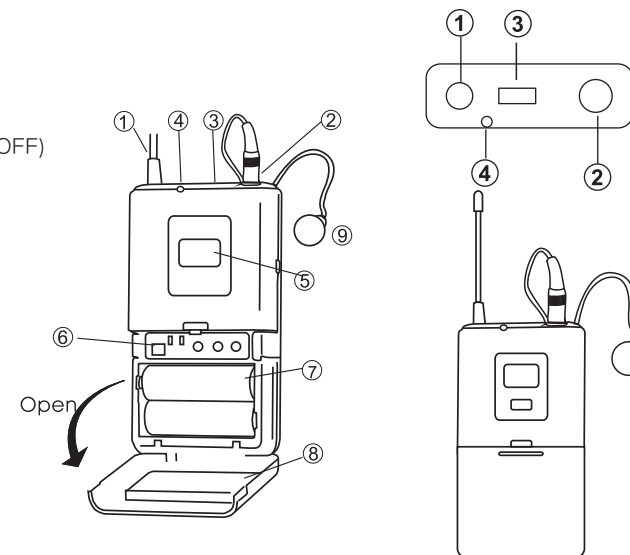

Replace The Batteries

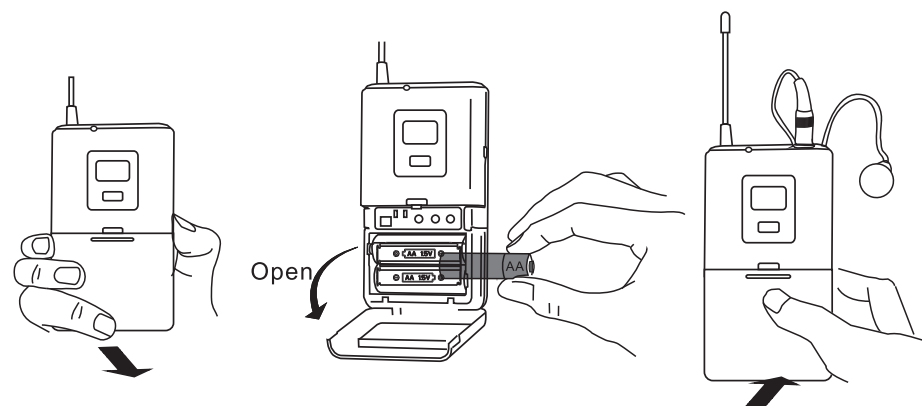

- 1. Open the battery cover
- 2. Insert two alkaline AA batteries and please make sure the positive and negative ends are facing the right direction.
- 3. Close the battery cover.

OPERATION

Operation

Quick Setup Guide

1. Connect the SWM26 receiver to an AC outlet through the power adapter provided.
2. Connect the SWM26 receiver to a powered speaker or an amplifier with the 1/4" audio cable provided.
Turn on the SWM26 receiver. (If you are connecting the receiver to a passive speaker, mixer, home receiver or television, please refer to the connection diagram section).
3. Insert two alkaline AA batteries into the battery compartment of the microphone. Make sure the positive and negative ends are facing the correct direction. Power on the microphone.

How to Select or Adjust Receiver Frequency

*Note: Please make sure the system is unlocked before adjusting system frequency. Long pressing the set button will lock or unlock system settings and the lock or unlock icon will display accordingly on the screen.

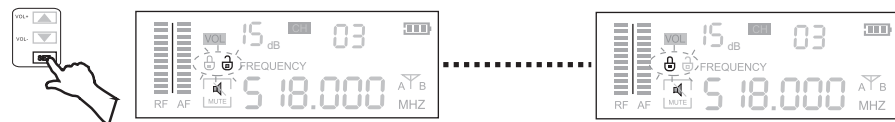

1. Automatic Frequency/Channel Selection: Press and hold "DOWN ▼" until "SEARCH" displays. Then the best frequency will be selected.

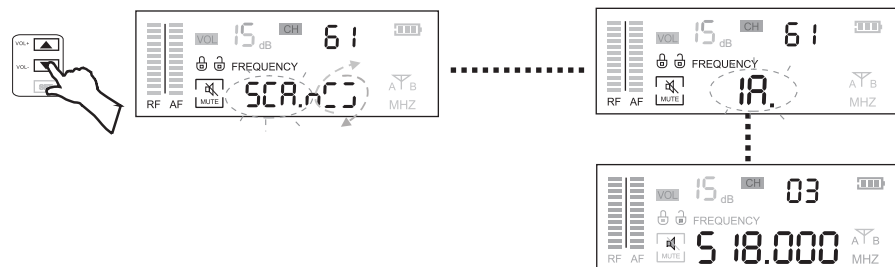

2. Manual Frequency/Channel Selection: Press and hold "UP ▲" on the receiver until the channel blinks.



While the channel is blinking, press "UP ▲" or "DOWN ▼" to select the desired channel. Then press "SET" to confirm the channel.

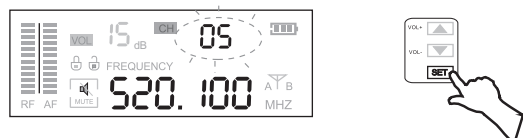

Synchronize Frequency between Receiver and Microphone

1. Point the Infrared Receiving Window (IR port) of the microphone towards the receiver's IR port.

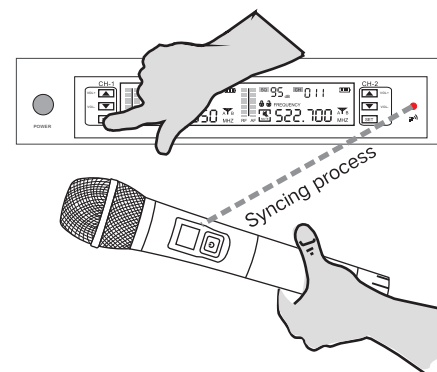

NOTE Please make sure that the other handheld microphone is powered off when adjusting the frequency on one microphone.

Please adjust the receiver to a different frequency shall you encounter interference. Please refer to the section above on how to adjust receiver frequency.

2. Press the "SET" button and "IR - - -" will display on the LCD screen. Once syncing is completed, the "RF" level bar appears and the "MUTE" icon disappears.

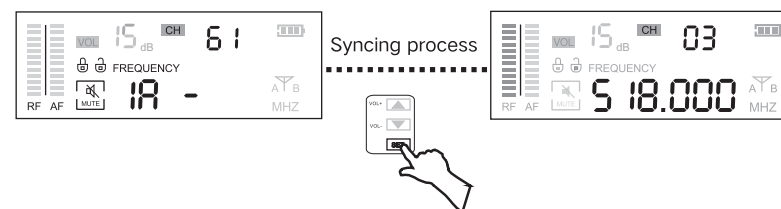

How to adjust the volume on the receiver

*Note: Please make sure the system is unlocked before adjusting system volume. Long pressing the set button will lock or unlock system settings and the lock or unlock icon will display accordingly on the screen.

Short press the "UP ▲" to increase the volume or short press the "DOWN ▼" to reduce the volume.

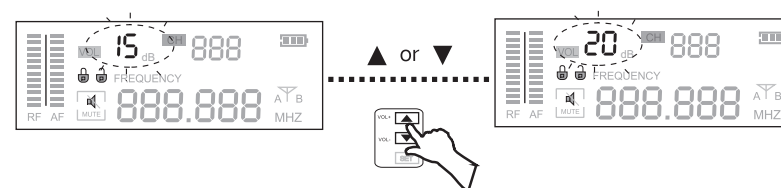

CONNECTION DIAGRAM

Connection Diagram

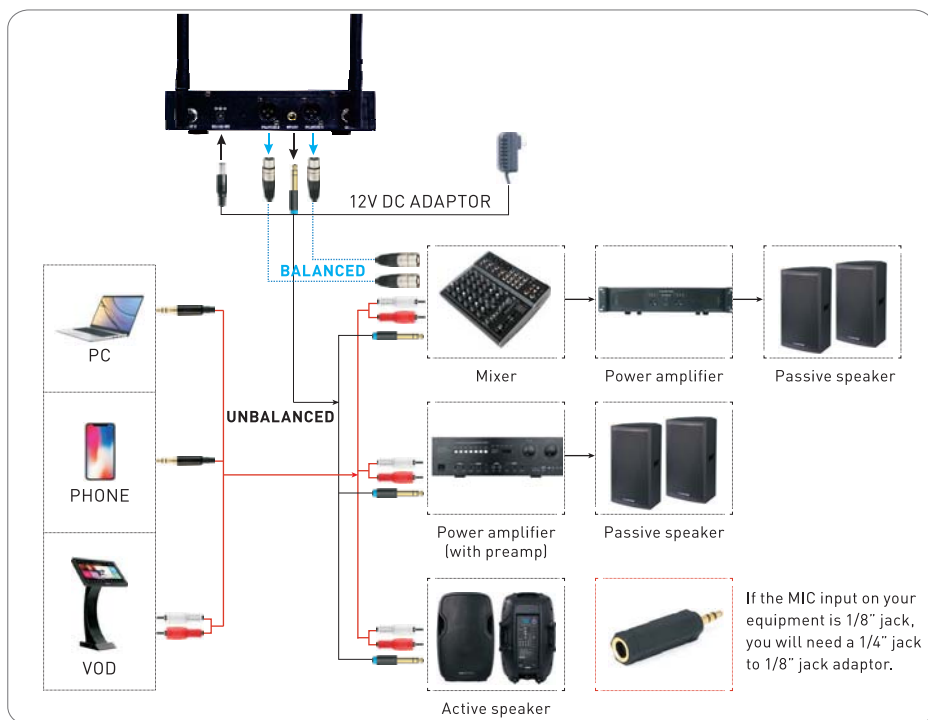

Note:

It is advised to check the input connectors of your device before connecting the wireless microphone to it. Most PA speakers come with 1/4" Mic input connectors and amplifiers come with XLR input connectors, they are capable of directly connecting to microphones.

For devices such as certain home receivers that do not come with 1/4" Mic or XLR input connectors, a preamp or mixer is recommended to optimize sound performance when connecting the microphone to a home receiver. Preamps and mixers act as an intermediary between the receiver and the microphone. They can increase the volume level on the microphone and mitigate the volume loss that occurs by connecting your microphone to your home receiver.

In the case a TV is used as sound source, we recommend considering the Sound Town SWM15-PRO wireless karaoke microphone and mixer instead. It has better compatibility with most smart televisions with HDMI ARC (Audio Return Channel) and media streaming devices. For more information, please visit Sound Town at www.soundtown.com

PARAMETER

Specifications

Frequency Range	UHF 510-560 Mhz, 200 Selectable Frequencies
Oscillation Mode	Quartz Controlled
Modulation Method	$\pi/4$ -DQPSK
Sampling Ratio	48KHz
Transmission Rate	204.8Kbps
Dynamic Range	>90dB
Total Harmonic Distortion	<0.1%
Delay Time of Audio Transmission	<3ms
S/N Ratio	>96dB
Frequency Response	30-20KHz
Working Distance	200 Feet
Power Supply	DC 12~18V / 0.35A
Max. Output Level	Balanced: 0~400mv, Unbalanced: 0~200mv
Display	LCD
Output Connector	Balanced XLR Outputs, 1/4" mix out
Unique ID Address	Yes
Dimensions (inch)	8.7 x 7.3 x 1.8
Weights (lbs)	1.6

Transmitter

Transmitter Power	15mW
Spurious Emission	<40dB(with carrier)
Display	LCD
Battery Voltage	1.5V X 2 (2 X AA)
Battery Life	8 hours

TROUBLE SHOOTING

Trouble Shooting

Faint Sound or No Sound

- Verify connections to PA system
- Adjust channel volume
- Turn on handheld microphone or bodypack
- Check that batteries are installed correctly.
- Change or charge batteries
- Verify power adapter is plugged securely into the outlet
- Check that receiver unit is powered on
- Verify that antennas are connected securely

Audio Interference, Artifacts, or Dropouts

- Identify and remove sources of interference: mobile phones, Wi-Fi access points, signal processors, electronics, etc.
- Charge or change batteries
- Move system away from metallic surfaces
- Provide line-of-sight from handheld microphone or bodypack to receiver unit antennas

Distortion

- Lower channel volume
- Change or charge batteries
- Verify fidelity of signal cable to PA

In the Package

SWM26-U2HH

- 1 SWM26-U2 receiver
- 2 Handheld wireless microphones

SWM26-U2LL

- 1 SWM26-U2 receiver
- 2 Lavalier microphones
- 2 Bodypack transmitters

SWM26-U2HL

- 1 SWM26-U2 receiver
- 1 Handheld wireless microphone
- 1 Lavalier microphone
- 1 Bodypack transmitter

How can we help you?

CONTACT OUR US-BASED SUPPORT TEAM

Simple or complex, your questions are important to us. For service, support

or more information, please contact the Sound Town support team:

Email: support@soundtown.com