

## SDRK-CR11&SDRK-CR11B ASSEMBLY INSTRUCTIONS

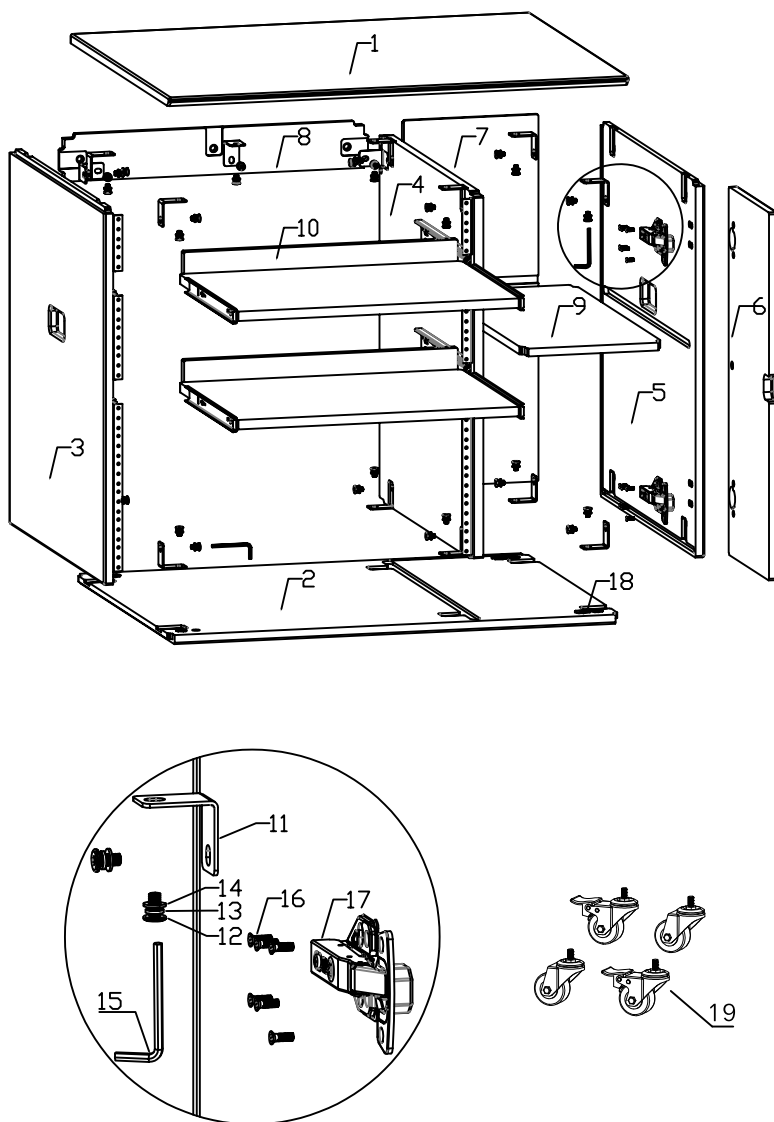

- |                                 |         |
|---------------------------------|---------|
| 1. Top Board                    | (1pc)   |
| 2. Bottom Board                 | (1pc)   |
| 3. Left Board                   | (1pc)   |
| 4. Middle Board                 | (1pc)   |
| 5. Right Board                  | (1pc)   |
| 6. Front Door                   | (1pc)   |
| 7. Back Board                   | (1pc)   |
| 8. Top Back Board               | (1pc)   |
| 9. Dummy Board                  | (1pc)   |
| 10. Slide-Out Tray              | (2pcs)  |
| 11. "L"Type Hinge               | (15pcs) |
| 12. Hexagon Screw               | (30pcs) |
| 13. Spring Washer               | (30pcs) |
| 14. Flat Washer                 | (30pcs) |
| 15. Hex Head Screw Driver       | (1pc)   |
| 16. Phillips Screw              | (12pcs) |
| 17. Door Hinge                  | (2pcs)  |
| 18. M10 Screw Catch For Casters |         |
| 19. 2" Casters                  | (4pcs)  |

## How can we help you?

CONTACT OUR US-BASED SUPPORT TEAM

Simple or complex, your questions are important to us. For service, support or more information, please contact the Sound Town support team:

Email: [support@soundtown.com](mailto:support@soundtown.com)



soundtown website