

KALE

TWO-WAY POWERED LOUDSPEAKER
BLUETOOTH ENABLED

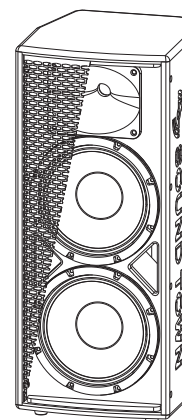

KALE-208BPW
KALE-208WPW

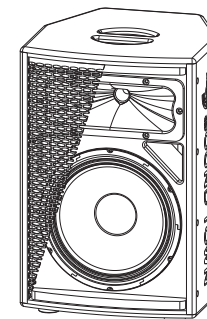

KALE-110BPW
KALE-110WPW

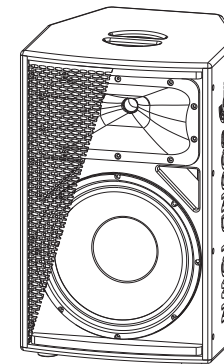

KALE-112BPW
KALE-112WPW

IMPORTANT SAFETY INSTRUCTIONS

1. Read all safety and operating instructions before using this product.
2. All safety and operating instructions should be kept for future reference.
3. Read and understand all warnings listed on the operating instructions.
4. Follow all operating instructions to operate this product.
5. This product should not be used near water, i.e. Bath tub, sink, swimming pool, web basement etc.
6. Only use dry cloth to clean this product.
7. Do not block any ventilation openings, it should not be placed flat against a wall or placed in a built-in enclosure that will impede the flow of cooling air.
8. Do not install this product near any heat sources, such as, radiators, heat registers, stove or other apparatus (including heat producing amplifiers) that produce heat.
9. Do not defeat the safety purpose of the polarized or grounding-type plug. A polarized plug has two blades with one wider than the other. A grounding-type plug has two blades and a third grounding prong. The side blade or the third prong are provided for your safety if the provided plug does not fit into your outlet, consult an electrician for replacement of the obsolete outlet.
10. Protect the power cord being walked on or pinched particularly at Plugs, convenience receptacles and the point where they exit from the apparatus. Do not break the ground pin of the power supply cord.
11. Only use attachments specified by the manufacturer.
12. Use only the cart, stand, tripod, bracket, or table specified by the manufacturer or sold with the apparatus. When a cart is used use caution when moving cart/apparatus combination to avoid injury from tip-over.
13. Unplug this apparatus during lightning storms or when unused for long periods of time.
14. Care should be taken so that objects do not fall and liquids are not spilled into the unit through the ventilation ports or any other openings.
15. Refer all servicing to qualified service personnel. Servicing is required when the apparatus has been damaged in any way; such as, power-supply cord or plug is damaged, liquid has been spilled or objects have fallen into the apparatus, the apparatus has been exposed to rain or moisture, does not operate normally or has been dropped.
16. **WARNING:** To reduce the risk of fire or electric shock, do not expose this apparatus to rain or moisture.
17. When the MAINS plug, or an appliance coupler is used as the disconnect device, the disconnect device should remain readily operable.
18. Protective Ground Terminal: The apparatus shall be connected to an AC main socket with a protective earth ground connection.



FEATURES

- The SOUND TOWN KALE series powered sound system features wireless Bluetooth connectivity, and streams audio from your smart phone, tablet, or computer.
- A complete all-in-one solution provides the flexibility of a 3-channel mixer (with inputs for microphones, music instruments and line level devices) which allows you to start performing with one apparatus.
- A loop output for linking multiple speakers.
- A built-in high quality Class-D amplifier and customized driver provide stellar sound quality.
- The lightweight and compact design with recessed handles make it an excellent complement to any mobile speaker application.

In the package

- 1 KALE speaker
- 1 User Manual
- 1 Power cable
- 1 Warranty Card

Rear Panel Instruction

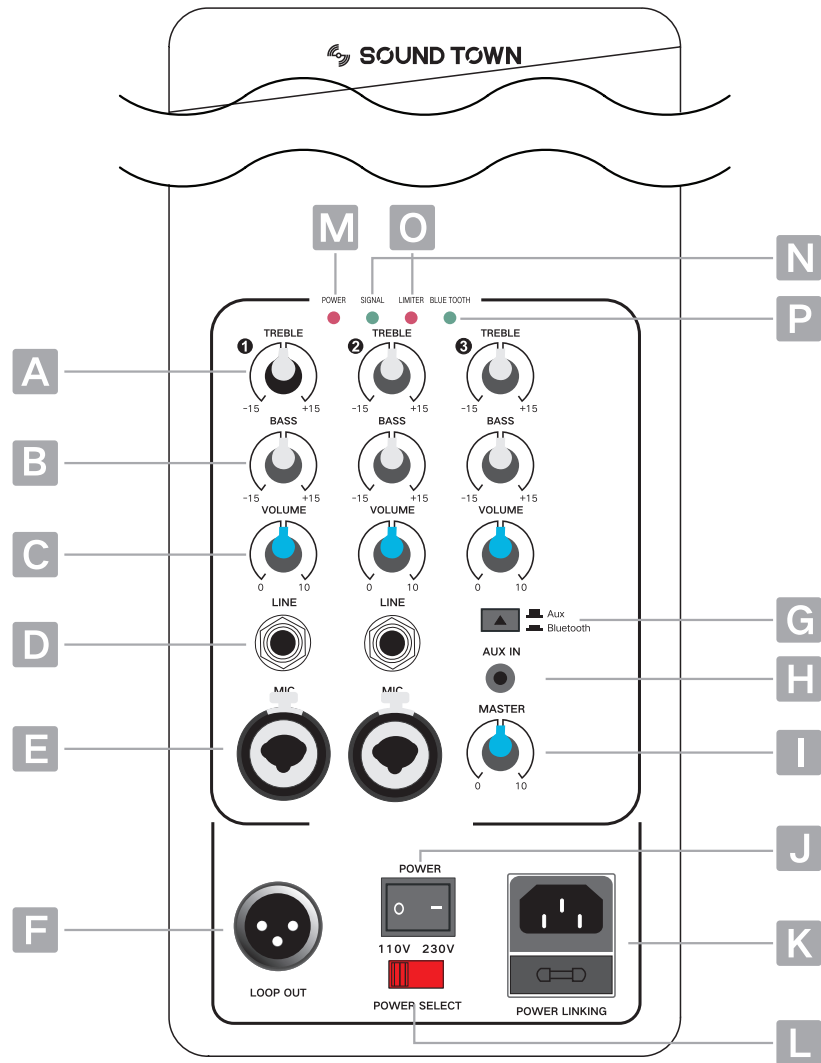

- A. **CHANNEL TREBLE CONTROL:** Treble frequency boost/cut; one for each of the three channels. Control is "flat" in center position (no effect on channel sound).
- B. **CHANNEL BASS CONTROL:** Bass frequency boost/cut; one for each of the three channels. Control is "flat" in center position (no effect on channel sound).
- C. **CAHNNEL VOLUME CONTROL:** Adjust volume of each channel relative to volume of other channels.
- D. **1/4" INPUT:** For connection of line-level input sources to channel one and two (left and center channels).
- E. **XLR MIC INPUT:** For connection of wired microphones to channel one and two (left and center channels).
- F. **LOOP OUTPUT:** XLR output for connection to additional KALE speakers or external subwoofer. Provides full-range signal for all three channels.
- G. **AUX/BT SWITCH:** For choosing the input way (Bluetooth or AUX) for channel three (right channel).
- H. **AUX INPUT:** Provides 3.5mm connection for auxiliary devices such as Mp3 players, computers and other line-level stereo sources.
- I. **MASTER VOLUME CONTROL:** Adjusts overall volume level of all three channels.
- J. **POWER SWITCH:** Turns unit on and off.
- K. **POWER CODE:** Connect to a grounded outlet in accordance with the voltage and frequency spec.
- L. **POWER SELECT:** For moving the unit from 115 voltage (US Standard) to 230 voltage (European Standard). The switch needs to be set on the proper voltage for your area.
- M. **POWER INDICATOR:** Illuminated when unit is on.
- N. **SIGNAL INDICATOR:** Flashing when there is signal input.
- O. **LIMITER INDICATOR:** Lights up when the amplifier is near clipping. An occasional flickering is acceptable. If LED is lit continuously adjust the Level control and reduce the output level of connected sources. Failure to do so may lead to premature failure of your speaker.
- P. **BLUETOOTH INDICATOR:** Flashing when pairing bluetooth, lit continuously after devices are paired. And flashing again when playing BLUETOOTH music source.

Operation

Bluetooth connection:

The KALE speakers come with built-in Bluetooth function and you can choose to pair the speaker with your Bluetooth enabled device.

1. Power on the speaker and press the BLUE TOOTH/AUX button (button "G" on rear panel feature) down, the speaker will become discoverable as **SOUNDTOWN**.
2. In the **settings** of your Bluetooth enabled device, set it to "**discover**". From the Bluetooth device list, select the "**SOUNDTOWN**" device.
3. The KALE speaker is now paired with your Bluetooth enabled device.

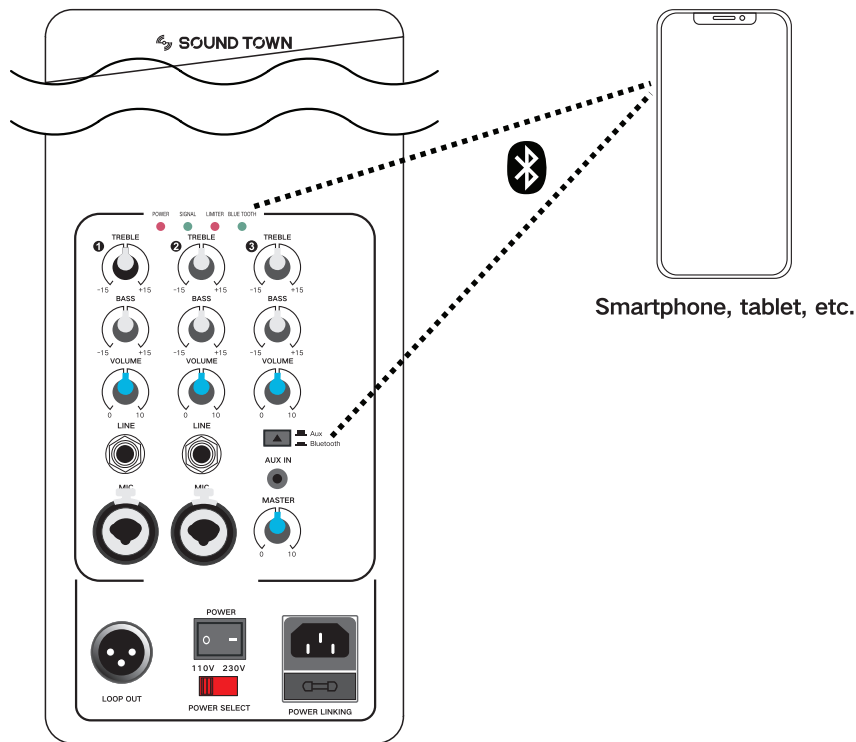

Connect with vocal microphone & guitar with active pickup:

1. Connect a dynamic microphone to the CH.1 Input using an XLR cable. We recommend using dynamic microphones with the KALE loudspeaker rather than condenser microphones. If you use a microphone that requires +48V of phantom power, you must connect it to an external phantom power supply. KALE does not supply any phantom power.
2. Connect a guitar with an active pickup to the CH.2 Input using a 6.35mm TS cable. We recommend using a guitar with active pickups rather than passive pickups. If you use a guitar with passive pickups, connect it to an external preamp or direct input (DJ) box.

