

## Outboard Motor Bracket Instructions

Note: Transom mounting hardware has not been supplied due to various transom depths.

### Mounting Instructions

#### Step 1

Measure the distance between the top of the mounting clamp to the bottom of the cavitation plate. Subtract 2" from this length.

Once you have determined the above length, add 10.5" to this length.

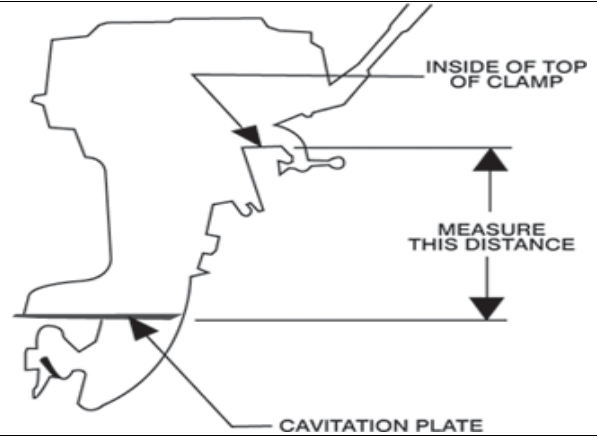

#### Step 2

Once you have determined the above length, mark this distance on a stick. Choose the best mounting position on your transom for the motor. Make sure to select a position that will not interfere with the turning of the motor.

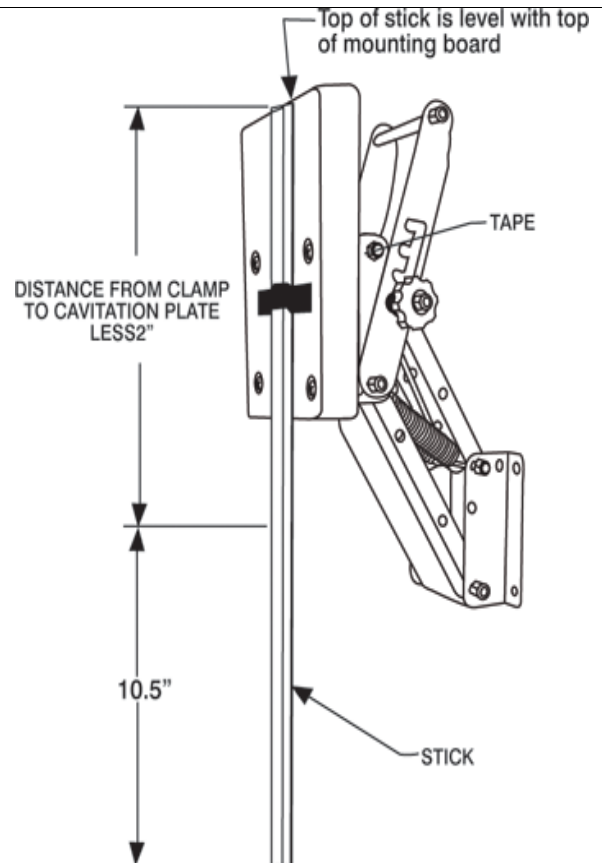

**Step 3**

Position your outboard motor bracket, with the stick taped on, so that the bottom of the stick is 1" above the bottom of your boat.

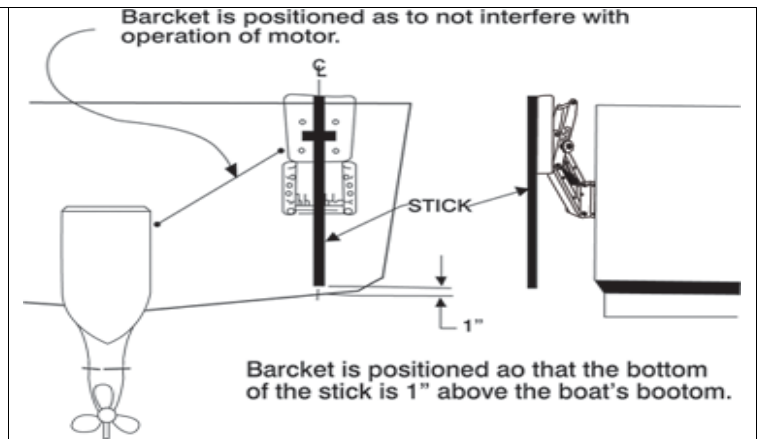
**Step 4**

With the outboard motor bracket positioned in the appropriate location, mark the four mounting holes as a template. Drill the four holes, making sure to hold the drill at the appropriate angle of the transom.

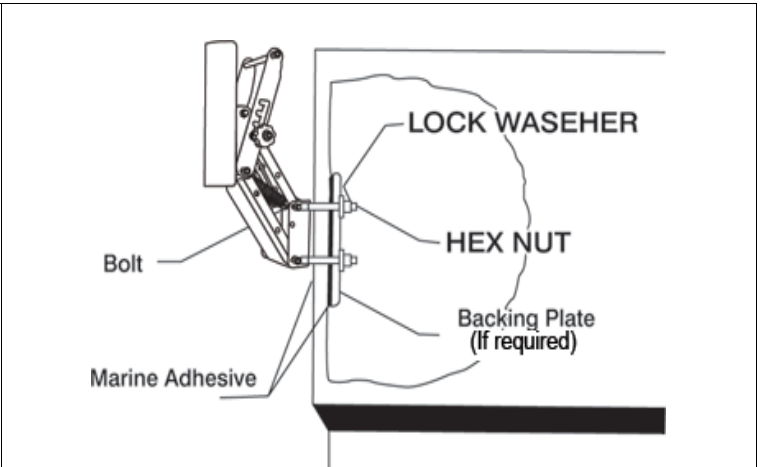
**Notes:**

- If your transom is less than 2" thick, it is recommended that you use a backing plate to ensure maximum rigidity.
- Always use a safety cable when operating your motor.
- Operate the motor in the lowest possible location to achieve best performance.
- Always raise the motor when not in use.
- Always remove your motor from the bracket when trailering.
- Do not exceed the stated motor capacity

**Lowering and Raising the Motor**

Note: The springs in the outboard motor bracket are meant to counter the weight of your motor. If you are using a particularly light motor, more pressure may be needed when raising and lowering the motor.

**To Lower Motor:** Loosen the plastic black tightening screws if needed. Grasp the motor and slowly lower it to the desired height.

**To Raise Motor:** Pull lever handle towards the boat to disengage locking pin. Grasp motor and lift to desired height. Release lever handle: the locking pin will lock the motor into place.