



## User Manual



Warrior

Please take a few minutes to read the instructions before using the product. Please charge and clean the product before using it. It's recommended to use the original charging cable only.

### Product Specifications

Product Name	Warrior
Product Materials	ABS Plastic, POM, TPE, Silicone
Battery	Li-Ion Rechargeable
Battery Capacity	500mAh
Using Time	about 180 min
Charging Time	about 100 min
Net Weight	1.74 lbs
Size	10.60*3.70 in
Waterproof	IPX0

### Buttons Display

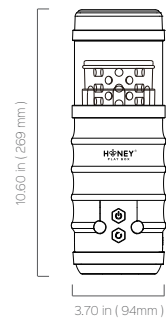

- Mode Switch&On/Off button
- Return Button
- Magnetic Charging Port

### Mode Switch&On/Off

- Press and hold the On/Off button for 2s to turn off the product.
- Press again to switch between 7 thrusting and rotating modes.

#### Return Button

- After the product is turned on, press the return button to back to the previous mode.

#### Pause

- Press on/off button and return button simultaneously to pause.

### Status Display

- Activate Status — Light on
- While Charging — Light flashes
- Fully Charged — Light on permanently
- Low Battery — Light flashes

### Attention

- For adult use only, keep out of the reach of children;
- Discontinue use if you feel any discomfort or if the product is damaged;

### Maintenance

- Clean the product with mild antibacterial soap and water before and after each use, then dry it with a towel;
- Store the product in a clean, dry and dust-free place, avoid direct sunlight, keep away from high temperature, humidity, and dirt.

### How to Use

- Clean the sleeve with water or shower gel while using it for the first time, then dry it with a towel.
- Apply appropriate lubricant into the tunnel or on your genital to smooth the experience.

### How to Clean

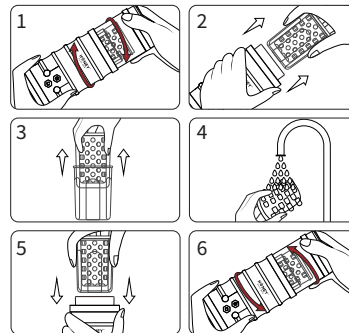

- Remove the plastic lid and turn the transparent cover 1cm counter-clockwise to remove it from the base.
- Pinch the interior transparent cup and pull it up to remove it.
- Take out the TPE sleeve from the transparent cup.
- Clean the TPE sleeve.
- After clean and air dry, put the TPE sleeve back.
- Reinstall the transparent cup and transparent cover once again.

Tómesse unos minutos para leer las instrucciones de este manual antes de usar el producto. Por favor, cargue y limpie el producto antes de usarlo. Se recomienda usar solo el cable original.

### Especificaciones del producto

Nombre del producto	Warrior
Materiales del producto	Plástico ABS, POM, TPE, Silicona
Batería	Recargable de iones de litio
Capacidad de la batería	500mAh
Tiempo de uso	unos 180 minutos
Tiempo de carga	unos 100 minutos
Peso neto	1.74 lbs
Tamaño	10.60*3.70 in
Impermeable	IPX0

### Botones Pantalla

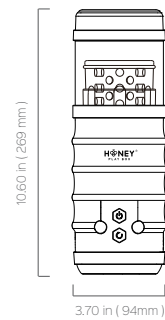

- Interruptor de modo y botón de encendido/apagado
- Botón de retorno
- Puerto de carga magnético

### Interruptor de modo y botón de encendido/apagado

- Mantenga presionado el botón de encendido/apagado durante 2 segundos para encender/apagar el producto.
- Presione nuevamente para cambiar entre 7 modos de empuje y rotación.

#### Botón de Retorno

- Después de encender el producto, presione el botón de retorno para volver al modo anterior.

#### Pausa

- Presione el botón de encendido/apagado y el botón de retorno simultáneamente para hacer una pausa.

### Pantalla de estado

- Activar estado — Luces encendidas
- Mientras se carga — Destellos de luz
- Completamente cargado — Luz encendida permanentemente
- Batería baja — Destellos de luz

### Atención

- Sólo para uso de adultos, manténgalo fuera del alcance de los niños;
- Deje de utilizarlo si siente alguna molestia o si el producto está dañado;

### Maintenance

- Limpie el producto con agua y jabón antibacteriano suave antes y después de cada uso, y luego séquelo con una toalla;
- Guarde el producto en un lugar limpio, seco y sin polvo, evite la luz solar directa, manténgalo alejado de las altas temperaturas, la humedad y la suciedad.

### Modo de uso

- Limpia el manguito con agua o gel de ducha mientras lo usas por primera vez, luego sécalo con una toalla.
- Aplique el lubricante adecuado en el túnel o en sus genitales para suavizar la experiencia.

### Cómo Limpiar

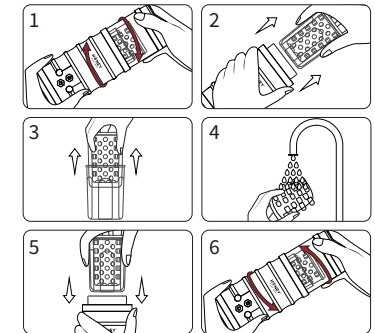

- Retire la tapa de plástico y gire la cubierta transparente 1 cm en sentido contrario a las agujas del reloj para quitarla de la base.
- Pelizque la copa interior transparente y tire hacia arriba para quitarla.
- Saque la funda TPE de la copa transparente.
- Limpie la funda de TPE.
- Después de limpiar y secar al aire, saque la parte posterior de la manga TPE.
- Vuelva a instalar la copa transparente y la cubierta transparente una vez más.

### Dear Valued Customer,

Thank you for choosing Honey Play Box! We are dedicated to bringing you intelligent, Sleek, Luxury and Elegant Lifestyle products! Once you registered on our website, you will get the latest updates of our innovative products with creative ways of playing. Enjoy the amazing pleasure!

Honey Play Box Customer Service



BY REGISTERING YOUR PRODUCT ONLINE, YOU WILL VALIDATE YOUR 1-YEAR WARRANTY



Official Website



Instagram

FOR LATEST UPDATES, FOLLOW US!



@Honey Play Box



PROVIDING 10 YEARS OF QUALITY SERVICE AND SEXUAL WELLNESS PRODUCTS  
https://www.honeyplaybox.com

### Quality

Surpassing standards from Europe and America

### Material Safety

All Honey Play Box products are manufactured using environmental friendly materials including Silicone and ABS plastics. They are harmless to human body.

### International Certification

Honey Play Box products have passed EU ROHS certification and meet EU CE Directive and WEEE Directive. Honey Play Box products are "Green" meeting the official safety and environmental protection standard issued by agencies in Europe and North America.



### Additional Information:

The EU CE Directive and the WEEE Directive are referred to as the "Twin Directives for Environmental Protection" or "Double Green Directives" and are used to restrict hazardous substances in electronic products including lead, cadmium, and mercury. ROHS stands for "Restriction of the Use of Certain Hazardous Substances"; and WEEE stands for "Waste Electrical and Electronic Equipment". Products that meet the standards set out in these two directives can be advertised as "Green Products".

### EU CE Directive:

Is the collective name of a series of product standards issued by the European Union; enterprises complying with the standard may apply for CE certification mark on their products and labelling. Honey Play Box products surpass the standards set out by these directives and are authorized to use the mark identifying that the products comply with all EU requirements.

### WARNING!

Proper maintenance and care may extend the product's service life. Before using the product, please read the following safety instruction carefully.

- Please comply with the following before using the product:
  - Clean the product completely. Scrub it with an antibacterial soap and then wash with clean hot water; at last, wipe it gently with towel or soft cloth.

- During using the product

- NO using massage oil or hand cream as lubricant.
- NO using silicon-based lubricant, because it'll damage the organosilicone surface.

Reminder: Do not use any cleaning agent containing alcohol, gasoline or acetone to wipe the product. Avoid direct solar radiation and long-time exposure to the high-temperature environment. The product shall be stored in a clean and dry place without contact with other plastic products.

### Maintenance of the Built-in Battery:

- This product uses rechargeable batteries. A new battery could play its full effectiveness after two or three charging and discharging processes.
- A battery can be charged or discharged for over 100 times and will go matured finally. After being charged fully, the battery shall be disconnected with the charger, or overcharge may reduce the battery life.
- When the product is idle, the electric quantity of fully charged battery will lose gradually.
- If the product is placed in a too hot or cold place, it will reduce the battery capacity and shorten the battery life. If the battery is too hot or cold, the battery life will be also short even though it is charged fully.

### Battery Warning!

- When the battery damaged or tampered with, it could cause fire or chemical burn. Explosion may happen when the battery is damaged.
- The battery shall be disposed in accordance with the local laws and regulations. If possible, please recycle it. Users shall not take out or replace the battery by themselves; otherwise, the risky operation may damage the product.

Reserve alguns minutos para ler as instruções antes de usar o produto. Por favor, carregue e limpe o produto antes de usá-lo. Recomenda-se usar apenas o cabo de carregamento original.

### Especificações do produto

Nome do produto	Warrior
Materiais do produto	Plástico ABS, POM, TPE, Silicona
Bateria	Li-ion recarregável
Capacidade de carga	500mAh
Usando o tempo	cerca de 180 minutos
O tempo de carga	cerca de 100 minutos
Peso líquido	1.74 lbs
Tamanho	10.60*3.70 in
Impermeável	IPX0

### Exibição de botões

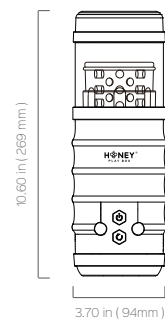

- Botão de ligar/desligar de modo
- Botão de retorno
- Porta de carregamento magnético

### Botão de ligar/desligar de modo

- Pressione e segure o botão Ligar/Desligar por 2s para ligar/desligar o produto.
- Pressione novamente para alternar entre os 7 modos de impulso e rotação.

#### Botão de Retorno

- Depois que o produto for ligado, pressione o botão de retorno para voltar ao modo anterior.

#### Pausar

- Pressione o botão liga/desliga e o botão de retorno simultaneamente para pausar.

### Exibição de status

- Ativar status — Luces ligadas
- Durante o carregamento — Luz pisca
- Totalmente carregado — Luz permanentemente
- Bateria fraca — Luz pisca

### Atenção

- Apenas para uso adulto, mantenha fora do alcance das crianças;
- Descontinuar o uso se sentir algum desconforto ou se o produto estiver danificado;

### Manutenção

- Limpe o produto com sabão antibacteriano leve e água antes e depois de cada uso, depois aque com uma toalha;
- Armazene o produto em um lugar limpo, seco e sem poeira, evite a luz solar direta, mantenha-se longe de alta temperatura, umidade e sujeira.

### Como usar

- Limpe a manga com gel de água ou chuveiro enquanto usá-lo pela primeira vez, depois aque com uma toalha.
- Aplique o lubrificante apropriado no túnel ou em seu genital para suavizar a experiência.

### Como Limpar

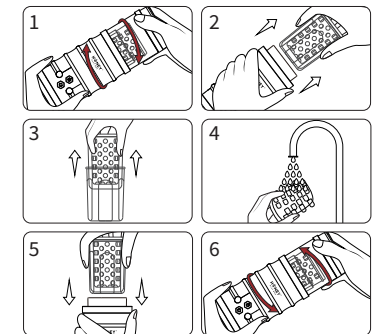

- Retire a tampa plástica e gire a tampa transparente 1cm no sentido anti-horário para removê-la da base.
- Aperte o copo transparente interno e puxe-o para removê-lo.
- Retire a manga TPE do copo transparente.
- Limpe a manga de TPE.
- Depois de limpar e secar ao ar, coloque a manga TPE de volta.
- Reinstale o copo transparente e a tampa transparente novamente.