

## TABLE OF CONTENTS

1. WHAT'S IN THE BOX & THE BASICS
2. MOUNTING YOUR FLEXTILT HEAD
3. MOUNTING THE CAMERA TO YOUR FLEXTILT HEAD
4. ADJUSTING TENSION OF YOUR FLEXTILT HEAD
5. CAUTIONS AND TIPS
6. USE WITHOUT A TRIPOD

## 1. WHAT'S IN THE BOX & THE BASICS

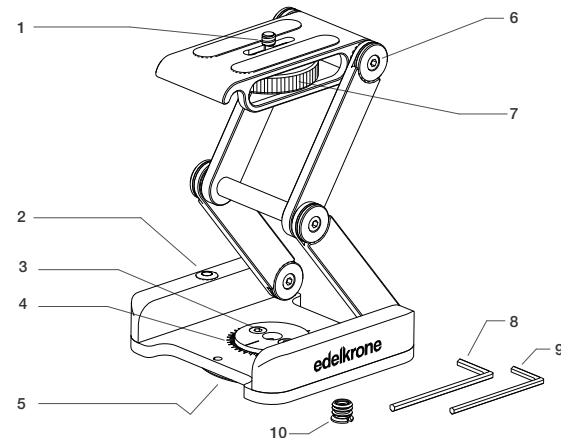

- |                                 |                                 |
|---------------------------------|---------------------------------|
| 1. 1/4" - 20 Mounting screw     | 6. 3mm Adjustment joints (x6)   |
| 2. Spirit level                 | 7. Mounting wheel               |
| 3. 2.5mm Adjustment joints (x2) | 8. 3mm allen wrench             |
| 4. Pan marking                  | 9. 2.5mm allen wrench           |
| 5. 3/8" - 16 Mounting port      | 10. Reducer bushing/adaptor* x2 |

\*1/4"-20 to 3/8"-16 mounting screw adapter and 1/4"-20 reducer bushing for mounting port are provided.

## 2. MOUNTING YOUR FLEXTILT HEAD 2

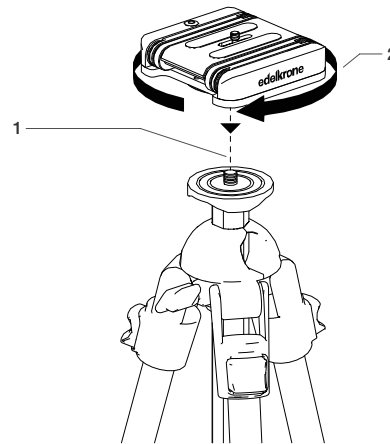

1. Place your FlexTILT Head 2 on the screw.
2. Rotate clockwise to tighten.
3. Continue rotating until it is tightened.

A detailed video explaining the mounting process can be found at: [manuals.edelkrone.com](http://manuals.edelkrone.com)

## 3. MOUNTING THE CAMERA TO YOUR FLEXTILT HEAD 2

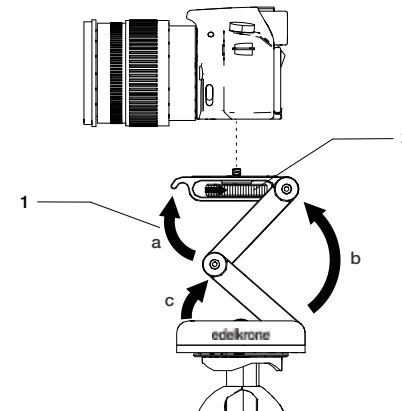

1. Unfold the FlexTILT Head 2 to access the mounting wheel.
2. Attach your camera using the mounting wheel.

When you are adjusting height, adjust one point at a time. (a,b,c)

A detailed video explaining the mounting process can be found at: [manuals.edelkrone.com](http://manuals.edelkrone.com)

## DISCLAIMER

edelkrone cannot be held responsible for damage caused by improper use or modification of the product.

For more information and tips about your FlexTILT Head 2, please watch the user's manual video at: [manuals.edelkrone.com](http://manuals.edelkrone.com)

#### 4. ADJUSTING TENSION OF YOUR FLEXTILT HEAD 2

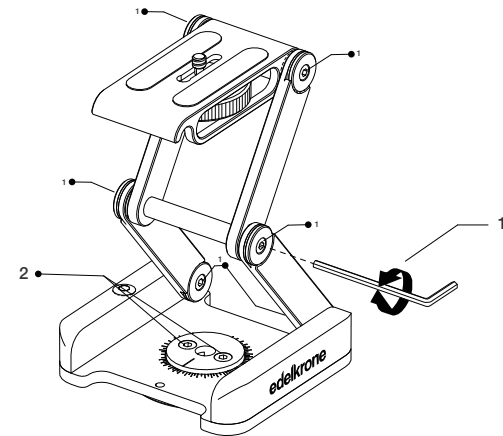

You can adjust the tension of the system with the help of a 3mm allen wrench (1). Simply tighten or loosen the screws on each side. Panning tension is adjusted using a 2.5mm allen wrench (2).

 A detailed video explaining the mounting process can be found at: [manuals.edelkrone.com](https://manuals.edelkrone.com)

#### 5. CAUTIONS AND TIPS

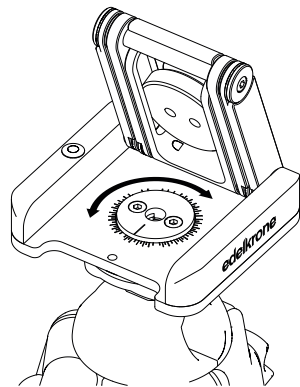

If the hash marks are turning, the FlexTILT Head 2 is panning.

The FlexTILT Head 2 can pan for up to 340° degrees.

 When you are operating the FlexTILT Head 2, hold your camera for safety.

 Avoid placing your hand in the middle of the system in order to prevent pinching.

 A detailed video explaining other tips can be found at: [manuals.edelkrone.com](https://manuals.edelkrone.com)

#### 6. USE WITHOUT A TRIPOD

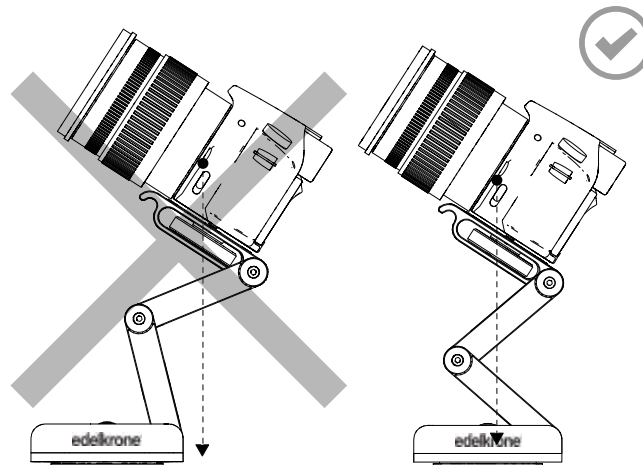

 To keep your set up balanced, ensure that the center of gravity is over the middle of the self standing area.

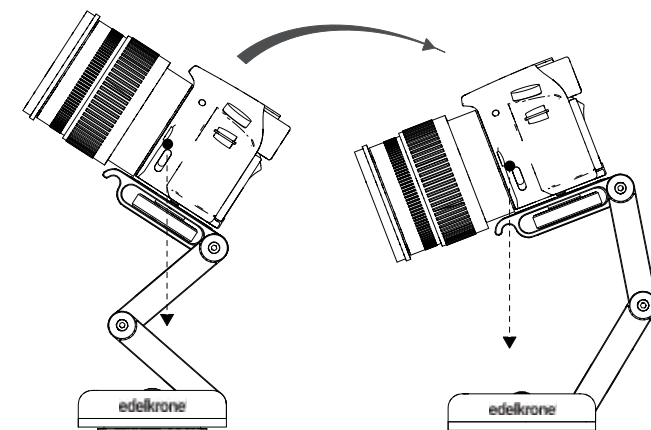

 If you want to aim the camera downwards/upwards, just keep the center of gravity in balance and set the height.

 A detailed video explaining how to balance and turn the camera can be found at: [manuals.edelkrone.com](https://manuals.edelkrone.com)

## FLEXTILT HEAD 2 USER'S MANUAL

Before operating your edelkrone, please watch the user's manual video from the link below

[manuals.edelkrone.com](https://manuals.edelkrone.com)

**edelkrone**  
filmmaking solutions