

The instructions provide you information on how to install your lock properly. Read the instructions carefully before installation.

BEFORE PROCEEDING:

1. CHECK BACKSET OF YOUR LOCK
Backset, 60mm (2-3/8") or 70mm (2-3/4"), is indicated on packaging box.

some models are supplied with adjustable latch.

2. CHECK BACKSET OF YOUR DOOR
Backset is the distance measured from door edge

to center of lock either 60mm (2-3/8") or 70mm (2-3/4").

3. MATCH BACKSET OF YOUR LOCK WITH BACKSET OF YOUR DOOR
Make sure your lock has the same backset size as your door. For lock

supplied with adjustable latch, you may adjust the backset if necessary according to step 10 - 12.

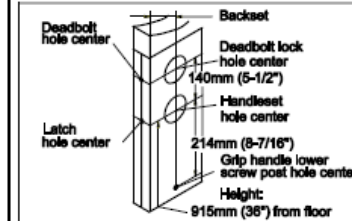

- 1. MARK DOOR**
- Start approximately 915mm (36") from floor, select backset, 60mm (2-3/8") or 70mm (2-3/4"), fold and apply template on high edge of beveled door.
 - Mark hole center on door face for deadbolt lock.
 - Mark hole center on door face for handleset.
 - Mark hole center on door face for grip handle lower screw post.
 - Mark two hole centers in door edge for latches.

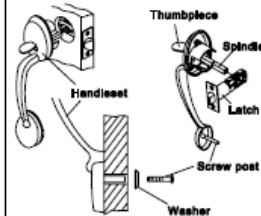

- 6. INSTALL HANDLESET**
- Place handleset onto door by inserting spindle through latch and lower screw post through screw post hole from outside of door as shown. Press tightly against door face. Insert mounting screw through washer on inside of door, but do not tighten.

Adjust Backset Instructions

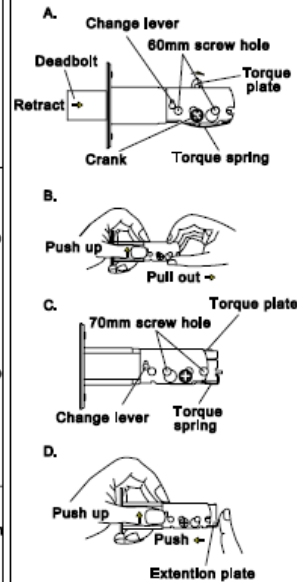

- 10. ADJUST DEADBOLT FROM 60mm (2-3/8") TO 70mm (2-3/4")**
- This model is supplied with adjustable latch, fitting 60mm (2-3/8") or 70mm (2-3/4") backset. Adjustable deadbolt was preset at 60mm (2-3/8") backset position. If 70mm (2-3/4") backset is required, please follow steps as below.
- Use tallpiece or flat head screwdriver to rotate crank and retract the deadbolt to the unlocked position.
 - Push change lever up against the top. Hold torque plate and torque spring, then pull extension plate all the way out. Be sure the 70mm (2-3/4") screw holes are properly aligned and change lever slides into original position.
 - The deadbolt is now set for 70mm (2-3/4") backset.
 - Deadbolt may be adjusted back to 60mm (2-3/8") backset by retracting the deadbolt to the unlocked position, pushing up the change lever and moving the extension plate back to its original position. Be sure the 60mm (2-3/8") screw holes are properly aligned and change lever slides into original position after adjustment.

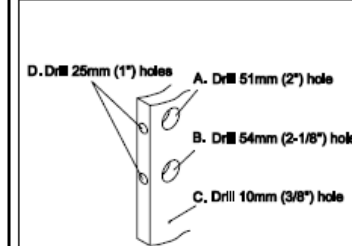

- 2. BORE FIVE HOLES**
- Drill a 51mm (2") hole through door face.
 - Drill a 54mm (2-1/8") hole through door face.
 - Drill a 10mm (3/8") hole through door face.
 - Drill two 25mm (1") holes in door edge.
- Note: It is recommended to drill holes from both sides of door in A, B & C to avoid splitting.

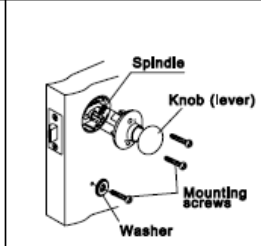

- 7. INSTALL INSIDE KNOB (LEVER) UNIT**
- Install inside knob (lever) unit, so holes in rose line up with screw posts, and spindle is engaged with inside mechanism.
 - Insert mounting screws into holes in rose, tighten screws for handleset.
 - Adjust all mounting screws as required for smooth operation.
- Note: Check operation of lock with thumbpiece and knob to be sure that spindle is properly engaged and latch operates smoothly.

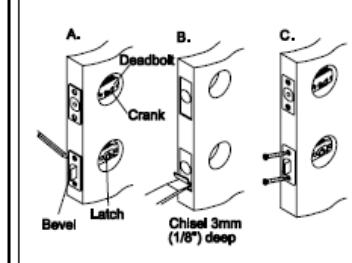

- 3. INSTALL LATCH AND DEADBOLT**
- Insert latch (deadbolt) into hole in door edge, keeping latch face parallel to edge of door. Mark outline of latch face and remove latch.
 - Chisel 3mm (1/8") deep or until latch face is flush with door edge.
 - Insert latch (deadbolt) into hole and tighten wood screws.
- Note: 1. Latch/bolt bevel must face to closing direction.
2. Crank hole must be in down position.

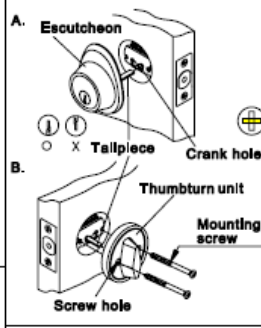

- 8. INSTALL SINGLE CYLINDER**
- Place outside cylinder unit through escutcheon and press against door face, making certain that tailpiece is horizontally inserted into crank hole. Tapped screw holes in outside cylinder body to be lined up with deadbolt holes.
 - Rotate thumbturn to vertical position and slip thumbturn onto tailpiece.
 - Insert two mounting screws through holes on thumbturn unit and deadbolt, engaging screw holes in outside cylinder body, then tighten to snug fit. Do not overtighten.
 - Test lock for smooth operation. If not smooth, loosen screws, adjust cylinder unit and tighten firmly.
- Note: Key hole must be in down position.

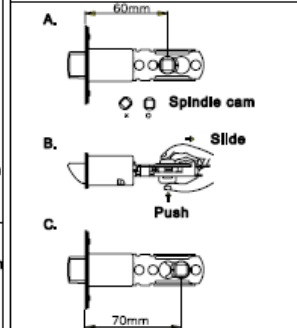

- 11. ADJUST LATCH FROM 60mm (2-3/8") TO 70mm (2-3/4")**
- Adjustable latch was preset at 60mm (2-3/8") backset position.
 - Keep spindle cam in correct position as illustrated. Adjust by grasping the spindle cam between thumb and index, slightly push down spindle cam and slide to right side.
 - The latch is now set for 70mm (2-3/4") backset. To re-adjust latch back to 60mm (2-3/8") backset, just push slide extension back to left side.

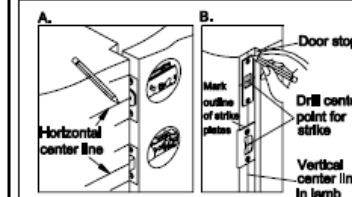

- 4. MARK JAMB AND OUTLINE OF STRIKES**
- Close door until latch/bolt touches door jamb. Mark horizontal center line along latch face.
 - Measure one half of door thickness from door stop and mark vertical center line.
 - Extend horizontal center line and vertical center line, then mark center points for strikes.
 - Place strikes in position and mark outline of strikes and remove strikes.

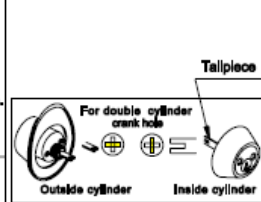

- 9. INSTALL DOUBLE CYLINDER**
- Place outside cylinder unit through escutcheon and press against door face, making certain that the outside tailpiece is horizontally inserted into crank hole.
 - Push inside cylinder unit and outside cylinder unit together, making certain that the inside tailpiece is vertically inserted into crank hole. Note: Key hole must be in down position.
 - The inside tailpiece should be inserted crosswise into the outside tailpiece.
 - Insert two mounting screws through countersunk holes on inside cylinder body and deadbolt, engaging screw holes in outside cylinder body and tighten to snug fit. Do not overtighten.
 - Test lock for smooth operation. If not smooth, loosen screws, adjust cylinder unit and tighten firmly.

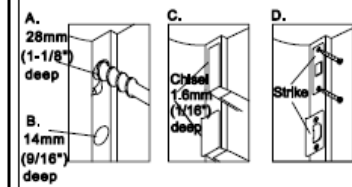

- 5. DRILL HOLES AND INSTALL STRIKES**
- Drill a 25mm (1") hole, 28mm (1-1/8") deep in door jamb at the upper center for deadbolt.
 - Drill a 25mm (1") hole, 14mm (9/16") deep in door jamb at the lower center for latch.
 - Chisel outline for strikes 1.6mm (1/16") deep or until strikes are flush with door jamb.
 - Install strikes and tighten wood screws.

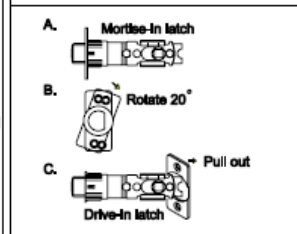

- 12. ADJUST 4-WAY LATCH**
- Some locksets are supplied with 4-way latch which can fit either 60mm (2-3/8") or 70mm (2-3/4") backset and also fit mortise-in or drive-in.
- This latch is for mortise-in.
 - Rotate latch face clockwise 20 degrees and pull out latch face.
 - This latch is for drive-in.