

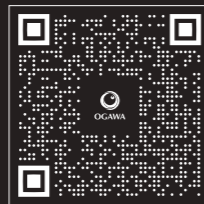

MasterDrive **Duo**



Scan the QR code for installation



INSTALLATION MANUAL | OG8900

Assembly Instructions

The OG8900 massage chair arrives in 2 boxes.



- 1 Open box 1 and remove all contents.** Remove the packing materials. Take the chair out of the box. Collect all the accessories and put them aside.

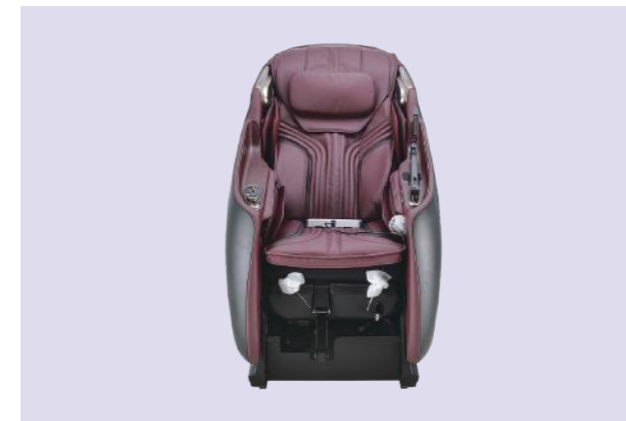

2 Remove the foam protectors and footrest holder clips. Use a flathead and wedge in between the clip as shown, then slide the clip out. Set them aside for later. Do not dispose.



3 Open box 2. Take the footrest out of the box and move the footrest close to the chair.



4 Connect the wire and air hose in footrest. Locate the white dots on both ends of the footrest connection, align them together and screw the threaded cap tight. Connect the air tube and make sure the side clips of the coupler are properly secured.

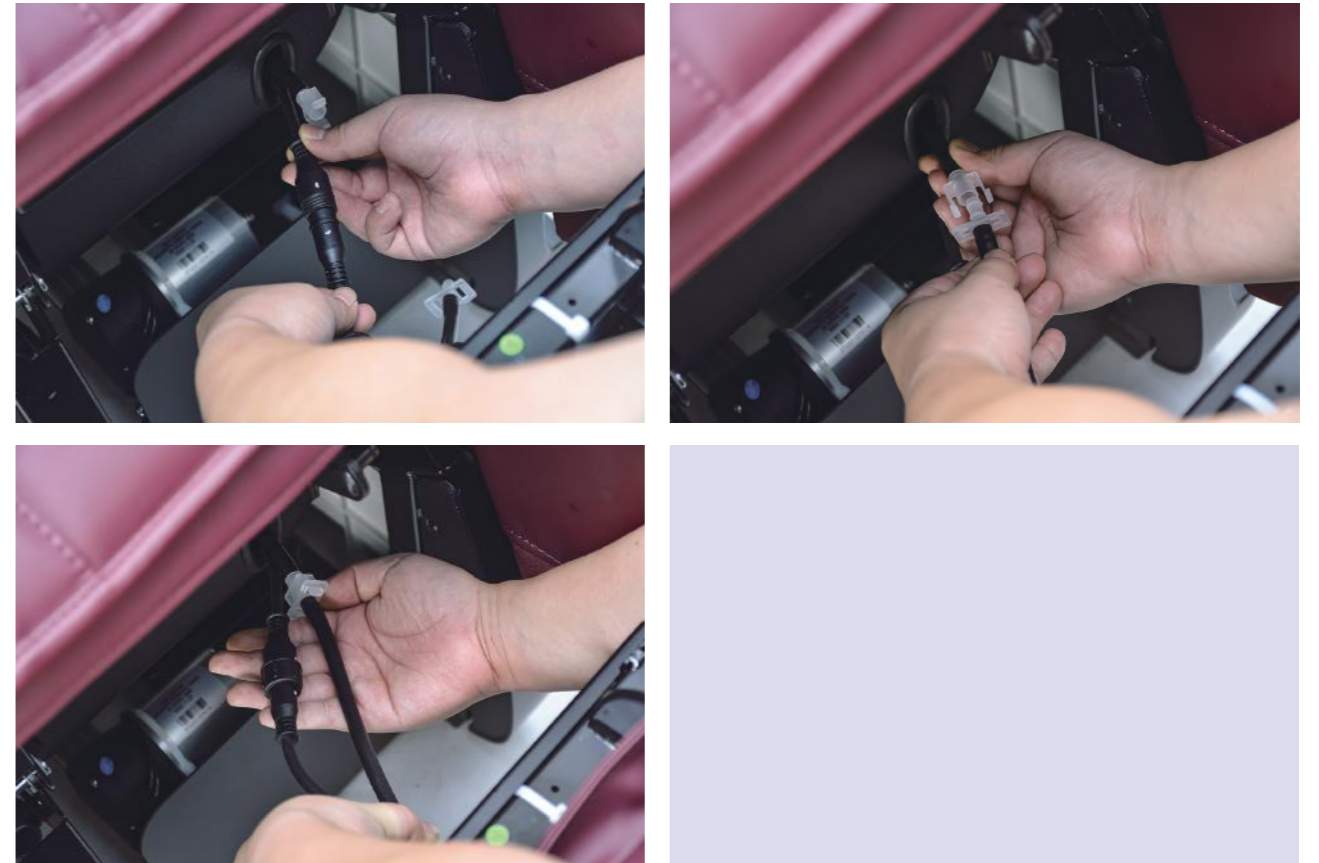

5 Fully connect the footrest to the base. Hold the footrest with both hands. Hold the footrest and base at an angle of 30 degrees. Hang the footrest on right side sitting bolt first. Then hang the footrest on left side sitting bolt.





6 Lock the footrest with the footrest holder clips. Zip the zipper between the seat pad and footrest cushion.



7 Place the remote control and biometric sensor into the holder.

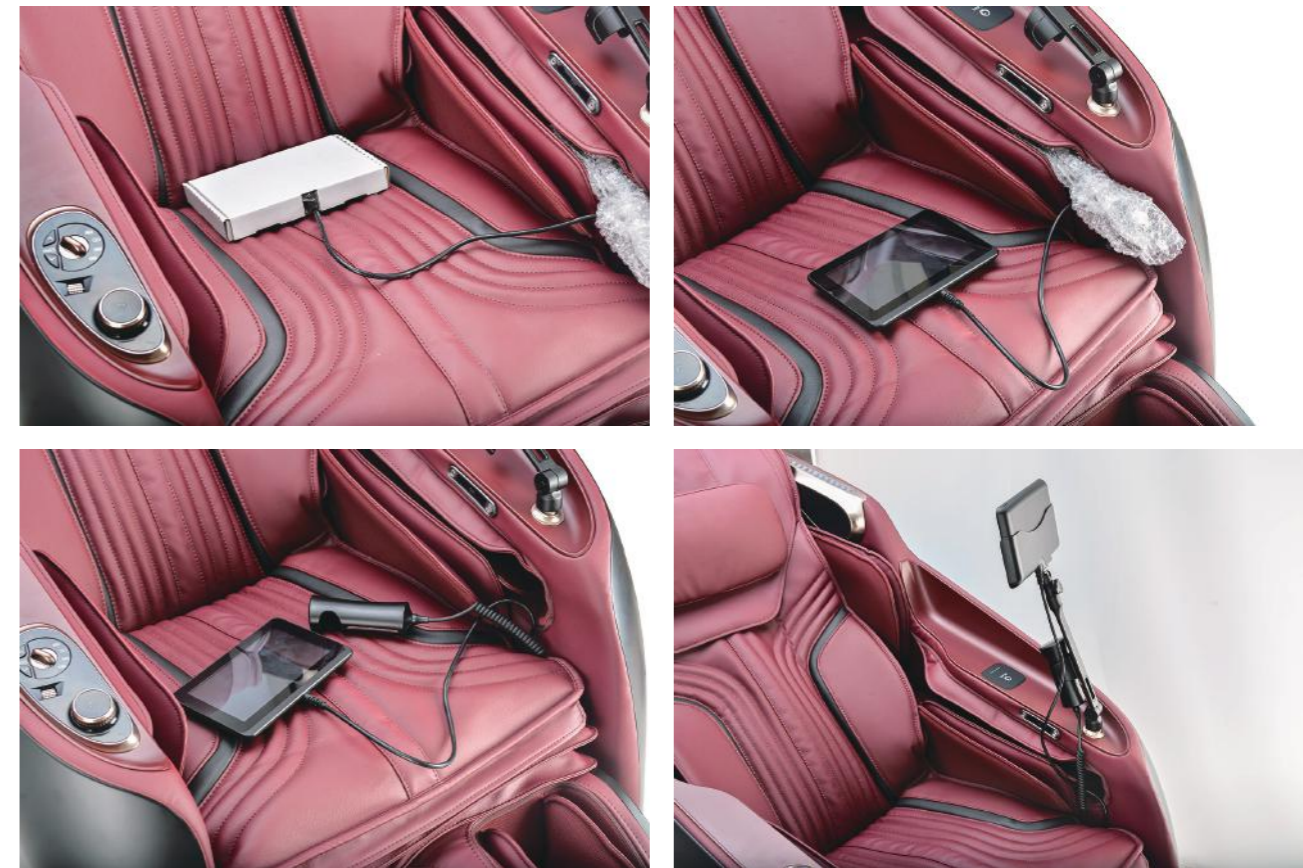

8 **Turn on the chair.** Connect the chair to a power supply and turn on the power switch. The chair will now be ready to start.

