

Limited Warranty

RELAX 2 ZERO 3D MASSAGE LOUNGER

Consumer Limited Warranty: ONE-YEAR WARRANTY

This warranty guarantees that the product purchased is to be free from defects in material and workmanship under normal usage and local voltage for a period of one year. This warranty expires in **TWO (2) years on parts, and ONE (1) year on labor** after the date of purchase.

U.S. JACLEAN, INC. (referred to as "the Warrantor") will repair this product with new or rebuilt parts in case of defects in material or workmanship, free of charge, in the USA provided that:

- 1) The product is operated in accordance with the printed instructions supplied.
- 2) The product is used under normal conditions for which designed.
- 3) The product is not subjected to misuse, negligence, or accident.
- 4) The product receives proper care, protection, and maintenance.

This warranty is extended to the original end-user when purchased from an authorized U.S. JACLEAN, INC. distributor. A purchase receipt or other proof of date of the original purchase is required for service and parts replacement under this warranty. This warranty does not cover shipping charges for defective items if a claim is made more than 30 days after the date of purchase.

This warranty only covers failures due to defects in materials and workmanship and does not cover normal wear or cosmetic damages. This warranty does not cover damages which occur in shipment, or failures which result from: accident, misuse (including, without limitation, failure to comply with instructions and use limitations contained in the Operating Instructions), abuse, neglect, mishandling, faulty installation, set-up adjustments, improper operation or maintenance, alteration, modification, a power line surge, lightening, improper line voltage, commercial use (e.g., as a service in a hotel, office, restaurant, or other business or for rental use), service by anyone other than from U.S. JACLEAN, INC., or damage that is attributable to "acts of God."

Continued use of this product after discovering a defect voids this warranty. This warranty shall be governed by the state of California, United States of America.

**IMPORTANT: CONTACT U.S. JACLEAN, INC. FOR REPAIR SERVICES.
DO NOT RETURN A DEFECTIVE PRODUCT TO THE STORE FROM**

Please retain this Warranty Certificate, together with the original purchase receipt, and present it to our technician for inspection during service.

For assistance and more information, please contact U.S. JACLEAN, INC.

Online warranty registration at: daiwamassage.com/warranty



RELAX 2 ZERO 3D

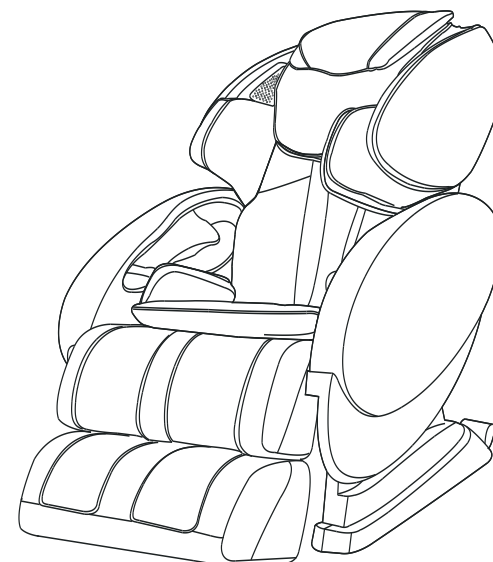

MASSAGE LOUNGER

Before operating this unit, please read these instructions completely.

* Due to continuous quality improvement, the specifications and part names in this instruction manual may be different than the actual product

Operating Instructions

DWA-9060



Distributed by U.S. Jaclean, Inc.
1816 West 135th Street
Gardena, CA 90249

1-833-542-1918
9AM - 5PM PST (Monday - Friday)

daiwamassage.com

▶ RELAX 2 ZERO 3D

Thank you for purchasing the Relax 2 Zero 3D Massage Chair.
Before using this chair for the first time, please read through all sections of this User Manual carefully, paying special attention to the Safety Instructions.

PLEASE RETAIN THIS MANUAL FOR FUTURE REFERENCE.

▶ CONTENTS

| | |
|--|----|
| IMPORTANT SAFETY INSTRUCTIONS | 1 |
| PARTS | 3 |
| Exterior Parts | 3 |
| Interior Parts | 3 |
| Power Supply Box | 4 |
| OPERATION | 5 |
| Main Controller | 5 |
| Controller Operation | 6 |
| Automatic Programs | 7 |
| Manual Programs | 8 |
| FEATURES | 13 |
| SETUP | 14 |
| Massage Chair Placement | 14 |
| Grounding Instructions | 15 |
| Installation | 16 |
| Relocation | 21 |
| Initial Operation | 22 |
| PRODUCT STORAGE AND MAINTENANCE | 23 |
| TROUBLESHOOTING | 24 |
| SPECIFICATIONS | 25 |
| WARRANTY | 26 |

▶ TECHNICAL SPECIFICATIONS

Product name: Relax 2 Zero 3D
Product Model: DWA 9060
Rated voltage: 100-120 V
Rated frequency: 50/60 Hz
Rated power: 240 W
Safety design: Class I

▶ TROUBLE SHOOTING

| No. | Problem | Check the following: | Explanations / Remedies |
|-----|--|--|--|
| 1 | Noises are heard during operation | N/A | These noises are normal and arise from friction between the massage rollers and the leather cover. |
| 2 | Operation fails to start | Has the power plug slipped out of the wall outlet? Is the power switch in the "off" position? Has the fuse blown out? | Connect the power plug securely to the wall outlet. Switch power to the "on" position. Replace the fuse with another of the same type. |
| 3 | Airbags within the seat and the legrests fail to work properly | Are the air tubes blocked? | Clean out the air tubes. |
| 4 | Airbags within the seat and the legrests fail to work properly | The massage chair has detected some error that it is unable to display. | Turn off power, then turn it on again. If the problem persists, disconnect the power plug from the wall outlet and contact an authorized repairman |

If you encounter problems operating the Relax 2 Zero 3D, please check the points above to see if they can be rectified. If the Relax 2 Zero 3D still malfunctions or does not work, please turn off the chair and remove the power plug from the electrical outlet. Contact U.S. Jaclean Repair Service at 310-538-2298 for assistance.

IMPORTANT

Do not dismantle or attempt to repair the chair yourself. Doing so will void the warranty and U.S. Jaclean/Daiwa will not bear any responsibility for any subsequent consequences.

▶ IMPORTANT SAFETY PRECAUTIONS

- ▶ Basic precautions should always be followed when using an electrical unit, including the following.
- ▶ Please ensure that you read all instructions before using the Relax 2 Zero 3D

 DANGER – To reduce the risk of electric shock:

1. Always unplug this unit from the electrical outlet immediately after using and before cleaning.

 WARNING – To reduce the risk of burns, fire, electric shock, or injury to persons:

1. Always insert the power plug all the way into the outlet to reduce the risk of short-circuit and fire.
2. The unit should never be left unattended when plugged in. Always unplug the unit when not in use.
3. The unit is not to be used by people who cannot move or communicate on their own.
4. Only use the unit for the purpose described in these instructions.
5. Do not stand on the unit.
6. Always return the seat to the upright position and make sure the legrest is completely retracted. Be careful that nothing is obstructing the legrest while retracting. Keep children away from the legrest.
7. Never operate the unit if it has a damaged power cord or plug. Return the unit to the nearest authorized service center if it is not working properly, if it has been dropped or damaged, or if it has been immersed in water.
8. Keep power cords away from heated surfaces. Do not carry the unit by the power cord.
9. Never block the air openings during operation and make sure that all air openings are kept free of lint and hair, etc. Do not drop or insert anything into any of the openings of the unit.
10. Do not use the unit on top of heating appliances, such as electric carpets, etc. Do not operate the unit under a blanket or pillow. Excessive heating can occur and cause fire, electric shock, or injury to persons.
11. Do not use the unit in bathrooms or other damp or humid places as this may cause electric shock or cause the unit to malfunction. Do not spill water, etc. onto the controller.
12. Do not use the unit outdoors.
13. Do not use or operate where aerosol spray products are being used or where oxygen is being administered.
14. When unplugging the unit, turn off all controls before removing the plug from power outlet. Do not use the unit with a transformer as this may lead to malfunction or electric shock.
15. Connect this unit to a properly grounded outlet only. See Grounding Instructions.
16. Use heated surfaces carefully. May cause serious burns. Do not use over insentive skin areas or in the presence of poor circulation. The unattended use of heat by children or incapacitated persons may be dangerous.

▶ IMPORTANT SAFETY PRECAUTIONS

- Persons with any of the conditions listed below or who are undergoing medical treatment or suffer from medical conditions should consult with their physicians before using the unit:
 - Pregnant women, people who are ill, in poor physical shape.
 - People suffering from back, neck, shoulder, or hip pain.
 - People who have a pacemaker, defibrillator, or other personal medical devices prone to electronic interference.
 - People suffering from heart disease.
 - People who are prohibited from receiving massage by a physician due to thrombosis or aneurism, acute varicose veins, or other circulatory disorders.
 - People with irregular curvatures of the spine.
 - People who have a loss of heat sensation.
- This unit should not be used by children.
- Sit down slowly after checking the position of the massage heads. Never put any part of your body between the massage heads as the squeezing action of the massage heads may cause injury. Never put your fingers or feet in the gap between the backrest and seat, the backrest and the armrest, the seat and cover under the armrest, or the gap between the legrest and the footrest. Do not place your fingers or any part of your body in the mechanism below the legrest, or between the legrest and footrest.
- Do not use the unit against bare skin. While thin clothing may increase effectiveness, exposing the skin directly to the massager may irritate the skin. Do not use the unit while wearing anything hard on your head like a hair accessory, etc. Do not use the unit for massaging the head, abdomen, front neck, elbows or knees. Do not use excessively strong massage action on the back of the neck.
- When using the body scanning function, always ensure that the shoulder position is correct. If the shoulder position is not correct, use the POSITION button to adjust it properly, or stop the massage function and re-try the body scanning function. You can adjust the shoulder position in this way in the auto program and manual operation. Failure to align the shoulder position correctly can lead to injury.
- While using the massager, if the pressure seems too strong, the movement of the massage heads can be stopped at any time by pressing the Stop button.
- Do not go to sleep while using the massage function.
- Do not use the unit after drinking alcohol.
- When the seat back is in a reclined position, do not sit on it or sit with your legs resting on the headrest. Do not sit on the legrest as the unit may fall over.
- Do not allow children or pets to play on or around the unit, especially during operation.
- Do not unplug the unit or turn it off during operation. Unplug the unit immediately if there is a power outage.
- Do not allow children to play on this mechanized furniture or operate the mechanism. Legrest folds down on closing so that a child could possibly be injured.
- Always leave in an upright and closed position.
- Keep hands and feet clear of mechanism. Only the occupant should operate it.
- Remove hard objects, such as false fingernails, wristwatches or rings, when massaging hands or arms. Empty pockets of hard objects when massaging the area of the seat or thighs.
- When "Heat" massage heads are used, do not let the massage heads touch the same place for a long time. Low-temperature burn may occur.

▶ PRODUCT STORAGE AND MAINTENANCE

CLEANING

- ▶ Before cleaning, switch off power and remove the power plug from the wall outlet.
- ▶ Dip a soft, cotton cloth in neutral detergent and wring dry. Use it to wipe the pillow cushion, back cushion, armrests, legrests, and any plastic parts of the chair.
- ▶ Use a piece of wet cloth (without detergent) to re-wipe the pillow cushion and back cushion. Place them in a well-ventilated location for drying.
- ▶ Use a soft, dry cloth to re-wipe the armrests, legrests, and any plastic parts of the chair.
- ▶ Use a soft, dry cloth to wipe the controller, and the power supply box.

CAUTION

- ▶ Before any maintenance, always disconnect the power plug from the wall outlet.
- ▶ To avoid electric shock, never touch the power plug with wet hands.
- ▶ When cleaning the back cover of the massage chair, do not allow any detergent to seep into the power supply box.
- ▶ Do not use abrasive chemicals, such as benzene or alcohol, to clean this chair.
- ▶ Damage to the chair may result.
- ▶ DO NOT apply an iron or any other heated device to the chair.

STORAGE

- ▶ Before putting into storage, wipe off all accumulated dirt and dust from the surface of the chair. Cover the entire surface of the chair with a dust cover (not included).

CAUTION

- ▶ Do not store the product under direct sunlight, nor in a location with high temperatures. Doing so may cause the upholstery to fade.

MAINTENANCE

Upon detecting any of the following conditions during daily use, immediately turn off power, disconnect the power plug from the wall outlet, and contact an authorized repairman:

- ▶ A burning smell
- ▶ The cord is plugged in and the power switch flipped on, but no functions operate.
- ▶ The power cord feels hot.
- ▶ Any other abnormal symptoms

CAUTION

- ▶ Do not store the product under direct sunlight, nor in a location with high temperatures. Doing so may cause the upholstery to fade.

▶ SETUP

BEFORE SITTING DOWN

- ▶ Make sure there are no objects, people, or pets in the vicinity of the unit.
- ▶ Use the controller to lower the backrest to its furthest outstretched position. Raise the legrest to its highest position. Make sure that sufficient open space surrounds the chair on all sides. Make sure that the leg rest is properly connected to the main part of the chair.
- ▶ Return the chair to its original, upright position.

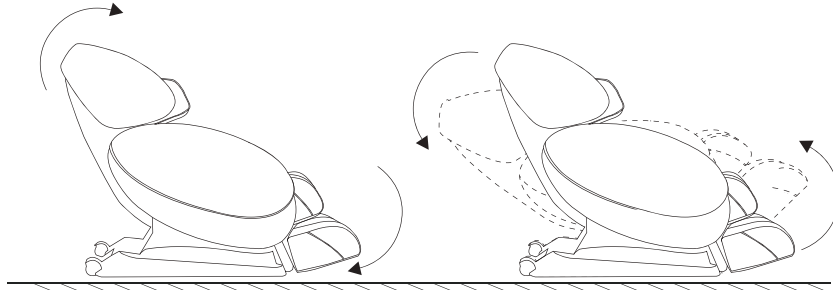

⚠ CAUTION

- ▶ Do not sit on the massage chair while the legrest is rising. To avoid possible damage, do not suddenly load the legrest with heavy weight.
- ▶ Do not allow children to play with this massage chair. If controls are tampered with, accident or injury arising from the power supply box may result.
- ▶ After your massage finishes its cycle, switch off power and remove the power plug from its wall outlet.
- ▶ Avoid operating this chair during rain and thunderstorms.
- ▶ When the chair is not in use, switch off power and remove the power plug from its wall outlet.
- ▶ If you do not plan to use the chair for an extended period of time, please put it into storage.
- ▶ Avoid dragging this chair across surfaces that can easily be damaged, such as wooden or carpeted flooring.
- ▶ To prevent electric shock, do not operate this chair within damp environments.
- ▶ Do not place this chair near a stove or other significant sources of heat. Do not expose the chair to prolonged sunlight. Damage to its leather cover may result.
- ▶ Do not hold on the legrest/leg/sole massage section when moving the unit. If this is not observed, the section may slide as you move the unit, and injuries may occur.
- ▶ Do not drag or push the unit in an installed state. Protect your floor (place a mat or similar) when moving the unit on its wheels to avoid damage to your floor.

▶ PARTS

EXTERIOR PARTS

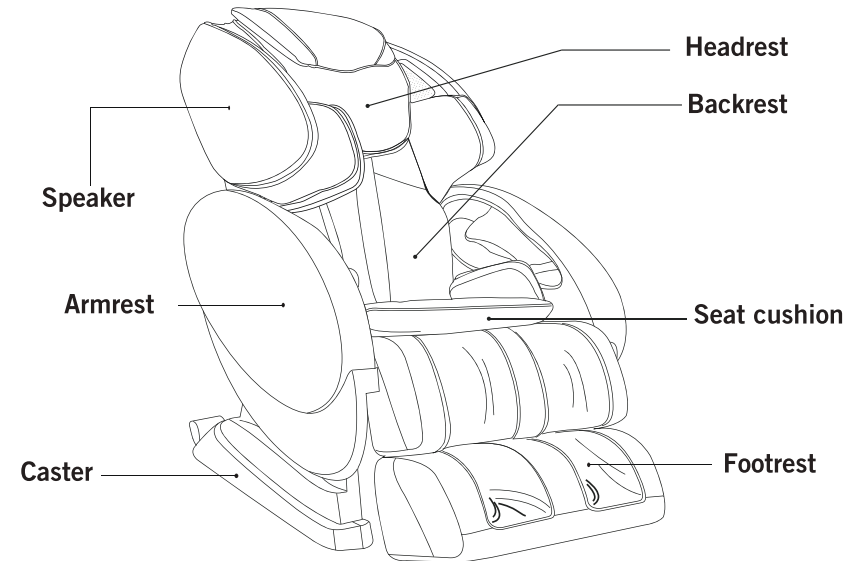

INTERIOR PARTS

3D Massage mechanism

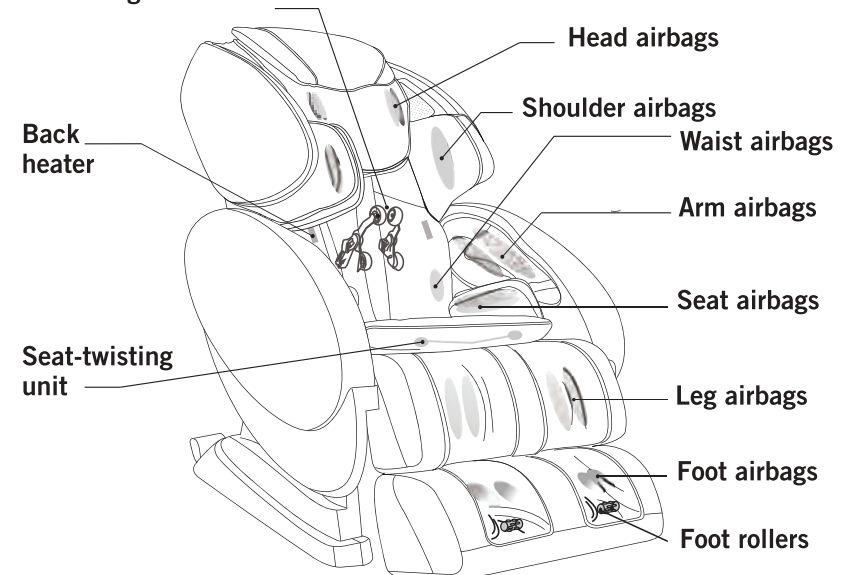

▶ PARTS

POWER SUPPLY BOX

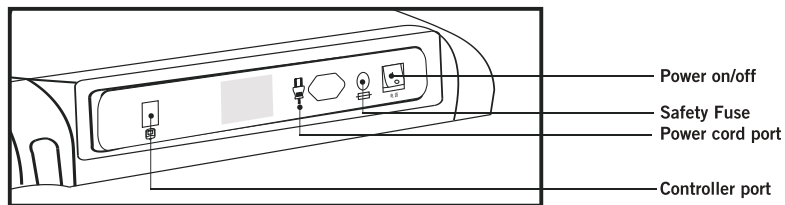

TURNING POWER ON

- ▶ Plug the power plug into a well-grounded, three-pronged power outlet.
- ▶ Flip on the power supply switch, located on the back of the massage chair, at the bottom of the backrest.

▶ SETUP

MOVING THE MASSAGE CHAIR

- ▶ Make sure that the backrest is in its highest upright position.
- ▶ Shut off power and remove the power plug from the wall outlet.
- ▶ Standing behind the back of the chair, grasp its backrest and tilt it downward, so that the front of the chair rises off of the floor. Push the chair to the location you desire. Move the chair by the wheels.

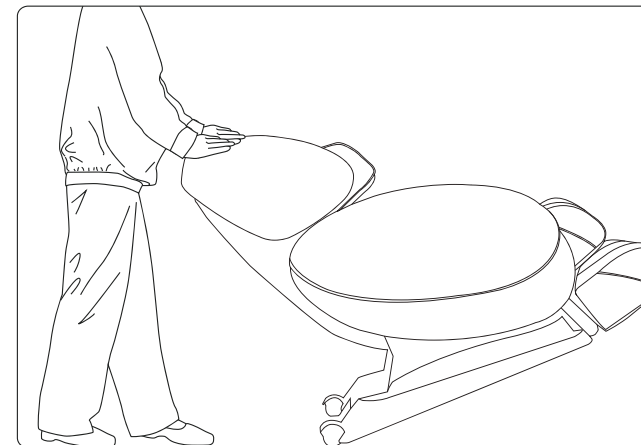

CAUTION

- ▶ Do not try to carry the chair on your own.
- ▶ Do not attempt to move the chair while someone is still sitting on it.
- ▶ While moving the chair, always grasp its backrest. Do not try to move the chair by grasping its armrests.
- ▶ Before plugging it in, inspect the entire power cord and plug for any possible damage. Make sure that no electrical wires are exposed.
- ▶ Make sure that the power supply switch is turned OFF before inserting the power plug into a wall outlet.

▶ SETUP

6. Installing the Seat Cushion

- ▶ Place the seat cushion onto the seat, and attach the air tube connectors.
- ▶ Use the velcro to fasten the seat cushion to the seat.

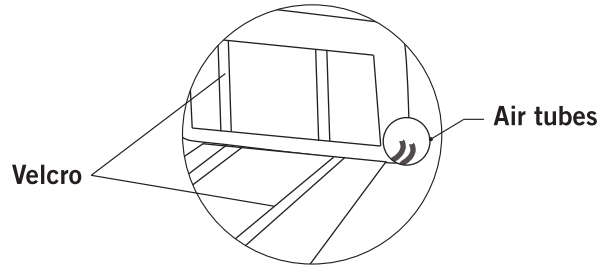

7. Installing all other units

- ▶ Connect the controller to its corresponding port on the power supply box. Insert the power plug of the chair into a wall outlet, then turn on power to return the chair's backrest to its upright position.

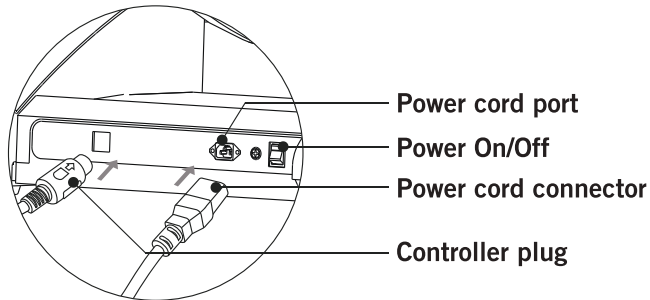

▶ OPERATION

MAIN CONTROLLER

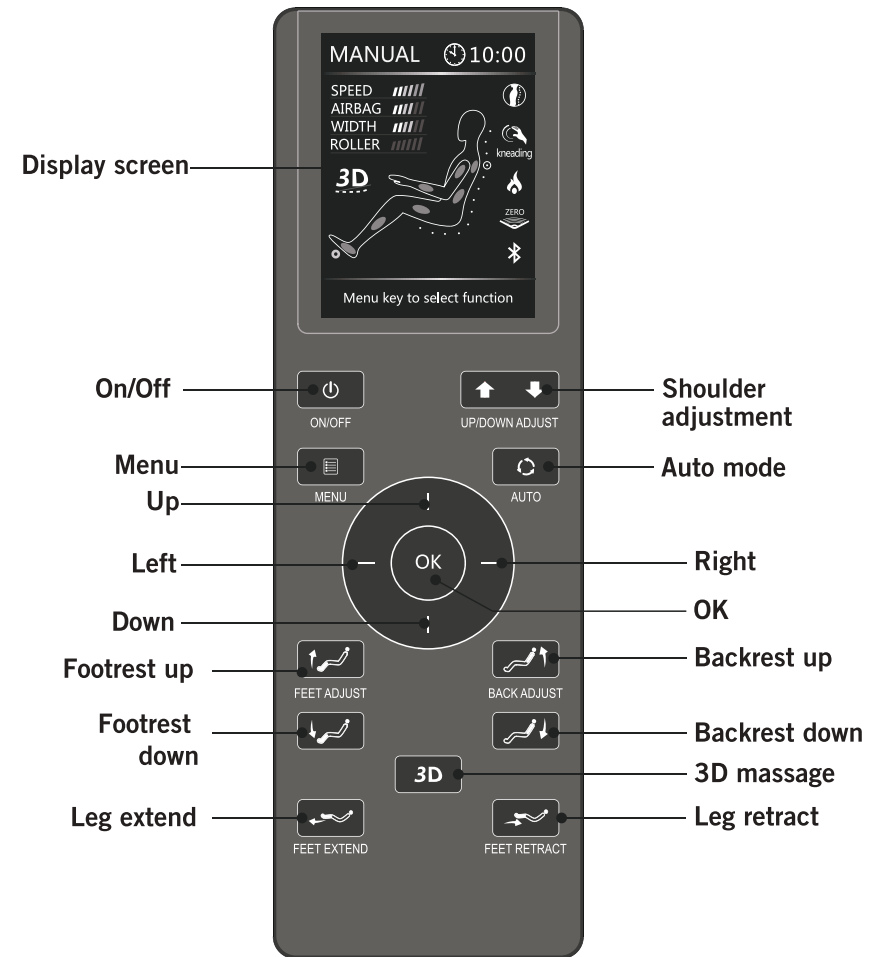

OPERATION

CONTROLLER OPERATION

Power Button

- ▶ Press to turn on the unit. The display screen will light up. Press the Up or Down key to highlight your preferred massage mode and preference. Press the center OK button to select.
- ▶ Press again to turn off all functions. The default running time is 15 minutes for each massage.

Menu Button

- ▶ During any massage operation, press here to:
 1. Select and switch to a direct massage function
 2. Add or end an option to run with your current massage program

Shoulder Position Adjustment keys

- ▶ While the Point mode manual program is running, use these keys to adjust your desired position of the point massage.

Auto mode button

- ▶ Press this button to bring up the chair's six automatic massage programs.

Direction Dial

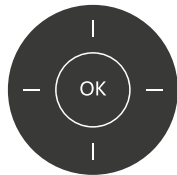

- ▶ After pressing the Menu or Auto mode buttons, use the Up, Down, Left, or Right direction keys to move among selections. Then press the center OK button to confirm that selection.
- ▶ During the massage, press the Up, Down direction keys to adjust the massage speed. Press the Left, Right direction keys to adjust the airbag force.

3D Button

- ▶ Press to adjust the 3D massage mechanism.

Footrest Up Button

- ▶ Press and hold to raise the leg rest. Release the button when it reaches your desired position.

Footrest Down Button

- ▶ Press and hold to lower the leg rest. Release the button when it reaches your desired position.

SETUP

4. Connecting the Speaker System

- ▶ Locate the Speaker System. Unzip the cover to reveal the connection slots within.
- ▶ Locate the two short spindles jutting out from either side of the chair's backrest, near the top. Also locate their corresponding slots on the inner portion of each speaker.
- ▶ Fit the entire speaker system onto the top of the chair's backrest, aligning the short spindle on the slots of the inner speaker arms.

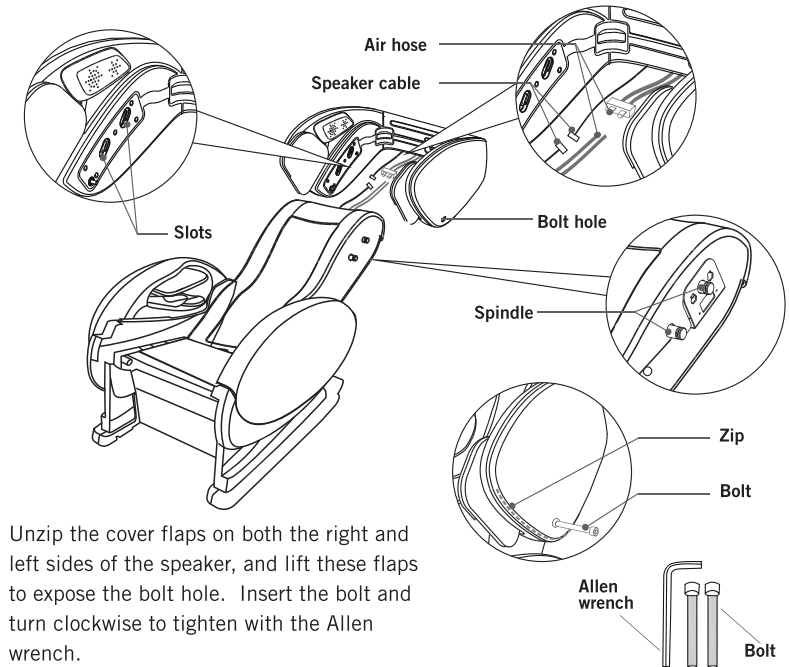

- ▶ Unzip the cover flaps on both the right and left sides of the speaker, and lift these flaps to expose the bolt hole. Insert the bolt and turn clockwise to tighten with the Allen wrench.

5. Installing the Backrest Cushion

- ▶ Attach the backrest cushion to the backrest of the chair with the zipper.
- ▶ To install the heater, locate the backrest cushion and the waist air tube (see illustration below).

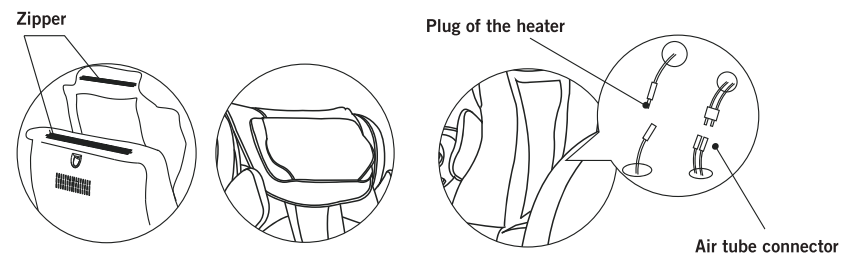

▶ SETUP

3. Connecting the Footrest

- ▶ Place the footrest in front of the main body of the massage chair.
- ▶ The footrest brackets are located on both the upper right and left sides of the footrest.

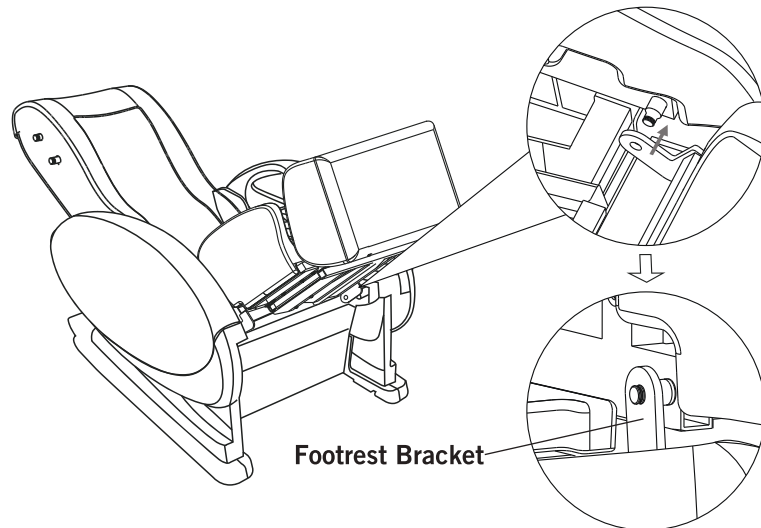

- ▶ Attach footrest bracket to the spindle and insert lock to the groove on the spindle. See below.

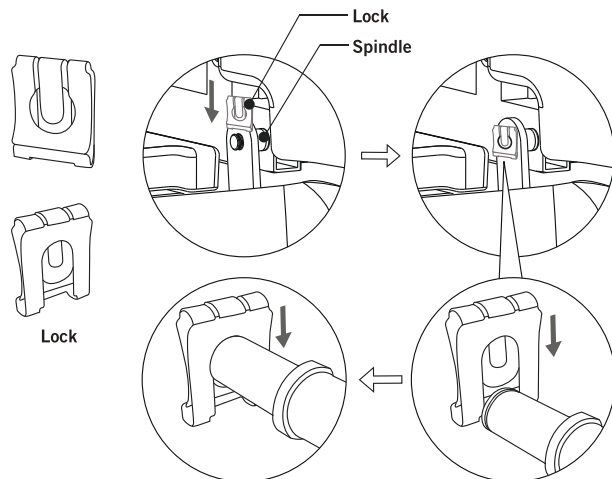

- ▶ Then connect the attachments from the air hose into their corresponding slots on the chair.

▶ OPERATION



Backrest Up Button

- ▶ Press and hold to raise the backrest. Release the button when it reaches your desired position.



Backrest Down Button

- ▶ Press and hold to lower the backrest. Release the button when it reaches your desired position.



Leg Extend Button

- ▶ Press and hold to extend the footrest. Release the button when it reaches your desired position.



Leg Retract Button

- ▶ Press and hold to retract the footrest. Release the button when it reaches your desired position.

DISPLAY SCREEN OPERATION

Automatic Programs

Press followed by to bring up the Automatic Programs menu.

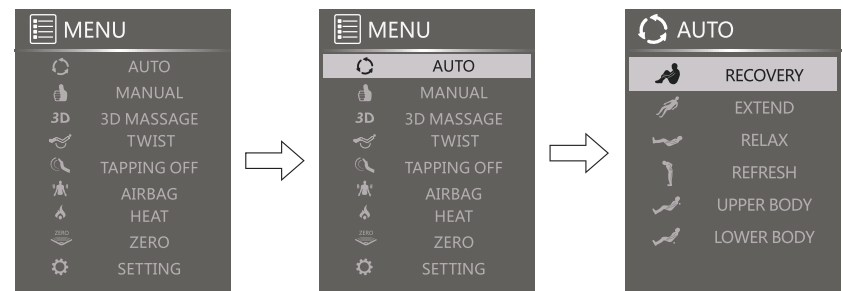

Use the Up or Down keys to highlight one of six automatic massage programs:

| | |
|------------------------|-------------------------------------|
| RECOVERY | (Warm up) |
| EXTEND | (Stretch) |
| RELAX | (Cool down) |
| REFRESH | (Light massage) |
| UPPER BODY AUTO | (Focused massage on the upper body) |
| LOWER BODY AUTO | (Focused massage on the lower body) |

Press to select.

OPERATION

Manual Programs

Press  (Menu button) and scroll down to the Manual option.

Press the OK button to select.

Press Up or Down arrow keys to choose your desired massage mode.

Press the Right arrow key to select and move on to the next menu.

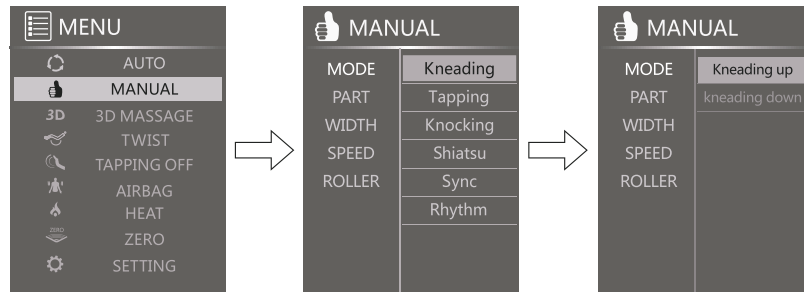

MODE

Under the Mode function, press Up or Down arrow keys to choose between Kneading, Tapping, Knocking, Shiatsu, Sync or Rhythm.

KNEADING

Select Kneading and press the OK button. Press the Up or Down keys to choose between Kneading Up or Kneading Down.

PART

Under the Part function, press the Right arrow key first, then press the Up or Down arrow keys to highlight the specific part of the body you wish to massage.

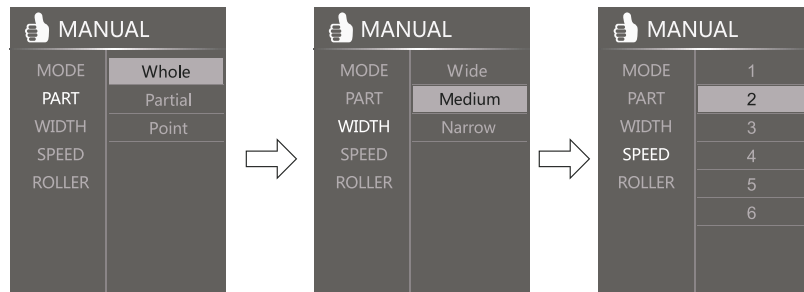

WIDTH

Under the Width function, press the Right arrow key first, then press the Up or Down arrow keys to highlight your desired width of the massage rollers.

SPEED

Under the Speed function, press the Right arrow key first, then press the Up or Down arrow keys to choose your desired massage speed.

SETUP

- ▶ After the left armrest has been assembled, repeat the same process to attach the right armrest.

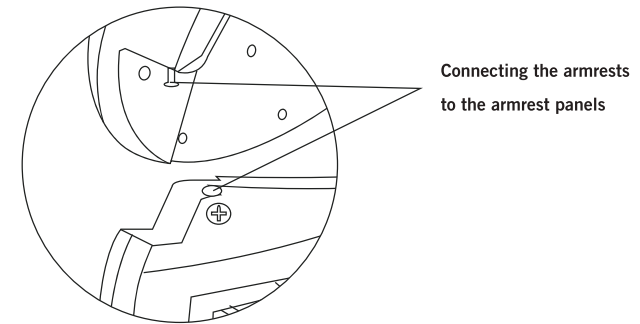

- ▶ To lock the armrest in place, you must connect it to the backrest. Hold up the rear part of the armrest, push inward to let the armrest lock into the armrest spindle. Then push the armrest to fasten them together.
- ▶ To unlock, push down on the lock lever to release the armrest from the backrest.

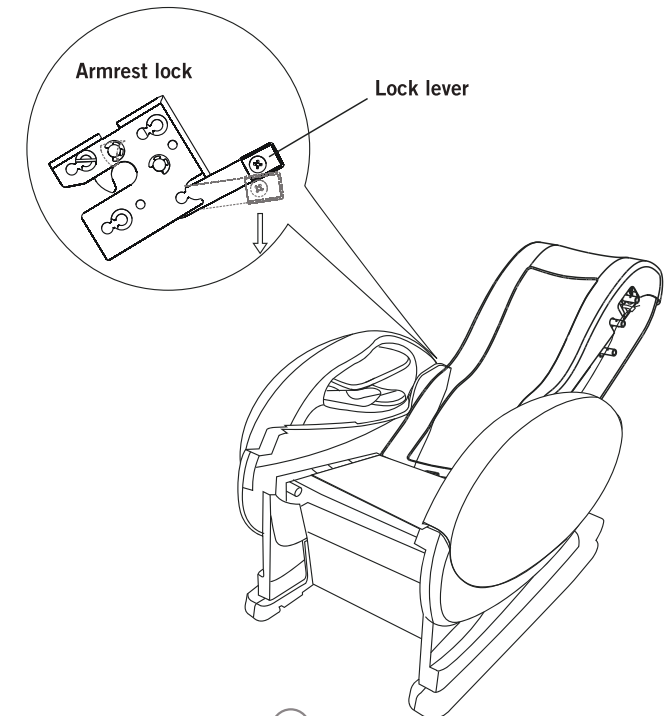

▶ SETUP

INSTALLATION

- Carefully lift the chair and all its parts from their packaging. Remove any protective wrapping. Locate the packing list. Check to make sure that all parts are present.
- Connecting the Armrests
 - ▶ Locate the two holes at the base of the left armrest.
 - ▶ Locate two identical screws, whose top, side, and inverted views are shown below:

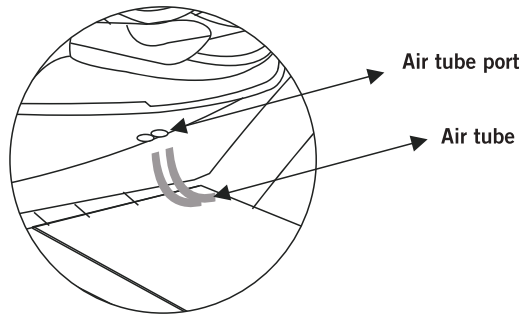

- ▶ Fit the two connection sticks into the two mounting holes. Turn each camlock clockwise until fully tightened.

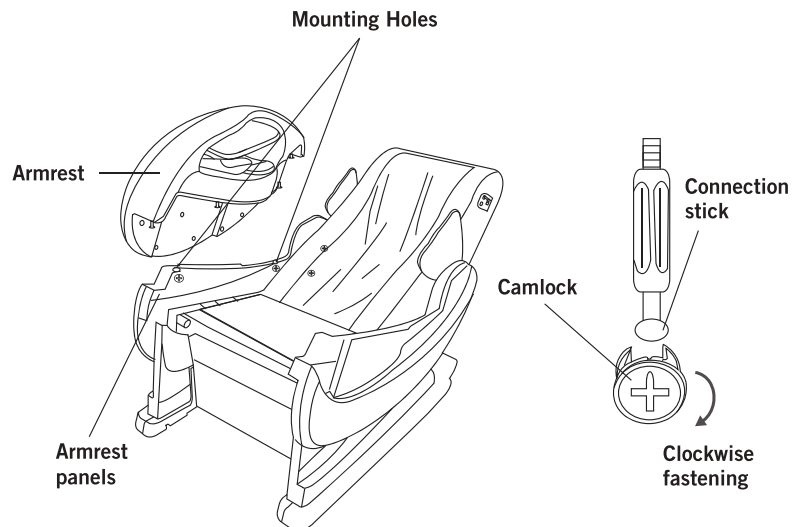

▶ OPERATION

| MANUAL | |
|--------|-----|
| MODE | 1 |
| PART | 2 |
| WIDTH | 3 |
| SPEED | Off |
| ROLLER | |

ROLLER

Press the Menu button first. Under the Manual mode, select the Roller function. Press Up or Down arrow keys to choose your foot roller speed or turn off.

3D MESSAGE

Press the Menu button first. Under the 3D Massage, press Up or Down arrow keys to choose between Deep Shiatsu, Breathe, or Revive. Press the Left arrow key to get back and choose your desired Force and Part.

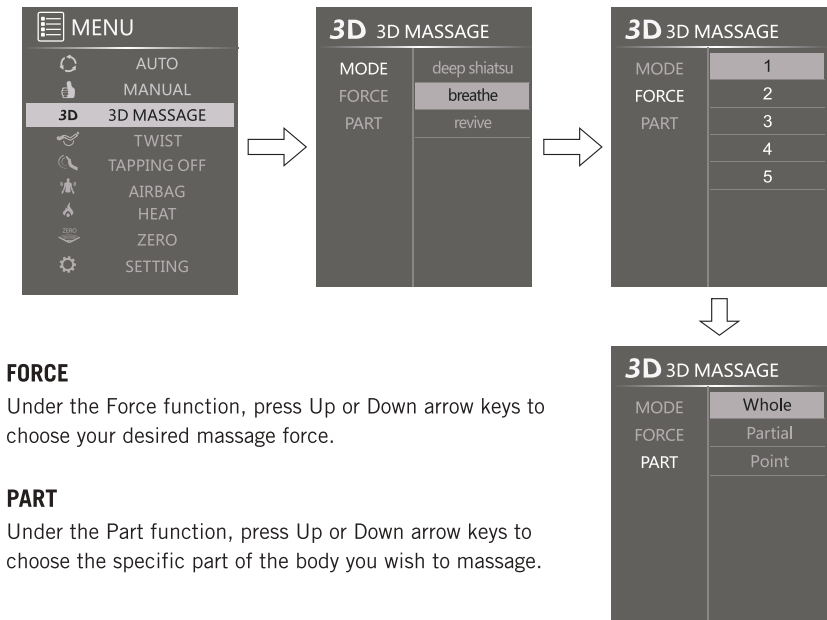

FORCE

Under the Force function, press Up or Down arrow keys to choose your desired massage force.

PART

Under the Part function, press Up or Down arrow keys to choose the specific part of the body you wish to massage.

▶ OPERATION

TWIST

Press the Menu button first. Under the Twist mode, press Up or Down arrow keys to choose your seat twist speed or turn off.

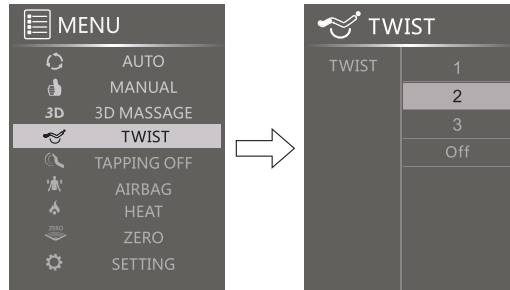

TAPPING OFF

Press the Menu button first. To turn off the Tapping massage, press the Down key to turn off the tapping, and press the Right arrow key.

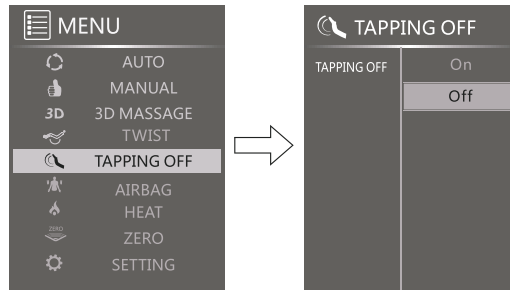

AIRBAG

Press the Menu button first. Under the Airbag mode, Press the Up or Down arrow keys to choose your desired Part and Force.

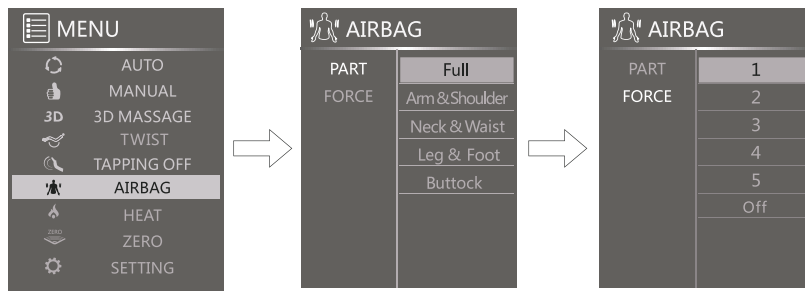

PART

Under the Part function, press Up or Down arrow keys to choose the specific part of the body you wish to massage.

FORCE

Under the Force function, press Up or Down arrow keys to choose your desired massage force or turn off.

▶ SETUP

GROUNDING INSTRUCTIONS

This product must be grounded. If it should malfunction or break down, grounding provides a path of least resistance for electric current to reduce the risk of electric shock. This product is equipped with a cord having an equipment-grounding conductor and a grounding plug. The plug must be plugged into an appropriate outlet that is properly installed and grounded in accordance with all local codes and ordinances.

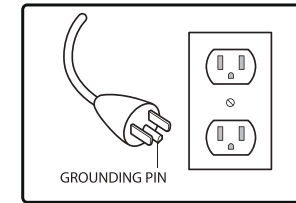

⚠ DANGER

- ▶ Improper connection of the equipment-grounding conductor can result in a risk of electric shock. Check with a qualified electrician or serviceman if you are in doubt as to whether the product is properly grounded. Do not modify the plug provided with the product – if it will not fit the outlet, have a proper outlet installed by a qualified electrician.
- ▶ This product is for use on a nominal 120-volt circuit and has a grounding plug that looks like the plug illustrated. Make sure that the product is connected to an outlet having the same configuration as the plug. No adapter should be used with this product.

▶ SETUP

MASSAGE CHAIR PLACEMENT

When looking for a location to place your massage chair, keep following in mind:

- ▶ The chair takes up significantly more space when stretched out, than when in an upright position. With the chair upright, allow at least 20 inches of open space behind the backrest, and at least 16 inches of space in front of the footrest.
- ▶ To prevent wearing out the floor beneath the chair, we advise placing some cushioning material, such as a rug or plastic mat, underneath the chair.
- ▶ To prevent possible electrical leakage, do not place the massage chair in or near a damp environment, such as a bathroom.
- ▶ To prevent fire or damage to its leather material, keep the massage chair away from any sources of heat (such as a stove or furnace).

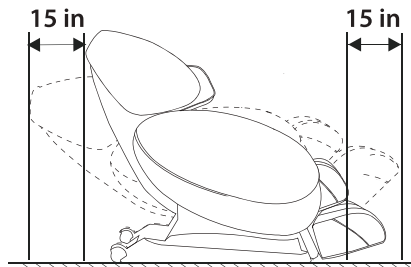

WHERE TO USE THE UNIT

- ▶ Ensure adequate space to recline.
- ▶ Do not expose the massage lounger to direct sunlight or high temperatures, such as in front of heating sources, because this can cause discoloration or hardening of the synthetic leather.
- ▶ Place the unit on a mat to prevent floor damage.
- ▶ When placing a mat under the unit, The size of the mat should be sufficient [At least 19.69 in. × 15.75 in. (50 cm × 40 cm)] to cover the areas where the unit touches and where the leg rest could touch the floor, as shown in the diagram on the right.
- ▶ Install the unit near a power socket.

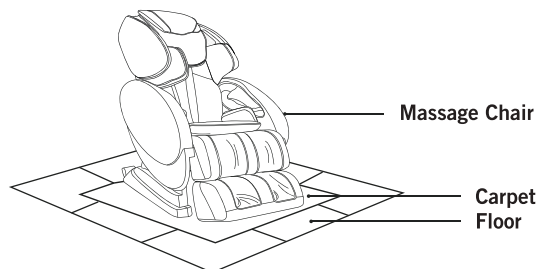

▶ OPERATION

HEAT

To turn on or off the unit's Heat function:

Press the Menu button first. Press the Up or Down arrow keys to highlight On or Off.

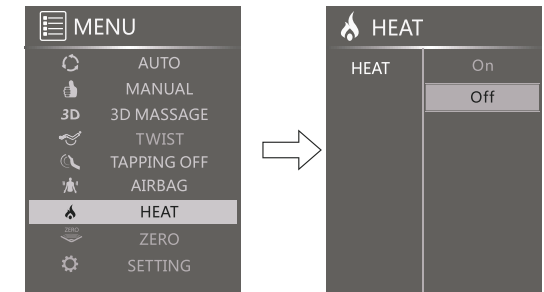

ZERO GRAVITY

To place your body into the Zero Gravity position:

Press the Menu button first. Under the Zero Gravity option, press Up or Down arrow keys to choose between position 1 and position 2. Select Off to return the chair to its initial position.

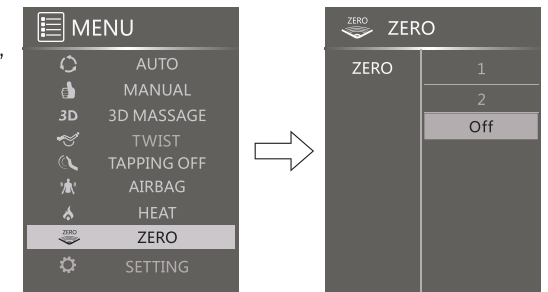

SETTING

Under Setting, press Up or Down arrow keys to choose Time, Language, or Bluetooth.

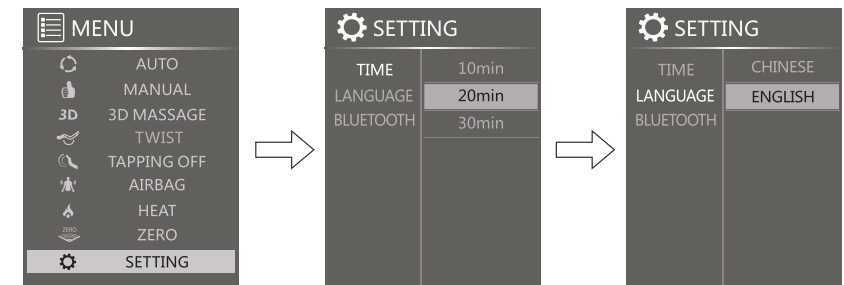

TIME

Press Up or Down keys to select your desired length of time for each massage: 10, 20, or 30 minutes. Press the OK button to select.

LANGUAGE

Press Up or Down keys to select your desired language to appear on the display screen.

OPERATION

BLUETOOTH

With Bluetooth highlighted, press Up or Down keys to turn On or Off Bluetooth connection.

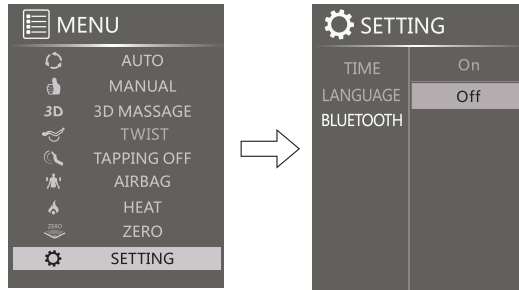

Notes:

1. Upon making any selections within the Automatic or Manual Mode menus, after 10 seconds of inactivity, the display screen will return to the home page.

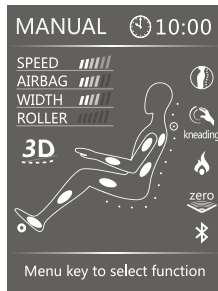

Home Page in Manual Mode

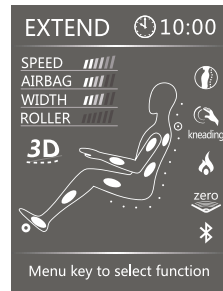

Home Page in Automatic Mode

2. With the exception of the “Lower Auto” option, each automatic program will begin with the movement of massage nodes along the backrest, in order to pinpoint the user’s shoulder position

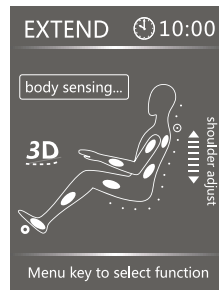

CAUTION

- ▶ To avoid possible damage, keep water and other liquids away from the controller.
- ▶ Do not crush the controller or power cord under any heavy object.

FEATURES

3D MESSAGE MECHANISM

- ▶ Innovative 3D massage mechanism adds an extra plane of movement to simulate a human massage therapist. The 3D rollers precisely follows the contours of your body.

SUPERIOR MESSAGE EXPERIENCE

- ▶ S-shaped massage track
- ▶ Total choice of 6 massage speeds and 3 massage intensities
- ▶ Automatic and manual modes
- ▶ Upper and lower airbags for a full-body massage
- ▶ Additional airbags target the neck, shoulders, and seat

CUSTOMIZED FOOT AND LEG MESSAGE

- ▶ Triple reflexology rollers
- ▶ Undulating airbag massage
- ▶ Adjustable foot extension with ankle grip
- ▶ Removable foot pads

SPECIAL FEATURES

- ▶ Two zero gravity positions
- ▶ Bluetooth audio connection
- ▶ Soothing heat option
- ▶ Twist-seat massage option
- ▶ Inversion stretch option
- ▶ Surround sound speaker system

AUTOMATIC MESSAGE PROGRAMS

- ▶ **RECOVER:** This program is ideal for alleviating muscle tension and soreness after a workout. The chair tilts your body into a zero-gravity position, while airbags tilt your hips from side to side and apply a squeezing massage to your calves. Massage nodules relieve overworked muscles along your entire back.
- ▶ **REFRESH:** This program includes a stretch massage. An invigorating program to warm up muscles and stimulate circulation. While airbags tilt your hips from side to side, a combination of rapid rolling and pummeling actions are applied to your entire back. The faster speed of the foot rollers add a reflexology treatment to your experience.
- ▶ **EXTEND:** This program features an inversion stretch on the lower back to release back tension and improve flexibility. The chair places your body into an inverted position. While airbags hold the shoulders and upper body in place, the legrest lowers to bend your knees downward and stretch your lower back. In this position, massage rollers apply kneading actions along your entire back, between the shoulders and the hips
- ▶ **RELAX:** This program includes a pillow air pressure massage. A light massage program designed for relaxation and stress relief. After placing your body into a reclined position, rapid pounding and squeezing actions target your entire back, even as your hips are tilted from side to side. A light airbag massage targets your calves, while a rolling massage stimulates your footsoles.