

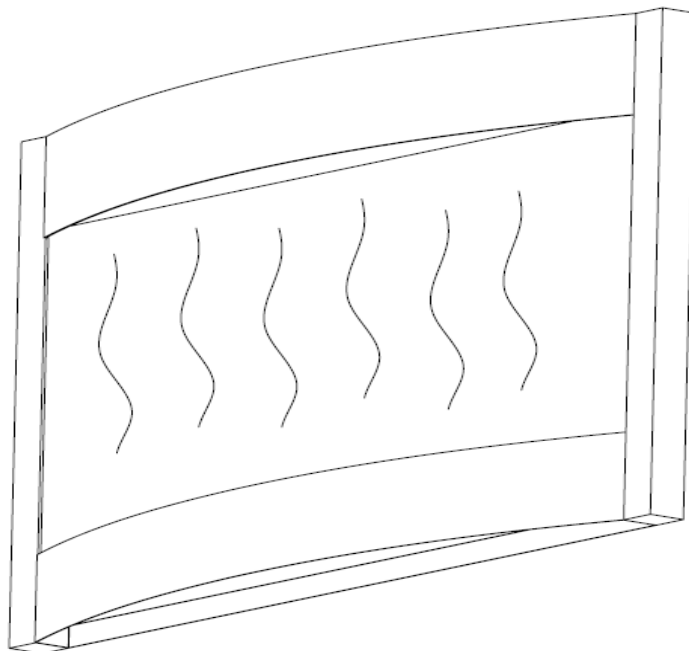

The Contempo™ Series

IMPORTANT – RETAIN FOR FUTURE REFERENCE – READ CAREFULLY

1. Please check the contents of the boxes before attempting to assemble this product. A full checklist of parts is in this instruction booklet. Check it very carefully. In the unlikely event that any components are damaged or missing, please contact our customer service hotline at **407-426-7674**.
2. **Assemble as near as possible to the point of use. Take extreme care when lifting to avoid personal injury or damage to the product.**
3. This product contains small items and plastic bags. Please be aware of the danger to young children.
4. A Pencil, Phillips Screwdriver, Level, and a Measuring Tape will be required for installation.



ASSEMBLY INSTRUCTIONS

Identification of Components



**A. Pump
(Inside Reservoir)**

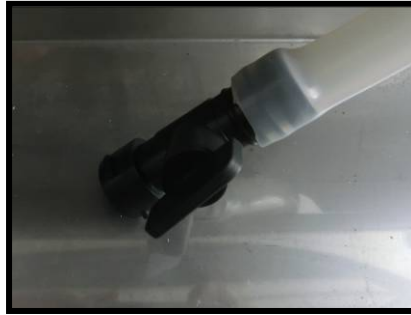

**B. Flow Control Valve
(Inside Reservoir)**

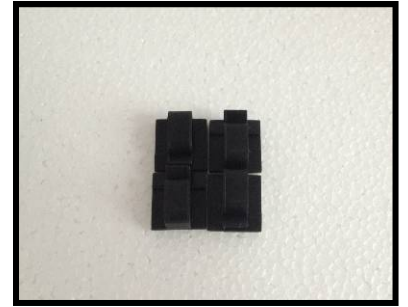

C. Wire Clips



D. LED Light Fixture



E. EZ Anchor™



F. Reservoir Tray



G. Wall Spacer Pad



H. Wall Bracket



I. Water Guiding Pad

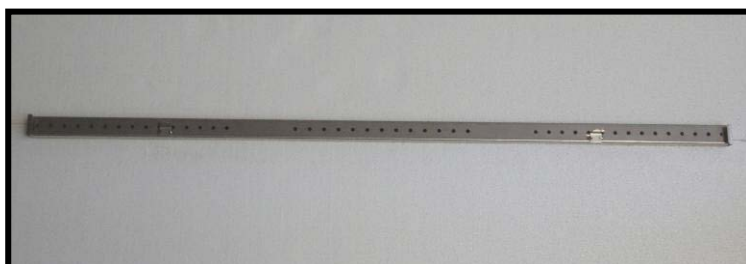

J. Water Diffuser

NOTES ON POSITIONING YOUR FOUNTAIN

- a. Try to position your fountain near an electrical outlet. We recommend using a GFCI outlet. The fountain should not be used outdoors with the transformer provided. Should you wish to use outdoors, a pump with an outdoor rated transformer or A/C pump rated for outdoor use will be needed.
- b. When considering the location of your fountain, please consider making it easily accessible for maintenance (e.g. adding water, cleaning, etc.)
- c. Consider the surface on which your waterfall will be placed. This feature can be mounted on sheetrock with wood or metal studs and can be mounted on tile or concrete. Due to the light weight nature of this fountain, it is not necessary to mount into studs but you **MUST** use EZ Anchors for any screw that does not hit a stud.
- d. Mount indoors only. It is not recommended to place Powder Coat models in direct sunlight.
- e. **** It is critical that your waterfall is level, as this will ensure even water flow. ****

Section 1 - Initial Prepping

Step 1.1 Remove Contempo™ Fountain from its shipping carton.

Step 1.2 Adhere the Wall Spacer Pad (G) to the back of the unit as shown in Fig 1.2 A- 1.2 B below.



Fig 1.2 A - 1.2 B

Section 2 – Pump Installation

Step 2.1 Locate the Water Pump (A). Place it into the reservoir and run the power cord through the notch behind the fountain as shown in the picture to the right.



Fig 2.1A

Step 2.2 Push the Flow Control Valve (B) into the Water Pump (A) output port as shown in Fig 2.2 A & 2.2 B.



Fig 2.2 A- 2.2 B

Section 3 –Water Diffuser Installation

Step 3.1 Place the Water Diffuser (J) into the water channel at the top of the fountain as shown below.



Fig 3.1 A – 3.1 B

Section 4 – Light Installation

Step 4.1 Locate the LED Light Fixture (D) and install it into the header as shown in 4.1A. The tabs need to slide into the hem of the header as shown in Fig 4.1 B and 4.1 C.



Fig 4.1 A

Fig 4.1 B

Fig 4.1 C

Step 4.2 Connect the power cord from the LED Light Fixture (D) as shown in Fig 4.2 A.

Step 4.3 Adhere the Wire Clips (C) to the back of the fountain to neatly run the LED Light Fixture (D) power cord down and behind the water feature as shown in Fig 4.3 A.

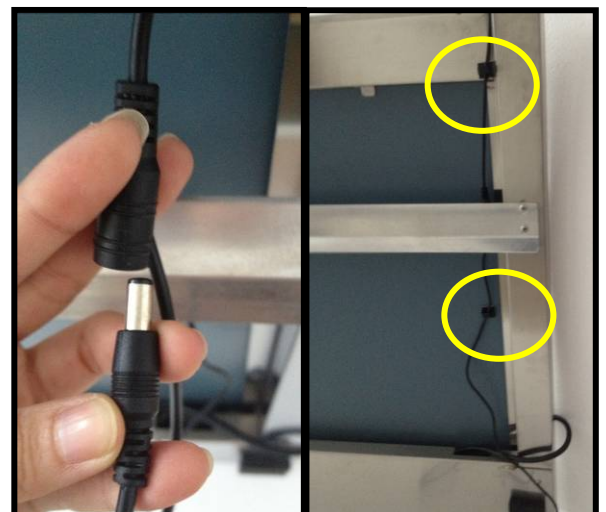

Fig 4.2 A

Fig 4.3 A

Section 5 – Mounting the Water Feature

- Step 5.1 Locate your level and draw a line on the wall indicating the top of the waterfall. Measure down from that line down, approximately 8 $\frac{3}{4}$ ", and draw another line to indicate the center of the Wall Bracket (H). Using a level, hold the Wall Bracket (H) to the wall with the top angled towards you. Mark both mounting holes on the wall. Remember to double-check your measurements. See illustrations below.



Fig 5.1 A – 5.1 C

- Step 5.2 To install the EZ Anchors™ (E), gently tap or press the tip into the drywall and slowly screw the anchors into the wall as shown in Fig 5.2 A. Make sure the flat side of the anchor is flush with the wall. Do not over-tighten the anchors as this will render them ineffective and damage the drywall. If you encounter a wall stud while installing an EZ Anchor™ (E), use the mounting screw without the anchor as shown in Fig 5.3 A. We only suggest using the provided EZ Anchors™ since each one has a weight capacity of up to 50 pounds. Plastic anchors are not an acceptable substitute.
- Step 5.3 Install the Wall Bracket (H) using the three 1" screws provided. A correctly installed Wall Bracket (H) is illustrated in Fig 5.3 B



Fig 5.2 A



Fig 5.3 A



Fig 5.3 B

Section 6 – Operating your Fountain

- Step 6.1 Unwind the Water Pump (A) and LED Light Fixture (D) power cords then run the cord for the light up and over the back of the reservoir from behind the mirror. The cord for the LED Light Fixture (D) should be behind the bracket and sitting in the cut out at the top of the fountain.

Step 6.2 Lift your waterfall into place and engage the bracket on the back of the fountain by lowering it onto the Wall Bracket (H) as shown in Fig 6.2 A - 6.2 B. THIS STEP NEEDS TWO PEOPLE TO COMPLETE.



Fig 6.2 A – 6.2 B

Step 6.3 After mounting your fountain to the wall, fill the reservoir with water. The water level must be maintained at least $\frac{1}{4}$ " above the Water Pump (A). If the water level drops below the Water Pump (A), damage may occur and your warranty will be voided.

Step 6.4 You can now plug in your Water Pump (A) and LED Light Fixture (D) into your designated electrical outlet.

Step 6.5 If necessary; slowly open the Flow Valve (B) to achieve a nice water flow. As water begins to flow down the panel, you can guide the water using the provided Water Guiding Pad (I) to ensure that water flows down the entire face of the panel evenly as shown in Fig 6.5. (Tip: Make sure when guiding the water with the Water Guiding Pad (I) that your elbow is facing upward while guiding and spreading the water across the panel during start-up. This will prevent water from running down your arm).

Step 6.6 Place Reservoir Tray in base as shown in Fig 6.6 A - 6.6 B.



Fig 6.6 A – 6.6 B

Warranty

Bluworld product is warranted against defects that render it unfit for its reasonably intended use. This Warranty is not extended to cover use of the product for a purpose other than as intended, and if the product is used unreasonably, or for purposes other than as intended, or if it is altered, modified or repaired by a party other than Bluworld, then the Warranty shall be null and void. The Warranty is in effect for a period of six months beginning from the date of sale to the original retail purchaser and the rights under this Warranty are limited to the original retail purchaser. Bluworld will, upon written notification thereof, take commercially reasonable steps to correct such defects (see "manufacturers defects below"), at Bluworld's sole option, by suitable repair, replacement, or refund. Bluworld will not be responsible for the installation, labor or any other costs or expenses related to the re-installation of a warranted part, and such expenses are not covered by this warranty. THIS LIMITED WARRANTY IS EXCLUSIVE AND IN LIEU OF ANY IMPLIED WARRANTY OF MERCHANTABILITY, FITNESS FOR A PARTICULAR PURPOSE, OR OTHER WARRANTY OF QUALITY, WHETHER EXPRESS OR IMPLIED, EXCEPT FOR THE WARRANTY OF TITLE AGAINST PATENT INFRINGEMENT. Corrections of nonconformities, in the manner and for the period of time provided above, shall constitute fulfillment of all liabilities of Bluworld to any Dealer with respect to the goods, whether based on contract, negligence, and strict tort or otherwise. Bluworld contract sales personnel, including but not limited to authorized Dealers and Resellers (collectively, "Sales Personnel"), are not authorized to make warranties about Bluworld merchandise. ORAL STATEMENTS DO NOT CONSTITUTE WARRANTIES. Oral statements made by Bluworld employees or other Sales Personnel shall not be relied upon by a Dealer and shall not become part of any contract for sale. The entire sales contract between a Dealer and Bluworld will be set forth in the invoice and/or accompanying or reference documents provided by Bluworld to the Dealer or Sales Personnel. No other warranties are given beyond those set forth in those documents. Please be aware that you may have valuable rights under the state law in which you reside. Some of the provisions of this Warranty may be prohibited by your state law in which case your state law will govern and control. Some states do not allow the exclusion or limitation of incidental or consequential damages, so the above limitation or exclusion may not apply to you. Some states do not allow limitations on how long an implied warranty lasts, so the above limitations may not apply to you. This Warranty gives you specific legal rights, and you may also have other rights which vary from state to state.

Our products are warranted for a period of six months against defects in finish, pumps and other product performance issues. Light bulbs are not warranted. Our experience has shown that in practically 100% of incidents that any defect is apparent within a week of installation and use. Appearance defects should be noticed upon unpacking the fountain. We have found that finishes have 'failed' due to poor maintenance, local water conditions with minerals affecting the finish, attempts to clean with harsh chemicals or abrasive pads being used. Performance of water flow, spitting, and other 'leaks', are usually caused by debris getting into the fountain, buildup of minerals, algae from poor water or lack of maintenance. Pumps can also fail due to water levels not being maintained in the reservoir and this is not covered by the warranty.

Manufacturers Defect defined - A distinct and obvious flaw in the manufacturing of the product that inhibits the product's ability to function properly or a distinct and obvious flaw in the workmanship of the product that affects its physical appearance. Bluworld water features are manufactured under generally accepted manufacturing techniques as recognized by the International Organization of Standardization. Our products are hand made and hand finished thus minor scratches in materials within accepted ranges are not considered defects.

Slate- Many of our products contain natural slate. Slate can vary to a large degree and that individuality is what is considered to be unique and inherent to the beauty of the natural product as no two are exactly alike. Photos in our marketing materials are representative of our slate products but should not be relied on to duplicate the photo. We use natural mined slate in our products. Personal taste in the appearance of slate is not considered a reason for a return.