

## How to replace the ropes on your Subwing

The ropes mounted to your Subwing are designed to easily be removed and replaced within minutes. No tools are needed, but a pen or a similar shaped object will make it easier.

### Remove the plastic grommets:

Place the wing in a way so the bottom side of the grommet is not obstructed.

Place the tip of the pen right where the rope exits the grommet.



Grip firmly around the top of the pen and give it a solid tap with your other hand.

The grommet will pop put on the other side, if not, keep tapping until it does.

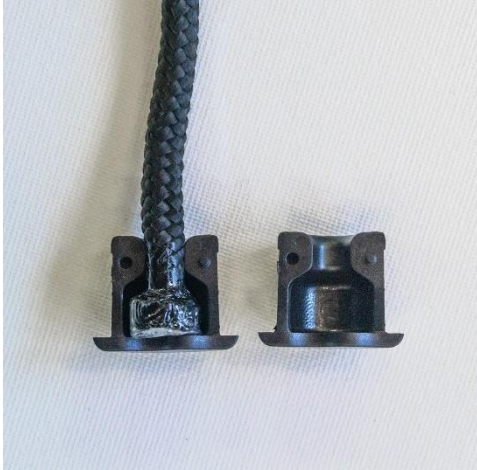

You'll see that the plastic grommets consist of two identical pieces with a cavity which anchors the rope-ends to the wings.

### Reassembly:

Before mounting the new rope to the wings, note that the rope-ends have different lengths. The long rope-ends shall be mounted furthest out on the wing tips and the short ones closest to the center.

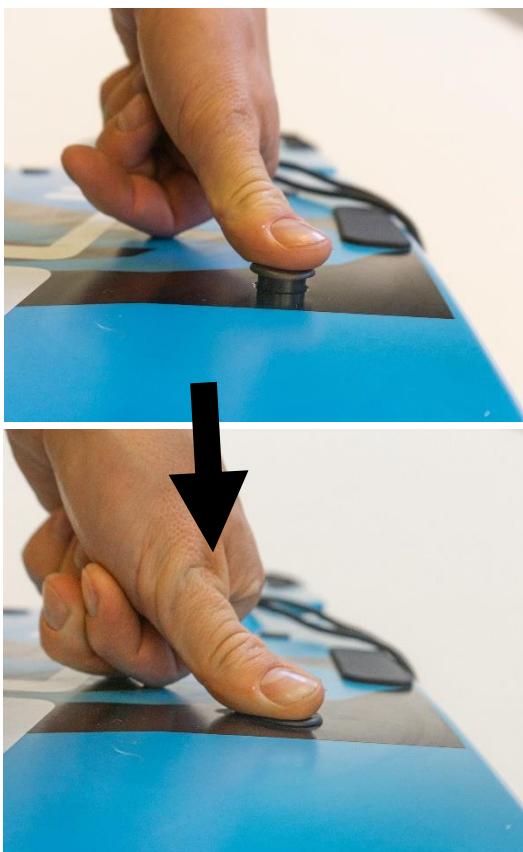

Reverse the process when installing the new rope.

Guide the ropes through the correct holes on the Subwing, place the grommets around the rope-ends and push them firmly into the holes.

Make sure to mount the ropes so they exit at the top side of the wings.

How to distinguish the top side from the bottom side:

- The large Subwing logo is located at the bottom side of the wings.
- The top side has the largest rubber grips. The top grips also have a small Subwing logo.

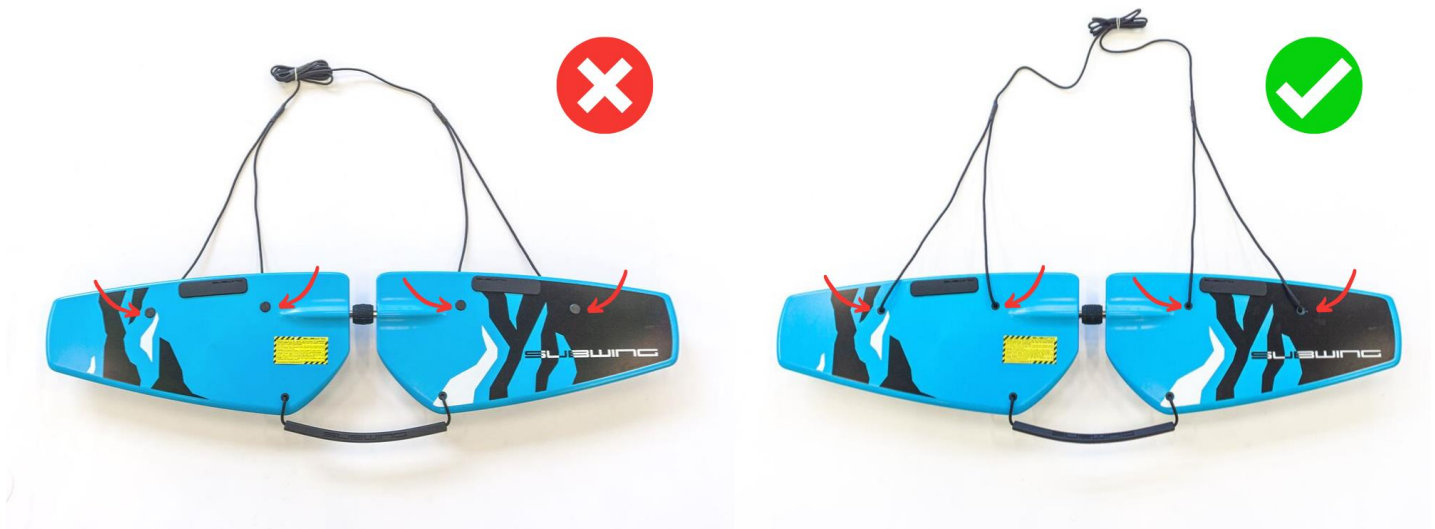

**Congratulations, you have now successfully replaced the rope on your Subwing!**