

Instructions for use



Cold Rush® Pad



Life Without Limitations®



.....	3
Ⓔ EN Instructions for use.....	8
Ⓕ FR Notice d'utilisation.....	10
Ⓖ ES Instrucciones para el uso.....	12

Ankle Pad

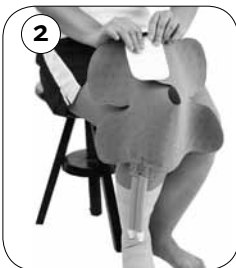

Hip Pad Left

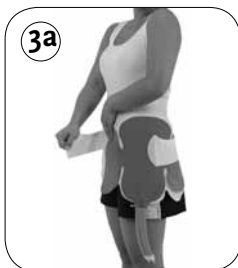

Hip Pad Right

1



2



3a



3b



4



Knee Pad

1



2



3a



3b



4



Lumbar Pad



Rectangular Pad

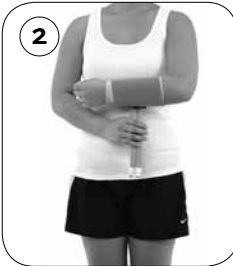
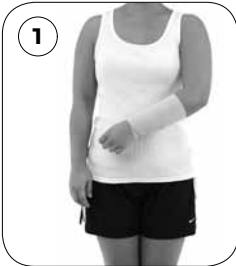

Shoulder Pad

1



2

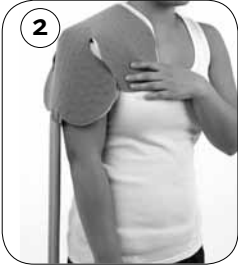

3a



3b

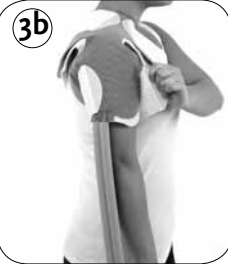

3c



4

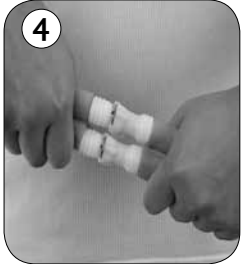

Universal Pad (Knee Application)

1



2



3a



3b



4



Universal Pad (Shoulder Application)

1



2

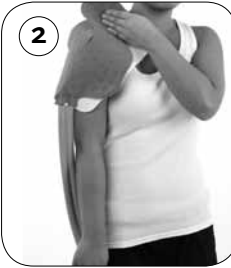

3a



3b



4



USES

- Cold Rush pads are for single patient use only
- Cold Rush pads are designed to reduce localized pain and swelling following surgical procedures or trauma.

WARNING

- READ THE FOLLOWING INSTRUCTIONS CAREFULLY BEFORE OPERATING THE COLD RUSH COLD THERAPY SYSTEM.
- The Cold Rush pad may become cold enough to cause serious injury to the skin. Correct temperature range for each patient's skin should be determined on an individual basis by a licensed healthcare practitioner. Patients vary in sensitivity to cold. Periodically monitor the temperature and appearance of the skin being treated once steady flow of water through the pad is achieved.
- The temperature at the surface of the skin may vary depending upon the amount of dressing used and other factors beyond the control of the manufacturer. Temperature and color of the skin at the treatment site must be monitored by a licensed healthcare practitioner.
- The Cold Rush Pad should never be applied directly to the patient's skin. Do not use the Cold Rush Cold Therapy System without first applying an insulation barrier between the Cold Rush Pad and the patient's skin.
- This Cold Rush pad is not sterile; do not apply over open or broken skin. To obtain an Ossur sterile pad, contact your healthcare professional.
- Care should be taken during use for children, diabetics, incapacitated patients and those with decreased skin sensitivity or poor blood circulation.
- If prescribed by a licensed healthcare practitioner for home use, the healthcare practitioner must provide each patient with guidance for use of the device. As well, the healthcare practitioner must monitor the patient's use of the device to assure appropriate use of the device and proper application of cold therapy.
- Use this product only for its intended use as described in this manual. Do not use attachments not recommended by the manufacturer.

FITTING INSTRUCTIONS

1. Remove Cold Rush Pad from packaging.
2. Inspect pad to make certain that it is free of defects.

*** For each pad shape - Figures 1-4 represent site specific pad configurations and anatomies.**

3. Apply insulation barrier over the patient's skin in the area to be treated. (Figure 1)
4. Apply Cold Rush Pad over insulation barrier, with the fabric facing up. Pad should never be applied directly to the patient's skin. (Figure 2)
5. Apply elastic straps over the Cold Rush Pad. Be sure not to wrap the pad too tightly as it may restrict blood flow or water circulation. (Figure 3)
6. Connect Cold Rush Pad to hose extending from the unit. To ensure proper connection, push couplings together until they snap into place. (Figure 4)
7. Follow operating instructions provided with your Cold Rush Therapy System.
8. When you are finished with your cold therapy treatment, turn the Cold Rush Cold Therapy System unit pump off and disconnect the pad from the hose couplings.
9. When you have finished all of your cold therapy treatments, discard the Cold Rush Pad. You may want to save the pad to use in cleaning your Cold Rush Cold Therapy System. (The Cold Rush Cold Therapy System Instructions For Use reviews this cleaning process in detail).

LIMITED WARRANTY

Ossur warrants, to the original purchaser, that this product is free from defects in materials and workmanship for 30 days from initial purchase. This warranty does not apply if this product (1) was not purchased from Ossur or its authorized dealer, (2) has been altered in any way, or (3) has not been used in accordance with Ossur's Instructions For Use (IFU). This Limited Warranty does not cover damage due to accidents, neglect, misuse, or operation beyond capacity, parts damaged by improper installation, substitution of parts not approved by Ossur, or any other alteration or repair by others that, in Ossur's judgment, materially or adversely affects the product or part.

For complete warranty guidelines please visit www.ossur.com

Caution: Federal law restricts this device to sale by or on the order of a physician.

SAVE THESE INSTRUCTIONS