

## CHARGING OTHER DEVICES

1. Plug the charging cable that you use for your device into your device
2. Connect the other end of the cable into the back USB device charging port on the Sumato WatchBox
3. The Sumato WatchBox will begin to charge your device.

## CHECKING REMAINING BATTERY

To check how much juice your Sumato WatchBox has remaining, press and hold the Power Button for 3 seconds.

See image for charging levels.



100-75%



74-50%



49-25%



25-0%

## TECHNICAL SPECIFICATIONS

	WatchBox	Pocket Charger
Battery type	2x 18650 lithium battery	Polymer cobalt lithium
Capacity	5000mAh	500mAh
Dimensions	92x92x46.8mm	48.1x37.5x17.9mm
Material	Aluminium alloy, PC	PC
Input	Micro USB, DC 5V/1A	Micro USB, DC 5V/500mA
Output	USB 2.0 DC 5V/1.5A (max)	Wireless Charging Module DC5V/500mA



APPLE WATCH WATCHBOX  
WITH BUILT-IN POWER BANK

**+ WIRELESS POCKET  
CHARGER**

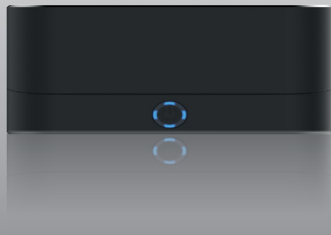

## KNOW YOUR WATCHBOX

1. Wireless pocket charger
2. Power button / battery indicator
3. Pocket charger battery indicator
4. Pocket charger power button
5. Device charging port (USB)
6. WatchBox charging port (micro-USB)
7. Micro USB cable

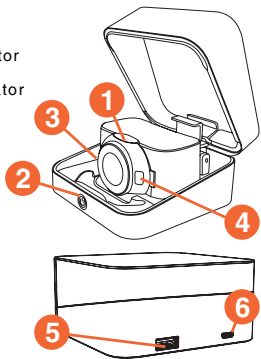

## CHARGING YOUR WATCHBOX

1. Connect micro usb cable into WatchBox charging port.
2. Connect cable to power source (USB power adapter, laptop, computer, TV etc.)
3. The battery indicator will light up blue and turn off after 30 seconds. Your Sumato WatchBox is now charging
4. When fully charged the battery indicator will turn solid blue and then switch off.

## CHARGING POCKET CHARGER

1. Ensure Pocket charger is inside WatchBox with the 4 magnetic pins touching.
2. Connect micro USB cable into WatchBox charging port.
3. Connect cable to power source (USB power adapter, laptop, computer, TV etc.)
4. Pocket charger battery indicator will flash red. Your Pocket charger is now charging.
5. When fully charged the Pocket charger battery indicator will turn solid red and switch off.

## CHARGING APPLE WATCH

### METHOD 1 (USING POCKET CHARGER)

1. Place the Apple watch onto the pocket charger
2. Press the pocket charger power button.
3. Your watch will begin to charge.

### METHOD 2 (WATCHBOX)

1. Ensure pocket charger is inside the Sumato WatchBox with the 4 magnetic pins touching.
2. Open the Sumato WatchBox
3. Press and hold the power button for 3 seconds to power on the Sumato WatchBox.
4. Press the power button on the pocket charger to turn it on.
5. Place the Apple watch into the WatchBox. The Apple watch will connect to the magnetic charging module.
6. Your watch will begin to charge