

IKEGGER

Any Drink, On Tap, Anywhere



CHEERS FOR CHOOSING US!

www.ikegger.eu

WELCOME TO IKEGGER

Welcome To The iKegger Family!

Thank you for choosing us for your recent purchase!

This company is very much a labour of love for a small group of friends working out of home offices, storage units and garages around the world. We love what we do and we believe that is apparent to all our customers from the great feedback we get from them.

As a small company each member wears many hats and we work huge numbers of hours each day to try and stay on top of everything.

We do our best to produce documentation, videos, manuals etc for all our products but sometimes we might use slightly different images than what you receive as we don't have time to go through and redo everything each time an o-ring changes colour or an adapter changes shape but still has the same function.

We are nearly always available on instant chat on the website, via email, facebook messenger and via phone during business hours if you have any questions.

The [iKegger Facebook Community](#) is also very active and full of friendly folks willing to help out newbies with any questions about gear, swap recipes, hint and tips.

IMPORTANT



We are a very small team who do everything you see and a lot you don't to provide great customer service, products, and information.

Please look through the info we have spent months putting together before contacting us with a problem.

This allows us to focus on providing great customer service to those that have an important question or issue rather than repeating information we have worked so hard to provide via downloads, printouts, and video tutorials.

If you think something is missing from your order or you have a warranty claim please take a pic of the issue or what you received then go to our website on your phone and enter the live chat.

There is an order lookup form at the top of it. This is the fastest way to get a result as it is prioritised over anything else in our inbox!

Contact and Social Media

 www.facebook.com/ikegger
[iKegger FB Group: facebook.com/groups/ikegger](https://www.facebook.com/groups/ikegger)

 www.youtube.com/c/ikegger
Subscribe to our channel to see the latest videos

 **australia** www.ikegger.com
new zealand www.ikegger.co.nz
europa www.ikegger.eu

 www.instagram.com/ikegger
Tag us when you're drinking with #iKegger and #ikegger_eu

 **Australia:** info@ikegger.com
Europe: info@ikegger.eu



IKEGGER

1ST TIME USING YOUR IKEGGER



Looking after your iKegger

CLEANING

- Wash your keg and all parts before using for the 1st time. You can just use very hot water, we recommend using sodium percarbonate as a deep cleaner. This will remove anything stuck to the internal surfaces of steel, plastic and lines. Use some no-rinse sanitiser like our phosphoric acid (or chemipro oxi) before each filling.

ASSEMBLY

- Screw the liquid disconnect to the cone-shaped piece of the shank adapter, ensure the ring part is held in place by it.
- Tighten the cone onto the disconnect by using the teeth in the tap as a lever.
- Once tight, align the spout of the tap with the base of the disconnect (where it attaches to the spear) and tighten the ring to hold it in place.
- Fill the keg with water till there is only 1L of air left.
- Cut the dip tube to the height of the keg and attach it to the base of the spear on the barb.
- Screw the spear into the keg.
- Put one gas bulb into the black plastic handle and screw it onto the gas inlet valve till you hear the gas inject into the keg.
- Lift the collar on the liquid disconnect and attach the tap setup to the spear in the same way as a garden hose.
- Pour a glass of water through the tap. Listen for any leaking gas, dribbles of water etc.
- If all is working then you are ready to fill your keg with coffee, cocktails etc and start pouring!

IMPORTANT

ALWAYS leave at least 800ml of space to fill with gas, so a 4 litre vessel can only be filled with 3.2 litres of cold brew coffee / cocktail mix. If you don't, all the gas will just immediately be vented out through the pressure release valve and be wasted.

PRESSURE: Check all the hexagonal nuts on the spear are tightened. They will loosen with normal use so get in the habit of checking every time you use it to prevent gas leaks.

SPARES: Your gear comes with all o-rings and seals in place, you don't need to add any. Any seals with your gear are spares we've included for free.

LUBRICATE: We recommend using a lubricant on all o-rings and posts to prolong their life and make connecting disconnects easier.

TAPS WILL DRIP liquid still in the body of the tap may take up to a minute or more to drip out (especially with a nitro tap) after you turn it off. Have a cloth or drip tray handy or use a tap sock drip catcher (on our shop).



IKEGGER Premium Flow Control Tap System

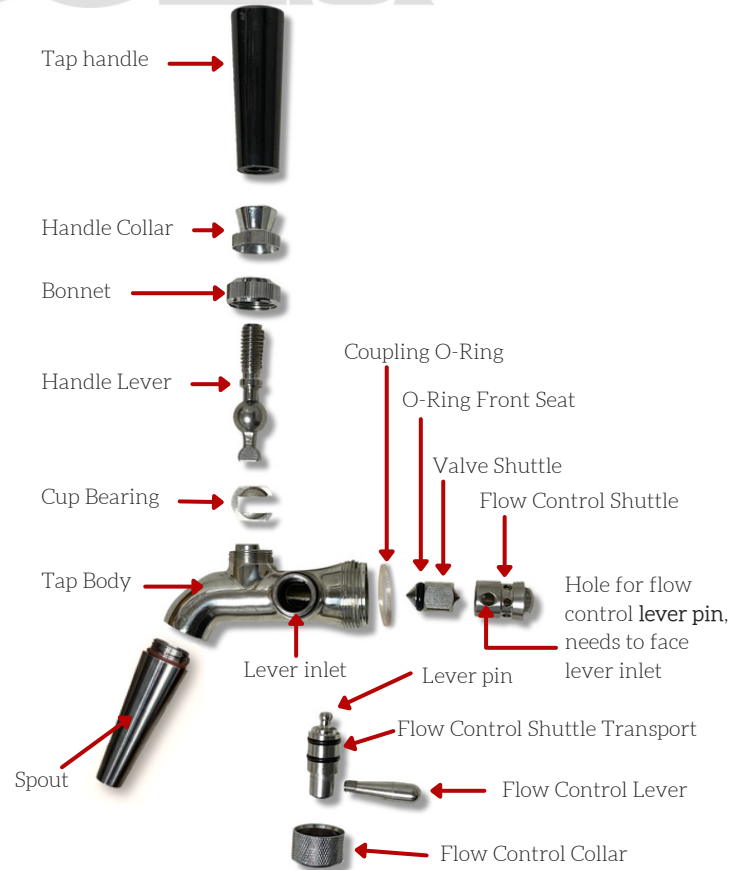
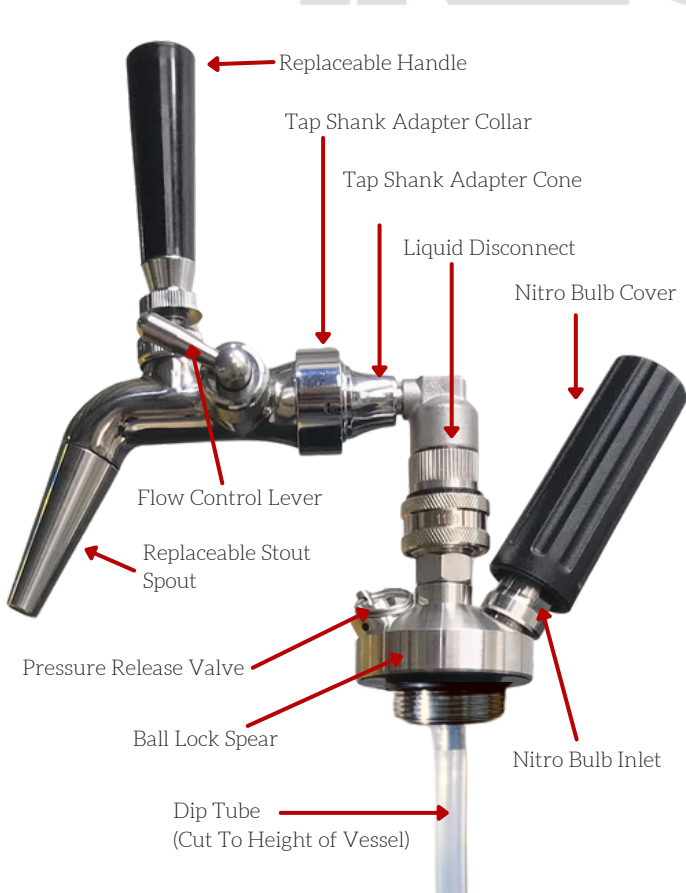

To Assemble

- Screw the tap shank adapter cone onto the black liquid disconnect (steel disconnect pictured, could be a black plastic one) with the tap shank adapter collar trapped by it.
- Interlock the teeth in the cone with those on the tap itself.
- Use the tap as a lever to tighten the cone onto the liquid disconnect.
- Un-interlock the teeth and line the tap spout up with the liquid disconnect base,
- Use the collar to lock the tap in this position, tighten firmly.
- Screw on the tap handle.
- Attach completed tap unit to liquid post of the keg (vertical post on the mini keg spear)
- The lever on the side of flow control taps is used to control how fast liquid comes out, adjust this as needed for a good pour.
- Inside the spout of the tap is a plastic holder, a metal restrictor plate with 5 holes and an o-ring holding them in place. If the flow stops with pressure still in keg, clean the disk as it is likely blocked.
- It is a good idea to disassemble and soak all parts in sodium percarbonate fairly regularly (fortnightly or so) as buildup inside the tap can affect taste.

IMPORTANT

If your FC Tap drips:

Cup Bearing:

If the cup bearing opening is facing the front of the tap (it is sitting on the handle lever), you won't be able to close the tap properly. Check that the opening is facing backwards.

Front Seat O-Ring:

Check the O-Ring on the Valve Shuttle, if it is damaged you'll need to replace it.

Flow Control Lever:

If the Flow Control lever pin is not properly aligned in the shuttle it might cause a leak. You should be able to turn the lever about 300°, if it turns more than that please make sure that the hole for the lever pin is facing out through the lever inlet and the pin is properly inserted.



Scan the QR code or enter the web address below to see an assembly video

youtu.be/f069tapGayk



IKEGGER Premium Stout Tap Systems

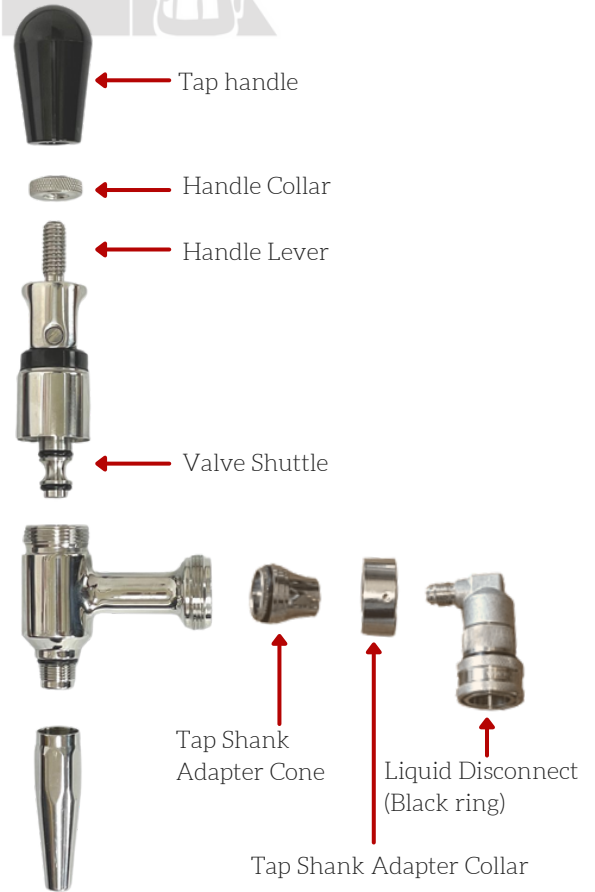

To Assemble

The Tap

- Screw the tap shank adapter cone onto the black liquid disconnect (steel disconnect pictured, could be a black plastic one) with the tap shank adapter collar trapped by it.
- Interlock the teeth in the cone with those on the tap itself.
- Use the tap as a lever to tighten the cone onto the liquid disconnect.
- Un-interlock the teeth and line the tap spout up with the liquid disconnect base,
- Use the collar to lock the tap in this position, tighten firmly.
- Screw on the tap handle.
- Attach completed tap unit to liquid post of the keg (vertical post on the mini keg spear)
- The Spout is pressure restricted to create a creamy pour. You can remove the O-ring, the plastic holder and the metal restrictor plate with 5 holes inside to use the tap with CO2 drinks. Or just use the tap without the spout.



IMPORTANT

If the flow stops with pressure still in keg, clean the restrictor plate as it is likely blocked.



IKEGGER Standard Steel Nitro Tap

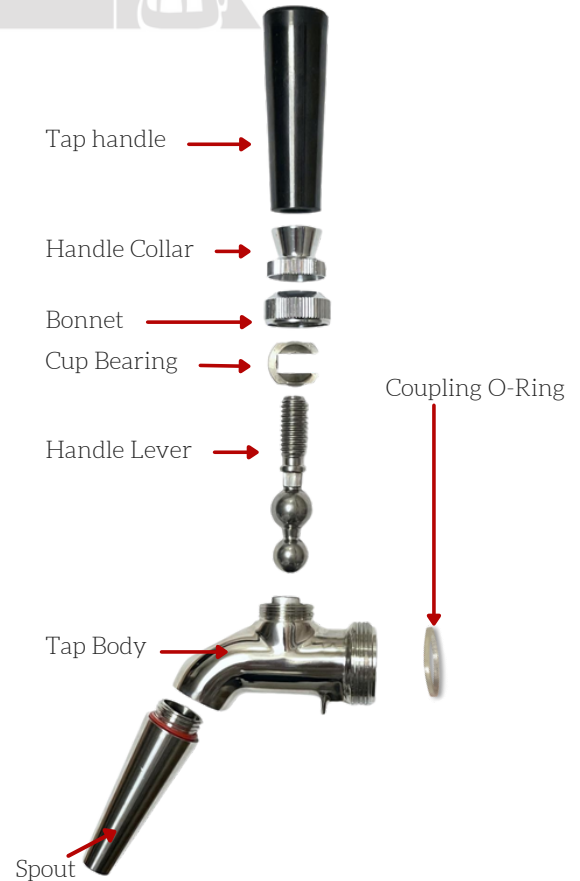

To Assemble

The Tap

- Screw the tap shank adapter cone onto the black liquid disconnect (steel disconnect pictured, could be a black plastic one) with the tap shank adapter collar trapped by it.
- Interlock the teeth in the cone with those on the tap itself.
- Use the tap as a lever to tighten the cone onto the liquid disconnect.
- Un-interlock the teeth and line the tap spout up with the liquid disconnect base,
- Use the collar to lock the tap in this position, tighten firmly.
- Screw on the tap handle.
- Attach completed tap unit to liquid post of the keg (vertical post on the mini keg spear).
- The spout is pressure restricted to create a creamy pour. You can remove the O-ring, the plastic holder and the metal restrictor plate with 5 holes inside to use the tap with CO2 drinks. Or just use the tap without the spout.



IMPORTANT

If the flow stops with pressure still in keg, clean the restrictor plate as it is likely blocked.

If the tap drips check that the cup bearing opening is facing the back of the tap (it's sitting on the handle lever). You won't be able to close the tap properly if it is facing the front.



IKEGGER

Nitro Bulb Injector Spear

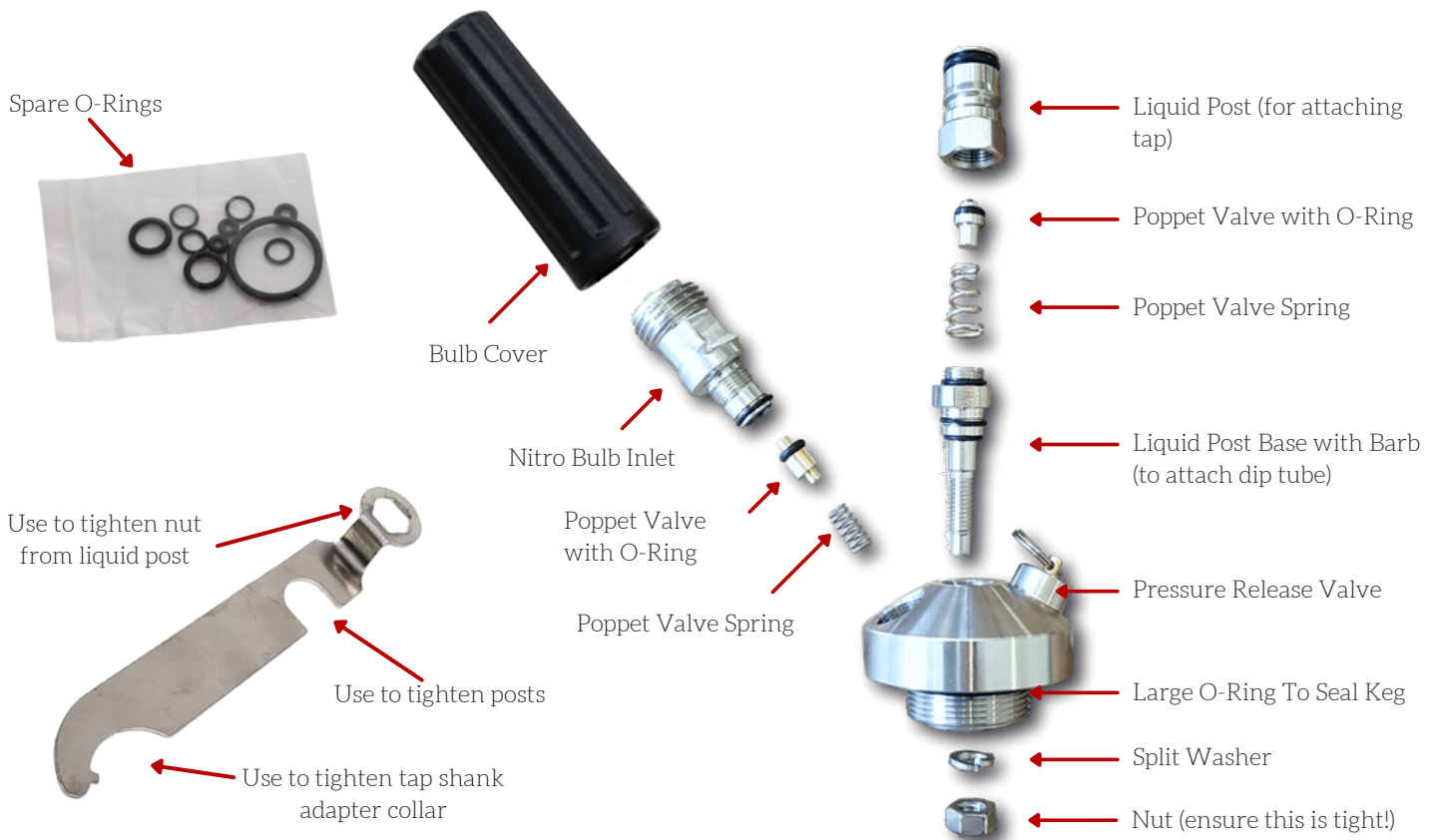

To Assemble

- **CUT DIP TUBE:** Make sure the flexible dip tube is cut to the height of the keg and securely attached to the barb on the base of the spear.
- Use the included tool to tighten all connections and components as these may arrive loose. You should check them regularly as they will work themselves loose.
- Lift the ring on the black disconnect and push the connection onto the central liquid post. Release the ring to lock the tap in place.
- It is normal for the tap to be able to spin around the post and feel a little wobbly, so long as there is no leak this is not an issue.
- After filling the vessel with COLD liquid, screw the keg spear into it (if using a growler insert the adapter first)
- Insert a bulb into the black gas bulb cover, having the mouth of the bulb pointing out. Screw the bulb cover with the bulb onto the nitro inlet until you hear the gas filling the keg.
- Let the keg rest in the fridge to absorb the gas or shake for 10-20 seconds before inserting another bulb. Rest or shake again. Once the release valve starts venting gas you can start pouring.
- How many bulbs you need depends on the type of gas, the temperature, how full your keg is and the size of the keg

Important

You must leave **at least 800ml of space** in your keg, so a 4 litre vessel can only be filled with 3.2 litres of cold brew coffee / cocktail mix. If you don't, the gas will just immediately be vented out through the pressure release valve and be wasted.

Spare O-rings are for replacing the ones on your spear in case they get damaged or wear down

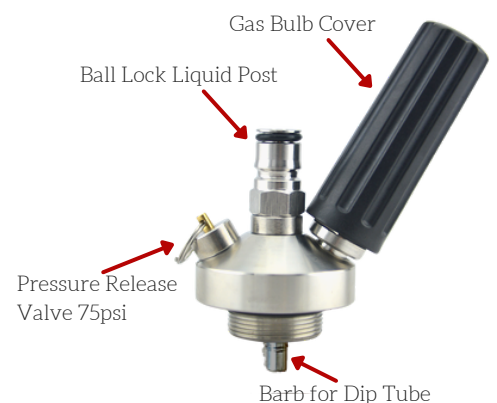

IKEGGER Disconnects

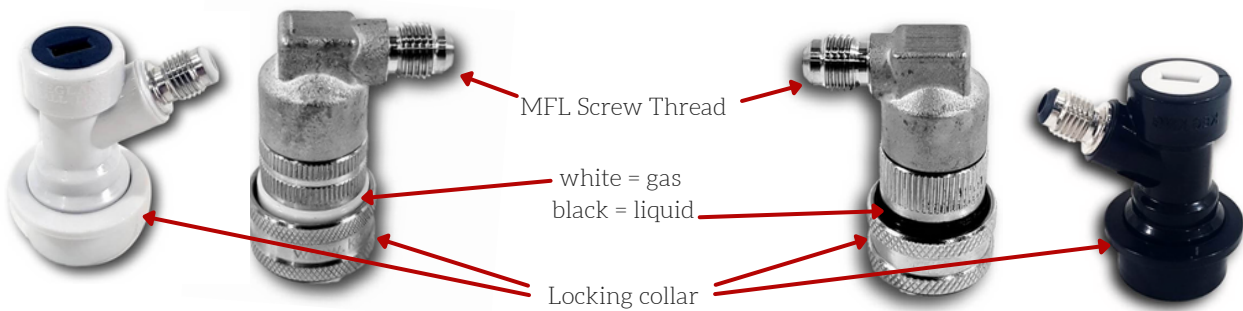

To Assemble

- The Disconnect attaches to the ball lock post like a garden hose, just lift the locking collar and push it firmly onto the post. There will still be some movement, even if the disconnect is attached properly
- To make it easier to connect a disconnect, use food safe lubricant on the ball lock posts. This will also extend the life of the o-rings.
- Make sure the top and bottom half of the steel disconnects are firmly screwed together to avoid leaks
- The steel disconnects are marked with rubber rings just above the locking collar: white for gas, black for liquid.
- You will only have gas disconnects if you use your system with a dual gauge regulator or have it set up to use with CO2 (replace the Nitro Inlet on the ball lock spear with a gas post to do this)
- The MFL screw thread fits FFL Duotight push fittings, which make it easier to connect and disconnect hose for cleaning purposes

IMPORTANT

If the disconnect **leaks in position 1**, make sure the olive is sitting in between the disconnect and the tap shank adapter. If it is, you need to tighten the cone of the tap shank adapter to the disconnect. Attach a tap to the tap shank adapter, make sure the teeth are interlocked and the collar is tightened. Now use the tap as a lever and tighten the tap shank adapter to the disconnect.

If it leaks in any of **position two**, you need to ensure that the top of the disconnect is properly tightened to the bottom half. If it is, please unscrew the top and check if the internal O-ring is sitting correctly and is undamaged.

Don't mix up gas & liquid posts! They might look similar but your disconnect will get stuck and won't work if attached to the wrong post!!



IKEGGER Nitrogen Regulator



To Assemble

- Push the Duotight hose firmly into the FFL Gas Outlet of the regulator.
- Place the nylon O-Ring in between the gas inlet and the M10 Adapter, use a spanner to tighten.
- Make sure the M10 Adapter is turned off, then screw onto the Nitrogen bottle.
- Clip the gas disconnect onto your keg, turn on the knob on the M10 Adapter and then turn on the Regulator.
- The Type 30 inlet can be replaced with a Type 50 for large commercial refillable Nitrogen Bottles.
- The knob on top of the adapter screws the pin down after connecting the gas bottle, so you never lose any gas while connecting and disconnecting the regulator.
- The Adapter comes with a spare set of o-rings and Allen key to replace damaged or worn out rings.

IMPORTANT

With a Nitrogen Regulator you do not need to leave 800ml of air space in the keg. You can fill it to capacity and the Nitrogen will still infuse.



IKEGGER

CO2 Conversion Kit

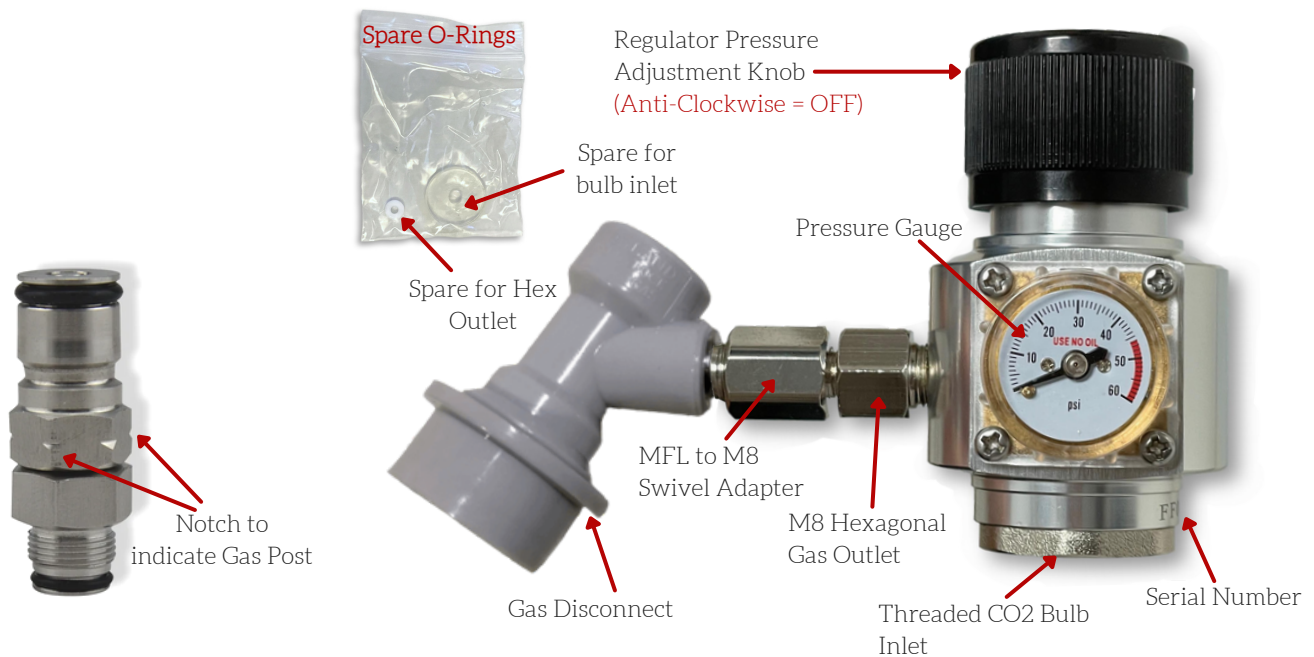

To Assemble

The CO2 Conversion Kit includes a Professional Mini Regulator with plastic disconnect, and a Gas Post for your Ball Lock Spear to replace the Nitro Inlet.

- Use the spear tool to unscrew the nitro inlet of your ball lock spear. Remove it.
- Screw the gas post into the ball lock spear, tighten it with the spear tool.
- Turn **OFF** the regulator (anti-clockwise all the way).
- Screw a 16g threaded CO2 bulb into the inlet gently until there is resistance.
- Complete screwing in with a firm twist to pierce the bulb.
- If gas escapes continue screwing in the bulb to seal it quickly, finger tight is fine, too hard will eventually damage the seal.
- To test, cover the hex outlet with your finger and turn up the pressure on the adjustment knob, the needle will rise.
- If you release your finger gas should escape, when you block the outlet again the needle should return to the same spot it was. If so the regulator is working perfectly.
- Screw the M8 swivel adapter onto the gas disconnect. **NOTE:** To remove it you need to keep these two parts together.
- Screw the regulator onto the swivel adapter. This allows you to adjust the angle of the regulator without breaking seal. **NOTE:** Always adjust the angle in a clockwise direction to maintain seal.
- Attach to the offset or gas post on your keg (notched at the base)

IMPORTANT

ALWAYS ensure regulator is turned off (all the way anti-clockwise) before adding gas. Not doing this will result in permanent damage, and voids the warranty.

DO NOT lay a keg down with a regulator attached without a check valve disconnect between the keg and regulator. Liquid can get into the regulator and ruin it.

AVOID using the regulator on it's side or upside down as CO2 is also stored in the bulbs / bottles as liquid and will enter the regulator

SLOW or zero flow of gas can just be you have screwed in the gas too tight. This squashes the seal, blocking the inlet. Try slightly unscrewing it.

Don't mix up gas & liquid posts! They might look similar but your disconnect will get stuck and won't work if attached to the wrong post!!

SPARES - Your regulator comes fully assembled, the O-rings are spares to replace the ones in your regulator once they have worn down



IKEGGER

What Drinks Can I make with Nitrogen?

There are countless drinks that can be infused with Nitrogen. The Nitrogen infusion process produces a rich, silky texture with a dense and creamy head. It's up to you how innovative you choose to be and what drinks you experiment with. Here are some ideas to get you started:



Espresso Martini

1l Martini Mix:

300ml Vodka
200ml Kahlua
500ml Cold Brew Concentrate or Espresso

Use nitrogen (N₂) for cascading bubbles or nitrous oxide (N₂O) for quicker results

Fill your keg with cold Martini mix, leave between 0.8l and 1l of space for the gas.

If using N₂O: Inject one bulb. Shake till you hear the sound become more "foamy" about 10-20 seconds. Inject one more bulb, shake for 5 seconds and start pouring.

If using N₂: Inject one bulb. Shake for about 10-20 seconds to dissolve the gas into the liquid. Inject another bulb and shake another 10-20 seconds. Rinse and repeat until gas escapes when injecting. Recommendation is to leave it to sit overnight in a fridge to infuse further into the drink, inject and shake once or twice before serving.



Stout Beer

Simply add your stout to the keg, carbonate and condition. When you're ready to serve, insert an N₂O bulb, give the keg a quick shake and enjoy beautifully creamy stout.



Nitro Cold Brew Coffee

Make a batch of cold brew coffee
Use filtered water (it tastes better)
Grind the coffee coarse (between filter & french press / plunger)
70g-100g coffee per l of water
For Cold brew concentrate use 200g per l of water

In a large container combine ground coffee and filtered water, let it sit for 18-24h at room temperature or in the fridge

Drain Coffee through a sieve to catch the coarse grounds and then pour through a filter.

Pour the coffee into your keg (leave at least 0.8l of space for nitrogen!)

Fill with nitrogen, let it infuse by shaking or resting the keg in the fridge. Nitrogen will give you a firmer head with smaller bubbles, while nitrous oxide will create larger bubbles and give a slightly sweet flavour.

Have you tried:

- Whisky Sour
- Matcha Tea
- (Fruit) Tea
- Cold Brew Lattes



Expand the Family

get your keg for every occasion



www.ikegger.eu