

ikegger

Nitrous Coffee & Cocktail System

Part 1 - The Tap

There are 3 possible taps with this package however all are attached the same way.



To Assemble

This tap system can be used on any of our vessels between 2L and 10L. Be sure the silicon sachet is removed from inside the keg and clean all parts with hot water, preferably sanitise them before using.

Note: An adapter needs to be used with the wide mouth 2L or 4L insulated growler, this is included if you purchase a package but needs to be bought separately if you buy a growler alone.

Part 1 - The Tap

1. Open package and lay out all included pieces.
2. Screw the cone shaped part of the tap shank adaptor to the black disconnect with the ring between the cone and the disconnect.
3. Lock the teeth inside the tap with the teeth on the cone and use the tap as a lever to tighten the cone firmly onto the disconnect.
4. Unmesh the teeth and line up the spout of the tap with the base of the black disconnect.
5. Tighten the ring to secure the tap in place, use the included tool (curved part with a notch) to tighten it.
6. Screw the tap handle onto the top of the tap.
7. Inside the spout of the tap is a plastic holder, a metal disk with 5 holes and an o-ring holding them in place. If flow stops with pressure still in keg, clean the disk as it is likely blocked. Remove all these parts to use the tap with carbonated drinks.

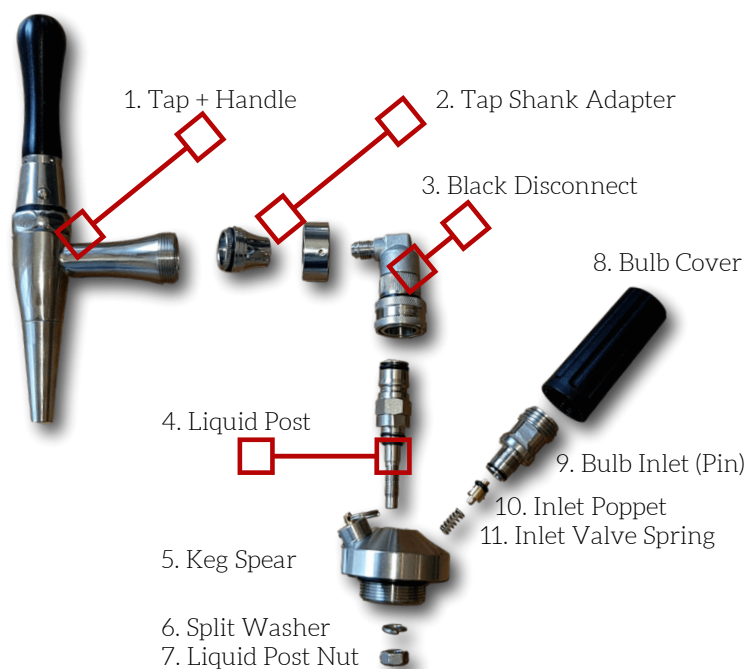

ikegger

Nitrous Coffee & Cocktail System

Part 2 - The Spears

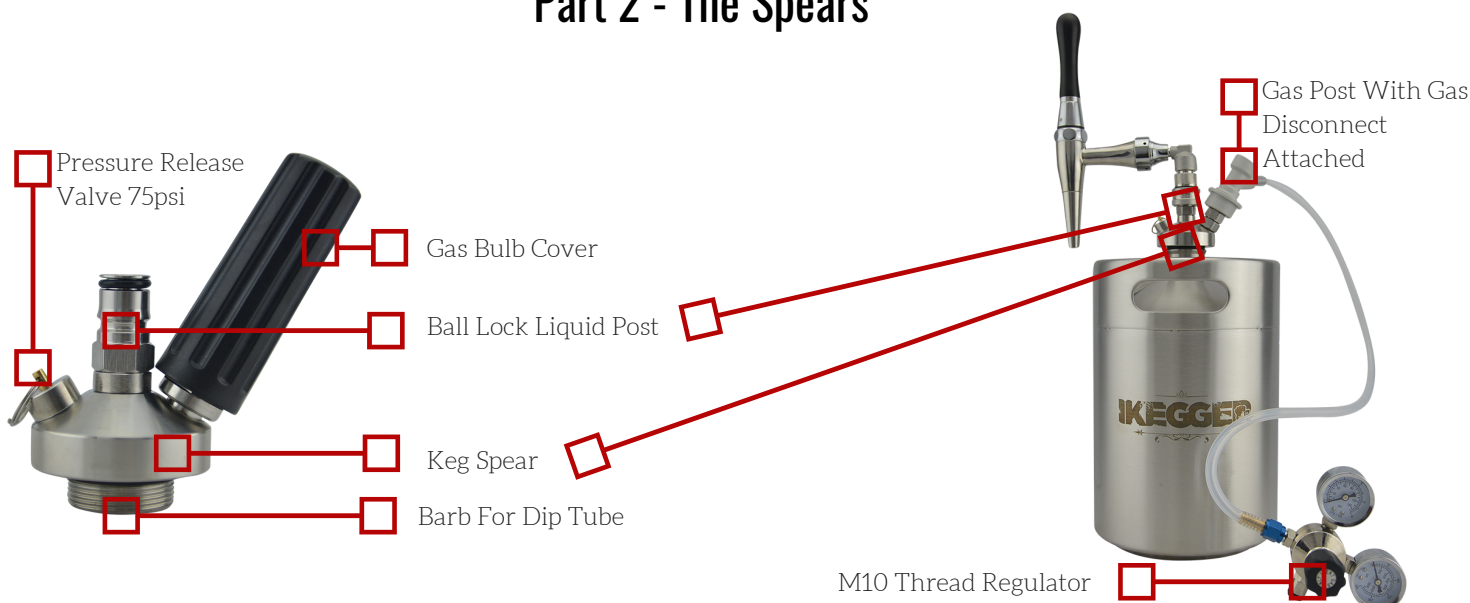

To Assemble

The Bulb Injector Spear

1. Cut the piece of flexible plastic tubing to slightly longer than your keg.
2. Attach it to the barb on the bottom of the keg spear.
3. Use the included tool to tighten all connections and components as these may arrive loose. You should check them regularly as they will work themselves loose.
4. Lift the ring on the black disconnect of Part 1 and push the connection onto the central liquid post. Release the ring to lock the tap in place.
5. It is normal for the tap to be able to spin around the post and feel a little wobbly, so long as there is no leak this is not an issue.
6. After filling the vessel with COLD coffee etc screw the keg spear into it (insert the adapter first if using a growler)
7. Insert bulb/s as outlined below and either rest to absorb gas or shake before pouring.

The Gas Post / M10 Regulator Spear

1. Cut one piece of flexible plastic tubing to slightly longer than your keg and attach it to the barb on the bottom of the keg spear.
2. Use the included tool to tighten all connections and components as these may arrive loose. You should check them regularly as they will work themselves loose.
3. Lift the ring on the black disconnect of the tap part and push the connection onto the central liquid post. Release the ring to lock the tap in place.
4. Use the same method to attach the grey disconnect from the regulator to the gas post.
5. Ensure your regulator is turned off (unscrewed all the way anti-clockwise) then screw a gas bottle into the socket on the base of the regulator.
6. After filling the vessel with COLD coffee etc screw the keg spear into it (insert the adapter first if using a growler).

ikegger

Nitrous Coffee & Cocktail System



To Use

*We recommend doing a test run with water first to check for leaks before filling it with your chosen beverage.
*You must leave approximately one litre of space to fill with gas, so a 4 litre vessel can only be filled with 3 litres of cold brew coffee / cocktail mix. If you don't all the gas will just immediately be vented out the pressure release valve and be wasted.

The Bulb Spear

1. Insert one 8g NO₂ or 2g N₂ bulb into the black gas bulk cover and tighten until the bulb pierces and gas flows into the keg.
2. Shake the keg to combine the liquid and gas. You will need to shake briefly for N₂O or more thoroughly for N₂
4. You may need to add more bulbs depending on the keg size and empty space. More space means more bulbs to bring it up to pressure.
5. Place glass under tap and pull tap all the way forward. If flow sputters or liquid not foamy inject another bulb and try again.
6. You will get drips afterwards as liquid drips through the tiny holes on the tap spout so a drip tray or matt is a good idea.
7. If flow slows down you can inject another bulb at any point.

The Gas Post / M10 Regulator

1. Turn the pressure up to 45psi on your regulator.
2. Turn off the regulator and check to see that the pressure doesn't drop quickly indicating a gas leak.
3. If the pressure does drop listen for gas escaping to find it and tighten the connections. If you can't hear it use soapy water on connections to try and find bubbles.
4. Once sure there aren't leaks (so you don't lose a whole bottle of gas overnight!) set the regulator back to 45psi and either let sit for minimum 2 hours or shake vigorously to dissolve the N₂ into the liquid.
5. Leave the pressure set at 45psi whether pouring or storing, the regulator and gas bottle can go in the fridge.

MAKE SURE TO TURN OFF THE REGULATOR BEFORE INSERTING OR REMOVING GAS BOTTLE OR ATTACHING OR DETACHING THE DISCONNECT FROM THE KEG!!!!