

ESPRESSO MARTINI MINI KEG PACKAGE



Assembly and Usage

iKegger Mini Keg

- Cut the dip tube to the height of the mini keg and attach it to the bottom of the iKegger 2.0
- Gas disconnects attach like hose fittings, you lift the collar to attach then release the collar to lock it in place. Some lubricant will make connecting easier and will extend the life of O-rings and seals.

To Clean: Use phosphoric acid no-rinse sanitiser or similar before first use, following the directions on the bottle.

To Use:

- Freeze one tray of ice cubes and put 500ml of vodka and 500ml Kahlua in the freezer. Chill the cold brew coffee too.
- Chill the keg, swirl ice water around in the Black keg as putting it in the fridge won't do anything for hours!
- Combine ingredients and full tray of ice in keg, screw on lid.
- Insert a gas bulb (with reg turned off!) and attach to keg. Lock the button down and turn the pressure up to 30psi.
- Shake vigorously or leave overnight with pressure turned up.
- Once one bulb is empty, switch to a new one and you can start pouring. Remember the more gas dissolved the better the foam and you need cold, pressure and either time or shaking to absorb the gas!

Important

- Check the packing sheet below, if anything is missing lodge a warranty claim using the look up my order section of the chat.
- **Always ensure the regulator is OFF before attaching or detaching gas source or pressurised kegs!**
- Check your system for leaks before leaving it unattended, turn off the gas and see if the needle drops. If it does, you have a leak and need to find it. Even a small leak will empty your whole gas bottle overnight! Use soapy water on connections and look for bubbles if you can't feel or hear where it's coming from.

IKEGGER

What's Included



Items

What is it?



One Mini Keg or Growler

Either the 2L Black insulated Mini Keg Double-walled 304 stainless steel with a screw-on lid Or the 2L Black Insulated Growler. Both options keep drinks hot or cold for many hours, The insulated growler comes with a Growler adapter which reduces the opening of the growler to the standard mini keg size opening.



2.0 Tap System

The iKegger 2.0 Push Button Tap system for Mini Kegs with 8mm push fitting liquid outlet, tap spout and gas ball lock posts, pressure release valve and a flexible silicone dip tube (cut to length of keg). Posts have valves, so spout and gas can be removed without losing pressure or spilling beer.



Mini Regulator

Regulates and maintains pressure inside the keg. Inlet for threaded 16g or use Sodastream Adapter. Inbuilt MFL Swivel Adapter to fit onto a gas disconnect. Comes with bulb inlet and bulb cover for use with unthreaded gas bulbs (e.g. Nitrogen, Nitrous Oxide), also includes the check valve adapter which will prevent the liquid going into the regulator when the keg is on it's side ,



Rubber Drip Tray or Coaster

Mini Drip Tray Coaster to fit under your Tap or to put your glass on. Dishwasher Safe for easy cleaning



The Keg Stand

Silicone Keg Stand to place your iKegger mini Keg onto when using it on its side. Keeps it from rolling around.



1x Carry Sleeve

Insulation Sleeve for the keg. Made from 5mm Neoprene, front has 3 pouches that fit gas bulbs. Includes strap for carrying over your shoulder.

IKEGGER

What's Included



Items

What is it?



Ice Cube Trays

Custom ice cube trays. Long thin shape to fit in the keg mouth. Use 1 whole tray per keg with 500ml of cold brew, 500ml of vodka and 500ml of Kahlua for our classic recipe.

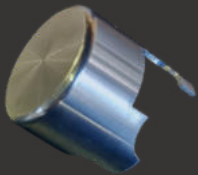

Tap Button

Button that allows to lock the iKegger 2.0 Tap in either open or closed position. Great for shaking! Replaces the existing button using the tool included in the tap box and a flat headed screwdriver.



Nitrogen Bulbs

Each bulb contains 2g of pure Nitrogen. Use with the bulb inlet. Insert a bulb, turn up the pressure, and shake the chilled keg and contents to dissolve the gas into the liquid. The more gas you dissolve (either by shaking or leaving to absorb for a few hours) the better the foam will be!



Karacho Cold Brew Concentrate

2 x 500 ml Strong brewed and perfect for an espresso like kick to your martinis! 500 ml is enough for 1 keg (500ml per keg)

IKEGGER

2.0 Push Button Tap

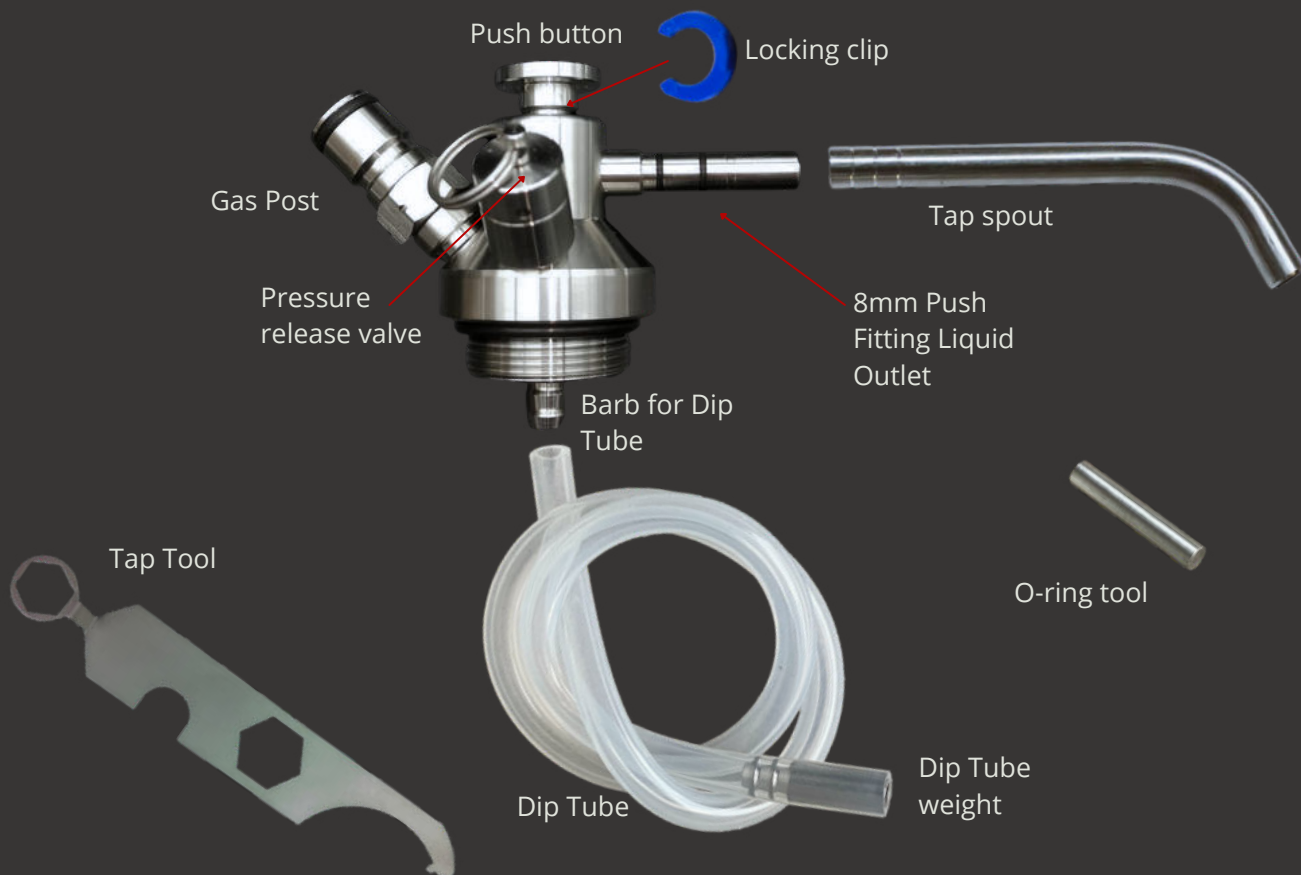

To Assemble

- Cut the silicone Dip Tube to the height of the keg. Don't leave it too long or it'll curl up inside the keg and not reach the bottom
- Push the Dip Tube firmly onto the barb at the bottom of the tap spear
- Push the Tap Spout onto the 8mm push-fitting compatible liquid outlet
- You can use the locking clip to prevent accidentally pushing the button when transporting your keg, just clip it on underneath the button
- The Dip Tube Weight will keep the dip tube at the bottom of the keg when lying down and prevent it from floating up to the top.
- The tap tool and o-ring tool are used to disassemble the tap for replacing the push button with the button clip (optional add-on), or for deep cleaning and servicing - [see youtube!](#)

ASSEMBLED



IKEGGER 2.0 Multi Gas Regulator

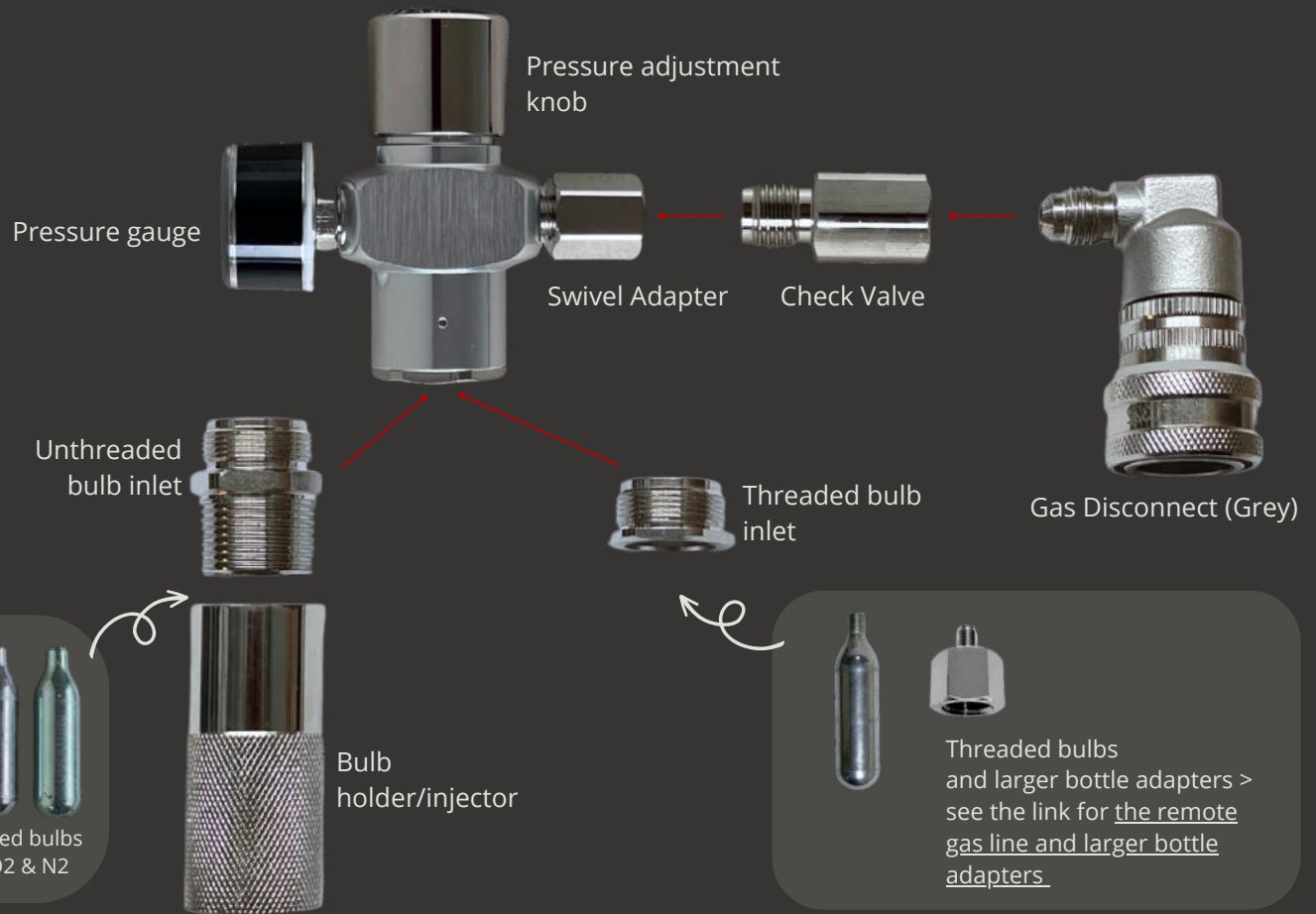

To Assemble

- If using unthreaded bulbs, remove the threaded inlet using the cutout on the tap tool or a spanner.
- If planning on using the keg lying down you **MUST** screw the check valve firmly onto the gas disconnect.
- Attach the disconnect (and optionally the check valve) into the swivel adapter inlet.
- If using **threaded bulbs**: screw in loosely until you feel resistance. Then pierce the bulb and complete the sealing firmly and quickly. Some gas might release while doing this, so screw in until it seals. Adapters can be just screwed in finger tight before the gas bottle is inserted.
- If using **unthreaded bulbs**: put a bulb into the bulb holder and screw onto the nitro bulb inlet until you feel resistance. Quickly and firmly screw on tightly to pierce the bulb and seal.
- Lift the collar of the Disconnect and push onto the Gas Post of your tap system until it clicks in place, just like a garden hose connection.
- Twist the knob to adjust your gas pressure in the keg, the gauge will show keg internal pressure.

IMPORTANT

DO NOT add or remove a source of gas (including connecting or disconnecting a pressurised keg) with the regulator turned on!



HELPFUL INFORMATION

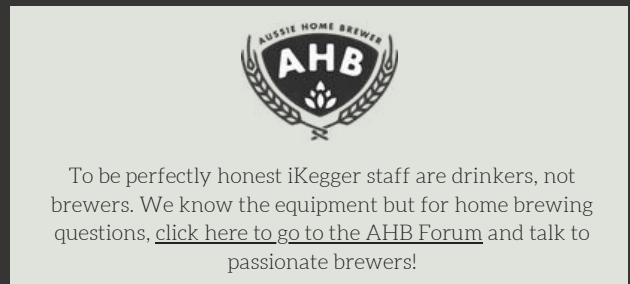
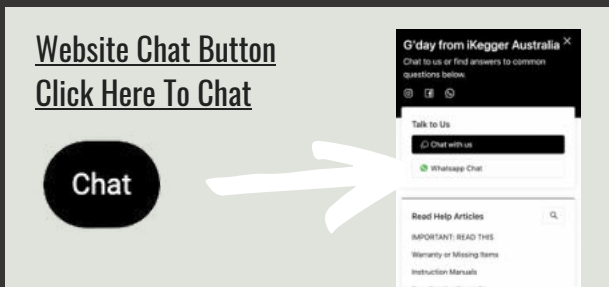

WARNING

We cannot say this enough.
The regulator is a piece of precision engineering. If you connect a gas source to it with it turned on, you will damage it.
This is not covered by warranty!

Always ensure the adjustment knob on the regulator is wound OUT (anti-clockwise) before unscrewing or screwing in a gas source or detaching or attaching the regulator to a pressurised keg. Both have the same effect, a burst of high pressure gas that damages the finely tuned internal parts.

email us info@ikegger.eu