

B033-A 1610 Freestanding Bath

Notes:

- Freestanding bathtub in matte white
- Polymarble or solid surface composition
- With overflow
- Chrome waste
- Optional matching stone waste available
- 10 years manufacturers warranty

Finishes:

- Matte white
- Gloss white
- Full colour range

Options:

- Overflow
- Non-overflow
- Stone waste (matte white)

Size: 1610 L x 810 W x 530 H (mm)

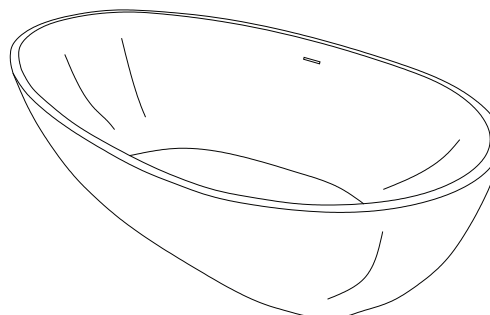
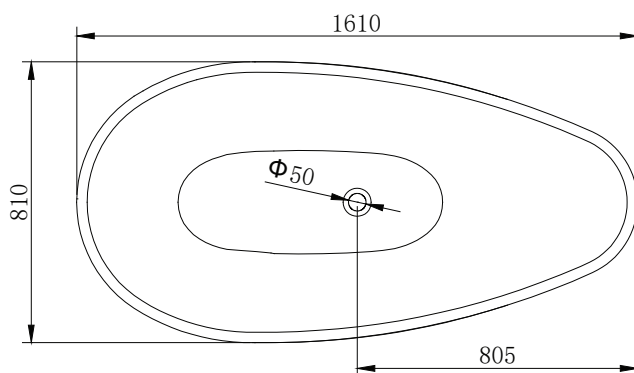
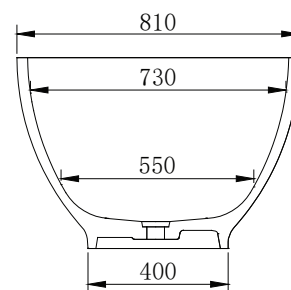
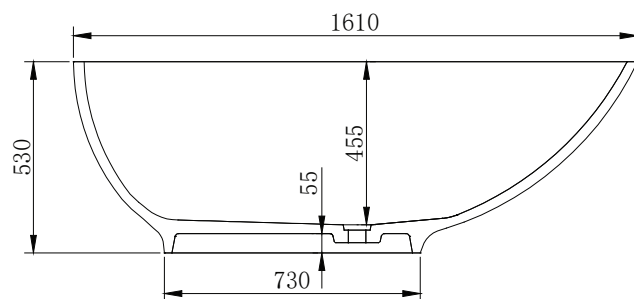

Net weight: 115kg
 Gross weight: 183kg
 Water capacity: 217lt
 Unit: mm