

**NOTE:** The supplied nuts have a Nylon threadlocker to prevent them from vibrating loose. When installing the nuts onto the supplied bolts they will thread on easily until the bolt reaches the outer end of the nut. After that you will feel some resistance as the nut is threaded onto the remainder of the bolt.

**WARNING:**  
*Improperly installed rack, bikes, or cargo can fall onto roadway potentially causing a serious accident resulting in bodily injury. Do not use rack on any vehicle where the rack cannot be properly and safely installed.*

## MAIN PARTS:

- 2 - Basket halves
- 1 - Central Support Tube (square tube)
- 1 - Hitch Insert

## PARTS LIST:

- 8 - Short Bolts, nuts, & washers (M10 x 20mm - 7/8")
- 3 - Carriage Bolts, nuts, & washers (M12 x 75mm - 3")
- 2 - Basket Connector Plates
- 1 - Large Carriage Bolt & nut (M16 x 80mm - 3 1/8")
- 1 - Straight Pin & Hairpin Cotter Pin/Locking Clip
- 1 - 3 1/4" half-threaded Anti-Rattle Bolt with lock washer & Hairpin Cotter Pin / Locking Clip
- 1 - AntiRattle Adapter (minimizes wobble)
- 2 - 17/19mm open end wrenches
- 2 - 22/24mm open end wrenches

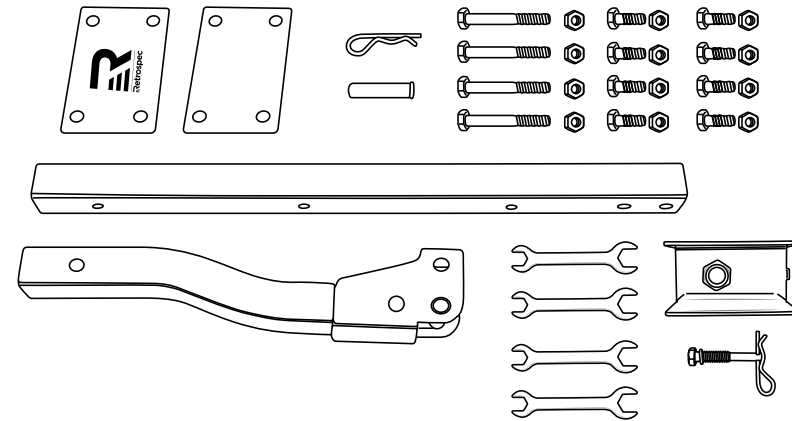

## WARNING:

- This rack is only intended to be installed on a vehicle with a 2" receiver hitch that is attached to the vehicle's frame.
- Never mount to a trailer or the back of a recreational vehicle. Never mount to a bumper hitch adapter. These mounting positions are not secure and can cause the rack and its contents to bounce and sway excessively resulting in damage to rack contents, rack, and the vehicle.
- Distribute weight evenly along basket platform to prevent an out of balance situation
- Never exceed maximum load weight of 500lbs
- Never allow people to sit in or be transported in the cargo basket
- Never carry a load that obscures your tail/brake lights, directional signals, license plate, or backup camera
- Never carry a load that is wider or deeper than the cargo basket
- Never carry a load that is not properly secured and tied down to the cargo basket. Improperly secured items may fall onto roadway and cause an accident
- Never allow any part of your cargo to be in direct path of your exhaust pipes as this could cause a fire or burn your cargo. Do not carry flammable items on cargo rack

## ASSEMBLY INSTRUCTIONS \* PLEASE READ INSTRUCTIONS ENTIRELY BEFORE BEGINNING ASSEMBLY \*

### STEP 1:

- Place the two Basket Halves bottom up on a flat surface and slide together using the locating pins at the end of each basket half to help mate the two pieces together. **(Fig 1)**
- Place the square Central Support Tube between the two halves of the cargo basket so that the three holes on the Basket Halves and the Central Support Tube line up with each other. Make sure that the protruding portion of the central support tube is on the hitch side of the basket, the side without red reflector stickers. **(Fig. 2)**
- Insert a carriage bolt through each of the three holes in the Basket Halves and the Central Support Tube and thread the corresponding nuts & washers onto the bolts. **(Fig. 2)**
- Tighten the bolts so they are snug but not fully tightened allowing for a small amount of movement. You will fully tighten them later in the assembly process.

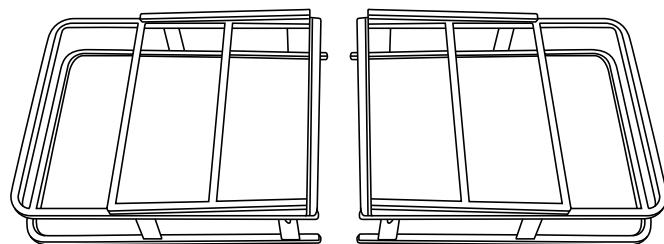

Fig. 1

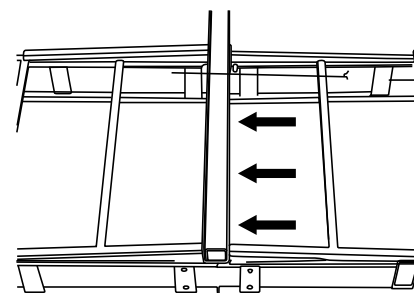

Fig. 2

### STEP 2:

- Flip the basket over and attach the two central connecting plates to the outside of the basket. One in front (with logo) and one on the hitch side (no logo). Attach using the short bolts placing them through the outside of the basket (4 per face plate). Secure by threading the nuts (and washers) onto the bolts from the inside of the basket. Full tighten the nuts and bolts. **(Fig. 3)**

### STEP 3:

- Now fully tighten the three carriage bolts on the square central tube from step #1.

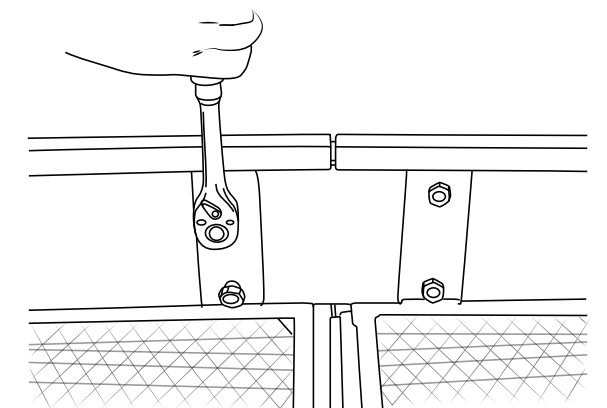

Fig. 3

## STEP 4 :

- Connect the Hitch Insert assembly to the square Central Support Tube on the basket by inserting the large bolt through hole A (**Fig. 4**) and secure with the corresponding nut. Tighten the bolt and nut so that it is very snug but allows the Hitch Insert to rotate up and down on the Central Support Tube.
- Rotate the hitch connector up and place the Straight Pin through hole B (**Fig 5**) and insert the Hairpin Cotter Pin/Locking Clip through the hole at the other end of the Straight Pin making sure that it fully clips in place. Having the Hitch Insert in the upright position will allow for a more compact profile making it easier to store and easier to mount onto the hitch of the vehicle.

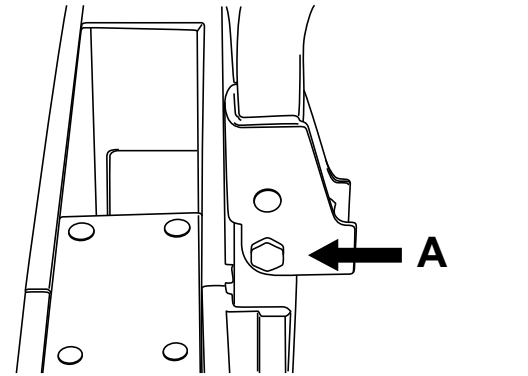

Fig. 4

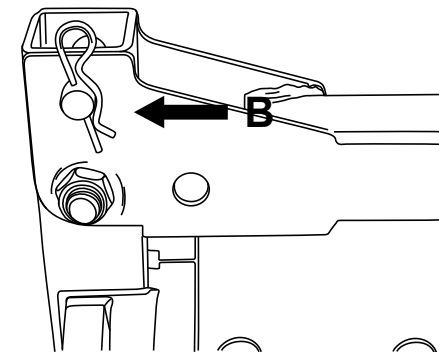

Fig. 5

## STEP 5 :

- Insert AntiRattle Adapter into Hitch Insert, slide in up to the Limit Tab (**Fig.6**). Install the now assembled rack into your vehicle's 2" hitch receiver. Line up the holes in the Hitch Insert and AntiRattle Adapter with the hole in the receiver then insert and thread the large 3 1/4" bolt through the holes. Tighten securely using wrenches.
- Thread-in 3 1/4" bolt from same side as Limit Tab. When tight, insert Hairpin Cotter Pin/Locking Pin into hole in end of Anti-Rattle Bolt.

**Warning! Never use the rack without the hitch bolt in place, securely tightened, and Hairpin Cotter Pin in place. Failure to install and properly tighten the hitch bolt will allow the rack to separate from the vehicle and fall onto the roadway potentially causing a serious accident.**

- Remove the Straight Pin and Locking Clip (hole B from Step 4), rotate the rack down, replace the Straight Pin through hole C and secure with Hairpin Cotter Pin/Locking Clip. (**Fig 7**)

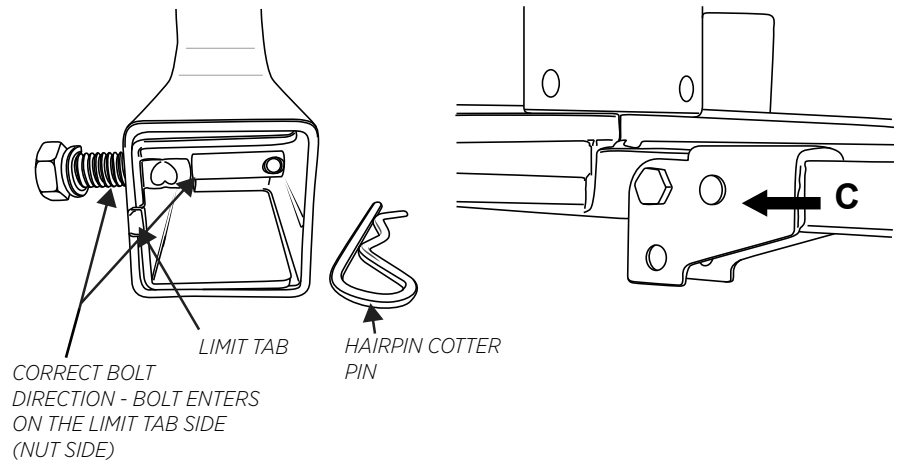

Fig. 6

Fig. 7

## RETROSPEC ACCESSORY HITCH CARRIER LIMITED WARRANTY

*Retrospec grants the original purchaser of a new Retrospec accessory hitch carrier a non-transferable limited lifetime warranty subject to the limitations, terms and conditions stipulated below.*

### TERMS & CONDITIONS:

- The product is warranted against defects in the materials and workmanship for the useful life cycle of the product. All products have a useful life cycle. Once the product has reached the end of its lifecycle it will no longer be eligible for warranty replacement or adjustments.
- This warranty applies to the original retail purchaser and is non-transferable.
- When contacting us for a warranty issue an original proof of purchase is required clearly identifying the product.
- The product must be returned to Retrospec for inspection along with copies of the original proof of purchase. The owner of the product is responsible for shipping costs.
- Should Retrospec determine that the product or any of its components are covered by this warranty, Retrospec's determination of the product's eligibility for warranty repair or replacement is final and binding.
- If, at the time of replacement, Retrospec does not have available the same product, the consumer may be offered a substitute product of equal or better value.

### ITEMS NOT COVERED BY THE LIMITED WARRANTY:

- Damage due to improper assembly
- Damage due to mounting the rack on the back of a trailer, Recreational vehicles, or to bumper hitch adapters.
- Normal wear and tear
- Damage due to lack of maintenance
- Damage due to installation of non-original parts, components, or accessories
- Damage due to loading of the bicycle carrier with non-standard bicycles, items that are not standard bicycles, or any product that exceeds the stated weight capacity of the bicycle carrier.
- Damage or failure due to improper use, accidents, neglect, or failure to follow the instructions provided with the product.
- The paint and finish of the bicycle carrier.
- Damage to bicycles or automobile
- Damage or injury due to the rack or bicycles falling from the car.

*This warranty is expressly in lieu of all other warranties. Any implied warranties of merchantability or fitness for a particular purpose created hereby are limited to the same duration as the express warranty herein. This warranty is void in its entirety if the product is modified in any manner. All provisions in this limited warranty are separate and severable. If any provision is held invalid and unenforceable, such determination shall not affect the validity or enforceability of the other provisions hereof. Except to the extent specifically prohibited by law, Retrospec shall in no way be responsible for direct, incidental or consequential damages, including, without limitation, damages for personal injury, property damage, or economic losses whether based on contract, warranty, negligence, product liability, or any other theory.*