



USA CAN

# MICOM WATER BOILER & WARMER

## OPERATING INSTRUCTIONS

# CD-WCC30KT

●Always follow basic safety precautions when using electrical appliances. Read all instructions carefully. Please keep these Operating Instructions at hand for easy reference.

### INDEX

IMPORTANT SAFEGUARDS.....	2
SPECIFICATIONS.....	5
PARTS NAMES AND FUNCTIONS.....	6
BOIL MODE.....	8
DISPENSE HOT WATER.....	10
DISPOSE WATER.....	10
REBOIL MODE.....	11
AUTOMATIC SHUT-OFF FUNCTION.....	11
HOW TO SET THE KEEP WARM MODE.....	12
QUICK TEMP MODE.....	14
ENERGY-SAVING TIMER FUNCTION.....	14
CAFÉ DRIP DISPENSING MODE.....	15
HOW TO CHANGE THE NOTIFICATION SOUND.....	15
CLEANING AND MAINTENANCE.....	16
●HOW TO REPLACE THE INNER LID GASKET.....	16
CITRIC ACID CLEANING.....	17
REPLACEMENT PARTS.....	17
Q&A ON PRODUCT USE.....	18
TROUBLESHOOTING GUIDE.....	18

# IMPORTANT SAFEGUARDS

---

## **BASIC SAFETY PRECAUTIONS SHOULD ALWAYS BE FOLLOWED WHEN USING ELECTRICAL APPLIANCES, INCLUDING THE FOLLOWING:**

1. Read all instructions thoroughly.
2. Avoid touching hot surfaces and do not close or clog the steam vent opening under any circumstances. The handles and knobs are provided for your safety and protection.
3. To safeguard against fire, electric shock and possible injury, keep the power cord, plugs and the appliance away from water or other liquids.
4. Close supervision is recommended when any appliance is used by or near children.
5. Unplug from outlet when not in use and before cleaning. Allow the appliance to cool before adding or removing parts, and before cleaning the appliance.
6. Do not use or operate any appliance with a damaged cord or plug. If the appliance malfunctions or has been damaged in any manner, unplug the appliance and return it to the nearest authorized service facility or dealer for examination, repair or adjustment.
7. The use of accessories or attachments not recommended by the appliance manufacturer may result in fire, electric shock or other injury to persons.
8. Do not use outdoors.
9. Keep the power cord away from hot surfaces and do not let the cord hang over the edge of tables or counters.
10. Do not place on or near a heated surface such as a gas or electric stove, or in a heated oven.
11. Always use extreme caution when moving an appliance containing hot liquids.
12. The plug to the appliance should be attached first before plugging the cord into a wall outlet.
13. Do not use the appliance for other than intended or specified purposes.
14. To protect against electrical hazard, unplug the cord before cleaning.
15. Scalding may occur if the lid is removed during boiling cycles.
16. Do not remove the Control Panel or the Water Level Gauge.

NOTE: This appliance has a polarized plug (one blade is wider than the other). To reduce the risk of electric shock, this plug was designed to fit into a polarized outlet in only one direction. If the plug does not fit fully into the outlet, do not attempt to force it or modify it in any way. Simply reverse the plug and insert. If it still does not fit, contact a qualified electrician.

## SAVE THESE INSTRUCTIONS

---

### **THIS APPLIANCE IS FOR HOUSEHOLD USE ONLY.**

- A. A short detachable power-supply cord has been provided for your safety. To reduce risks from entanglement or tripping, a longer cord is not recommended.
- B. Extension cords should only be used if care is exercised.
- C. If using an extension cord: (1) the marked electrical rating of the detachable power-supply cord or extension cord should be at least as high as the electrical rating of the appliance; (2) if the appliance is of the grounded type, the extension cord should have a ground-type 3-pronged plug; and (3) the longer cord should not drape over the countertop or tabletop where it can be pulled on by children or tripped over.

# IMPORTANT SAFEGUARDS (cont.)

## BEFORE USE

These WARNINGS and CAUTIONS are intended to protect you and others from personal injury and household damage. To ensure safe operation, please follow carefully.

## WARNINGS

**Do not modify the product. Only a repair technician may disassemble or repair this unit.**

- Attempting to do so may cause fire, electric shock or injury. Make any repair inquiries to Zojirushi Customer Service.

**Do not immerse the product in water or splash it with water, and do not put it on a wet surface such as a sink.**

- Doing so may cause short circuit or electric shock.

**Do not allow liquid to come into contact with the Receptacle or Power Cord.**

- Doing so may cause short circuit or electric shock.

**Do not plug or unplug the Power Cord with wet hands.**

- Doing so may cause electric shock or injury.

**Do not touch the Steam Vent or bring your hands or face near the Steam Vent.**

- Doing so may cause burns or scalding. Take special precautions with children and infants.

**Do not cover the Steam Vent with anything such as a dishcloth.**

- Hot water may spill out, resulting in scalds. It may also cause deformation or discoloration of the Upper Lid or breakdown of the product.

**Do not allow children to use the product unsupervised. Keep it out of the reach of infants.**

- Children are at risk of burns, electric shock or injury.

**Do not fill over the Maximum Water Level Line.**

- Overfilling may cause hot water to spill out, resulting in scalds.

**Always remove the Upper Lid before disposing hot water.**

- The Upper Lid may fall off and cause hot water to splash, resulting in scalds.

**Do not tilt or shake the product or carry in your arms. Do not move it or drain hot water by holding the Upper Lid.**

- Doing so may result in scalding by hot water spilling out from the Spout or Steam Vent, even if the Automatic Dispense Lock is on. Always use the handle when carrying.

**Do not tilt the product or tip it over.**

- Hot water may spill from the Spout or Steam Vent, even if the Automatic Dispense Lock is on.

**Do not slam the Upper Lid when closing.**

- Hot water may dispense or spill out, resulting in scalds.

**Do not use the product if the Power Plug or Power Cord is damaged or if the Power Plug is loosely inserted into the electrical outlet.**

- Doing so may cause electric shock, short circuit or fire.

**Close the Upper Lid securely.**

- Hot water may spill out when the product is overturned, resulting in scalds.

**Do not remove the Upper Lid while boiling.**

**Do not damage the Power Cord.**

- Do not bend, pull, twist, fold, or attempt to modify the Power Cord. Do not place it on or near high temperature surfaces or appliances, under heavy items or between objects. A damaged Power Cord can cause fire or electric shock.

**Do not use the product as a cooler or place ice inside of it.**

- Doing so may cause condensation, resulting in electric shock or breakdown of the product.

**Do not allow the end of the Appliance Plug to become soiled with dust or come into contact with any metal objects.**

- Doing so may cause electric shock, short circuit or fire.

**Do not allow infants or children to put the Appliance Plug in their mouth.**

- Doing so may cause electric shock or injury. Take special precautions with children and infants.

**Insert the Power Plug completely and securely into the electrical outlet.**

- A loosely inserted Power Plug may cause electric shock, short circuit, smoke or fire.

**Use only an electrical outlet rated at 15 amperes minimum, and do not plug other devices into the same outlet.**

- Plugging other devices into the same outlet may cause the electrical outlet to overheat, resulting in fire.

**If the blades or surface of the Power Plug become soiled, wipe them clean.**

- A dirty Power Plug may cause fire.

**Do not use a power source other than 120 V AC.**

- Use of any other power supply voltage may cause fire or electric shock.

**Do not boil anything other than water.**

- Attempting to boil, cook, or heat up the following items may cause bubbling or boiling over, which may cause scalding. Doing so may also cause clogging of the water route or Electric Pump, corrosion of the Water Tank, or peeling of the Nonstick Coating.

- Milk, sake, soup, charcoal, tea bags or tea leaves.
- Instant food.
- Food and sauce pouches or foods in plastic bags.

**Replace the Inner Lid Gasket if it hardens, changes shape, turns white, or otherwise becomes worn out.**

- Hot water may spill out when the product is tilted or tipped over accidentally, and may cause scalding. Steam may also leak out from the gap and cause burns or product failures.

●The illustrations used in these Operating Instructions may vary from the actual product you have purchased.

# IMPORTANT SAFEGUARDS (cont.)

**This product is not intended for use by persons (including children) with reduced physical, sensory or mental capabilities, or lack of experience and knowledge, unless they have been given supervision or instruction concerning use of the product by a person responsible for their safety. Children should be supervised to ensure that they do not play with the product.**

**Stop using immediately if you notice any of the following symptoms indicating a malfunction or breakdown.**

- Continued use of the product may cause smoke, fire, electric shocks or injury.
- The Power Plug or Power Cord has become very hot.
- The Power Cord is damaged or the electricity turns on and off when touched.
- The product is deformed or unusually hot.
- Smoke is arising from the product or there is a burning smell.
- Some parts of the product is cracked, loose or unstable.
- The product emits steam for at least 10 minutes continuously and does not turn to the Keep Warm mode.
- Water leaks from the product.

**If any of the above occurs, unplug the product immediately and return to Zojirushi Customer Service for check-ups and/or repairs.**

## CAUTIONS

**Always use caution when opening the Upper Lid and avoid skin contact with steam.**

- Loose water or steam may escape upon opening the Upper Lid and cause scalds.

**Do not touch hot surfaces during or for a short period of time after use.**

- Touching hot surfaces may cause burns. Be especially careful with metal parts such as the Inner Lid and the Water Tank.

**Please allow the product to cool down before cleaning.**

- Touching hot surfaces may cause burns.

**Do not use the product near walls or furniture.**

- Steam or heat may damage, discolor or deform walls or furniture.

**Do not swivel or move the product while dispensing water.**

- Hot water may splash out, resulting in scalds.

**Do not place or use the product on unstable surfaces.**

- Doing so may cause scalds or injuries.

**Do not use on heat sensitive rugs.**

- Doing so may cause fire.

**Do not attempt to dispense hot water while it is boiling.**

- Hot water can spurt out, resulting in scalds.

**Do not use other Power Cords than the one provided. Do not use the Power Cord for other appliances. Do not use the Power Cord for overseas models.**

- Doing so may cause malfunction or fire.

**Do not place the product over direct flame (such as a gas stove top), or on top of electric or induction heating (IH) cookers.**

- Doing so may cause fire, breakdown or damage of the product.

**Unplug the Power Plug from the outlet when the product is not in use.**

- Leaving the Power Plug in an outlet may cause the insulation to become damaged, resulting in electric shock, short circuit or fire, or result in injuries or scalds.

**Do not touch the Lid Lock when carrying the product.**

- Doing so may cause the Upper Lid to open, resulting in injuries or scalds.

**Always unplug the product by holding the Power Plug, not by pulling the Power Cord.**

- Pulling the Power Cord to unplug the product may cause electric shock, short circuit or fire.

**If the Power Cord is damaged, it must be replaced by an appropriate cord or assembly made available by the manufacturer or its service agent.**

## IMPORTANT

**Do not operate the product when it is empty.**

- Doing so may burn or damage the product.

**Avoid rough handling, dropping or bumping the product.**

- Doing so may cause damage or cease operation of the product.

**Avoid letting steam make contact with cabinets and walls when using near or under a kitchen shelf.**

- Doing so may cause discoloration or deformation.

**Allow the product to dry completely when storing the product for a long period of time where it may freeze.**

- If water left inside freeze, it may cause breakdown or malfunction.

**Avoid using the product near a radio, TV, computer, etc.**

- The product may cause interference with certain electronics.

**Do not drag the product over any surface while attempting to move.**

- Doing so may cause damage to surfaces such as countertops.

**Do not allow hot water to come into contact with the Control Panel or the Water Level Gauge.**

- Doing so may cause breakdown of the product.

**Do not use the product where its steam may come into contact with other electrical appliances.**

- The steam may cause fire, malfunction, discoloration or deformation to other electrical appliances.

**This appliance is intended to be used in household.**

# SPECIFICATIONS

Model No.		CD-WCC30KT
Capacity		101 oz. (3.0 liters)
Rating		AC 120 V 60 Hz
Electric Consumption		700 W
Average Power Consumption during Keep Warm	208°F (98°C)	Approx. 41 W
	195°F (90°C)	Approx. 34 W
	175°F (80°C)	Approx. 28 W
	160°F (70°C)	Approx. 23 W
Length of the Power Cord		2' 11" (0.9 m)
External Dimensions	(approx. inches)	8- <sup>1</sup> / <sub>4</sub> (W) x 11- <sup>1</sup> / <sub>4</sub> (D) x 11- <sup>1</sup> / <sub>2</sub> (H)
	(approx. cm)	21 (W) x 28.5 (D) x 29 (H)
Weight (including the Power Cord)		Approx. 5 lbs. (2.3 kg)

- The average Keep Warm electric power consumption is for one hour, provided that the Water Tank is full and the room temperature is approximately 73°F (23°C).
- The height refers to the product when the handle is down.
- In high altitudes or severely cold areas, the product may not perform as specified. Avoid using the product in such areas or in other extreme conditions.
- This product is not suitable for use in countries or regions with different power supply voltages or frequencies.

# PARTS NAMES AND FUNCTIONS

The rattling or metallic noise you may hear when opening or closing the Upper Lid or during boiling is normal. (see pg.20)

## Inner Lid Gasket (Expendable Part)

- If the Inner Lid Gasket hardens, changes shape, turns white, or otherwise becomes worn out, please replace it with a new one. (Separate charge required.) (see pg.16)
- Not doing so may cause hot water to leak when the product is tilted or tipped over, resulting in scalding. Steam leaking from the gap may also cause burns or product failures.

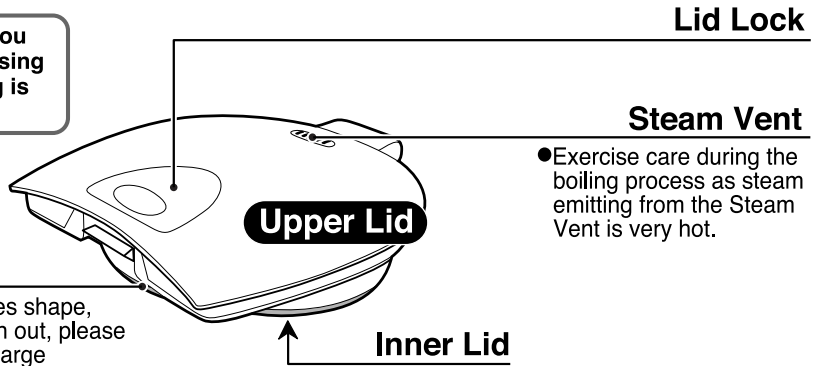

## Water Removal Area

- Drain water here.

## Maximum Water Level Line

## Control Panel

## Spout

- Hot water dispenses from here.

## Water Level Gauge

## REFILL Line

- Fill water above the line.

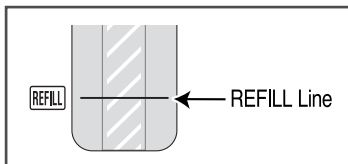

## Filter (Expendable Part)

- For care and use instructions, see pg.16.

## Water Tank (Nonstick Coated)

## Hinge

## Handle

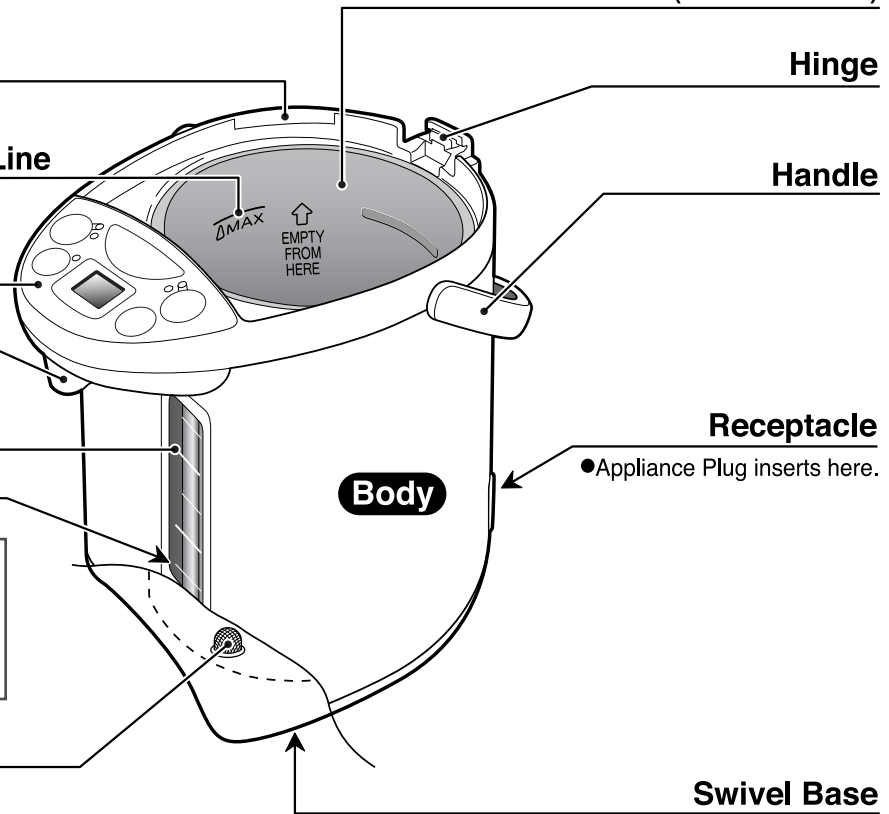

## Power Cord

## Twist Tie

- Please remove the twist tie holding the Power Cord before use.
- Do not use the Power Cord bundled up. Doing so may cause the Power Cord to become excessively hot, resulting in malfunction.

## Power Plug

## Appliance Plug

## Cord

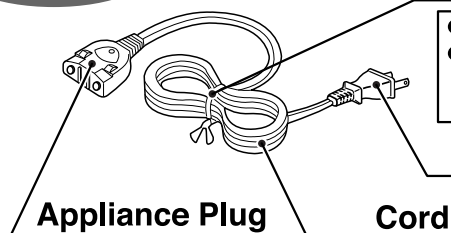

# PARTS NAMES AND FUNCTIONS (cont.)

## CONTROL PANEL

- Press buttons down firmly.
- The Notification Sounds and raised dot (●) in the center of the DISPENSE button is provided for those with visual impairment.

### DISPENSE button

Press to dispense hot water. (see pg.10, 15)

### QUICK TEMP light

### BOIL light

### REBOIL/QUICK TEMP button

Starts the Reboil mode. (see pg.11)  
Sets the Quick Temp mode. (see pg.14)

Also used when performing the Citric Acid Cleaning (to initiate cleaning, press this button for more than 3 seconds). (see pg.17)

### TEMP SET button

Sets the Keep Warm temperature. (see pg.12)

### KEEP WARM light

### CAFÉ DRIP light

### UNLOCK light

### UNLOCK button

Press once to unlock. (see pg.10)  
Press twice to activate the Café Drip Dispensing mode. (see pg.15)  
Hold for at least 3 seconds to change the Notification Sound. (see pg.15)

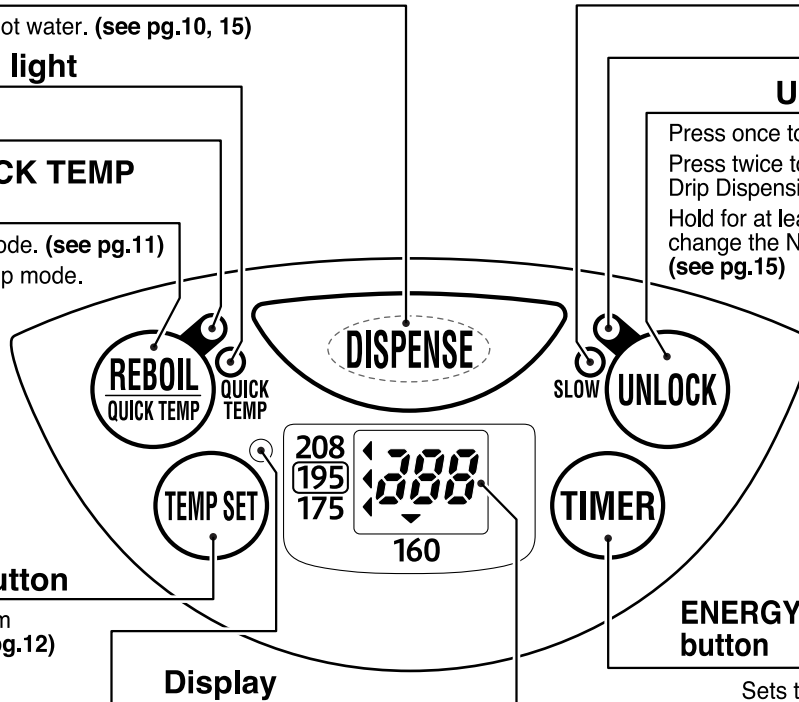

### Display

LCD display shows the water temperature and Timer settings.

### ENERGY-SAVING TIMER button

Sets the Energy-Saving Timer function. (see pg.14)

NOTE: Illustration is for reference only. Actual display will not show all functions simultaneously during use.

## How to Open/Close the Upper Lid

- To Open**
- 1 Press the indented area of the Lid Lock with your thumb.
  - 2 Pull the Lid Lock up with your fingers to open the Upper Lid.

**To Close** Depress the Upper Lid until it clicks shut.

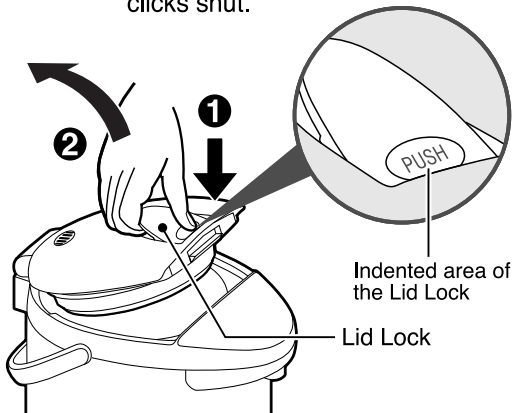

## How to Detach/Attach the Upper Lid

- To Detach**
- 1 Open the Upper Lid to about a 45-degree angle.
  - 2 Push the Upper Lid Detach button.
  - 3 Pull the Upper Lid forward and up at an angle.

**To Attach** Push the Upper Lid back into place at the same angle.

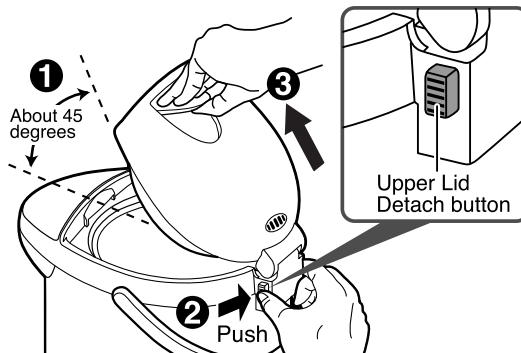



# BOIL MODE

**1** Open the Upper Lid and fill the Water Tank with water using a pitcher or other container.

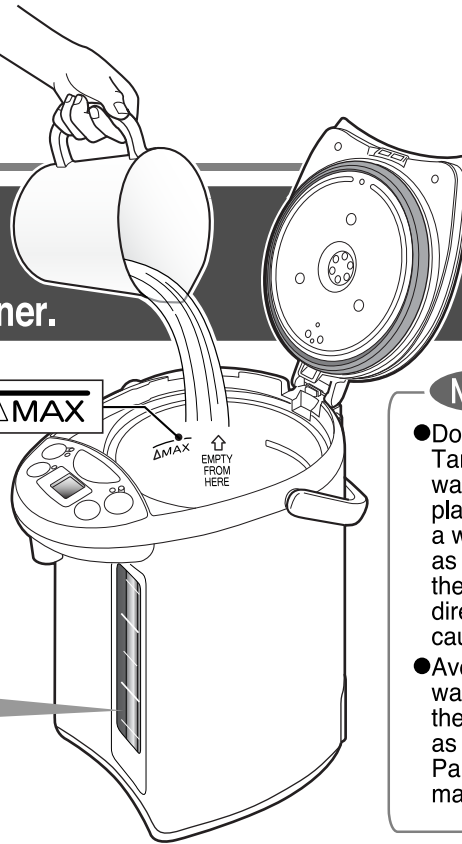

To monitor the amount of water you are filling, look at the thickness of the stripes on the Water Level Gauge.

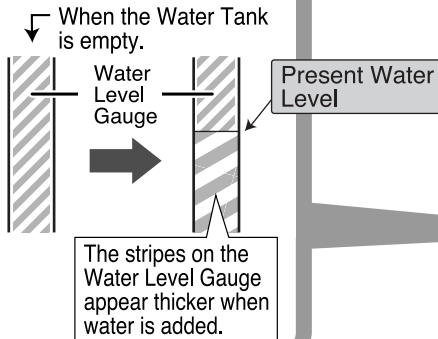

## NOTE

- Do not fill the Water Tank directly from a water faucet or place the product on a wet surface such as a sink. (Exposing the heating element directly to water may cause malfunction.)
- Avoid splashing water on other than the Water Tank such as the Control Panel. (May cause malfunction.)

**2** Close the Upper Lid and connect the Power Cord.

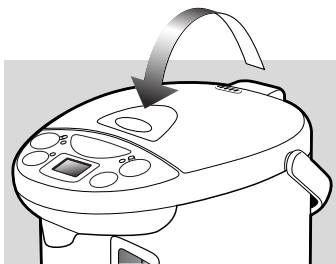

Close the Upper Lid securely.

(To ensure safe operation while boiling and to prevent scalds if the product is overturned.)

**It automatically starts the boiling process.**

The BOIL light turns on and the Display shows the water temperature.  
 Below 170°F: The Display shows the water temperature in 10°F increments.  
 Above 175°F: The Display shows [175] → [180] → [185] → [190] → [195] → [200] → [205] → [212].

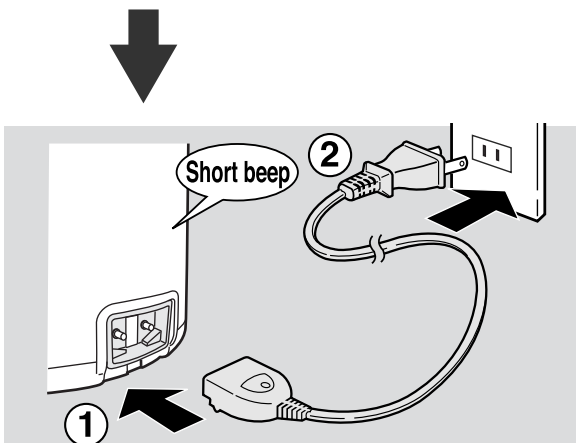

Be sure to insert the Power Cord securely.  
 (Otherwise, may cause electric shock, short circuit, smoke or fire.)

## NOTE

- Do not allow the end of the Appliance Plug to get soiled with dust or come into contact with metal objects such as pins.

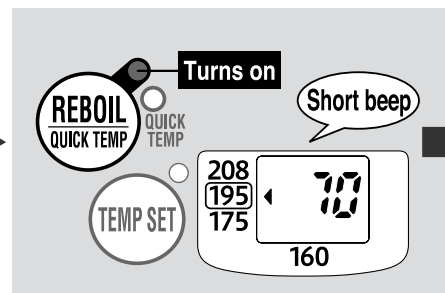

- How to set the Quick Temp mode: (see pg.14)



■ Temperature Conversion Guide

Fahrenheit (°F)	Celsius (°C)
212	100
208	98
195	90
175	80
160	70
73	23

# BOIL MODE (cont.)

The first time you use the product you may notice the smell of plastic. This is normal and will gradually fade away.

● **At your initial use or when using the product after a long period of storage:**

Fill the Water Tank with water to the Maximum Water Level Line ( $\Delta$ MAX), and boil water as directed. Once it reaches a boil, press the UNLOCK button, then press the DISPENSE button to dispense about 34 oz. (1 liter) of hot water in order to rinse the water route, and dispose the remaining water. Fill with fresh water.  
(Always remember to attach the Filter.)

● **When using mineral or alkaline ionized water:**

When mineral or alkaline ionized water is used, a floating residue may develop or a milky white substance may form on the surface of the Water Tank. This is due to the ingredients in the water and is harmless to your health. Frequent cleaning is recommended.

- Do not fill over the Maximum Water Level Line. (Hot water may overflow from the Spout or the Steam Vent, resulting in scalds.)
- Do not fill the Water Tank with hot water. (The Automatic Shut-Off function may be activated.) (see pg.11)
- Do not fill the Water Tank with any liquid other than water.
- Do not use water additives such as charcoal for water purification or mineral additives. (Small particles may get clogged inside of the product.)
- If you wish to shorten the completion time, add less water to the Water Tank.

How to change the Notification Sound from a melody to a beep. (see pg.15)

**When boiling has completed, a melody sounds and it automatically switches to the 195°F Keep Warm mode.**

The BOIL light turns off, the KEEP WARM light turns on and "212" appears on the Display.

How to set the Keep Warm mode:

- 208°F Keep Warm Mode (see pg.12)
- 175°F Keep Warm Mode (see pg.12)
- 160°F Keep Warm Mode (see pg.13)

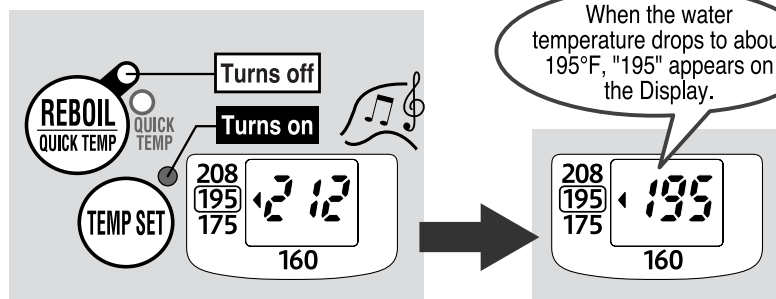

**NOTE**

- Add water when the water level is low during the Keep Warm mode. (The product automatically begins heating the water.) If the water level is still not high enough, it will not automatically switch to Boil. In this case, press the REBOIL/QUICK TEMP button to manually start the process. (see pg.11)
- Please follow the instructions below to prevent the risk of scalding:
  - Do not cover the Steam Vent with a cloth.
  - Do not touch the Steam Vent or bring your hands or face near the Steam Vent.
  - Do not open the Upper Lid while the BOIL light is on.
  - Do not dispense hot water while it is boiling.

Time required to boil water:

Approx. 31 minutes\*

(At a room temperature of 73°F with the Water Tank filled to the Maximum Water Level Line with water temperature at 73°F.)

\* Includes approx. 4 minutes to dechlorinate.

Length of time until the water temperature reaches about 195°F:

Approx. 25 minutes

(At a room temperature of 73°F with the Water Tank filled to the Maximum Water Level Line.)

● The length of time for the water temperature to reach 195°F will vary depending on the temperature of the room and water.

# DISPENSE HOT WATER

**1** Press the **UNLOCK** button.

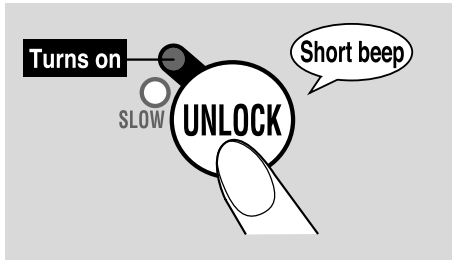

The **UNLOCK** light turns on and hot water can be dispensed.

**NOTE**

- Do not unlock and press the **DISPENSE** button if the Water Tank is empty.

**2** Press the **DISPENSE** button to dispense hot water.



**Do not swivel the product while dispensing water.**

- Initially upon boiling or if it has been a while after dispensing, the water may not be very hot. Please discard the first cup (of the hot water).
- Do not attempt to dispense hot water while boiling.
- Water may not dispense smoothly shortly after boiling. Wait for a short period of time before dispensing hot water again.
- Be careful as the product heats up during the Boil and Keep Warm modes.

# DISPOSE WATER

Dispose leftover water when the product is not in use.

**1** Unplug the Power Cord and detach the Upper Lid.

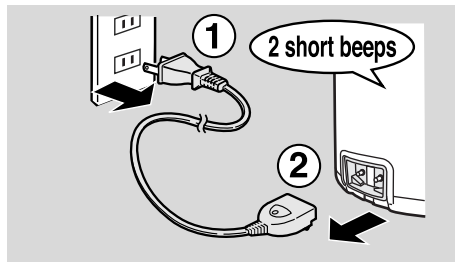

**When detaching the Upper Lid:**

- Take precaution with the steam. You may scald yourself.

**2** Hold the product with both hands and dispose water where indicated "EMPTY FROM HERE" on the wall of the Water Tank.

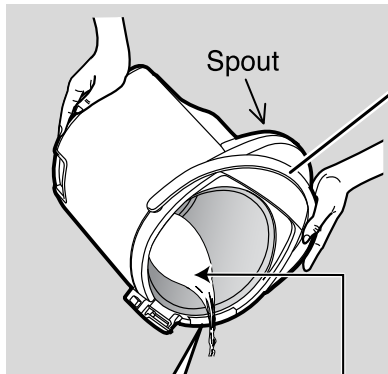

Hold the Handle securely.

**When disposing hot water:**

- Take precaution with the hot water and steam. You may scald yourself.
- Take precaution as hot water may drip from the Spout, causing scalds.

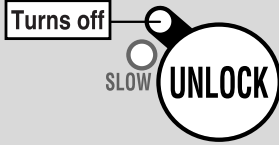

10 seconds after dispensing, the UNLOCK light turns off and the Automatic Dispense Lock is activated.

#### Automatic Dispense Lock

A safety function to prevent hot water from dispensing if the DISPENSE button is accidentally pressed.

- Even if no water is dispensed, the Automatic Dispense Lock will be activated after about 10 seconds.

**Do not tilt or shake the product after dispensing. Hot water may drip from the Spout, causing scalds.**

#### NOTE

- Do not plug or unplug the Power Plug or Appliance Plug with wet hands. (Doing so may cause short circuit or electric shock.)
- Do not dispose hot water with the Upper Lid in place. (The Upper Lid may come off, spilling hot water and causing scalds.)
- Do not allow water to splash on the Control Panel, Hinge, Handle or Receptacle. (Could cause scalding or breakdown.)
- Take precaution as not attaching the Filter properly may cause it to fall out when dispensing hot water.
- Dispose the water at least once a day. (Leaving water in the Water Tank can cause unwanted odor or scale build-up.)

## Reboil Mode

This function is used when reboiling water in the Keep Warm mode.

Press the **REBOIL QUICK TEMP** button.

The BOIL light turns on when the boiling process begins.

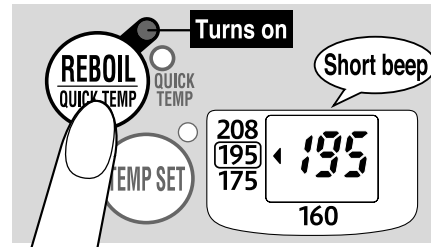

Time required to finish reboiling

(At a room temperature of 73°F (23°C) with the Water Tank filled to the Maximum Water Level Line.)

208°F Keep Warm Mode
Approx. 3–4 minutes
195°F Keep Warm Mode
Approx. 5–8 minutes

When the Reboil process is completed, a melody sounds and the product switches to the Keep Warm mode.

- Pressing the REBOIL/QUICK TEMP button twice activates the Quick Temp mode. (see pg.14)
- Do not attempt to dispense hot water while reboiling.
- Water may not dispense smoothly shortly after boiling. Wait for a short period of time before dispensing hot water again.

#### NOTE

- Make sure the water level is above the REFILL Line before pressing the REBOIL/QUICK TEMP button.

## Automatic Shut-Off Function

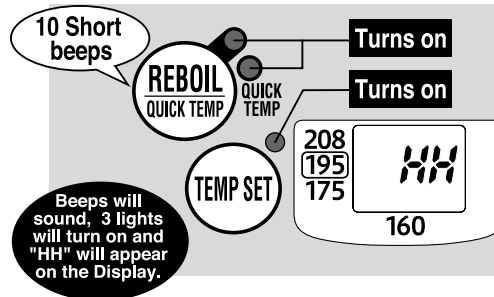

- Be careful not to repeat the boiling process without filling the Water Tank with water, as the Nonstick Coating may discolor and peel.

The Automatic Shut-Off function activates to shut down power to the heater in order to prevent damage from overheating. The Display will show "HH" and beeps will sound to alert you that the Automatic Shut-Off has been activated. The following conditions may cause activation:

- When plugged in without filling the Water Tank with water.
- When the water level is lower than the REFILL Line and boiling has been attempted.
- When the Water Tank is empty or the Upper Lid is left open for adding water.
- When pouring in hot water immediately after plugging in the unit.

#### Remedy

**Unplug the product. Allow the Water Tank to cool. Fill the Water Tank with water above the REFILL Line and plug back in.**

# HOW TO SET THE KEEP WARM MODE

Press the  button to change the settings.

Each press of the button changes the position of the "◀" on the Display.



## 208°F Keep Warm Mode

208°F is ideal for making coffee, tea and instant noodles.

Select the "208" on the Display.

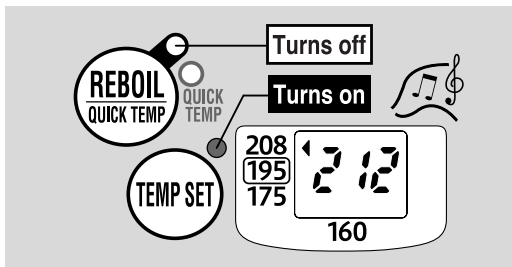

When the boiling process has completed, a melody sounds, the BOIL light turns off and the KEEP WARM light turns on.

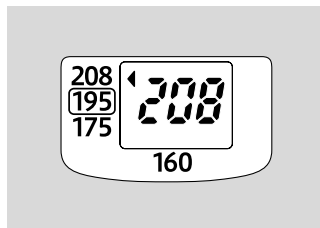

When the water temperature reaches 208°F, "208" appears on the Display.

- Depending on the altitude where the product is used, the Keep Warm mode may be set at 205°F-207°F, in order to prevent continuous boiling.

## 175°F Keep Warm Mode

175°F is ideal for making Japanese (green) tea.

Select the "175" on the Display.

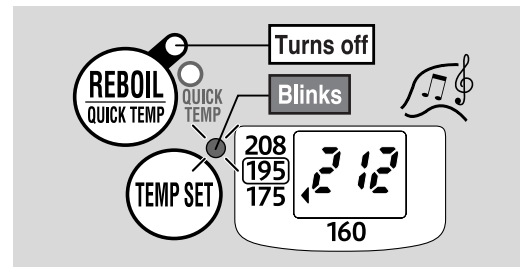

When the boiling process has completed, a melody sounds, the BOIL light turns off, and the KEEP WARM light begins to blink.

(If initiated during the Keep Warm mode, the light will blink 2 seconds after the selection.)



When the water temperature reaches about 175°F, "175" appears on the Display, and the KEEP WARM light stops blinking and remains on.

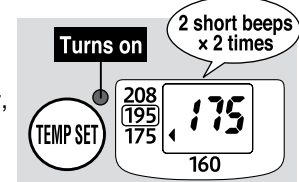

(When water is boiled in the Quick Temp mode, the KEEP WARM light does not blink but turns on. (see pg.14))

- Length of time for the water temperature to reach 175°F after boiling:

Approx. 1 hour and 10 minutes

(At a room temperature of 73°F with the Water Tank filled to the Maximum Water Level Line.)

- The length of time for the water temperature to reach 175°F will vary depending on the room temperature and amount of water.

# HOW TO SET THE KEEP WARM MODE (cont.)

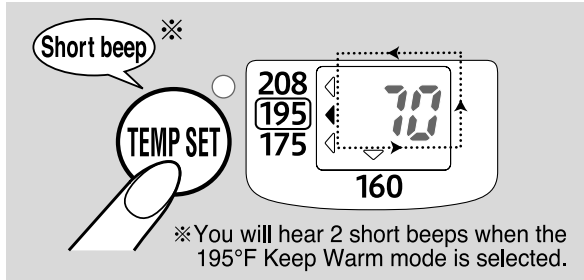

- You can change the temperature setting during the Keep Warm mode.  
(It may start reboiling depending on the water temperature and the selected setting.)
- You cannot select the 208°F Keep Warm mode while the Quick Temp mode is selected.

## 160°F Keep Warm Mode

160°F is ideal for preparing baby formula.

**Select the "160" on the Display.**

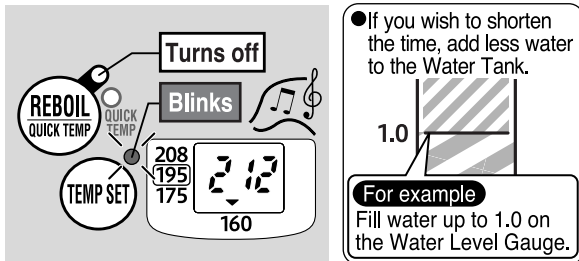

When the boiling process has completed, a melody sounds, the BOIL light turns off, and the KEEP WARM light begins to blink.

( If initiated during the Keep Warm mode, the light )  
will blink 2 seconds after the selection.

When the water temperature reaches about 160°F, "160" appears on the Display and the KEEP WARM light stops blinking and remains on.

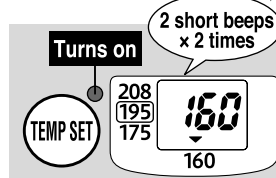

■ Length of time for the water temperature to reach 160°F after boiling:

1.0 L	Max Capacity
Approx. 1 hour	Approx. 2 hours and 10 minutes

(At a room temperature of 73°F.)

- The length of time for the water temperature to reach 160°F will vary depending on the room temperature and amount of water.

### When preparing baby formula:

160°F is ideal for preparing formula. **Dissolve the formula and let cool to optimum temperature (slightly higher than body temperature). If fed without cooling, babies are at risk of scalding.**

- Be sure to check that the KEEP WARM light is on and NOT blinking before dispensing.
- Discard a cup of hot water before preparing baby formula. (Because the remaining water in the Water Level Gauge may not be very hot.)
- Do not use the Quick Temp mode. (see pg.14)

## If the Power Cord is detached:

- Reinsert the Power Cord if it is accidentally detached.
- If the cord is detached for more than a few minutes and reinserted, the product returns to the 195°F Keep Warm mode and may start reboiling automatically.

## Temperature Conversion Guide

Fahrenheit (°F)	Celsius (°C)
212	100
208	98
207	97
205	96
195	90
175	80
160	70
73	23

# QUICK TEMP MODE

This function heats the water to the selected Keep Warm temperature without reaching a boil. The water will reach the selected Keep Warm temperature quicker than the Regular Boil mode. Other benefits include reduced steam and reduced energy use. Use this mode when dechlorination is not necessary, such as when using bottled or purified water.

**1** While the water is heating, press the  button to select the Quick Temp mode.

You cannot activate the Quick Temp mode while the product is set at the 208°F Keep Warm mode. Select the 195°F, 175°F or 160°F Keep Warm mode, then select the Quick Temp mode.

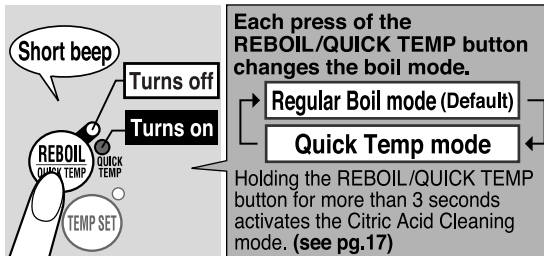

- You cannot select the 208°F Keep Warm mode while the Quick Temp mode is activated.
- There may be a lingering chlorine smell if tap water is used while the Quick Temp mode is activated. If this is an issue, use the Regular Boil mode instead.
- Depending on the room temperature and amount of water, the actual water temperature after heating may differ from that shown on the Display.
- Depending on the temperature of the room and water, and atmospheric pressure, some steam may be produced.
- The Quick Temp mode may be canceled if the product is left unplugged for several minutes. Set to the desired mode again.
- The product begins the Regular Boil mode when water is added. Activate the Quick Temp mode again.

**NOTE**

- Water does not reach a boil under the Quick Temp mode, and should not be used to prepare baby formula.
- Although the water will not reach a boil when the Quick Temp mode is activated, the Steam Vent will become hot. Please do not touch it.

**2** After reaching the selected temperature, it will automatically switch to Keep Warm.

**195°F, 175°F Keep Warm mode:**

After reaching the selected temperature, a melody sounds, the QUICK TEMP light turns off and the KEEP WARM light turns on.

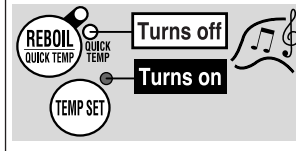

**160°F Keep Warm mode:**

When the water temperature reaches about 175°F (80°C), a melody sounds, the QUICK TEMP light turns off and the KEEP WARM light begins to blink.

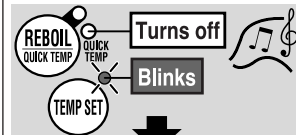

When the water temperature reaches about 160°F (70°C), the KEEP WARM light remains on.

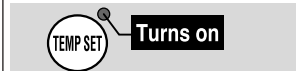

Length of time for the water temperature to reach 160°F (70°C) after 175°F (80°C) is approx. 40 minutes. (At a room temperature of 73°F (23°C) with the Water Tank filled to the Maximum Water Level Line.)

# ENERGY-SAVING TIMER FUNCTION

The Boiling function will complete at the set time. Setting the Energy-Saving Timer function before going to sleep at night or before long idle period will help to save energy by shutting off electricity to the heater.

Press the  button until the desired length of time is displayed.

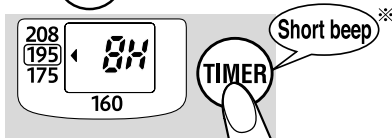

※ You will hear 2 short beeps when 6H is selected.

**A melody sounds and the Energy-Saving Timer function is activated.**

The Display shows the remaining time. Once the boiling process begins, it is replaced with the water temperature.

**The Boiling function will complete at the set time.**

A melody sounds, the BOIL light turns off and the product switches to the Keep Warm mode. (see pg.9, 12, 13)

Boiling may stop earlier than the set time, depending on room temperature, water temperature and amount of water.

Each press of the TIMER button changes the set time. (H for hours)

6H → 7H → 8H → 9H → 10H

Cancel (temperature display)

- If the product is idle for about 2 seconds, the time currently displayed will be applied.

**NOTE**

- To cancel the Timer, press the TIMER button several times until the temperature appears on the Display, or press the REBOIL/QUICK TEMP button once.
- When using the Quick Temp mode with the Energy-Saving Timer function, set the Energy-Saving Timer function after selecting the Quick Temp mode.
- If the Power Cord is detached, the Energy-Saving Timer function will be canceled and must be reset.



# CAFÉ DRIP DISPENSING MODE

This mode decreases the amount of water dispensed to 60% of the normal setting, making it suitable for brewing café drip coffee.

## 1 Press the **UNLOCK** button twice.

When the CAFÉ DRIP light turns on, the Café Drip Dispensing mode is activated.

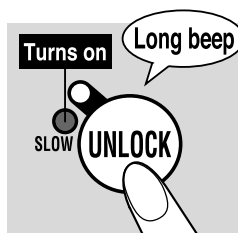

- Pressing the UNLOCK button again during the Café Drip Dispensing mode will reset the product to the normal dispensing mode.
- When the CAFÉ DRIP light turns off, the Automatic Dispense Lock is activated.
- If the water level is low, it may take longer for water to begin dispensing after pressing the DISPENSE button, or water may not dispense smoothly.
- Water may not dispense smoothly just after boiling has completed. In this case, wait for a short period of time before dispensing hot water again.

## 2 Press the **DISPENSE** button to dispense hot water.

You can use the Café Drip Dispensing mode for about 60 seconds while the CAFÉ DRIP light is on.

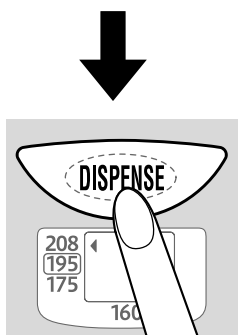

### NOTE

- Be careful not to burn yourself.
- If using a cone filter placed directly on a cup, be careful not to let it fall inside the cup while brewing.
- The first cup of water may not be hot enough just after boiling has completed, or when you have not dispensed water for a while. Discard a cup of hot water before brewing.
- If the cup or other container that you use is cold, the hot water may cool quickly. To prevent this, warm the container before use.

# HOW TO CHANGE THE NOTIFICATION SOUND

## ● Notification Sound:

The product notifies you with a melody or beeps that it has finished boiling or the timer has been set.

### When and what types of Notification Sounds are heard:

When	Types of Notification Sound	Melody	Beeping	Silent <sup>**</sup>
		(Default)		
Boiling stops		Minuet	5 long beeps	×
Timer is set		Beautiful Dreamer	×	×

\* The tone that indicates button inputs will sound even when Silent is selected.

### How to change the Notification Sound:

## 1 Hold the **UNLOCK** button for more than 3 seconds during the boiling process or the Keep Warm mode.

Each time the UNLOCK button is held for more than 3 seconds, the Notification Sound will change.

### ① Melody:

"Beautiful Dreamer" will play when setup is complete.

### ② Beeping:

It will beep 3 times when setup is complete.

### ③ Silent:

It will beep once when setup is complete.

## 2 Setup is complete when the desired sound (melody or beep) is heard.

- The Notification Sound will return to Melody if the product is unplugged.



# CLEANING AND MAINTENANCE

Always unplug the Power Cord, dispose all water, and allow to cool completely before cleaning.

**NOTE** ●Do not attempt to dry the product by turning it upside down when the bottom is wet. (Water may get inside the Body and cause it to break or rust.)

- Do not use the following:
  - Thinner and bleach. (Doing so may cause discoloration, crack, degradation and corrosion.)
  - Polishing powder, nylon brushes, anything made with metal, eraser pads, hard nylon sponges and abrasive cleaners. (Doing so may cause corrosion.)
  - Detergent. (Hot water may spill out, resulting in scalds or damage. Doing so may cause unwanted odor.)
- Do not use scrub brushes for any portions other than the Filter. (Doing so may cause corrosion.)
- When using chemically treated cloths, do not rub too hard or leave them on the product for a long time as the surfaces of the product may be damaged by chemical reactions.
- Do not use a dishwasher or dish dryer for cleaning or drying. (Doing so may cause the plastic parts to deform.)
- Before storing the product for a longer period of time, dry it completely and pack in a plastic bag to prevent odors from being absorbed.
- Never wash the Body, Upper Lid, or Power Cord with water.

**Inner Lid** Wipe with a soft wet sponge.

**Water Tank** Perform the Citric Acid Cleaning (see pg.17) periodically.

**Especially when...**

- Red rust spots (rust stain) is visible on the Water Tank.
  - Milky white or gray discoloration and/or filmy objects are found in the water.
  - Boiling is louder than usual.
  - Hot water has an odor.
- (The condition of the Water Tank will vary depending on the water quality and frequency of use.)

**Filter** Remove the Filter from the Water Tank and wash with a soft brush.

Pull the Filter up to release, and press down firmly to attach.  
If you find it difficult to clean the Filter, replace it with a new one. (see pg.17)

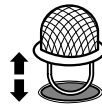

- Never use the product without installing the Filter. (The Filter prevents foreign objects from entering the water route or Electric Pump and obstructing the flow of hot water.)

**Power Cord** Wipe clean with a dry cloth.

**Body/Upper Lid** Wipe clean with a damp well-wrung cloth.

- Do not get water on or wash the Control Panel or Water Level Gauge. (If water gets inside, it may cause malfunction or rust.)

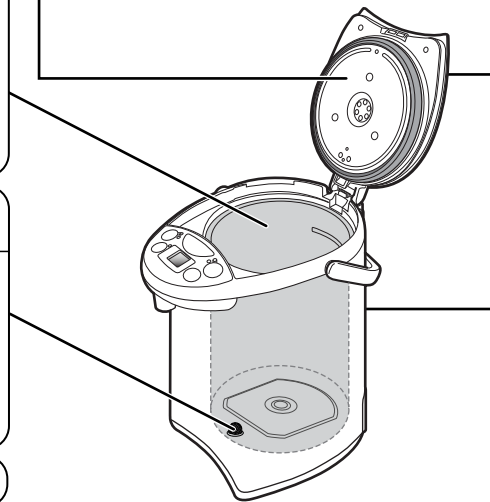

## HOW TO REPLACE THE INNER LID GASKET

The Inner Lid Gasket may need to be replaced due to time and wear. We recommend that you replace it about once a year.

Wipe new Inner Lid Gaskets with a wet soft sponge before attaching to the Inner Lid.

### To remove the Inner Lid Gasket

- 1 Remove the three screws, and remove the Inner Lid.
  - Be careful not to lose these screws.
- 2 Remove the Inner Lid Gasket which is installed on the Inner Lid.

After removing the Inner Lid, check the plastic part of the Upper Lid for abnormalities.

→If this part is discolored or if it feels rough to the touch, replace it (there will be a fee for this).

### To attach the Inner Lid Gasket

- 1 Fit the Inner Lid Gasket securely to the outer circumference of the Inner Lid as shown in the figure.
- 2 Line up the pin on the Upper Lid with the hole on the Inner Lid, and tighten the three screws securely.

If the Inner Lid Gasket hardens, changes shape, turns white, or otherwise becomes worn out, hot water may leak from the gap between the Upper Lid and Body when tilted. Steam may also leak from the gap, causing burns and product failures, which may result in scalds. If hot water spews from the gap or there is steam even after replacing the Inner Lid Gasket, other parts may be in need of repair. Please contact Zojirushi Customer Service.

When the Inner Lid Gasket hardens, changes shape, turns white, or otherwise becomes worn out.

Please purchase and replace with a new one.

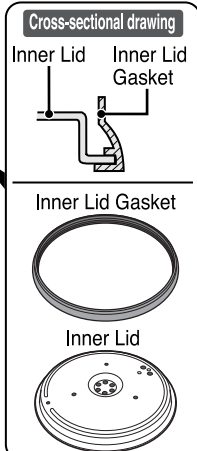
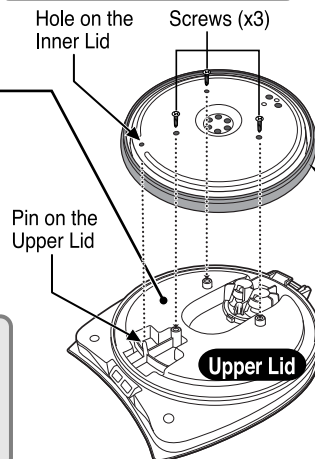

# Perform every 1-3 month(s) of usage

## CITRIC ACID CLEANING

Do not drink the water used for citric acid cleaning.

**NOTE** In order to prevent gas bubbles and bubbling-over, the Citric Acid Cleaner for Electric Water Boilers (CD-K03E-JU) is recommended for cleaning. To purchase this cleaner, please visit an authorized Zojirushi dealer or [www.zojirushi.com](http://www.zojirushi.com).

**Preparation:**  
Check that the Filter is attached to the Water Tank.

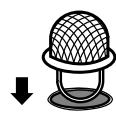

**NOTE**  
● If the Filter is dirty, remove it from the Water Tank, wash with a soft brush and reinstall.

**1** Put 1 package of the Citric Acid Cleaner CD-K03E-JU in a cup and add warm water to dissolve. Pour it into the Water Tank and fill with water to the Maximum Water Level Line.

**NOTE**  
● Do not fill over the Maximum Water Level Line. (Hot water may spill out, resulting in scalds.)

**2** Close the Upper Lid, insert the Power Plug and press the **REBOIL QUICK TEMP** button for more than 3 seconds.

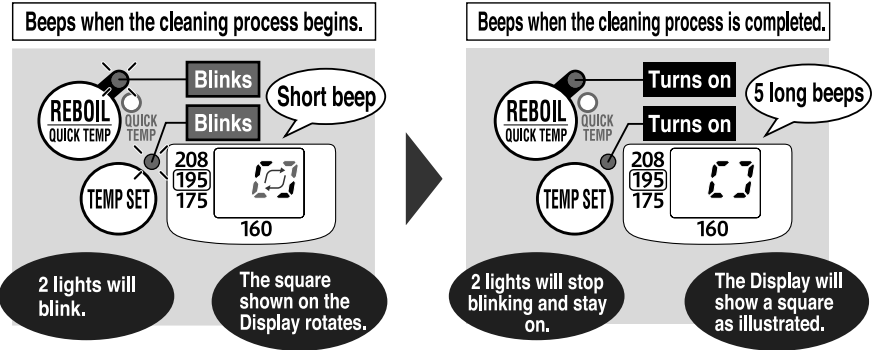

**Cleaning time:** ※  
**Approx. 1.5 hours.**  
※ Cleaning time may vary depending on the amount of water, water temperature and room temperature.

**3** Unplug the Power Plug, detach the Upper Lid and dispose water where indicated "EMPTY FROM HERE." (Please take precautions not to splash water on the Hinge.)

**When disposing hot water:**

- Take precaution with the hot water and steam. You may scald yourself.
- Take precaution as hot water may drip from the Spout, causing scalds.

**4** To rinse, fill the Water Tank with water. Boil and dispense about a cup of hot water to rinse out the Spout, allow to cool, then dispose the remaining water.

To cancel the Citric Acid Cleaning at any time, unplug the Power Plug for more than 5 seconds.

**NOTE** ● Repeated citric acid cleaning may be necessary for hard-to-remove residues or if water does not dispense smoothly.

● If mineral or alkaline ionized water is used, calcium tends to build up on the surface of the Water Tank. If scale accumulates on the Water Tank or the Filter, boiling may become louder than usual and water may not dispense smoothly. Frequent cleaning is recommended when using mineral or alkaline ionized water.

## REPLACEMENT PARTS

- Replacement parts may be available for an additional charge. Please replace damaged parts only with new parts.
  - When purchasing parts, please record the model number and part name beforehand. Parts can be purchased through [Zojirushi.com](http://Zojirushi.com), by contacting Zojirushi Customer Service, or the store where you purchased the product.
- Zojirushi Customer Service**  
1-800-733-6270 [www.zojirushi.com](http://www.zojirushi.com)

Part Names	Part Numbers
Inner Lid Gasket	625702-00
Filter	627402-00
Citric Acid Cleaner for Electric Water Boilers (1 oz. / 30 g × 4 packets)	CD-K03E-JU

# Q&A ON PRODUCT USE

Is it okay to use the product for heating liquids other than water?	▶ Do not fill the product with any liquid other than water. It may cause malfunction, or may overflow and cause scalding.	▶ pg.3
Does the water need to be changed every day?	▶ To prevent odor and scale build-up, please change the water at least once a day.	▶ pg.10
Is it okay to use mineral water or alkaline ionized water?	▶ Yes. However, when mineral or alkaline ionized water is used, a floating residue may develop or milky white substance may form on the surface of the Water Tank. This is due to the ingredients in the water and is harmless to your health. Frequent cleaning is recommended.	▶ pg.9 ▶ pg.17
I accidentally drank water while performing the Citric Acid Cleaning. Is this harmful to my health?	▶ Please follow the instructions shown on the package of the citric acid cleaner CD-K03E-JU.	
Is it okay to leave the product unattended while it is turned on?	▶ It is safe to use the product unattended as it has the Automatic Shut-Off function (power to the heater will be automatically turned off), which will be activated once it is empty of water. However, be careful not to repeat the boiling process without filling the Water Tank with water, as the Nonstick Coating may discolor and peel.	▶ pg.11

## TROUBLESHOOTING GUIDE

Please check the following points before calling for service.

Condition	Cause	Remedy
Water does not heat up.	▶ The Power Plug is not connected to an electrical outlet.	▶ Connect the Power Plug.
Water does not boil.	▶ The Quick Temp mode is selected. (Water does not reach a boil under the Quick Temp mode.)	▶ Press the REBOIL/QUICK TEMP button, and select the Regular Boil mode. (see pg.14)
Hot water has a disagreeable odor.	▶ Scale or other residue has accumulated on the Water Tank.	▶ Perform citric acid cleaning. (see pg.17)
	▶ You have not performed citric acid cleaning regularly.	
	▶ The product has not been used for a long time.	▶ Boil water, press the UNLOCK button, and then dispense about 34 oz. (1 liter) of hot water. Discard the remainder. (see pg.9)
	▶ Tap water is used under the Quick Temp mode.	▶ If this is an issue, use the Regular Boil mode instead. (see pg.14) The Regular Boil mode purges chlorine in tap water by boiling completion.
	<ul style="list-style-type: none"> <li>● A mild plastic odor may be noticeable with a new product. This odor will gradually fade away.</li> <li>● You may smell chlorine (used for sterilization of tap water) after boiling.</li> </ul>	
Water leaks from the Spout or spills out from the Steam Vent.	▶ Check that the Water Tank is not filled over the Maximum Water Level Line.	▶ Pour out the excess water until it is below the Maximum Water Level Line.

# TROUBLESHOOTING GUIDE (cont.)

Condition	Cause	Remedy
Steam emits while heating water using the Quick Temp mode.	<ul style="list-style-type: none"> <li>The Quick Temp mode does not heat water until it boils. However, some steam may be produced depending on the temperature of the room and water, and the atmospheric pressure.</li> </ul>	
The Quick Temp mode cannot be selected.	Is the 208°F Keep Warm mode selected?	Select the 195°F, 175°F or 160°F Keep Warm mode, then select the Quick Temp mode. (see pg.14)
The 208°F Keep Warm mode cannot be selected during the Quick Temp mode.	You cannot select the 208°F Keep Warm mode during the Quick Temp mode.	Use the Quick Temp mode for other than the 208°F Keep Warm mode. (see pg.14)
Water does not dispense or does not pour properly.	Hot water does not pour properly a few minutes after boiling.	Bubbles form from the bottom of the Water Tank while water is being heated. Wait for a short period of time before dispensing hot water again.
	Scale or other residue has accumulated on the Water Tank and Filter.	Clean the Water Tank and Filter. (see pg.16)
	The Automatic Dispense Lock is activated.	Press the UNLOCK button, then press the DISPENSE button. (see pg.10)
	The Power Plug is not connected to an electrical outlet.	Connect the Power Plug.
	Scale may build up in the water route or Electric Pump and prevent water from dispensing smoothly.	Perform citric acid cleaning. (see pg.17)
A filmy, floating residue is noticeable. (Could the Nonstick Coating be peeling off?)	Residue is due to the mineral content in water, not from corrosion of the Water Tank or peeling of the Nonstick Coating.	
Milky white and rough-surfaced objects have built up on the surface of the Water Tank.	Excessive accumulation of scale and other build-up on the surface of the Water Tank can cause boiling to become louder.	<div style="border: 1px solid black; padding: 10px; text-align: center;"> <p><b>Scale</b></p> <p>Over time and use, calcium and other minerals contained in water build up on the surface of the Water Tank and Filter. It is called "scale" and is harmless to your health.</p> </div>
Boiling is louder than usual.		
Red rust-like spotting appears on the surface of the Water Tank.	Caused by iron in the water, not deterioration of the Water Tank.	
White floating residue is noticeable.	Remove the Inner Lid and check the plastic part of the Upper Lid for abnormalities. (see pg.16)	If this part is discolored or if it feels rough to the touch, replace it (must purchase separately).
Water is not hot.	Initially upon boiling or if it has been a while after dispensing, the water may not be very hot due to water remaining in the Water Level Gauge.	Please discard the first cup (of the hot water).
	Is the Timer set?	Press the REBOIL/QUICK TEMP button. (see pg.14)

# TROUBLESHOOTING GUIDE (cont.)

Condition	Cause	Remedy
The outer surface of the product becomes hot.	<ul style="list-style-type: none"> <li>When the water temperature and/or room temperature is high, the outer surface of the product may reach up to 140°F (60°C). This is not a malfunction.</li> </ul>	
The Power Cord becomes hot.	<ul style="list-style-type: none"> <li>The Power Cord may become hot while the water is boiling. This is not a malfunction.</li> </ul>	
You may hear a rattling or metallic noise when opening and closing the Upper Lid or during boiling.	<ul style="list-style-type: none"> <li>This sound is normal and comes from the movement of the weight which prevents hot water from flowing out when the product is overturned.</li> </ul>	
Humidity builds in the Display window or the Water Level Gauge.	<ul style="list-style-type: none"> <li>If water is filled from a faucet or the product is placed directly on a sink and the bottom becomes wet, water may go inside of the Body and the Display or the Water Level Gauge may show moisture. This may cause short circuit or electric shock. Unplug the Power Cord and contact Zojirushi Customer Service.</li> </ul>	

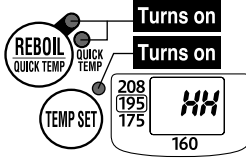
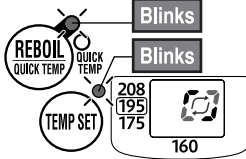
Error Displays and their Meanings	3 lights turn on and "HH" appears on the Display.		The Water Tank is low on water or hot water was added to the Water Tank, causing the Automatic Shut-Off function to engage.	Unplug the Power Plug and wait until the Water Tank cools down. Add water and plug in the Power Cord. (see pg.11)
	2 lights blink at the same time and the Display shows a rotating square.		The Water Tank is in a citric acid cleaning cycle.	To cancel the citric acid cleaning cycle, unplug the Power Plug and wait more than 5 seconds before plugging back in. (see pg.17)
	E2, E3 or E4 is displayed.		Indicates malfunction.	Please contact Zojirushi Customer Service.

Replacement for the Upper Lid	Inner Lid Gasket	<ul style="list-style-type: none"> <li>The Inner Lid Gasket is replaceable, and we recommend that you replace it about once a year. If steam leaks from the gap between the Upper Lid and the Body, or if the Inner Lid Gasket hardens, changes shape, turns white, or otherwise becomes worn out, please replace it. (see pg.16)</li> </ul>
	Plastic Parts	<ul style="list-style-type: none"> <li>The plastic part of the Upper Lid may deteriorate over use. When replacing the Inner Lid Gasket, check the plastic part. If discoloration occurs or the surface becomes coarse, replace the Upper Lid (must be purchased separately). (We take care in only using materials for the plastic parts that are safe and hygienic for food contact.)</li> </ul>

**The Nonstick Coating of the Water Tank may become damaged with use. Contact or call Zojirushi Customer Service to discuss available options we may have for you: 1-800-733-6270**



[www.zojirushi.com](http://www.zojirushi.com)

CD-WCC30KT ©(B)(A)