

**HOIST A TOP**<sup>®</sup>

*Crank 2004  
thru 2006  
Single Line Pull*



Call toll free 1866 284 7428  
langeoriginals.com copyright  
lange originals 2017

# Jeep Extended Top 2004/2006

## Installation Instructions / Hoist-a-Top™

The hoist-a-Top is designed to help you remove your Jeep hardtop quickly and easily by yourself. This kit requires a garage or carport. This Hoist-a-Top mounts on a back wall and on a strong ceiling joist.

If you have any problems, question, or missing parts, do not call your supplier, call Lange directly toll free **1866 284 7428**.

Parts Included		
Drawing #	Description	Qty.
1	Crank Wire Puller	1
2	Hoist Frame T Section	1
3	Frame Arms	2
4	Center Frame Arm with Balance Slide	1
5	Pulleys	2
6	Screws #parts bag	1
7	End Caps	3
8	Nylon Capture Nuts 3/8"	3
9	Rubber Coated J Hooks	2
10	Rubber Coated L Hook	1
12	Foam Top Protectors	3
11	Eye Bolt 3/8" shorty	1

### Tools Required

Electric drill with screw bit,  
Phillips screw driver,  
adjustable wrench,  
Measuring tape & pencil.

### 1 Cable Crank

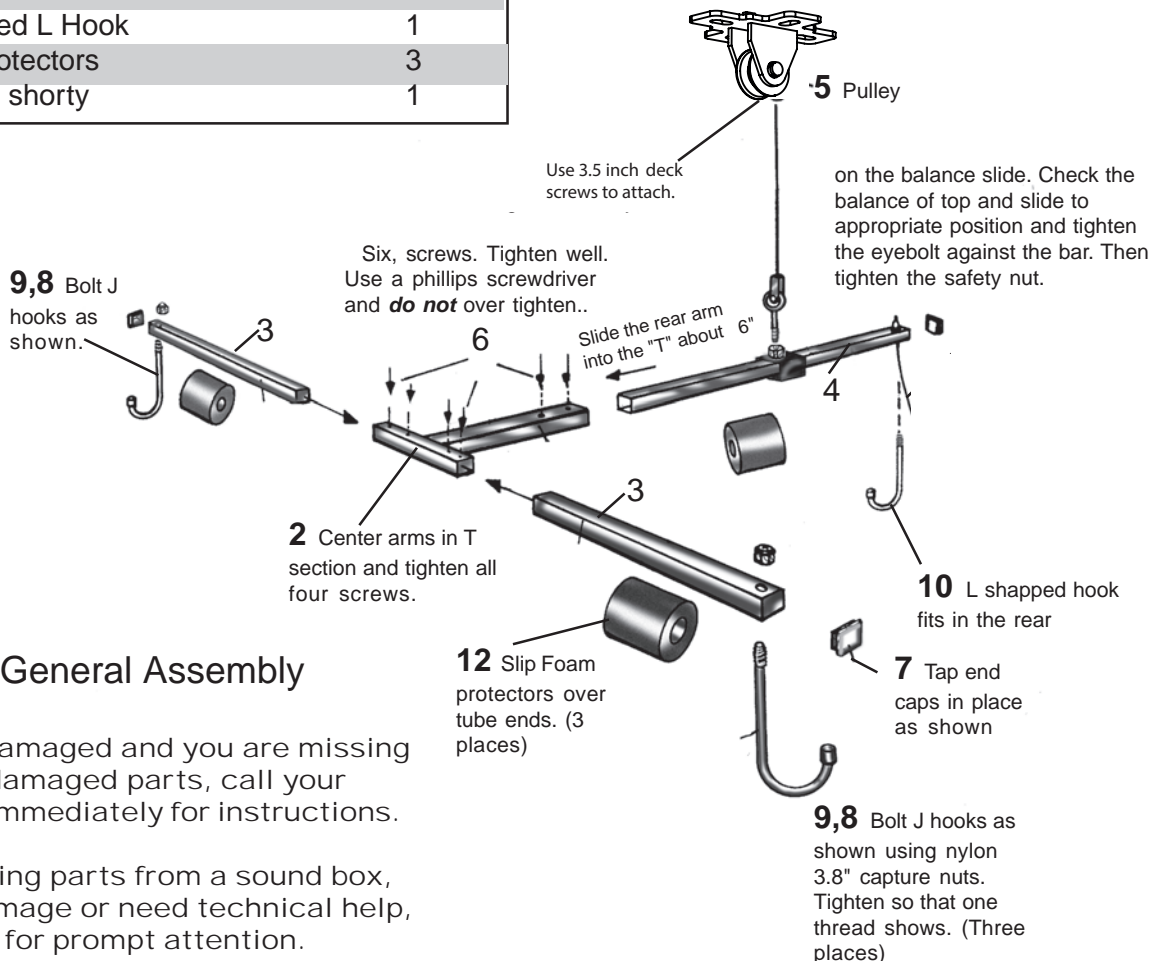

Fig. 1 General Assembly

If your box is damaged and you are missing parts or have damaged parts, call your selling dealer immediately for instructions.

If you are missing parts from a sound box, showing no damage or need technical help, call us directly for prompt attention.

Monday thru Friday 8:30 to 4:30 Mountain Standard Time Call toll free 866 284 7428 Do not call your dealer!

## Lifting Cautions

Never lift your top so it is tight against the ceiling. This puts undue stress on the top and the hoist. Keep your body, especially your hands away from edges of the top. We recommend you push or pull the top from the side and not use the bottom edge. There is a natural tendency to align the top with your fingers under the edge. Periodically check nuts and bolts on the Hoist-a-Top® system for tightness. Also, inspect the ceiling mounting points for damage, or bent parts.

All Garages are different. Carefully read and watch the video and written instructions before installing. If you are unsure or uncomfortable with installing this product contact a structural professional. Always test this mechanism using a static and live load. Never stand, allow children, or pets under a lifted object on this mechanism. Misuse or improper installation of this product can result in serious injury or death. Follow all safety rules and regulations of tools and ladders while installing this product. Wear safety glasses, gloves, and boots while installing this product. Never walk under or allow others to either play, stand, or work under the top.

If you need help or are missing a part **DO NOT CALL YOUR DEALER. You will receive faster support though the factory 1-866-284-7428** We offer technical support Monday through Friday 9:00 AM to 4:30 PM Mountain Standard Time. Send us an inquiry via our website [hoistatop.com](http://hoistatop.com) anytime, or [contact1@langeoriginals.com](mailto:contact1@langeoriginals.com). No question or problem is trivial so we'll try and help any way we can. We use these products ourselves and like them, we hope you will too. Lange Originals® is not responsible for damage or personal injury due to improper installation, custom installation that doesn't follow the instructions, or neglect.

## Site Preparation

Ceilings that have a height of 7 to 10 feet work well with this product. Ceilings that are higher than 10 feet please call the factory. This system has a single line pull and requires the top to "balance" before successful lifting occurs.

Test your lift the first time with a dead load and not your top. A dead load means at least 100 pounds of dead weight lifted up to the ceiling and then down to the floor. Do this several times to familiarize yourself with the operation of the Crank and check the fasteners and frame assembly. Don't skip this step.

Caution-never stand under the top when in the stored ceiling position. Keep children and pets from playing under the top. Keep the puller out of their reach or lock with a chain.

Caution-never lower or raise the top with your hand under the edge. Always push or pull from the side.

Caution-make sure all fasteners attaching your top are removed before lifting. Lift the top by hand slightly to check that it will release easily. Trying to lift your top with the Jeep still attached will damage your top or the hoist mechanism. Rubber seals can stick. Break them loose before lifting. Do not lift the top so high that you pull the top against the upper pulley. Damage to the ceiling or top will occur. Stop before the hoist frame reaches the pulley.

Caution-make sure the back tailgate door is latched before lifting on '92 or earlier jeeps. Watch the rear glass if open on newer jeeps to avoid damaging the glass.

Caution-occasionally check the tightness of all bolts and fasteners. Always check the wire cable puller for loose bolts before each cycle.

Caution-align your Jeep carefully before lifting off the top. This will avoid damage to the vehicle top when the top swings to its lift center. Tape on the floor of your garage will help align the vehicle each time.

Copyright , all rights reserved, design copyright 1998, all rights reserved Lange Originals . Patents pending. Jeep is a registered Trademark of Chrysler Corp.

We give a one year warranty from the date of purchase on this product if installed and operated according to these instructions. This warranty covers parts if found defective and does not include a provision for adjustment if abused or damaged due to neglect or misuse. Liability for any application of this product is limited to the replacement or repair of said product and does not include consequential damages. Please call customer service (801-262-7322) for return instructions and warranty verification. **Proof of purchase date required.**

## Questions

If you have questions or gripes, please call, we listen. We offer technical support Monday through Friday 9:00 AM to 4:00 PM Mountain Standard Time. No question or problem is trivial so we'll try and help any way we can. We use these products ourselves and like them, we hope you will too.

## Returns

We accept returns purchased directly from us within a 30-day period if you are not satisfied. We ask that you return them in as-new condition. Items that do not meet this condition may be charged a refurbishing or restocking charge. Contact the factory for a Return Authorization number which must be on the address of the package. Returns purchased from a selling dealer must be returned to them directly.

## Parts

We stock parts. If you need a replacement, just call for pricing and shipping information. SEE OUR WEBSITE [WWW.LANGEORIGINALS.COM](http://WWW.LANGEORIGINALS.COM)



## Lange Originals

3651 South 700 East  
Salt Lake City, UT 84106  
801-262-7322 FAX 801-262-5087  
[www.langeoriginals.com](http://www.langeoriginals.com)

# Installation Steps

Please follow in order and read carefully before starting.

- 1 Prepare your site, measure and mark according to Figure 2 and 2A. Use Fig. 3 to layout the ceiling with 2, 2x6 supports.

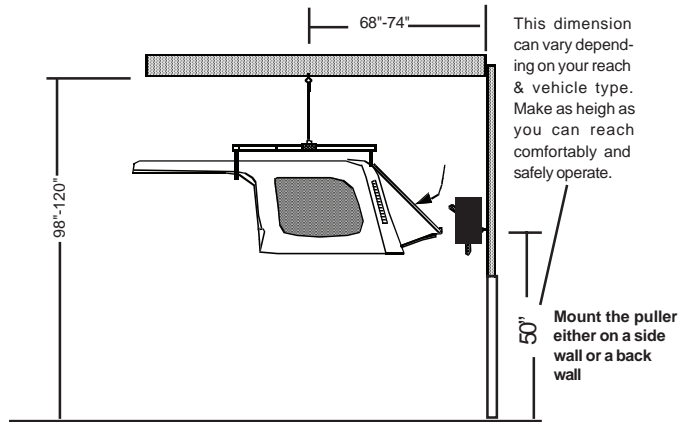

Figure 2, Typical Layout Measurement

Use Figures 2 and 3 to mark your ceiling at the point where the pickup spot for your Jeep is located. Back the Jeep in to the garage and drop a plumb bob to find the approximate spot. Leave enough room at the back between the wall and the top to work raising and lowering your top.

Install two cross braced 2x6's, laying flat, and longer than the length of the gap between studs centered on the middle mark you drew with your pencil and plumb bob. The pulleys should be installed one at the back wall and one under where you will lift your Jeep top. Leave enough room between the wall and the rear of the Jeep to work and open the window. Install 2x6's with provided long screws. These figures are shown as if you were looking up at the ceiling and the studs were exposed without sheetrock. Use the 3 1/2 inch deck screws to mount the 2x6's and pulleys.

Next, install the Crank using Figure 4 as a guide. Use the lag bolt fasteners from the parts bag to mount the Crank.

- 2 Assemble the hoist frame as shown in Figure 1. Position the Slide on the long bar and center approximately as shown. Put the shorty eye bolt with nut on the slide and tighten lightly. Leave the lock nut loose for now. Setting the Balance Slide will follow.

Slip all Round Protectors on to the frame as shown in Figure 1 and seat the End Caps on each end of the frame arms. Attach Hooks with the nylon nut and tighten until one thread shows at the top of the nut. The "L"-shaped hook goes at the back.

## Garage Door Side

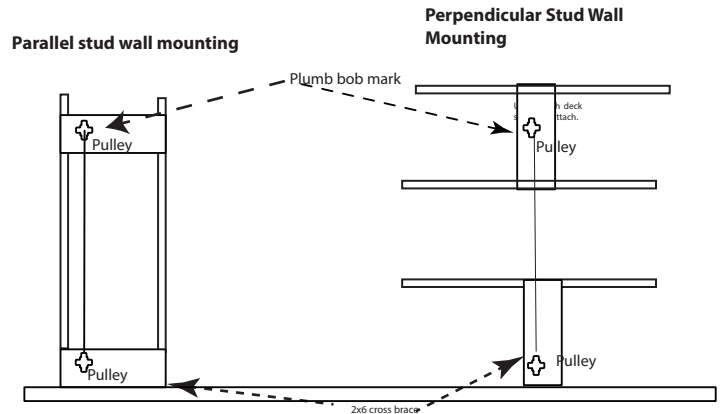

Rafter Layouts Fig. 3

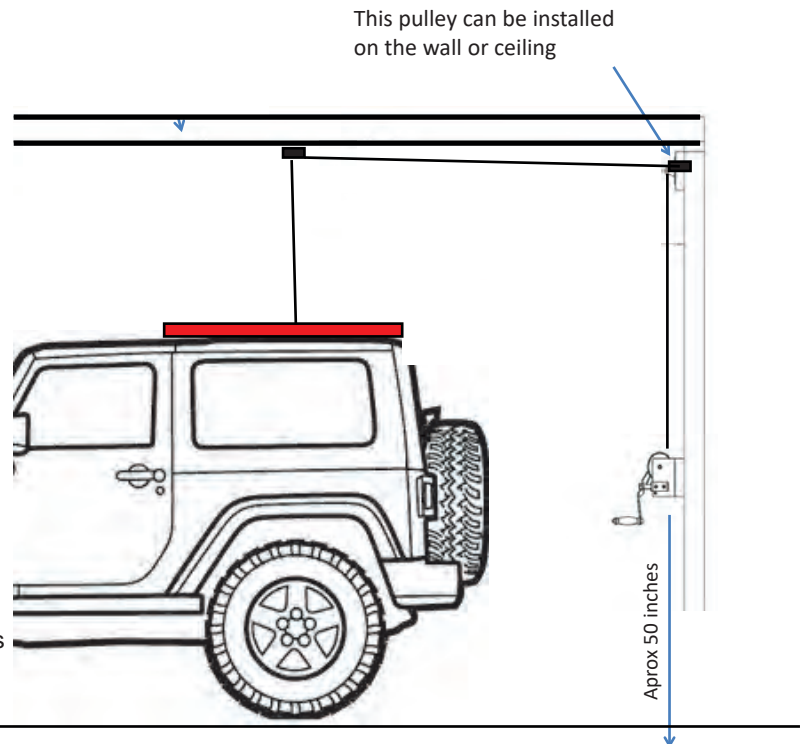

Fig. 2 A

### Installation of the crank unit

1. Remove the spool from the crank unit using the 11/16 and 9/16 socket
2. Cut one section of 2x6 to 20 inches. Mount it to your wall using at least 4 screws (at least two in each stud) approx. 50-inches above the floor.
3. Mount your crank unit to the center of the 2x6 using the 2 3-inch lag screws and washers provided.

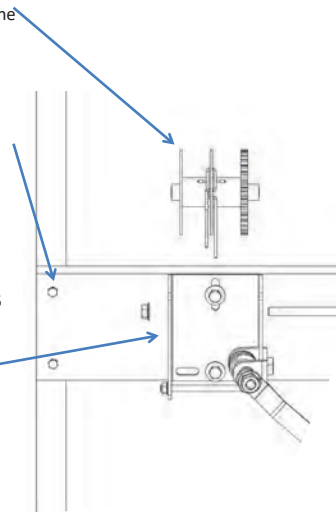

Fig. 4 Mounting the Crank

## 3 Very important !Warning! Follow these instructions very carefully for safe operation.

Test the whole system with 200 pounds or more of dead load before using on your top. Attach a weight or have a heavy person hang from the hoist frame while you operate the Crank. **Do this a minimum of five times--very important. Report any problems immediately to Lange 801-262-7322 for technical help.** This tests the mechanism, the pulleys in the wall and ceiling, and lets you become familiar with the operation of the Crank Puller Mechanism. Try this several times, work it hard both up and down to test everything, especially the ceiling mounting. For instructions on operating the Crank Puller see the pamphlet inside the Crank's shipping box.

### Lifting Your Top

**Check your complete lift system by lifting a dead weight up and down at least five times. This will test lifting points and you will practice using the Crank. Please do this before lifting your top!**

Helpful Hint: Fill an empty one-gallon milk carton about 3/4 full of water. Slip the handle of the carton through the rear hook on the empty hoist frame. This will balance your hoist so you can raise it to the ceiling leveled (without top).

Lift the hoist to the ceiling and back your vehicle directly under the hoist. (It may pay to mark a line on your garage floor to aid in aligning your vehicle under the hoist). **Open both doors. Remove all attaching hardware holding your top and the light plug/washer tube (if any).**

Position the frame as shown in Figure 5.

standard equipment. **Open the rear window and slip the hook between the glass and the top.** Turn the hook under and position in the center of top.

Position the J Hooks under the edge at the rear edge of the door opening. Make sure the Crank is set to lift. See instructions in the Crank's manual for lifting and lowering settings. Make sure the top will release and then lift the top 3 inches with the Crank. Use one hand to balance the top until it clears the vehicle body. Make sure the top balances so that it remains fairly level when in the stored position (Hanging slightly lower at the back will aid in installation). To change the balance, move the balance slide (either to the front of the jeep to lower the rear or to the rear of the jeep to lower the front). **Make sure you replace the top back on the vehicle before moving the slide.** When the balance point is found, tighten the eyebolt until it presses hard into the rear support bar, then tighten the safety lock nut to additionally secure the eyebolt. Lift your top slowly a few inches and recheck everything.

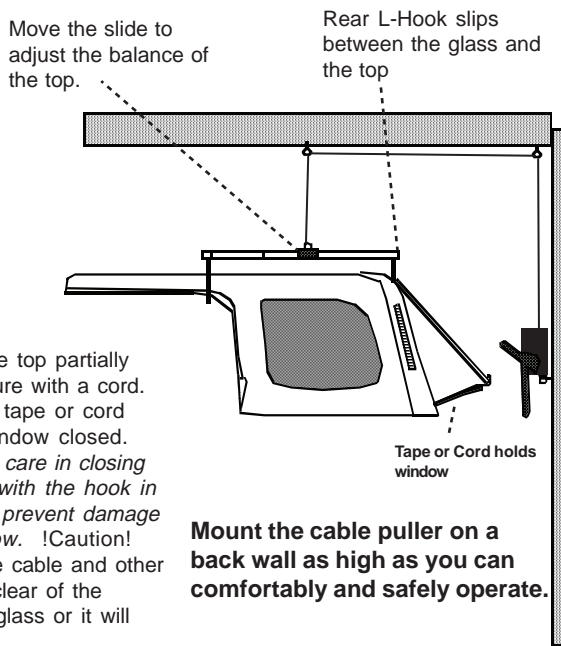

Close the top partially and secure with a cord. Optional tape or cord holds window closed. *Exercise care in closing window with the hook in place to prevent damage to window. !Caution! Keep the cable and other objects clear of the window glass or it will break.*

**Mount the cable puller on a back wall as high as you can comfortably and safely operate.**

Mounting Connections Fig. 5

## *Servicing the Crank Unit*

**Please lubricate the gears regularly with a high-strength grease. This insures long life for the gear set.**

**Note that the gears are designed for some wear and shavings or metal bits are normal. This is a sacrificial process where one gear is softer than the other.**