



THE WORK EARBUDS

CLASSIC

USER MANUAL

TABLE OF CONTENTS

- INTRODUCTION1
- UNIT AT A GLANCE2
- FEATURE AT A GLANCE3
- QUICK START GUIDE4
- FUNCTIONS5
- SOUND PROFILES6
- AWARENESS & ANC MODE6
- CHARGING YOUR DEVICE7
- THE PERFECT FIT9
- FACTORY RESET10
- SAFETY GUIDELINES11
- FAQ & ADDITIONAL RESOURCES12
- SUPPORT12
- LIMITED WARRANTY12
- SPECIFICATIONS13

INTRODUCTION

Welcome to your new The Work Earbuds Classic!

At Raycon, we develop and design innovative electronics so you can move and conquer your daily fast-paced life.

Before using your product, we strongly encourage you to fully read through this user manual. You can also visit our support center at www.rayconglobal.com/support.

This web page has more specific guidelines and helpful videos for you to navigate your product.

For best performance, charge fully before first use.

We are Raycon. We create carefully crafted wireless audio products for go-getters who need tech that keeps up with them.

We teamed up with expert engineers, leading taste-makers, and platinum artists to design products you'll love to use.

We believe in the early risers and the one-more-milers of the world. Premium audio, inspired by you.

Pairing ID: The Work Earbuds Classic

INTERNATIONAL MANUAL

For international versions of the manual, please visit rayconglobal.com/support.

UNIT AT A GLANCE

- 1. Charging Port
- 2. LED/Battery Indicator
- 3. Charging Connectors
- 4. Gel Tip
- 5. Microphone
- 6. Touch Controls
- 7. Wireless Charging Capsule
- 8. Reset Button

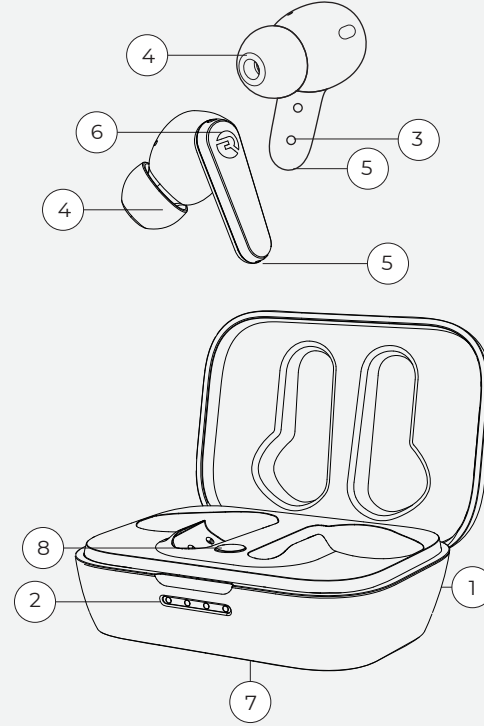

UNIT AT A GLANCE

SIMPLE ACTIVE NOISE CANCELLATION

Staying focussed is hard enough. We make it easy to tune out the noise with Simple Active Noise Cancellation.

VIVID VOICE TECHNOLOGY

The Work Earbuds' Vivid Voice Technology makes sure your words are heard clearly and commandingly.

AWARENESS MODE

Stay focussed but be conscious of everything around you with Awareness Mode.

28 HOURS OF BATTERY LIFE

World doesn't pause to charge your earbuds. That's why ours have almost an entire day's worth of battery life.

IPX5 WATER RESISTANCE

You never know where your job will take you, that's why the Work Earbuds are equipped with IPX5 water resistance.

THREE SOUND PROFILES

The Work Earbuds feature three unique sound profiles, putting you in control of what you hear and how you hear it.

QUICK START GUIDE

1. Take your earbuds out of the charging capsule. Both earbuds will power on and connect to each other automatically.

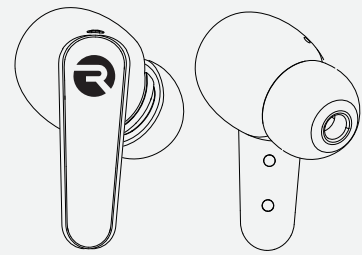

2. From the source device, go to Bluetooth settings and ensure Bluetooth is on. Search for "The Work Earbuds Classic" and select it to pair.



3. Enjoy your Raycon Work Earbuds Classic!

FUNCTIONS

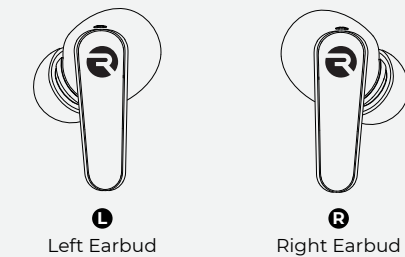

Control audio and other functions by tapping the logo on the earbud.

- Tap **Ⓡ** for **Volume Up**
- Tap **Ⓡ** for **Volume Down**
- Tap **Ⓡ** 2 times for **Play/Pause**
- Tap **Ⓡ** 3 times for **Next**
- Tap **Ⓡ** 3 times for **Previous**
- Tap **Ⓡ** 4 times for **Voice Assistant**
- Hold **Ⓡ** for 3 secs to toggle between **Sound Profiles**.
- Hold **Ⓡ** for 3 secs to toggle **Awareness & ANC Mode**.
- Tap **Ⓡ** 2 times to **Answer/End call**.
- Hold **Ⓡ** for 3 secs to **Reject call**.
- Place earbuds in capsule, close lid, and remove from capsule to **Power On**.
- Hold **Ⓡ** for 10 seconds or place earbuds in charging capsule to **Power Off**.

SOUND PROFILES

Your sound, your way! As our sound profiles were crafted by artists and producers at the top of the industry, you're in good hands.

PURE SOUND - Our most refined sound, perfect clarity to hear every single note.

BALANCED SOUND - A leveled sound that is great for all around performance and warmth.

BASS SOUND - Our bass boosted sound, great for songs with strong beats and a go-to for bass lovers.

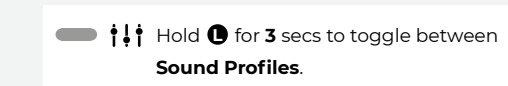

AWARENESS & ANC MODE

AWARENESS MODE

Hear what's happening around you.

ANC MODE

Focus and block out unwanted outside noise.

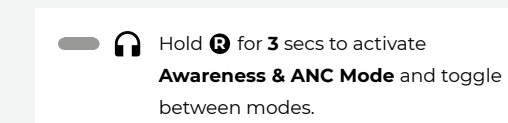

CHARGING YOUR DEVICE

Charging Earbuds: The earbuds will charge automatically when placed in the capsule.

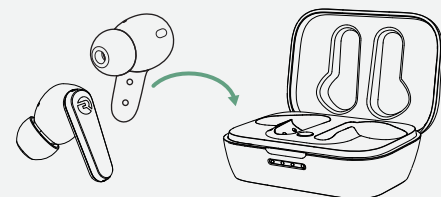

Fully Charged: Once fully charged, the battery indicator lights will stay on.

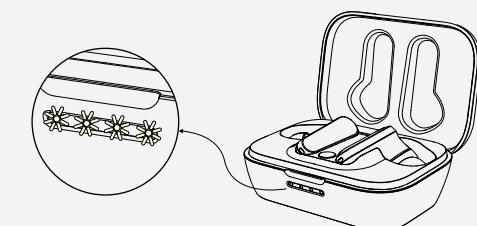

Charging Capsule: Connect your charging capsule to a 5V - 1A power source via the supplied USB-C Cable.

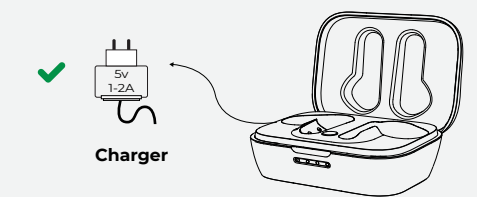

Wireless Charging: Simply place the capsule on any Qi-compatible charging mat.

Battery Status Indicator - After closing the lid of the charging capsule, the battery status indicator lights will display the remaining battery life.

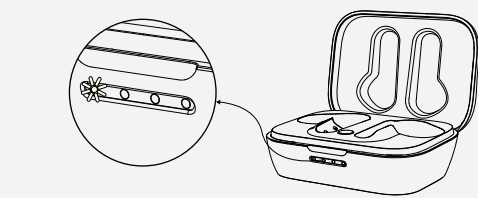

Low-Battery Warning - When earbud batteries are low, a "low battery" voice prompt will play, and there will be 30 mins of playtime left before the earbuds automatically power off.

Call/Play time: about 7 hours

Total battery life: 28 hours

A fully charged capsule can completely recharge the earbuds up to 3 times before needing to recharge the capsule.

THE PERFECT FIT



Insert the earbuds into your ear. Rotate the earbuds slightly forward. The perfect fit should look like this.

GEL TIPS

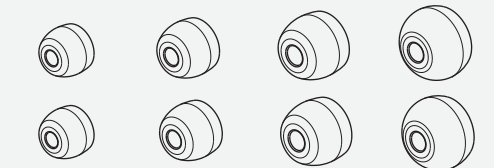

Customize your fit. Select the right size gel tip for you!

FACTORY RESET

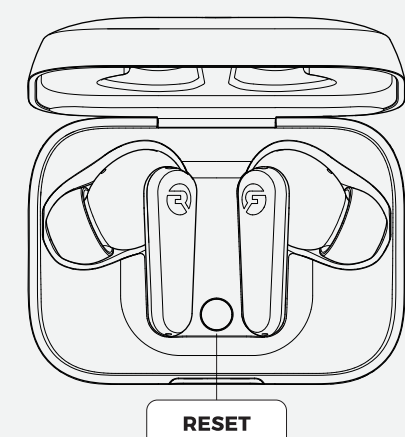

FACTORY RESET - First, delete the "The Work Earbuds Ultra" from the Bluetooth settings on your device, and place your earbuds back in the capsule.

While earbuds are in charging capsule, hold the "Raycon" button 5 seconds or until the battery indicator lights flash. Please ensure the that the charging capsule has enough charge.

Close the charging capsule to complete the reset function.

Follow instructions in Quick Start Guide section to reconnect earbuds to Bluetooth device.

SAFETY GUIDELINES

Please follow the safety guidelines below at all times when operating or caring for your device.

• Be wary of any edges, uneven surfaces, and metal parts, including on accessories and product packaging, to prevent any possible injury or damage.

• Listen to music at a proper volume to avoid damaging your hearing and the earbuds.

• Do not store in high temperatures, such as in a hot vehicle or in direct sunlight.

• Do not expose the earbuds or any of its supplied parts to rain or other liquids for extended periods of time.

• Do not drop or cause undue impact to the earbuds.

• Do not modify, repair, or dismantle the product on your own.

• Do not use any diluent or volatile liquid to clean the product.

• Do not use the product in a hazardous location.

FAQ & ADDITIONAL RESOURCES

For frequently asked questions about your device, simply go to www.rayconglobal.com/support. Select your product to find additional resources on how to operate your product, including helpful tips and videos.

SUPPORT

If your device is not functioning correctly, please visit www.rayconglobal.com/support for customer support, and we will be more than happy to help you.

LIMITED WARRANTY

For more information and instructions on how to get warranty service, visit www.rayconglobal.com/warranty.

SPECIFICATIONS

Model Number: RBE783
Bluetooth Name: The Work Earbuds Classic
RDID: D783-21E-Q321
Bluetooth version: 5.0
Power Input: 5V/ 1A
Capsule charging time: 1.5 hours
Earbud charging time: 1.5 hours
Call / Play time: About 7 hours
Total battery life: About 28 hours
Charging earbuds by capsule: 3 times
Support Profiles: HSP/ HFP/ A2DP/ AVRCP
Sensitivity: 107 +/- 3dB
Frequency Response Range: 20Hz - 20KHz
Bluetooth Range: Up to 10 Meters

FCC WARNING

This device complies with part 15 of the FCC Rules. Operation is subject to the following two conditions: (1) this device may not cause harmful interference, and (2) this device must accept any interference received, including interference that may cause undesired operation. Any changes or modifications not expressly approved by the party responsible for compliance could void the user's authority to operate the equipment.

NOTE: This equipment has been tested and found to comply with the limits for a Class B digital device, pursuant to Part 15 of the FCC Rules. These limits are designed to provide reasonable protection against harmful interference in a residential installation. This equipment generates, uses, and can radiate radio frequency energy and, if not installed and used in accordance with the instructions, may cause harmful interference to radio communications. However, there is no guarantee that interference will not occur in a particular installation.

If this equipment does cause harmful interference to radio or television reception, which can be determined by turning the equipment off and on, the user is encouraged to try to correct the interference by one or more of the following measures:

- Reorient or relocate the receiving antenna.
- Increase the separation between the equipment and receiver.
- Connect the equipment into an outlet on a circuit different from that to which the receiver is connected.
- Consult the dealer or an experienced radio/TV technician for help. The device has been evaluated to meet general RF exposure statement. The device can be used in portable exposure condition without restriction

IC CAUTION:

Radio Standards Specification RSS-Gen, issue 5

- English:
This device contains licence-exempt transmitter(s)/receiver(s) that comply with Innovation, Science and Economic Development Canada's licence-exempt RSS(s). Operation is subject to the following two conditions:
This device may not cause interference.
This device must accept any interference, including interference that may cause undesired operation of the device.
RF exposure statement:
The equipment complies with IC Radiation exposure limit set forth for uncontrolled environment. This equipment should be installed and operated with minimum distance 20cm between the radiator and your body.

- French:
Cet appareil contient des émetteurs / récepteurs exemptés de licence conformes aux RSS (RSS) d'Innovation, Sciences et Développement économique Canada. Le fonctionnement est soumis aux deux conditions suivantes:
Cet appareil ne doit pas causer d'interférences.
Cet appareil doit accepter toutes les interférences, y compris celles susceptibles de provoquer un fonctionnement indésirable de l'appareil.

Déclaration d'exposition RF:
L'équipement est conforme à la limite d'exposition aux radiations de la IC établie pour un environnement non contrôlé. Cet équipement doit être installé et utilisé avec une distance minimale de 20 cm entre le radiateur et votre corps.



@rayconglobal