

TABLE OF CONTENTS

INTRODUCTION1

UNIT AT A GLANCE2

FEATURES AT A GLANCE3

QUICK START GUIDE4

CHARGING YOUR DEVICE5

FUNCTIONS6

MULTI-LINK MODE7

SOUND PROFILES9

STRAP INSTALLATION10

SAFETY GUIDELINES11

FAQ & ADDITIONAL RESOURCES12

SUPPORT12

LIMITED WARRANTY12

SPECIFICATIONS13

INTRODUCTION

Welcome to your new Raycon Fitness Speaker!

We are Raycon. We create carefully crafted wireless audio products for go-getters who need tech that keeps up with them. We teamed up with expert engineers, leading taste-makers, and platinum artists to design products you'll love to use.

We believe in the the early risers and the one-more-milers of the world. Premium audio, inspired by you.

Before using your product, we strongly encourage you to fully read through this user guide. You can also visit our support center at www.rayconglobal.com/support. This web page has more specific guidelines and helpful videos for you to navigate your product. For best performance, charge fully before first use.

Pairing ID: **The Fitness Speaker**

INTERNATIONAL MANUAL

For international versions of the manual, please visit www.rayconglobal.com/support

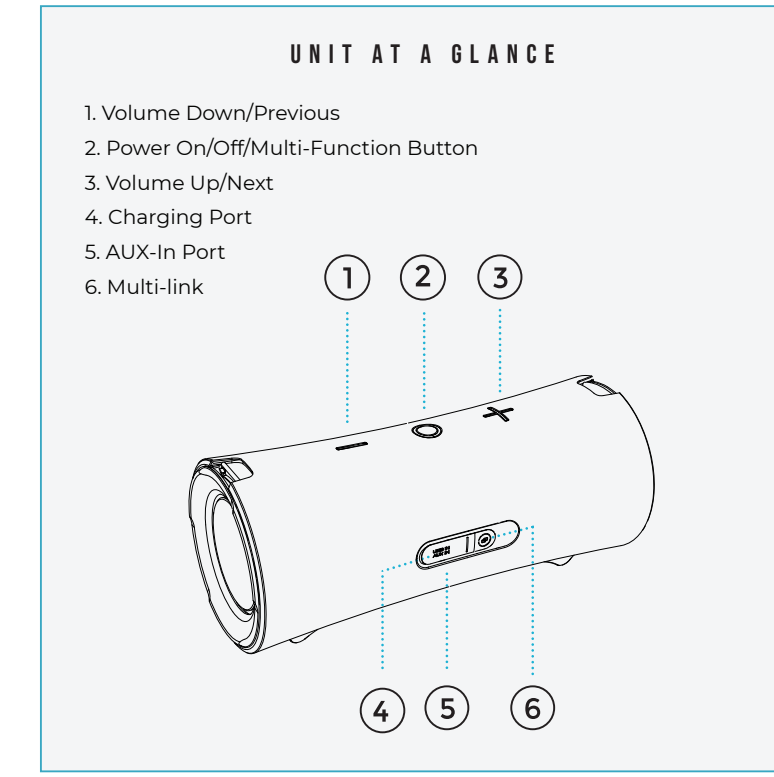

FEATURES AT A GLANCE

DUAL DRIVERS
The Dual Drivers in the Fitness Speaker give you powerful sound to power you through your toughest workouts.

IPX4 WATER RESISTANCE
Whether you're working out in the gym or outdoors, the Fitness Speaker will stand up to whatever you throw at it.

ON THE GO STRAP
Bring the Fitness Speaker wherever your workout takes you with a convenient on the go strap.

MULTI-LINK MODE
Fill the whole house with sound by linking your Fitness Speaker to others via Bluetooth.

12 HOURS OF PLAYTIME
The Fitness Speaker boasts 12 hours of playtime so it's with you for the long haul.

THREE SOUND PROFILES
Different workouts need different vibes, that's why you have three unique sound profiles to choose from.

QUICK START GUIDE

1. Hold "⊕" for about 3 seconds. Speaker will enter pairing mode automatically.

2. From the source device, go to Bluetooth settings and ensure Bluetooth is on. Search for "The Fitness Speaker" and select it to pair.

3. Enjoy your Raycon Fitness Speakers!

CHARGING YOUR DEVICE

1. Use a standard **5V/1-2A charger** or a **PC** to charge this device. Do **NOT** use a power bank.

2. Charge time should be 6 hours. While charging, the red LED will stay on.

3. After fully charging, the LED light will be off.

FUNCTIONS

CONTROL PANEL TOP VIEW

MEDIA PLAYER CONTROL

	Previous	Hold for 1.5 sec
	Volume Down	Press
	Power On	Hold for 3 sec
	Power Off	Hold for 5 sec
	Play/Pause	Press
	Next	Hold for 1.5 sec
	Volume Up	Press

PHONE CALL CONTROL

	Answer/End Call	Press
	Reject Call	Press 2 times

MULTI-LINK MODE

Pair two Fitness Speakers together with Multi-link Mode.

- Power on both speakers and ensure that both speakers are not connected to any bluetooth device.
- On one speaker, press "⊕" to begin pairing. A voice prompt will be audible once speakers are successfully paired.

3. From the source device, go to Bluetooth settings and ensure Bluetooth is on. Search for "The Fitness Speaker" and select it to pair.

4. Enjoy your Raycon Fitness Speakers with Multi-link Model Press "⊕" to unpair speakers.

NOTE:
Please keep speakers within 10 ft of each other for best Multi-link Mode experience.

SOUND PROFILES

Your sound, your way. Our sound profiles are designed by artists and producers at the top of the industry. Press "⊕" 2 times to toggle between sound profiles.

PURE SOUND
Our most refined sound, perfect clarity to hear every single note.

BALANCED SOUND
A leveled sound that is great for all around performance and clarity.

BASS SOUND
Our bass boosted sound, great for songs with strong beats and a go-to for bass lovers.

STRAP INSTALLATION

- Feed one end of the strap into the speaker buckle, underneath the metal rod. In the direction of the arrow.
- Hold the strap buckle, and push the strap outwards, as shown, creating a loop.
- Feed the first end into the bottom portion of the strap buckle. Create a loop and feed the strap into the top portion of the strap buckle.
- Pull in the direction of the arrow to tighten.
- Repeat on the other side.

SAFETY GUIDELINES

- Be wary of any edges, uneven surfaces, and metal parts, including on accessories and product packaging, to prevent any possible injury or damage.
- Listen to music at a proper volume to avoid damaging your hearing and speaker.
- Do not store in high temperatures, such as in a hot vehicle or in direct sunlight.
- Store in cool and dry area.
- Do not drop or cause undue impact to the speaker.
- Do not modify, repair, or dismantle the product on your own.
- Do not expose speaker and any of its supplied parts to liquid such as rain for prolonged periods of time. Please see IPX-Rating for more guidelines.

-Do not expose the speaker to water while charging, as doing so may result in damage to the speaker or the power source.

- When cleaning this speaker, use a soft dry cloth. For more severe stains, dampen the cloth with water only. Anything else increases the chance of dissolving the paint or damaging the plastic.

FAQ & ADDITIONAL RESOURCES

Visit: www.rayconglobal.com/support

SUPPORT

If your device is not functioning correctly, please visit www.rayconglobal.com/support for customer support, and we will be more than happy to help you.

LIMITED WARRANTY

Visit: www.rayconglobal.com/warranty

SPECIFICATIONS

Model Number: RB5940
Bluetooth Name: The Fitness Speaker
RDID: D940-21E-Q321
Bluetooth Version: 5.0
Power Input: DC 5V /1A
Battery Capacity: 7200mAh
Call / Play Time: About 12-14 hours
Charging Time: About 5-6 hour
Charging Current: 5V 1.8A
Driver Unit: 20W x 2
Dimension: 280 x 118 x 120mm
Weight: 1730g ±10
Bluetooth Range: Up to 10 Meters

FCC WARNING

This device complies with part 15 of the FCC Rules. Operation is subject to the following two conditions:
(1) this device may not cause harmful interference, and
(2) this device must accept any interference received, including interference that may cause undesired operation. Any changes or modifications not expressly approved by the party responsible for compliance could void the user's authority to operate the equipment.

NOTE: This equipment has been tested and found to comply with the limits for a Class B digital device, pursuant to Part 15 of the FCC Rules. These limits are designed to provide reasonable protection against harmful interference in a residential installation. This equipment generates, uses, and can radiate radio frequency energy and, if not installed and used in accordance with the instructions, may cause harmful interference to radio communications. However, there is no guarantee that interference will not occur in a particular installation. If this equipment does cause harmful interference to radio or television reception, which can be determined by turning the equipment off and on, the user is encouraged to try to correct the interference by one or more of the following measures:

- Reorient or relocate the receiving antenna.
- Increase the separation between the equipment and receiver.
- Connect the equipment into an outlet on a circuit different from that to which the receiver is connected.
- Consult the dealer or an experienced radio/TV technician for help. The device has been evaluated to meet general RF exposure statement. The device can be used in portable exposure condition without restriction.

IC Caution:
Radio Standards Specification RSS-Cer, issue 5

- English:
This device contains licence-exempt transmitter(s)/receiver(s) that comply with Innovation, Science and Economic Development Canada's licence-exempt RSS(s). Operation is subject to the following two conditions:
This device may not cause interference.
This device must accept any interference, including interference that may cause undesired operation of the device.

RF exposure statement:
The equipment complies with IC Radiation exposure limit set forth for uncontrolled environment. This equipment should be installed and operated with minimum distance 20cm between the radiator and your body.

- French:
Cet appareil contient des émetteurs / récepteurs exempts de licence conformes aux RSS (RSS) d'Innovation, Sciences et Développement économique Canada. Le fonctionnement est soumis aux deux conditions suivantes:
Cet appareil ne doit pas causer d'interférences.
Cet appareil doit accepter toutes les interférences, y compris celles susceptibles de provoquer un fonctionnement indésirable de l'appareil. Déclaration d'exposition RF:
L'équipement est conforme à la limite d'exposition aux radiations de la IC établie pour un environnement non contrôlé. Cet équipement doit être installé et utilisé avec une distance minimale de 20 cm entre le radiateur et votre corps.

FCC ID: 2AZ0V-RB5940
IC: 27185-RB5940

