

# User Guide

## E100 Eardrums

"Inspired by underdogs and big dreams, we are the brand that believes in you. I launched Raycon to inspire people that they can achieve greatness through hard work and passion.

The future is yours to grab. Aim high and never stop."



# Introduction

Welcome to your new Raycon E100 Eardrums Earphones!

At Raycon, we develop and design innovative electronics so you can move and conquer your daily fast-paced life.

Before using your product, we strongly encourage you to fully read through this user guide. You can also visit our support center at [www.rayconglobal.com/support](http://www.rayconglobal.com/support)

The web page has more specific guidelines and helpful videos for you to navigate your product.

For best performance, charge fully before first use.

Pairing ID: Raycon E100

# Quick Start Guide

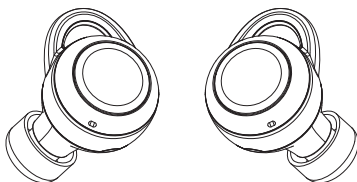

1

First, put the earphones into the charging capsule to charge for 10 minutes, then take the earphones out of the capsule, both earphones will power on and connect automatically.

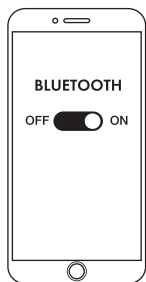

2

Turn on Bluetooth, search "Raycon E100" and click it to pair.

3

Enjoy your E100 Eardrums!

# Charging your Earphones

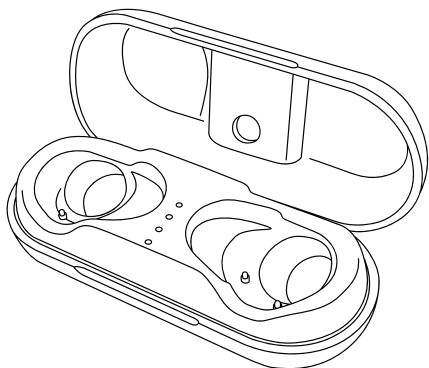

1

To charge your earphones, place them in the charging capsule.

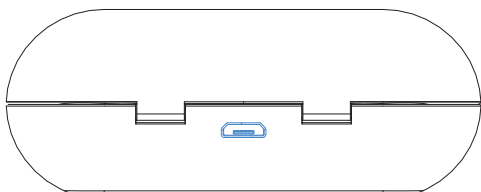

2

Once your capsule runs out of battery, plug the charging cable in the back charging port and connect it to a power source.

# Functions



## Left Earphone

## Right Earphone

Pause / Play  
Answer / Hand Up



**Press Once**

Pause / Play  
Answer / Hand Up

Previous Song



**Press Twice**

Next Song

Volume -



**Press Three Times**

Volume +

Power On / Siri  
Reject Calls



**Hold 2 sec**

Power On / Siri  
Reject Calls

Power off



**Hold 5 sec**

Power off

You may also place the earphones into the capsule to power off.

# Earphone Details

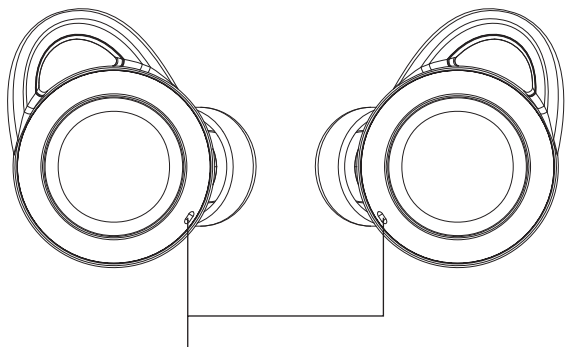

## Charging

Both lights remain red

## Fully Charged

Red lights turn off

- Call / Play: about **5** hours
- Standby: about **2,000** hours
- Water-resistance Grade: **IPX7**

# Capsule Details

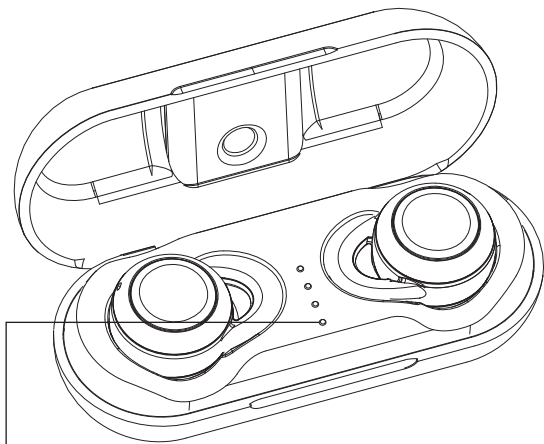

## Charging Indicator

Blue lights turn on

- Charge Capacity **4** times
- Charge time: **1.5** hours

# Unit at a Glance

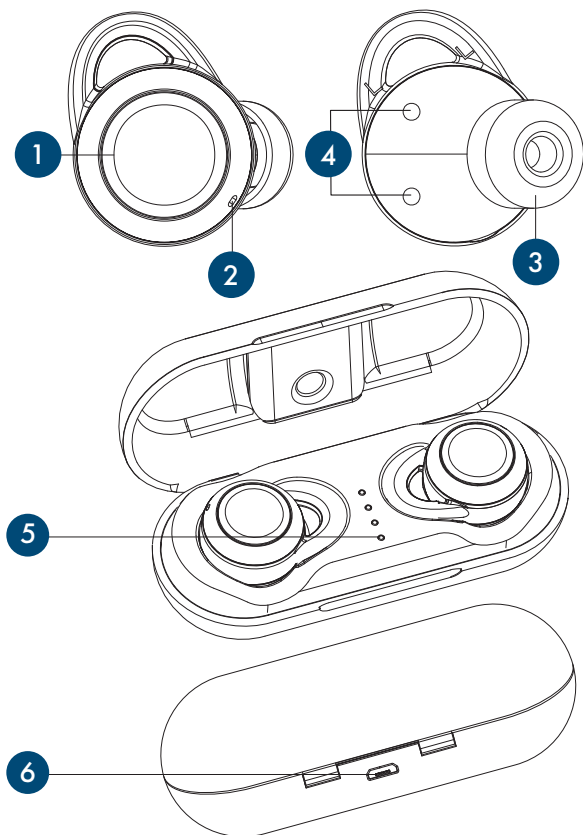

- 1. Control Button
- 2. Microphone/Earphone Indicator
- 3. Gel Tips
- 4. Charging Connectors

- 5. Charging Capsule Indicator
- 6. Charging port



# Customization

Select your size of silicone gel tips:

The E100 earphone's gel tips come in 5 sizes:  
Extra small, small, medium, large, extra large.

Please select the right size according to your preference and fit  
it over the earphones.

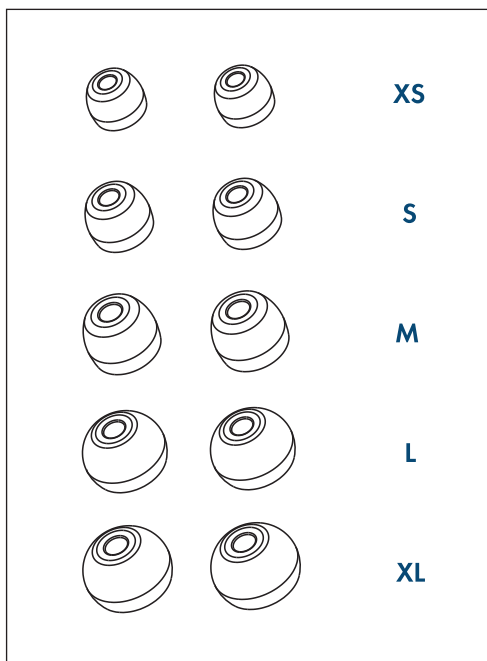

# FAQ and Additional Resources

For frequently asked questions about your device, simply go to [www.rayconglobal.com/support](http://www.rayconglobal.com/support). Select the product and you will find more resources on how to operate your products including helpful tips and videos.

## Safety Guidelines

Please follow the safety guidelines below at all times when operating or caring for your device.

- Be wary of any edges, uneven surfaces, and metal parts, including on accessories and product packaging, to prevent any possible injury or damage.
- Listen to music at a proper volume to avoid hurting your hearing and the earphones.
- Avoid storage in high temperatures, such as in a hot vehicle or in direct sunlight.
- Do not expose the earphones or any of its supplied parts to rain or other liquids.
- Do not drop or cause undue impact to the earphones.
- Do not modify, repair, or dismantle the product on your own.
- Do not use any dilutant or volatile liquid to clean the product.
- Do not use the product in a hazardous location.

## Factory Reset

### **How to factory reset your E100 earphones:**

While the earbuds are off, hold the power on/off button on the left and right earphones for 30 seconds to restore the earphones to factory settings.

### **If you are using a smartphone:**

1. Turn off earbuds
2. Delete all Raycon Bluetooth names in the settings of all paired devices
3. Hold down the earbud buttons on both earphones for 30 seconds.
4. Turn both earphones on by holding down both of the buttons together and wait for earbuds to pair to each other
5. Locate and click on Raycon E100 in your phone's settings to connect

# Specifications

Bluetooth Version: 5.0

Support Profiles: HSP / HFP / A2DP / AVRCP

Operation Range:  $\leq 10\text{M}$

Earphone Battery Capacity: 3.7V / 45mAh  $\times 2$

Charging Capsule Battery Capacity: 3.7V / 460 mAh

Talk / Play Time: About 5 hours

Charging Time: About 1.5 hours

Sensitivity: 100dB

Frequency Response: 20-20k Hz

# Support

If your device is not functioning correctly, please visit

**[www.rayconglobal.com/support](http://www.rayconglobal.com/support) for customer support**, and we will be more than happy to help you.

# Limited Warranty

For more information and instructions on how to get warranty service, visit **[www.rayconglobal.com/warranty](http://www.rayconglobal.com/warranty)**.



@rayconglobal