



Slim Cases

For DJI Pocket 2

Information Sheet

We designed this new case so that it could still provide good protection while stored as well as some protection while filming.

Setup

1. We've included an adjustable wrist lanyard that can be used by looping through the lanyard holes on the right side.
2. The first time you slide your Pocket 2 into the case there may be a small amount of resistance from the red rubber pads. This is normal and will reduce with use. It's recommended that you take care to gently insert it for the first few times until it seats in.
3. The camera screw on the bottom of the case is used to secure your Pocket 2 in place by screwing it into the ¼-20 hole on the base of your Pocket 2. It's designed so that when screwed securely in, the base will sit on a flat surface & mic holes will line up with the sound pipes.
4. The front of the cap has been designed to allow space for the wide-angle lens to be on the camera
5. The two side and front & rear mics are uncovered and three have sound pipes connected so that the Pocket 2 can still record clear audio on those mics.

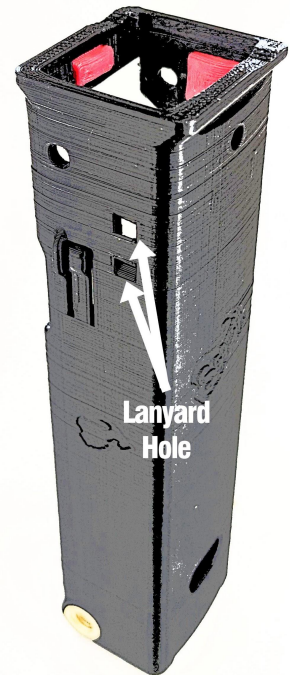

Opening and Closing the Cap

It's essential to make sure that when placing the cap onto the case that you do it carefully following these instructions. The cap allows the gimbal to be held securely in the rubber-lined cap. The cap is designed to slide together with the case and then snap closed.

To put the cap on;

1. Turn off the gimbal and with the cap showing the image in the same orientation as the gimbal in its stowed position.
2. Before the motors release from the stowed position, slide the cap from left to right along the slideway.
3. Keep pushing the cap until you hear an audible click as it snaps closed
4. To remove the cap simply put both your thumbs on the two pads and push.

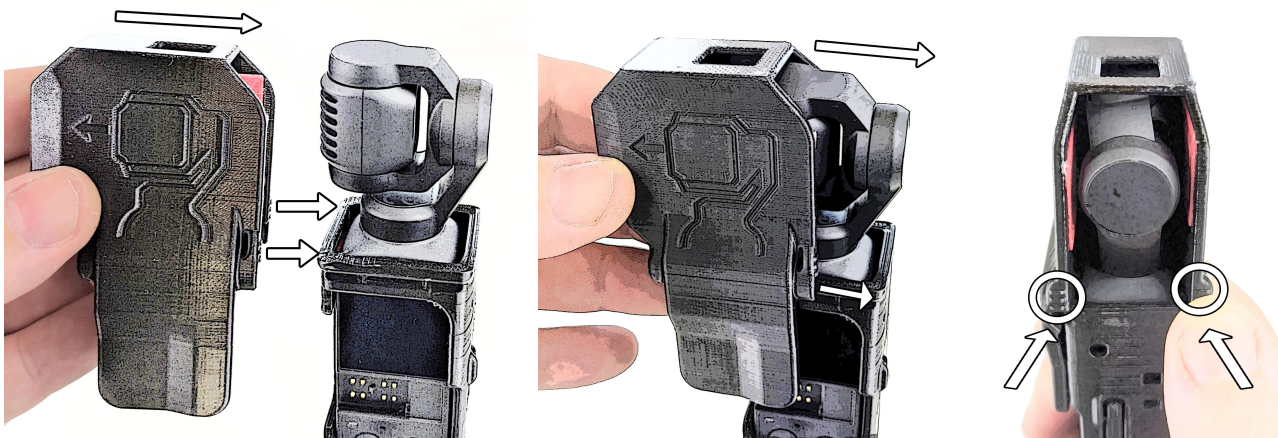

Note: Just as you wouldn't leave your expensive camera in a car on an extremely hot day, don't do likewise with your Pro Case.

Temperatures exceeding 55°C (130°F) can cause permanent deformation!