

AGES  
6+

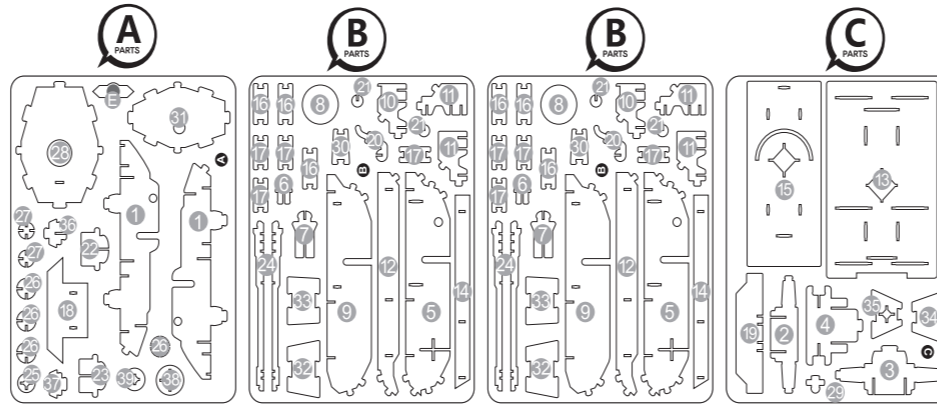

PARTS



Use this awl to punch out pieces.



ASSEMBLY

NOTE: Make sure all pieces are pressed in all the way in order to securely interlock and leave room for later pieces.

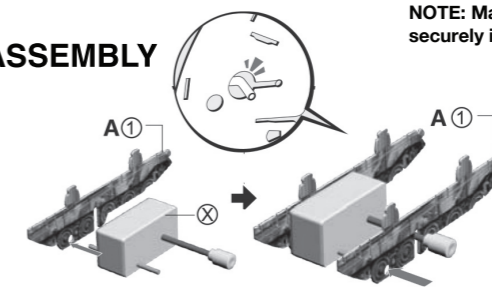

1 A1 + X

Insert the motor X. Secure the motor by sliding it forward into the narrower portion of the cutout.

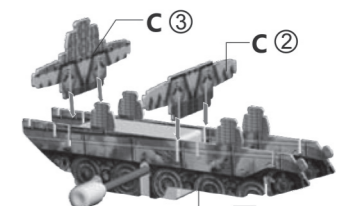

2 C2 + C3

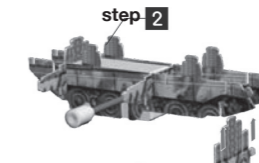

3 C4

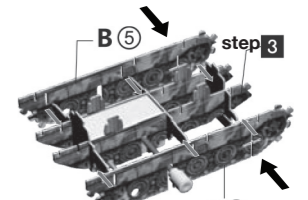

4 B5

Read through this entire instruction manual BEFORE using Super Tank 3D Wind Up Puzzles.

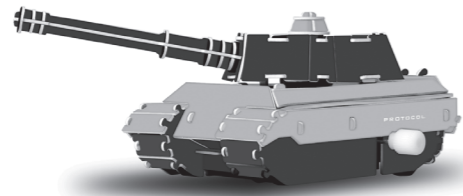

Images may vary from actual product

For additional instructions and to check out other cool models, visit us at [3DWindUp.com](http://3DWindUp.com)!

PROTOCOL

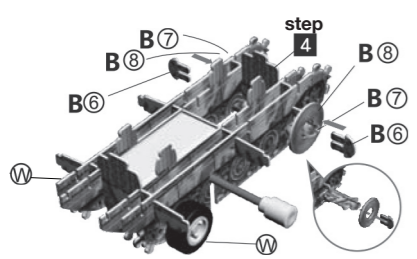

5 B6 + B7 + B8 + W

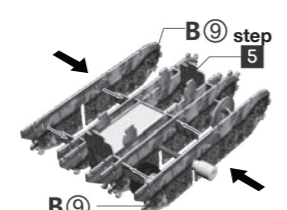

6 B9

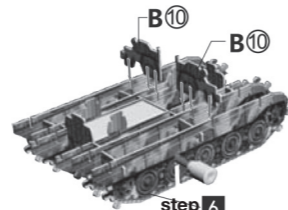

7 B10

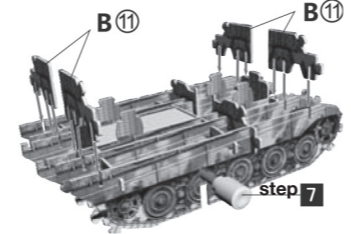

8 B11

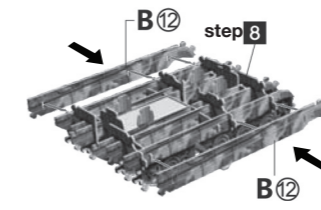

9 B12

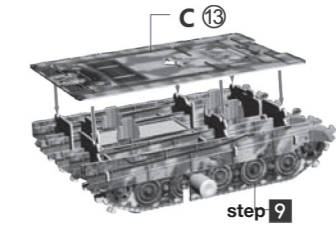

10 B13

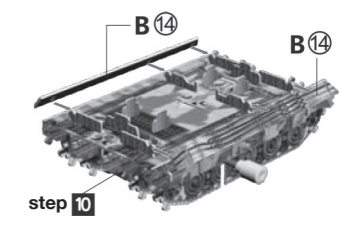

11 B14

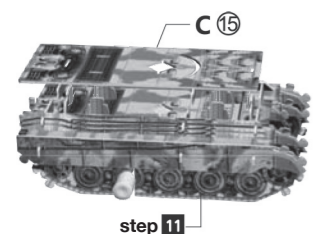

12 C15

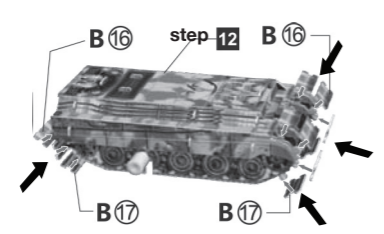

13 B16 + B17

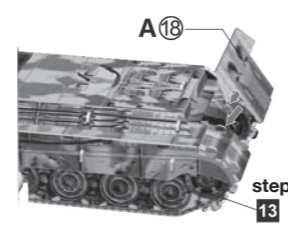

14 A18

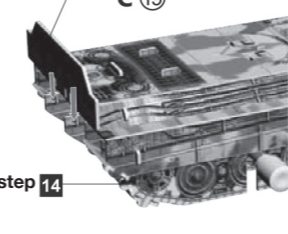

15 C19

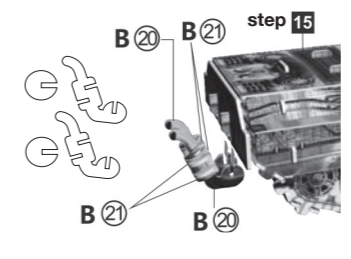

16 B20 + B21

Take B21 and insert them into the slots of B20. Hook B20 onto tank.

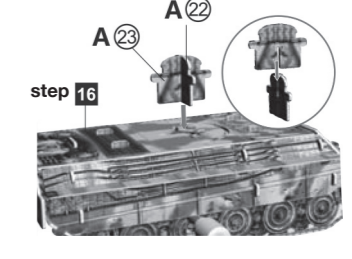

17 A22 + A23

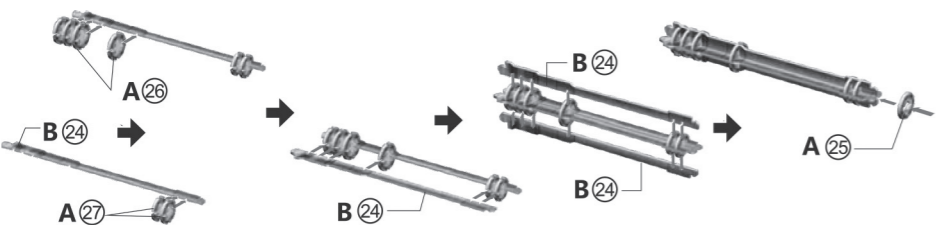

18 A26 + B24 + A27  
Hook all four of A26 to B24.  
Hook all two of A27 to B24.

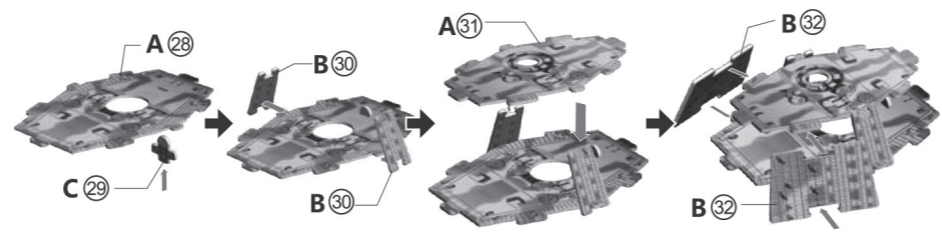

19 C29 + A28 + B30 + A31 + B32

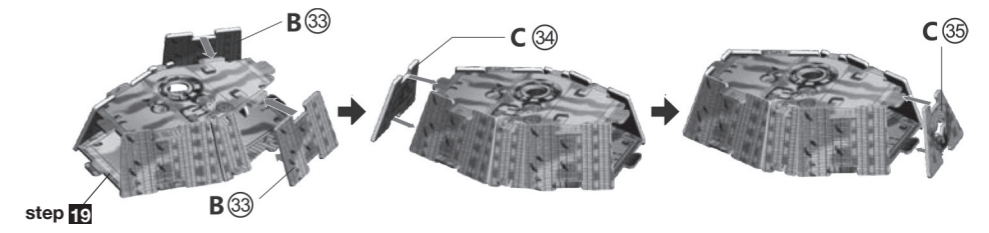

20 B33 + C34 + C35

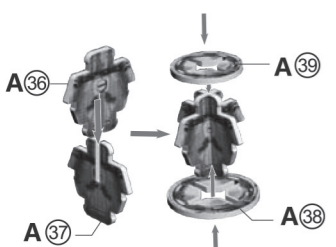

21 A36 + A37 + A38 + A39

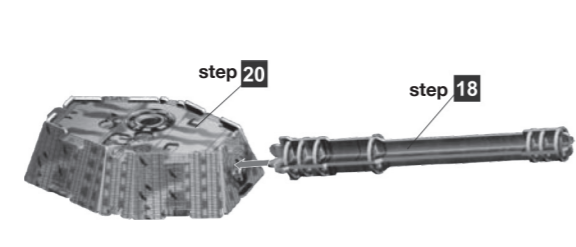

22 Step18 + Step20

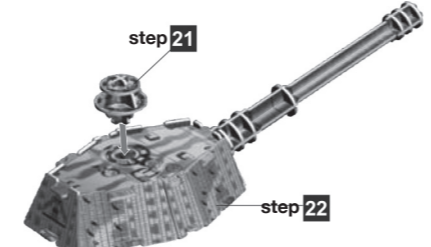

23 Step21 + Step22

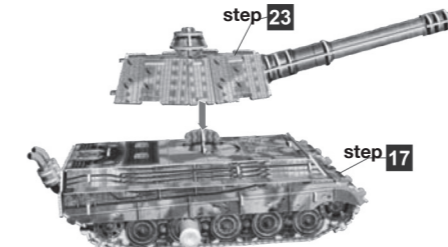

24 Step23 + Step17

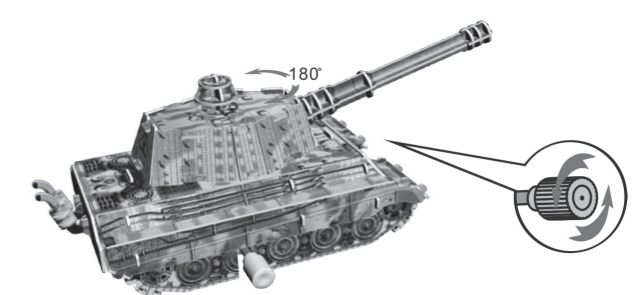

Wind motor to run.