

## Instruction Manual for **Bottled Sunshine™** Solar Powered Bottle Lights

Read through this entire instruction manual BEFORE using **Bottled Sunshine**. We're dedicated to bringing you well-designed products that make living fun and easy. We stand behind all our products and warrant this to be free from defects in workmanship and materials.

For service claims or questions please consult our website [ProtocolNY.com](http://ProtocolNY.com).



### TURNING ON THE LANTERN

1. Twist the lantern's core (black disc with indentations) to the left to access the solar panel (Fig. 1).
2. Turn the solar panel on (Fig. 2). The panel must be on in order to charge.
3. Re-install the core to the lantern.

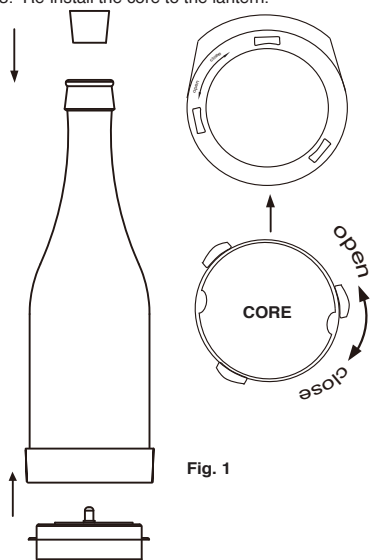

Fig. 1

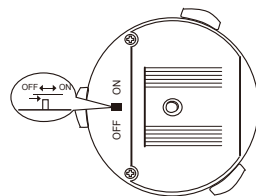

Fig. 2

### INSTALL THE LANTERN

1. Using the twine cord, hang the lantern from a desired location such as a tree branch, deck railing, etc. Make sure the lantern gets direct sunlight to help it charge.
  - a. In direct sunlight, the lantern requires 6-8 hours of charging for max performance.
  - b. In partial sunlight, the lantern requires 12+ hours of charging for max performance.
2. The lantern will charge during the day and will come on as it gets dark.
  - a. NOTE: If the lamp is located near another light source, it may not light up.

### REPLACING THE RECHARGEABLE BATTERY:

When the lantern begins to dim even after a full charge, you can replace the rechargeable battery. Unscrew the battery cover, and insert a new rechargeable 'Ni-MH AAA 1.2V' battery into the lantern (Fig. 3).

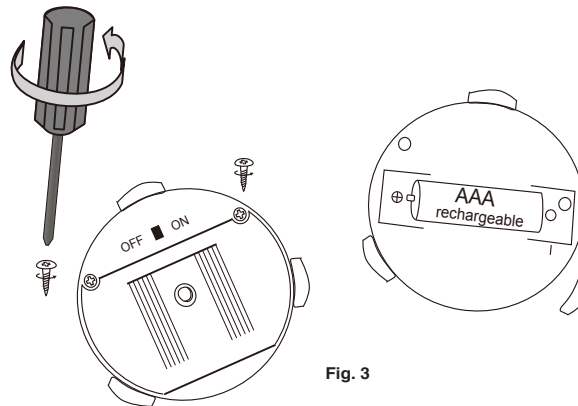

Fig. 3