



Barneys Facial Steamer with Ozone

MODEL B88601

User Manual

Please read this user manual carefully before using the product.

www.barneyssalonsupplies.com.au | 1800 676 522

1. About This Manual

This manual should only be used in reference of the operation of this particular model. If the manual is used for other purposes, or instructions not followed correctly, Barneys Salon Supplies will not undertake any consequences or responsibility.

All information in this manual shall be protected by copyright and shall not be copied and translated in any part of this specification without the written consent of the manufacturer.

2. Features

This product series is composed of a metal shell, stainless steel base, fashionable glass water cup, copper spray pipe and other quality materials that create a solid structure, durability and an ergonomic shape. The stainless steel base ensures stability and safety in high temperature settings, and will not result in oxidation or re-composition in high temperature. This acts as a safety feature whilst the product is being used, to avoid some oxidised and heavy metal atoms that can form at high temperatures, from harming the skin. This product composition ensures clean vapors are omitted during beauty treatments. The spray head features various rotation angles to help make operation easy. The equipment also features a herbs function, time pre-set, five levels of spray adjustment and an automatic water level detection feature. In addition, it is equipped with a minimum/maximum water level alarming system. This acts as an additional safety feature to prevent damage of heater parts when the water level is too low or high. The alarm will also help prevent users from opening the steamer when there is no water in the cup.

3. Functions

1. Revitalises the skin for a more youthful, healthier and firmer complexion.
2. Opens up the skin's pores for deep cleansing.
3. Penetrates deep into pores to soften and lift dirt, residue, make-up and black heads.
4. Helps the skin to release toxins and enhances Vitamin D formation.
5. Helps temporarily soften the appearance of wrinkles.
6. Activates blood circulation, hydrates skin cells, improves metabolism and renews overall complexion.
7. Helps treat acne, wounds and scars by creating faster cell regeneration and speeding up the healing process.

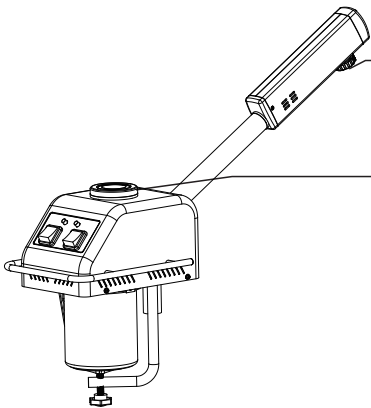

⚠ Warning !

- To prevent scalding, please keep spray head a certain distance from the surface of the face. Do not point the spray head at the same area for too long.
- Spray head should be perpendicular to the face.

⚠ Warning !

- Only distilled or demineralised water should be used with this machine.
- Do not remove cover when machine is heating or in the process of steaming.

4. Parts explanation and installation

Parts featured

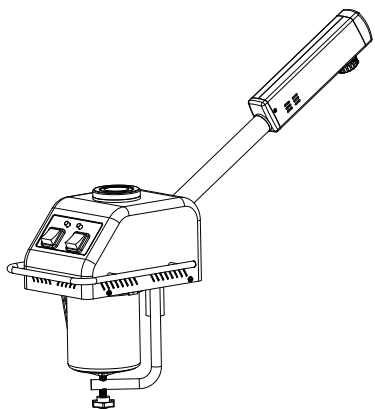

Mainframe



Plastic ring



Herbs cover

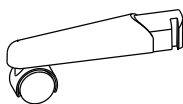

Five-wheel leg × 5



Five-leg base

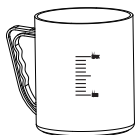

Glass water cup



M14 small panner



Power line



Sliding bar



Adjustment thimble



Pressing plate



Straight post



M10 gasket



M10 screw

5. Base and installation for single functions steamer

First, mount the five-wheel legs in the five-leg base and then insert into the straight post.
(Please refer to Pictures 1, 2 and 3.)

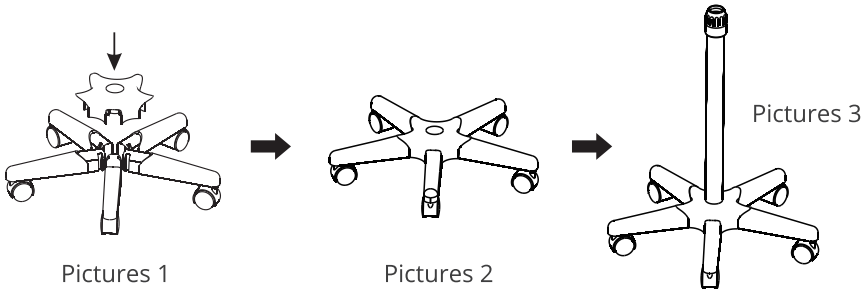

Next, insert the screw featuring the gasket and pressing plate, to the above-mentioned parts.
(Please refer to Picture 4.)

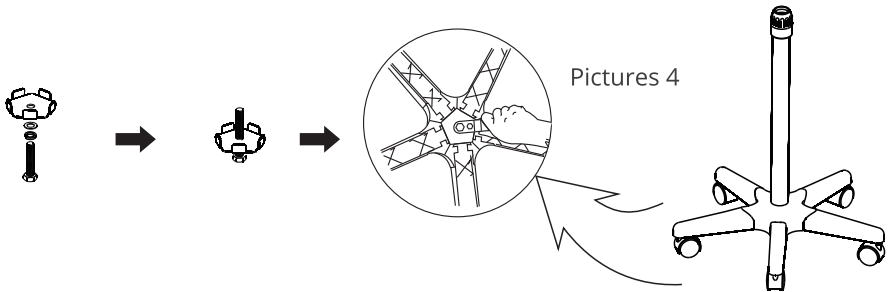

Next, twist the adjustment thimble, insert the sliding bar into the straight post and press it into the lowest position (Please refer to Pictures 5, 6, 7 and 9), then adjust it to a suitable height and tighten (Please refer to Picture 8).

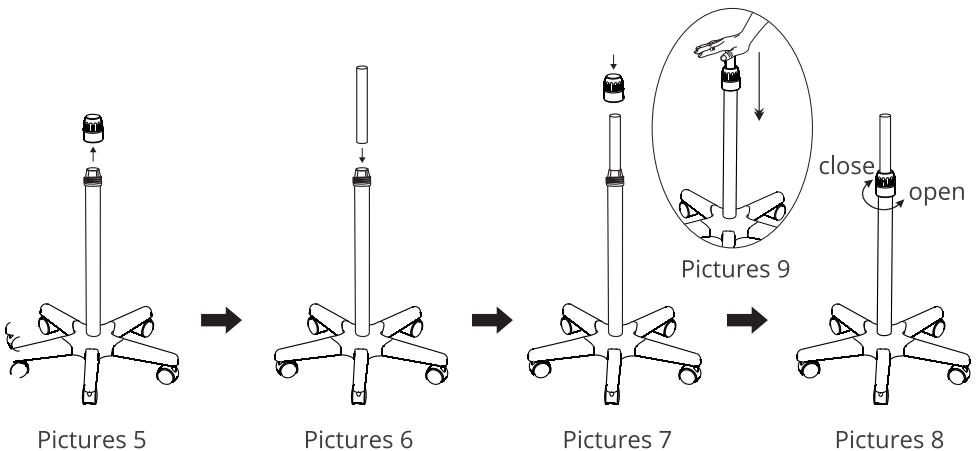

⚠ Warning!

When adjusting the height of the sliding bar, hold the sliding bar with one hand, then adjust the adjustment thimble with the other hand. As you adjust, be sure to hold the nozzle of the sliding bar away from your face and the face of others, to avoid injury should the bar spring out.

6. Water cup installation

Step 1. Place the plastic ring on the water cup. Step 2. Twist the water cup tray to a suitable position where it can hold the water cup securely, then push it backward. Step 3. Place the water cup into the mainframe. Step 4. Push the tray back and tighten. (Refer to pictures 1 and 2).

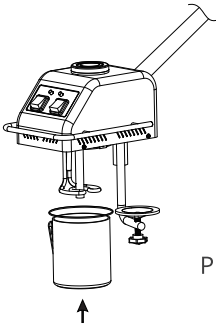

Pictures 1

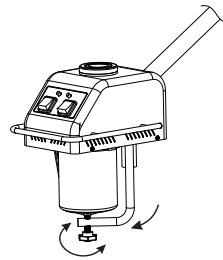

Pictures 2

⚠ Warning!

The water cup is designed specifically for this series steamer. Please do not use other similar water cups to place into this steamer, as they could impact operation and cause leakage.

7. Installation of the whole facial steamer

Please install the steamer onto the sliding bar.
(Please refer to Pictures 1 and 2.)

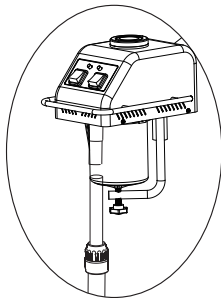

Pictures 1

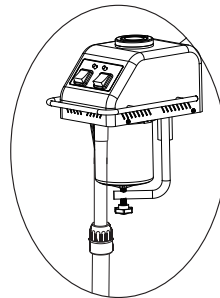

Pictures 2

8. Operation panel

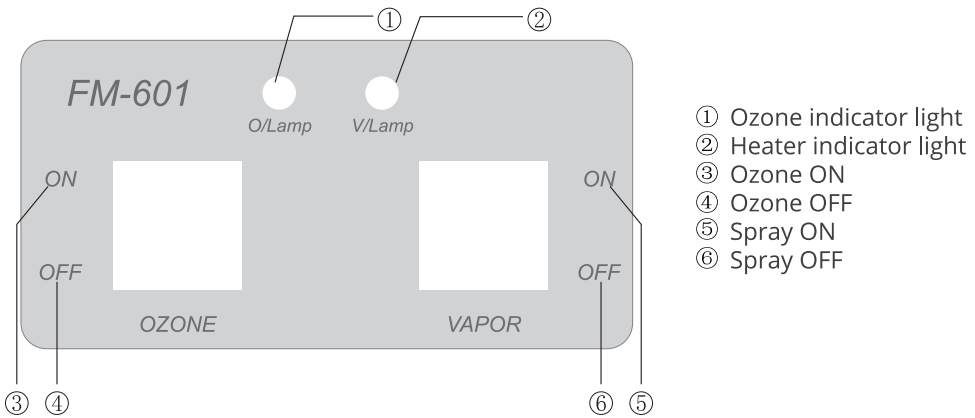

Treatment Preparation

- 1) Adjust the facial chair or massage table to secure your client into a stable position, and allow your client to find a comfortable posture for the duration of the treatment.
- 2) Ask your customer if there are any contraindications before proceeding.
- 3) Explain the care contents and precautions to be performed during the treatment.
- 4) Ensure to clean and disinfect your hands before you begin.
- 5) Ensure you have cleansed your client's skin thoroughly prior to using the machine.
- 6) It is advised to perform a skin sensitivity test with selected settings and adjust accordingly.
- 7) Ensure the instrument, plugs, sockets, wires and connectors are safe and away from water.

Operation Steps

- 1) Open the cover, then pour distilled water into the water cup via the water inlet, until the water level reached maximum level.
- 2) Plug in the power plug.
- 3) Turn on the 'VAPOR' (spray switch). After approx. six minutes the steam should begin to spray evenly and smoothly. The spray head is then ready to be adjusted to suit the position of the face being treated.
- 4) Turn on the 'OZONE' switch. The indicator light will come on and the ozone tube will begin to function. Steam will begin to appear and a distinct smell will indicate this is working. The steam will start to spray evenly and smoothly in which case the spray head is then ready to be adjusted to suit the position of the face being treated.
- 5) During use, the water level will drop. Once the water level drops below the lowest point, turn off the power switch and disconnect the power plug. Add water from the water inlet from the top of the mainframe after four minutes post switching off. (Refer to operation Step 1. Ensure attention is paid to the water level between the highest and lowest limits). Then plug the power plug into its outlet to continue the treatment.

9. Operation method

- (1) Place the water cup upon the water cup tray and then tighten the screw. Next, lift the herbs cover lid up and pour distilled water into the water cup. The water level should be between the MAX and MIN indicator limit of the cup. (Please refer to Pictures 1 and 2).

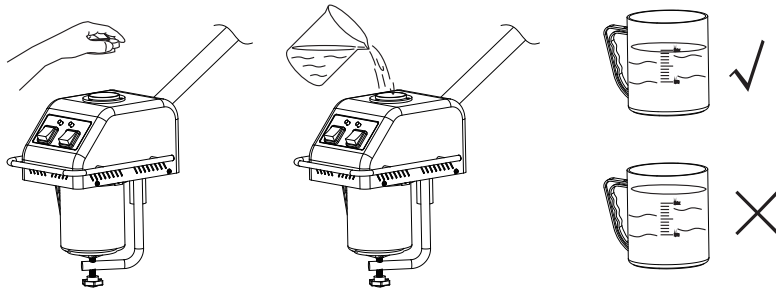

Cautions

- If you need to adjust the height of the machine, hold the sliding bar tightly with one hand and twist the adjustment thimble with the other hand. Do not hold the nozzle of the sliding bar toward your face or that of others to avoid injury should the sliding bar spring out.
- The protector is used to prevent scalding by the way of accidental touching of the stainless steel cup during use. Do not remove the protector. If the protector gets damaged, please contact the supplier for repair.
- The water cup should be placed appropriately in position. Pay attention to the position of the rubber ring prior to use. This should not be rolled or folded or leakage will occur.
- The water level should be between 'MAX' and 'MIN' whilst the machine is being used.
- When adding water to the water cup, try to avoid spilling water over the surface of the machine's shell to avoid electrical issues.
- Should air or water leakage occur during use, immediately switch off the 'POWER' button. Carefully remove the water cup and check to ensure the rubber ring is properly fixed. Adjust if required once cooled down. If this continues, refer to the supplier.
- When operating the machine, ensure the nozzle is not aimed at your face or that of the client, until the vapor is spraying thinly and evenly. Keeping approx. 40cm from the client's face, you can begin treatment from the jaw and upward.
- Avoid using the ozone for long periods of time to avoid harming the skin's natural properties.
- Whilst using the machine, if the water level falls below 'MIN' or if there is no more water in the cup, the machine should switch off the heater and lock all key functions except the 'VAPOR' key. It will emit a constant buzzing sound until water is added to the normal level, and the key is pressed to continue operation.
- The interior temperature controller will respond automatically and cut power to the machine if there is no water, so ensure to keep the water level maintained to avoid temperature variances.

Different skin may require different spraying distances. Note the following numbers as a reference.

Skin types (remedy suits case)	Distance	Time
Greasy skin, poor blood circulation	35-40cm	About 15 min
Normal skin	35-40cm	10 min
Sensitive skin, dry skin	40-45cm	5 min
Capillary vessel expansion, UV inflammation	40cm	5 min



Cautions

- Do not put greasy residue into the water container of the herbs filter mesh or this may cause water to spray out and cause subsequent issues.
- Do not spray vapor too closely to the client's face or this may cause scalding.
- Avoid using the machine under humid conditions.
- Avoid using the machine in direct sunlight or this may cause instability.
- Do not open the machine. If there are issues that cannot be resolved as per instructions, please consult the supplier.
- Should the main electrical line be damaged, seek professional assistance or contact the supplier.

Maintenance

- Clean scale from the water cup and heater elements at least once per week. (Use water that contains at least 7% acetic acid or citric acid to clean the scale).
- After operation, clear the equipment of any materials.
- Always keep an eye on the water level during operation to ensure adequate levels are maintained.



Special announcement

- Ensure the power source is cut off when there is no water or water level is below 'MIN'. If this is not actioned, the user is at full responsibility of any injuries or malfunctions.
Ensure instructions are referred to prior to use. If unsure, contact supplier for assistance.
- Do not allow children to operate the machine.
- Do not allow others to get close to the machine whilst in operation, in order to avoid accidents.

10. Product Parameters

Net weight	6.5 kg
Gross weight	8 kg
Rated voltage	AC 100-120V / AC 220-240V
Frequency	50/60Hz
Power	650W (AC 100-120V) / 880W (AC 220-240V)



Do not dispose of old or defective appliances in domestic garbage; this should only be done through public collection points.

▲ Please check the product specification before use. This manual is for reference only. Specifications are subject to change without prior notice.