

Red + Grey Christmas

Featuring fabrics from the Red + Grey Christmas collection



54" square

Quilt designed by Lisa Swenson Ruble



901 E. 14th Avenue
North Kansas City, MO 64116
(816) 421-2000
www.pbsfabrics.com

Finished Quilt Size: 54" square
Finished Block Size: 21" square
Number of Blocks: 4

Yardages and Cutting

WOF means width of fabric from selvage to selvage. Remove as little fabric as possible when trimming selvage edges.

1 panel, 11418-65081

- Fussy-cut (4) 15-1/2" square blocks

1/2 yard tree plaid, 11418-65031

- 3 strips 3-1/2" x WOF; cut into (32) 3-1/2" squares

5/8 yard dark grey stars, 11418-65051

- 8 strips 2" x WOF; cut into (8) 2" x 11" pieces, (8) 2" x 9-1/2" pieces, (16) 2" x 8" pieces and (8) 2" squares

5/8 yard light grey stars, 11418-65052

- 8 strips 2" x WOF; cut into (8) 2" x 11" pieces, (8) 2" x 9-1/2" pieces, (16) 2" x 8" pieces and (8) 2" squares

1-1/8 yards black stripe, 11418-65041

- 6 strips, 5-1/2" x WOF

7/8 yard Painter's Palette Solid Christmas Red, 121-067

- 6 strips 2-1/4" x WOF for binding
- 5 strips 1-1/2" x WOF

3-5/8 yards backing fabric of choice

- 2 pieces 62" x WOF

Batting

- 1 piece 62" square

Piecing the Blocks

Use a 1/4" seam allowance for all stitching. Press all seams as directed.

1. Sew (1) 2" x 8" dark grey stars piece lengthwise to (1) 2" x 8" light grey stars piece. Press toward dark gray. Draw a diagonal line on the wrong side of (1) 3-1/2" tree plaid square. Lay the marked square right sides together on the left end of the pieced strip as shown. Sew on the drawn line, trim seam allowance to 1/4", and press open. Make a total of (4) short A units.

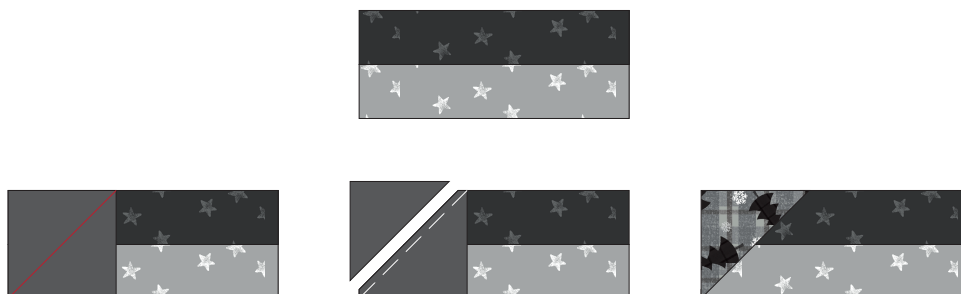

2. In the same way, make a total of (4) mirror image short B units, noting orientation.

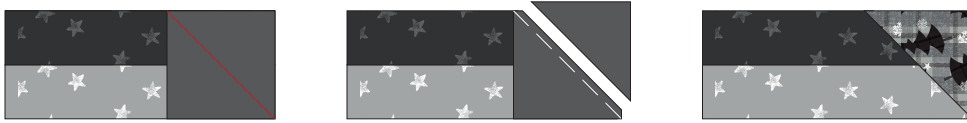

3. Sew (1) 2" light grey stars square to (1) 2" x 9-1/2" dark grey stars piece. Press toward the square. Noting orientation, sew (1) 2" x 11" light grey stars piece to the bottom. Press toward the dark grey.

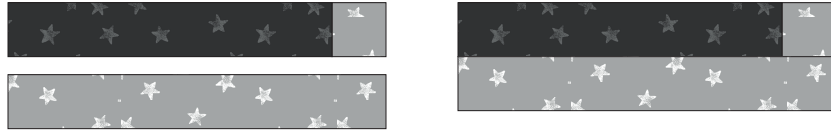

4. In the same way as in Step 1, mark and sew (1) 3-1/2" tree plaid square to the left end as shown. Make a total of (4) long A units.

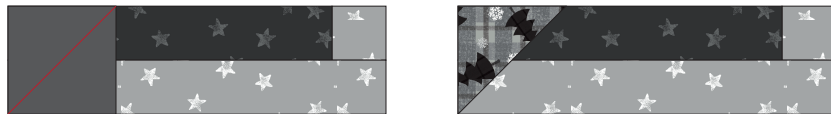

5. In the same way, make a total of (4) mirror image long B units.

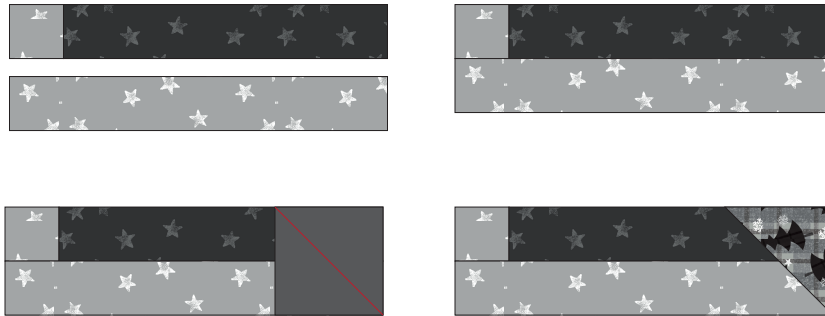

6. Sew (1) A short unit and (1) B short unit together to make a side unit. Press open. Make (4). Sew (1) A long unit and (1) B long unit together to make a top/bottom unit. Press open. Make (4).

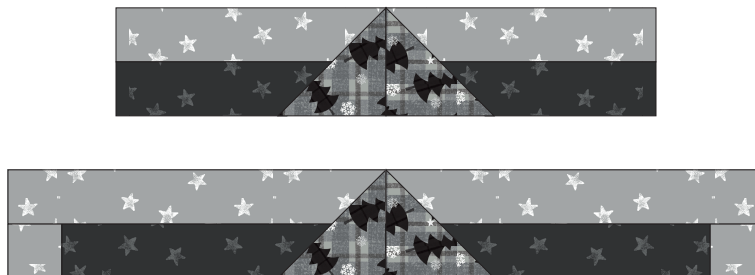

7. Sew side units to the sides of (1) 15-1/2" square panel block as shown on page 3. Press toward panel. Sew top/bottom units to the top and bottom of the square. Press toward panel. Make (2) 21-1/2" square blocks.



8. Sew (1) 2" x 8" dark grey stars piece lengthwise to (1) 2" x 8" light grey stars piece. Press toward dark grey. Draw a diagonal line on the wrong side of (1) 3-1/2" tree plaid square. Lay the marked square right sides together on the left end of the pieced strip as shown. Sew on the drawn line, trim seam allowance to 1/4", and press open. Make a total of (4) short C units.



9. In the same way, make a total of (4) mirror image short D units, noting orientation.

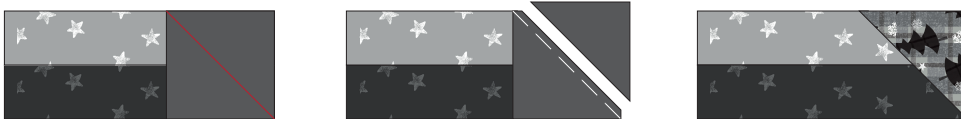

10. Sew (1) 2" dark grey stars square to (1) 2" x 9-1/2" light grey stars piece. Press toward square. Noting orientation, sew (1) 2" x 11" dark grey stars piece to the bottom. Press toward dark grey.



11. In the same way as in Step 8, mark and sew (1) 3-1/2" tree plaid square to the left end as shown. Make a total of (4) long C units.



12. In the same way, make a total of (4) long D units.

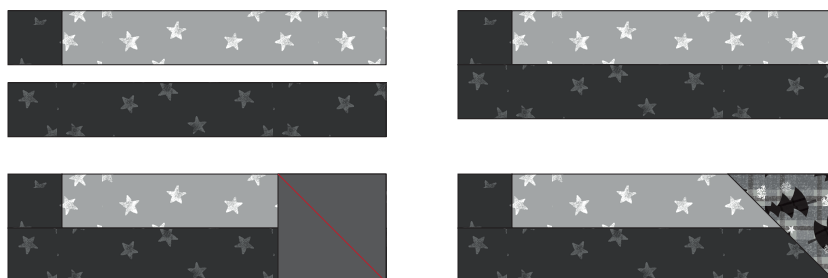

13. Sew (1) C short unit and (1) D short unit together to make a side unit. Press open. Make (4). Sew (1) C long unit and (1) D long unit together to make a top/bottom unit. Press open. Make (4).

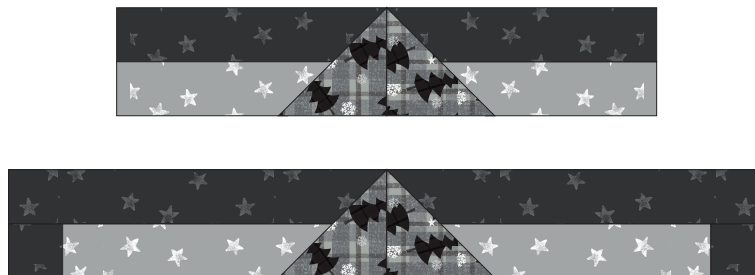

14. Sew side units to the sides of (1) 15-1/2" square panel block. Press toward units. Sew top/bottom units to the top and bottom of the square. Press toward units. Make (2) 21-1/2" square blocks.

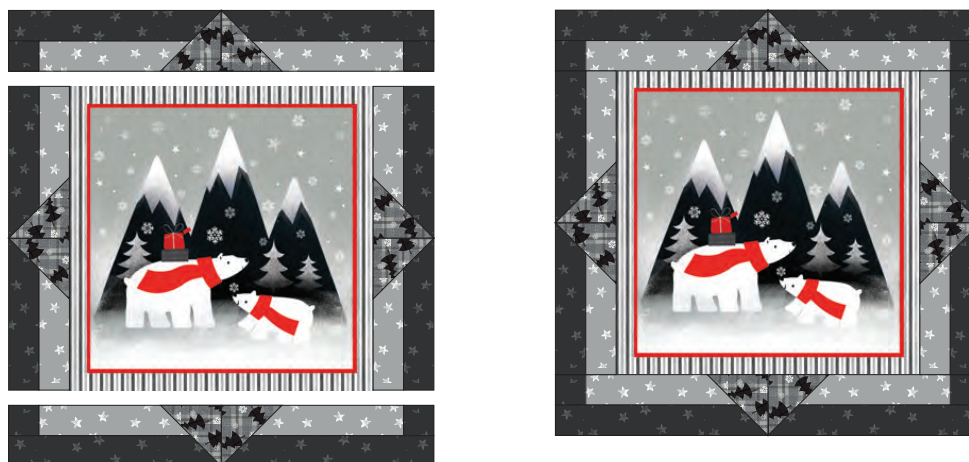

Completing the Quilt

1. Referring to the Quilt Assembly Diagram on p. 5, lay out the blocks in (2) rows of (2) blocks each. Sew the blocks into rows and join the rows.

2. Sew the (5) 1-1/2" x WOF Christmas Red strips short ends together. Measure the quilt lengthwise across the center and cut (2) strips to this length. Sew to the sides of the quilt. Measure the quilt widthwise across the center, including the borders just added, and cut (2) strips to this length. Sew to the top/bottom of the quilt.

3. Sew the (6) 5-1/2" x WOF black stripe strips short ends together. Measure the quilt lengthwise along the center and cut (2) strips to this length. Sew to the sides of the quilt. Measure the quilt widthwise along the center, including the borders just added, and cut (2) strips to this length. Sew to the top/bottom of the quilt.

4. Remove the selvedge edges from the backing pieces. Join the pieces on the long edges with a 1/4" seam allowance. Press seams open. Trim to make a 62" square backing piece.

5. Layer, baste, quilt and use the (6) 2-1/4" x WOF Christmas Red strips to bind the quilt.



Quilt Assembly Diagram

Red + Grey Christmas

1 Kit 5 Kits 10 Kits

11418-65081 **Panel**

1 yard 5 yards 10 yards



11418-65031 **Tree Plaid**

1/2 yard 2-1/2 yards 5 yards



11418-65051 **Dark Grey Stars**

5/8 yard 3-1/8 yards 6-1/4 yards

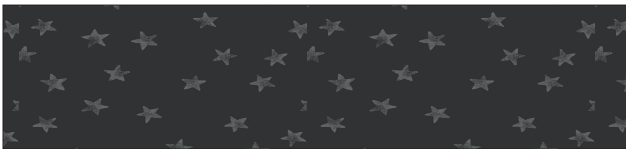

1 Kit 5 Kits 10 Kits

11418-65052 **Light Grey Stars**

5/8 yard 3-1/8 yards 6-1/4 yards



11418-65041 **Black Stripe**

1-1/8 yards 5-5/8 yards 11-1/4 yards

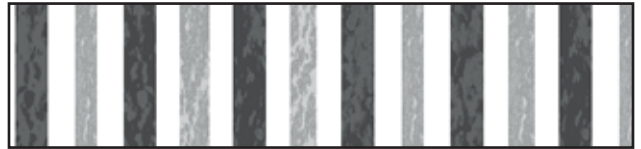

121-067 **Painter's Palette Solid Christmas Red**

7/8 yard 4-3/8 yards 8-3/4 yards



Backing of choice

3-5/8 yards 18-1/8 yards 36-1/4 yards