

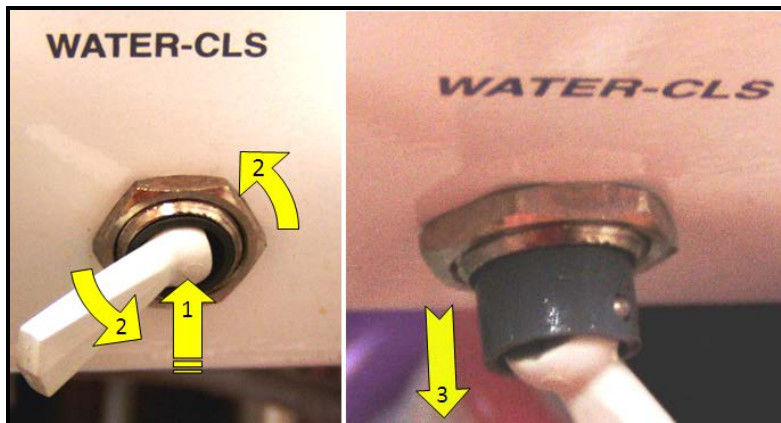

Coolant Selector Toggle Cartridge Replacement Instructions

1. Depressurize coolant system by turning off the coolant bottle pressure toggle.
2. Grasp coolant selector toggle, push directly back into dental unit approx 1/8", rotate counter-clockwise 1/8 turn (45°) while depressing toggle, then pull on toggle to remove cartridge from dental unit.



3. With the oval opening in the side of the cartridge in approximately the 7 o'clock position, push the new cartridge back into the dental machine and rotate 1/8 turn clockwise to lock it in place.
4. Toggle back and forth; check the toggle snaps more easily to the CLS side.
5. Re-pressurize the coolant system using the coolant bottle pressure toggle.
6. Check the flow of water and CLS at the air water syringe. Allow the coolant a few seconds to start flowing.