



**PROFILE
DESIGN**

AIRSTRYKE II AEROBAR

REVISION 01-02-01-2023

INTRODUCTION

Thank you for purchasing this set of Profile Design Aerobars. These instructions apply to the Airstryke II Aerobar.

Please read these instructions thoroughly before attempting to install this item. Proper installation is required for compliance with Profile Design's warranty policy. If you are not familiar with installation of Aerobars or their accessories, please seek the assistance of your local Profile design dealer by logging on to www.profile-design.com and using "dealer search" or by calling Profile Design's customer service number p.# 888.800.5999.

Note to Dealers: If you install this product for the consumer, please provide him/her with this owner's manual after installation.

Tools and materials required:

- 5mm Hex Wrench
- Torque Wrench with a 5mm Hex fitting
- Assembly compound
- Lithium grease
- Isopropyl alcohol
- Cutting guide and hacksaw (18T blade)
- Half round file
- Electrical/Insulation tape
- Clean, lint free cloth

Your Aerobar kit should contain:

- Two (2) aerobar upper brackets (aluminium) with spring loaded wings
- Two (2) aerobar lower brackets (aluminium half round)
- Four (4) M6x18 bolts with washers
- Two (2) M6x15 bolts preinstalled in the lower bracket with washers
- One (1) Airstryke extension
- Two (2) cable exit plugs
- Two (2) Ergo armrests with hook and loop stickers (plastic)
- Two (2) Ergo 10mm armpad cushions (foam)
- Four (4) M6x13 countersunk bolts

Optional accessories compatible with this Aerobar:

- Swiftshift kit
- Ergo+, Race+ and Boom armrest kits

If anything is missing from the aerobar kit please contact your dealer.

Please note that threaded areas have been pre-treated by Profile Design during production with a special blue thread locking compound. This special compound is easy to detect on the threads of all bolts provided. If you cannot detect this thread locking compound or if you have cleaned it off through normal maintenance, re-apply a suitable blue thread locking compound as available from Loctite® or another company before assembly.

COMPONENT LIST

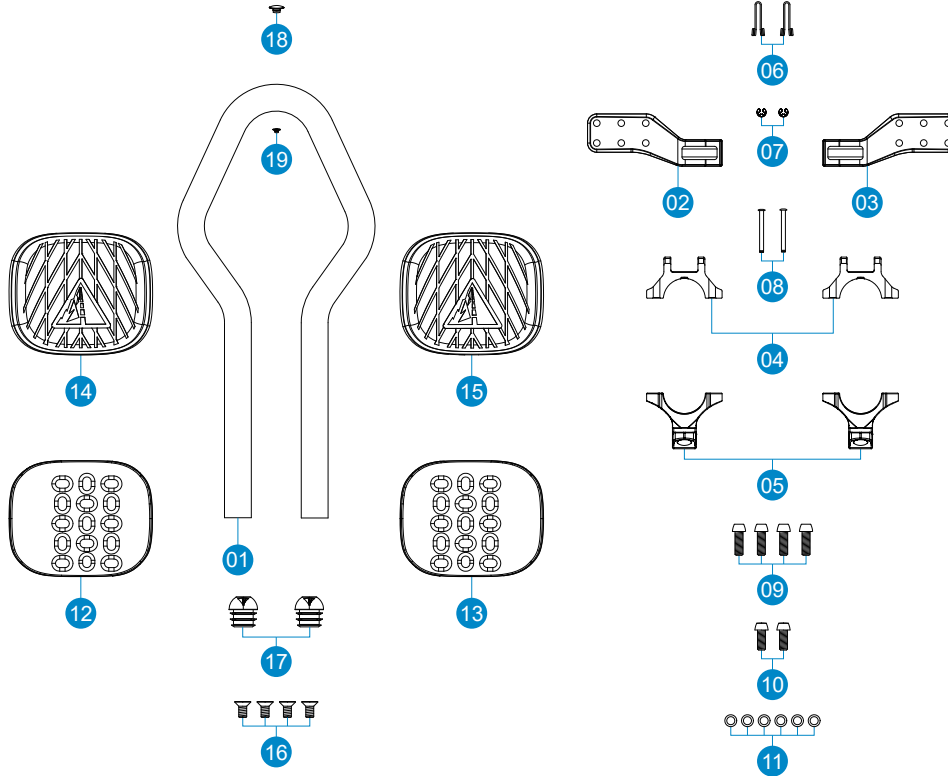

Ref.#	Part.#	QTY. Req.	Part Description
1	852243	1	Extension - A Shape Five Bends Flat Black
2	189360	1	Bracket - Flip Wing Flat Black Left
3	189361	1	Bracket - Flip Wing Flat Black Right
4	189369	2	Bracket - Flip Base 31.8mm Flat Black
5	189363	2	Bracket - Non-thread 31.8mm/22.2mm Flat Black
6	312796	2	Spring-Flip Up set
7	550026	2	C Clip for Forged Flip Up Brkt
8	550023	2	Steel Pin - For Flip Bracket 3*33mm
9	919211	4	Bolt-M6x18 Blk CP Mushroom Cap
10	312615	2	Bolt-M6x15 Blk CP Mushroom Cap
11	550006	6	Washer-M6x9x.8 SS
12	200062	1	Armrest - ERGO W/Hook Sticker Side A
13	200063	1	Armrest - ERGO W/Hook Sticker Side B
14	685225	1	Pad - Ergo/Race Ultra L/R 10mm
15		1	
16	313593	4	Bolt - M6x12 FHB w/Nylok Stainless(SUS304)
17	716666	2	AL Ext Rear Plug W/slot & Logo
18	F970	1	Plug-Swiftshift for Airstryke (11mm)
19	104276	1	Plug-Shift shift for Airstryke (5.5mm)

PART DRAWINGS

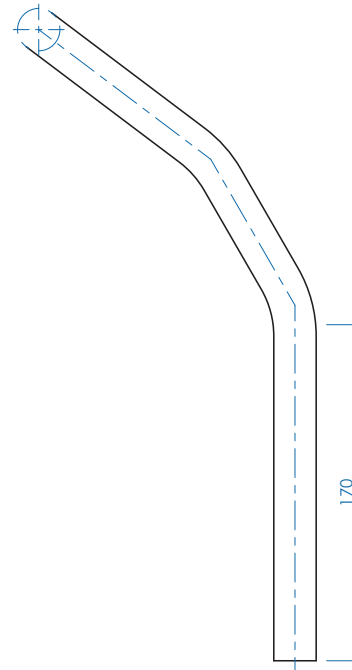
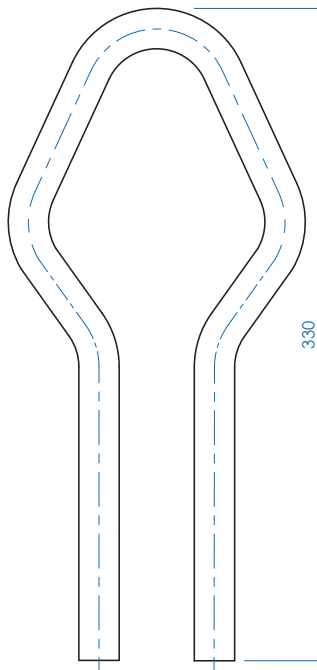
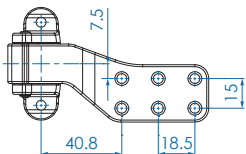
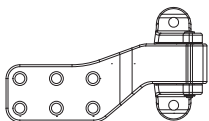
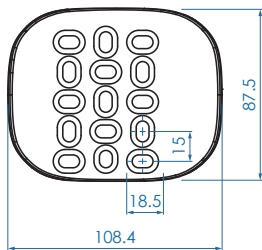
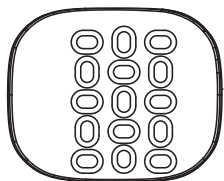

Units: mm

PRODUCT SPECIFIC SETUP LIMITATIONS

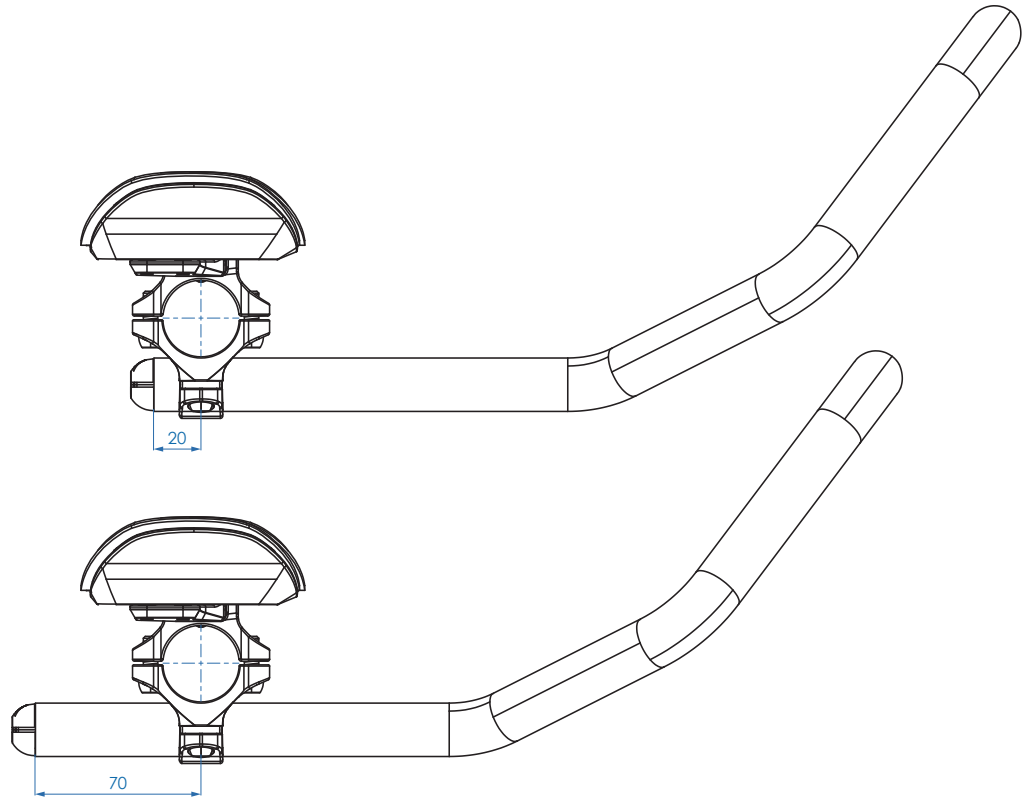

Units: mm

TORQUE SETTINGS

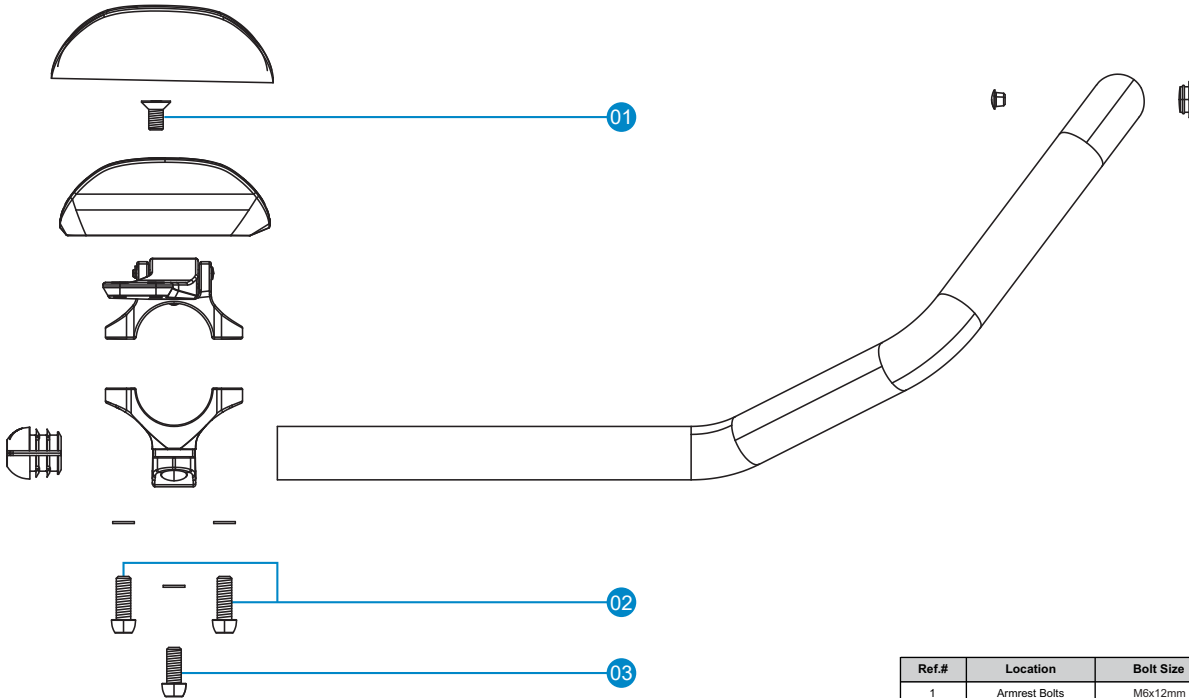

Ref.#	Location	Bolt Size	Torque
1	Armrest Bolts	M6x12mm	4.7Nm (42 inlbf)
2	Handlebar Clamp	M6x18mm	6Nm (53 inlbf)
3	Extension Clamp	M6x15mm	6Nm (53 inlbf)

INSTALLATION INSTRUCTIONS

1. Apply a thin coating of assembly compound to the inside faces of the handlebar clamp on both the upper and lower parts of the bracket.
 - If you are using a 31.8 to 26.0 reducing shim apply assembly compound to both sides of the shims.
2. Clasp the two halves of the handlebar clamp around the handlebar then use the 5mm Hex Wrench to install the M6 bolts through the lower bracket into the upper. Take care that the first thread engagement feels smooth to avoid cross threading the bolt.
3. Tighten the bolts until the aerobar bracket is firmly in place on the bar and repeat with the other side.
4. Apply assembly compound to the inside faces of the extension clamp.
5. Install the extensions to the required length, if there is excess protruding behind the bars that could strike the frame or pose a risk to the riders knees it should be cut.
6. Mark the point at which you wish to make a cut, allowing at least 10mm of the extension to extend behind the aerobar bracket. If you wish to have the ability to increase the aerobar length in future, allow a longer space behind the bracket.
7. We recommend checking your measurements after first marking the cut line to ensure that you do not inadvertently cut the extensions too short.
8. If using a cutting guide mount it securely in a vice. Then place the extension in the guide and line up the marked cut line with the slot in the cutting guide.
 - For aluminium an 18 tooth blade is recommended. Along with eye protection.
9. Using the hacksaw, make firm strokes of the blade through the guide, allowing the blade to do the work. Do not apply excessive force to the hacksaw as you risk snapping the blade and the possibility of injury.
10. Repeat the process for the second extension.
11. Once you have cut both extensions, use the half round file to remove any sharp edges from both the interior and exterior faces of the extension.
12. Reinstall the extensions in the desired position and tighten the M6 extension fixing bolt using the 5mm Hex wrench so they are held snugly.
13. Fit the cable exit plugs.
14. Check the placement of the brackets and extensions then use the torque wrench with a 5mm fitting to tighten the handlebar clamp to 6Nm.
15. Then use the torque wrench with a 5mm fitting to tighten the extension clamp to 6Nm.
16. To fit the armrests first ensure the inner face of the armrest is free of lint and grease, if the armrest has previously had a hook and loop sticker applied the residue should first be removed either mechanically or with a citrus based solvent.
17. Before applying the hook and loop sticker, you may choose to wipe down the surface with isopropyl alcohol to ensure good adhesion. Remove the backing from the hook and loop sticker and apply it to the armrest, smoothing the sticker out to ensure there are no air bubbles trapped under it.
18. Allow the sticker 24 hours to cure before use.
19. Fasten the armrests to the brackets using the M6x13mm countersunk bolts, note that the armrests have an offset design so care is required to ensure each side is positioned in the same way.
20. Apply a light coating of Lithium grease to the surface of the bolts as a protective layer against the effects of sweat.
21. Attach the cushion by placing carefully on hook and loop backing of the armrest and hold firmly for 30 seconds. Repeat for the other armrest. Note that the cushions on these models of armrest are symmetrical, so it doesn't matter which side each cushion is applied to.
22. Periodically check the aerobars for damage, particularly for scratches through the anodised coating that could lead to oxidation and weakening of the aluminium. Replace your aerobars if you notice any damage from use or accident.

WARRANTY POLICY

- Profile Design Worldwide Two Year Limited Warranty.
- Profile Design, LLC (distributor) warrants to the original retail purchaser ("you") that the Profile Design product for which you received this warranty is free from defects in material and workmanship for (2) two years from the date of original retail purchase. For more details on this warranty, its exclusions and/or how to make a claim under the warranty please call +1 310.747.0085 extension 161 or visit www.profile-design.com/pages/warranty



2677 El Presidio Street
Long Beach, CA 90810
Ph: 310-884-7756

www.profile-design.com

© Profile Design LLC