



**PROFILE
DESIGN**

A3 RISERS

REVISION 01-02-24-2023

INTRODUCTION

Thank you for purchasing these Profile Design Risers. These instructions apply to the A3A and A3c riser kits.

Please read these instructions thoroughly before attempting to install this item. Proper installation is required for compliance with Profile Design's warranty policy. If you are not familiar with installation of Aerobars or their accessories, please seek the assistance of your local Profile design dealer by logging on to www.profile-design.com and using "dealer search" or by calling Profile Design's customer service number p.# 888.800.5999.

Note to Dealers: If you install this product for the consumer, please provide him/her with this owner's manual after installation.

Tools and materials required:

- 5mm Hex Wrench
- Torque Wrench with a 5mm Hex fitting
- Grease such as Finishline Premium Grease

Your Riser kit should contain:

- Aluminium riser pairs (sized according to the kit you have purchased)
- Stainless steel bolts (sized according to the kit you have purchased)
- An Aluminum bridge if you purchased the A3A High Riser kit
- An integrated carbon bridge if you purchased the A3C High Riser kit

Products compatible with these risers

- Profile Design Wing Ultimate bar
- Profile Design Wing20C+ bar
- Profile Design Aeria Ultimate bar (A2-A3 adaptor required, available separately)
- Profile Design A2 Standard and Race brackets

If anything is missing from the Riser kit please contact your dealer.

Please note that threaded areas have been pre-treated by Profile Design during production with a special blue thread locking compound. This special compound is easy to detect on the threads of all bolts provided. If you cannot detect this thread locking compound or you are re-installing the bolt, re-apply a suitable thread locking compound as available from Loctite® or another company before assembly.

WARNING: Periodically check the Aero bar for damage, particularly for scratches through the anodised coating (aluminium parts) or clearcoat (carbon parts) that could lead to degradation and weakening of the base material. Replace your Aero bar if you notice any damage from use or accident.

COMPONENT LIST

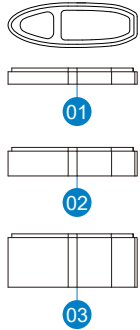

A3A LOW

Ref.#	Part.#	QTY. Req.	Part Description
1	293151	2	Riser - Aeria 3 BK 5mm
2	293152	2	Riser - Aeria 3 BK 10mm
3	293153	2	Riser - Aeria 3 BK 20mm

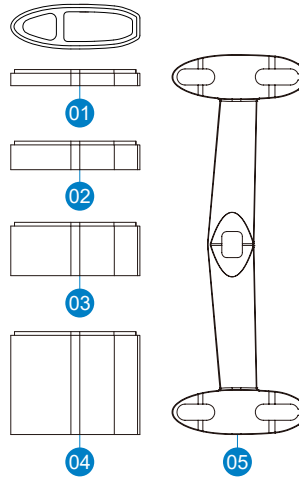

A3A HIGH

Ref.#	Part.#	QTY. Req.	Part Description
1	293151	2	Riser - Aeria 3 BK 5mm
2	293152	2	Riser - Aeria 3 BK 10mm
3	293153	2	Riser - Aeria 3 BK 20mm
4	293154	2	Riser - Aeria 3 BK 40mm
5	683188	1	Bridge - Aeria Ult BK 5mm

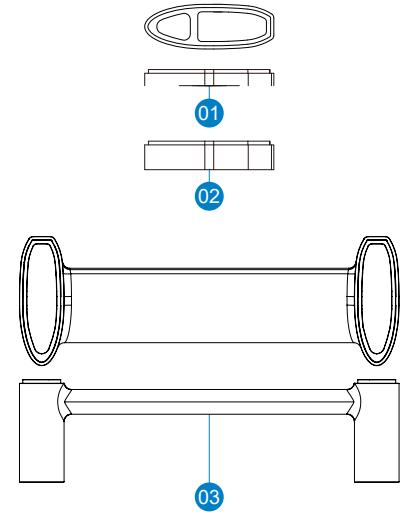

A3c HIGH

Ref.#	Part.#	QTY. Req.	Part Description
1	293151	4	Riser - Aeria 3 BK 5mm
2	293152	2	Riser - Aeria 3 BK 10mm
3	293155	1	Bridge - Aeria 3 Carbon UD Black 40mm

PART DRAWINGS

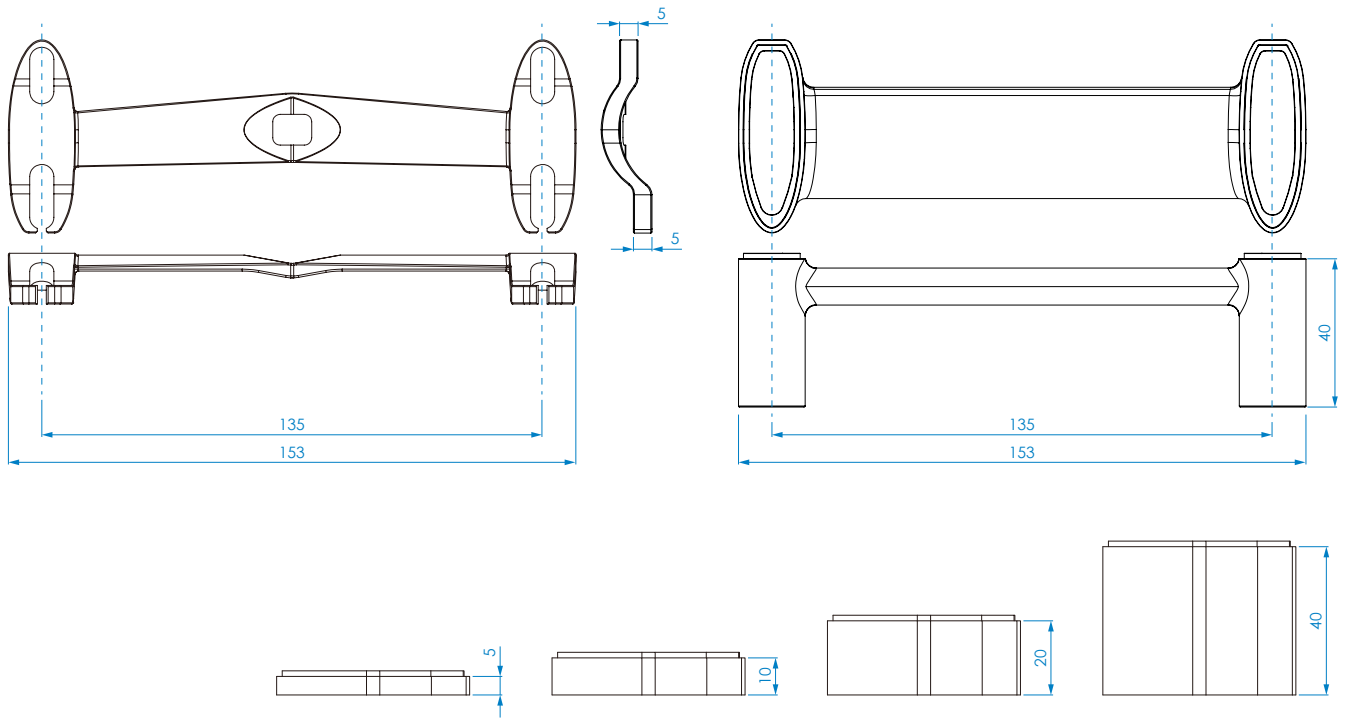

PRODUCT SPECIFIC SETUP LIMITATIONS

WING/20c+

A3A LOW

Riser (mm)	0	5	10	15	20	25	30	35
Bolt (mm)	40	45	50	55	60	65	70	75

A3A HIGH / A3c HIGH

40	45	50	55	60
> Bridge included in stack >				
80	85	90	95	100

WING ULT

A3A LOW

Riser (mm)		0	5	10	15	20	25	30	35
Bolt (mm)	Front	35	40	45	50	55	60	65	70
	Rear	40	45	50	55	60	65	70	75

A3A HIGH / A3c HIGH

40	45	50	55	60
> Bridge included in stack >				
75	80	85	90	95
80	85	90	95	100

* These bolt lengths refer to the flat (0 degree) position, tilting the bars may require altering the bolt lengths.

ASSEMBLY DIAGRAMS AND TORQUE SETTINGS

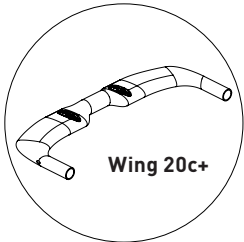
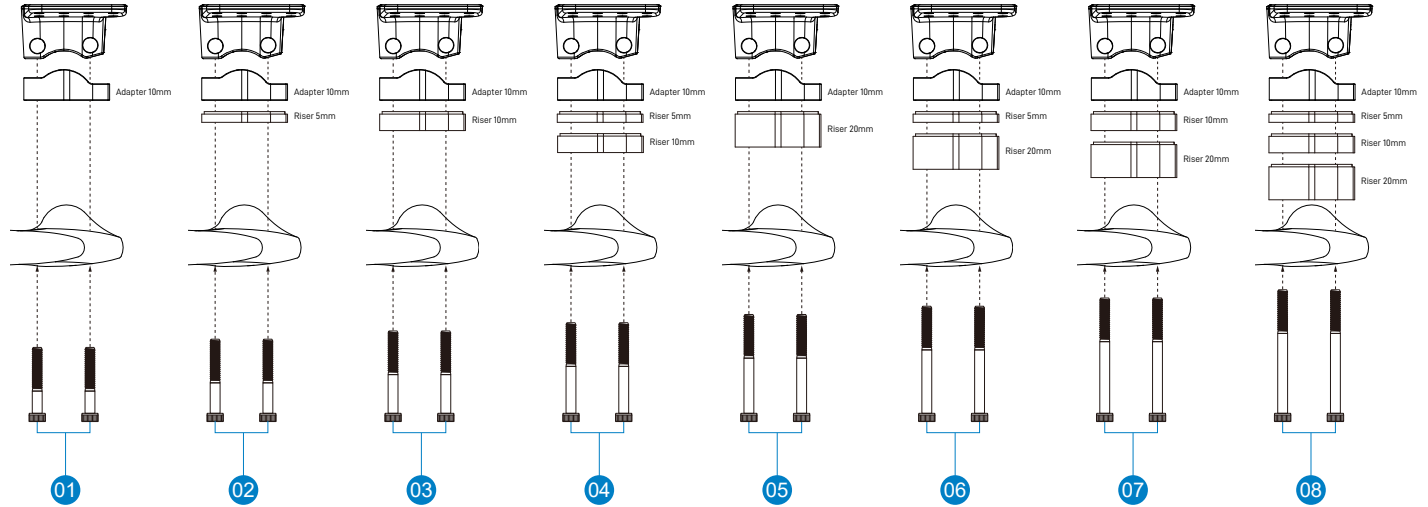

A3 _h LOW			Basebar: Wing 20c+
Ref.#	Location	Bolt Size	Torque
1	Bracket mount	M6x40mm	6Nm (53 inlbf)
2		M6x45mm	
3		M6x50mm	
4		M6x55mm	
5		M6x60mm	
6		M6x65mm	
7		M6x70mm	
8		M6x75mm	

ASSEMBLY DIAGRAMS AND TORQUE SETTINGS

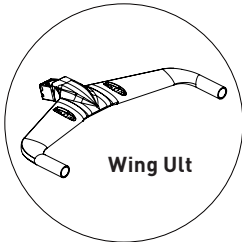
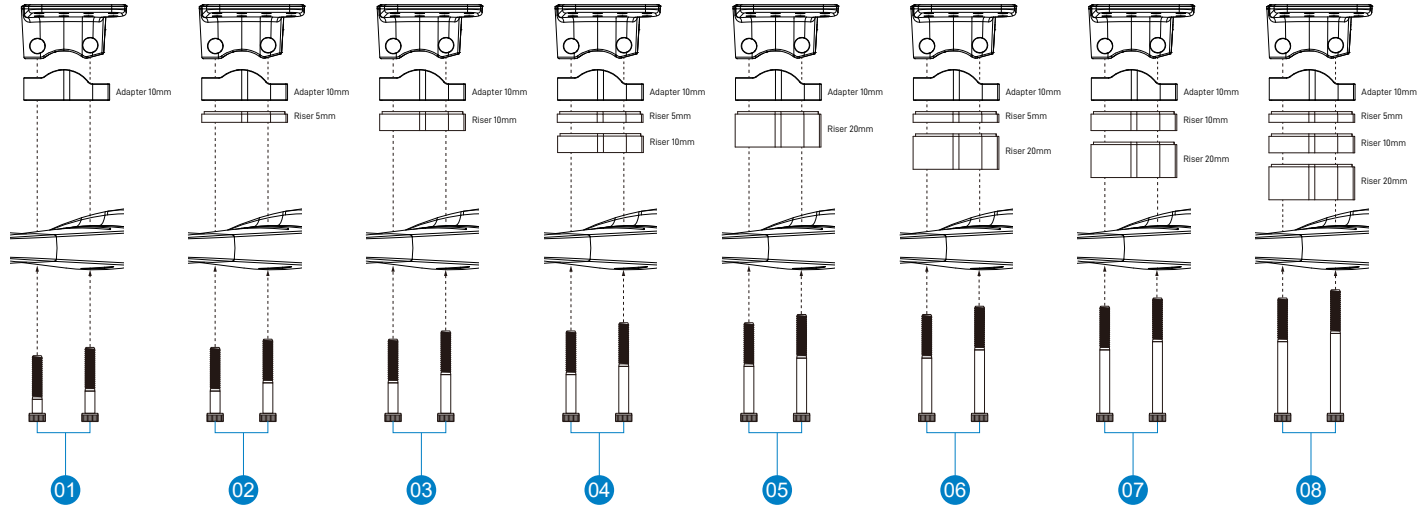

A3 _A LOW				Basebar: Wing Ult
Ref.#	Location	Front - Bolt Size	Rear - Bolt Size	Torque
1	Bracket mount	M6x35mm	M6x40mm	6Nm (53 inlbf)
2		M6x40mm	M6x45mm	
3		M6x45mm	M6x50mm	
4		M6x50mm	M6x55mm	
5		M6x55mm	M6x60mm	
6		M6x60mm	M6x65mm	
7		M6x65mm	M6x70mm	
8		M6x70mm	M6x75mm	

ASSEMBLY DIAGRAMS AND TORQUE SETTINGS

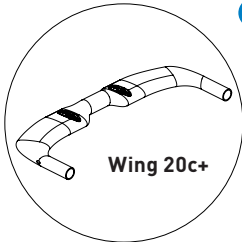
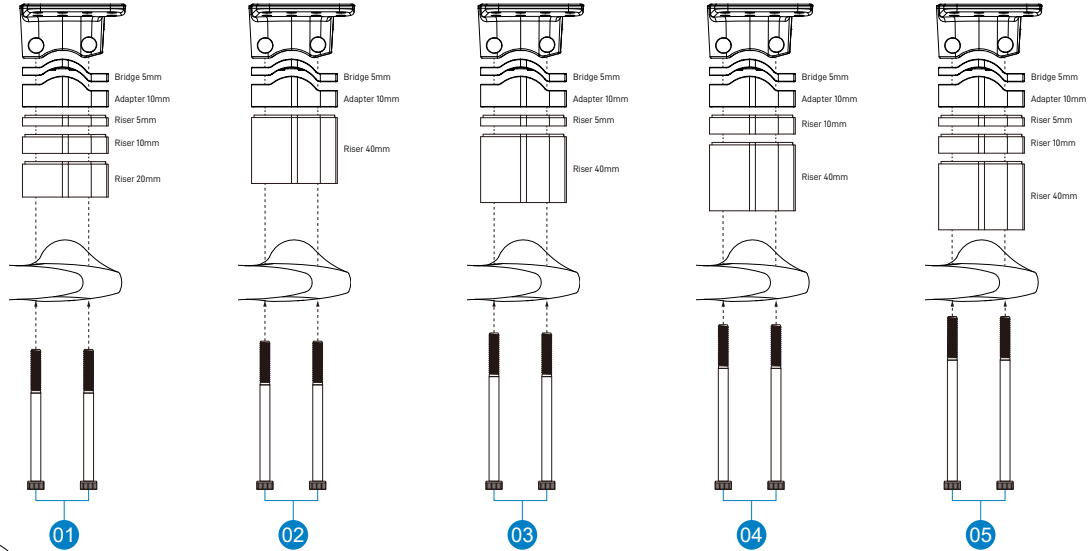

A3A HIGH			Basebar: Wing 20c+
Ref.#	Location	Bolt Size	Torque
1	Bracket mount	M6x80mm	6Nm (53 inlbf)
2		M6x85mm	
3		M6x90mm	
4		M6x95mm	
5		M6x100mm	

ASSEMBLY DIAGRAMS AND TORQUE SETTINGS

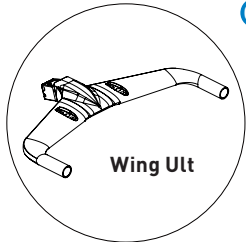
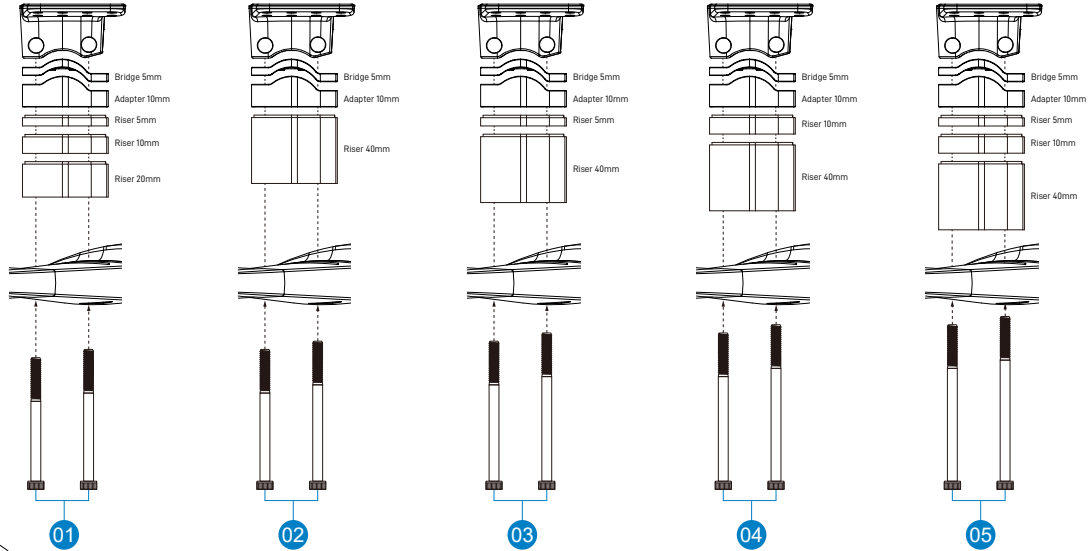

A3A HIGH				Basebar: Wing Ult	
Ref.#	Location	Front - Bolt Size	Rear - Bolt Size	Torque	
1	Bracket mount	M6x75mm	M6x80mm	6Nm (53 inlbf)	
2		M6x80mm	M6x85mm		
3		M6x85mm	M6x90mm		
4		M6x90mm	M6x95mm		
5		M6x95mm	M6x100mm		

ASSEMBLY DIAGRAMS AND TORQUE SETTINGS

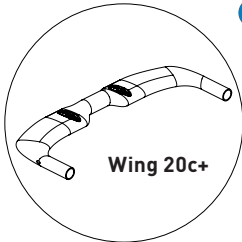
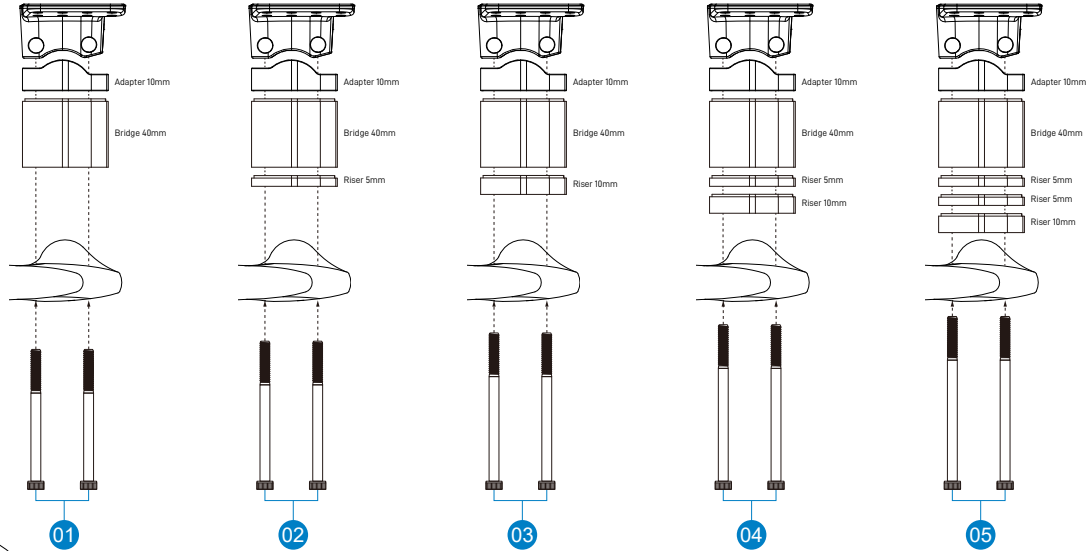

A3c HIGH			Basebar: Wing 20c+
Ref.#	Location	Bolt Size	Torque
1	Bracket mount	M6x80mm	6Nm (53 inlbf)
2		M6x85mm	
3		M6x90mm	
4		M6x95mm	
5		M6x100mm	

ASSEMBLY DIAGRAMS AND TORQUE SETTINGS

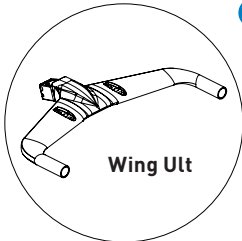
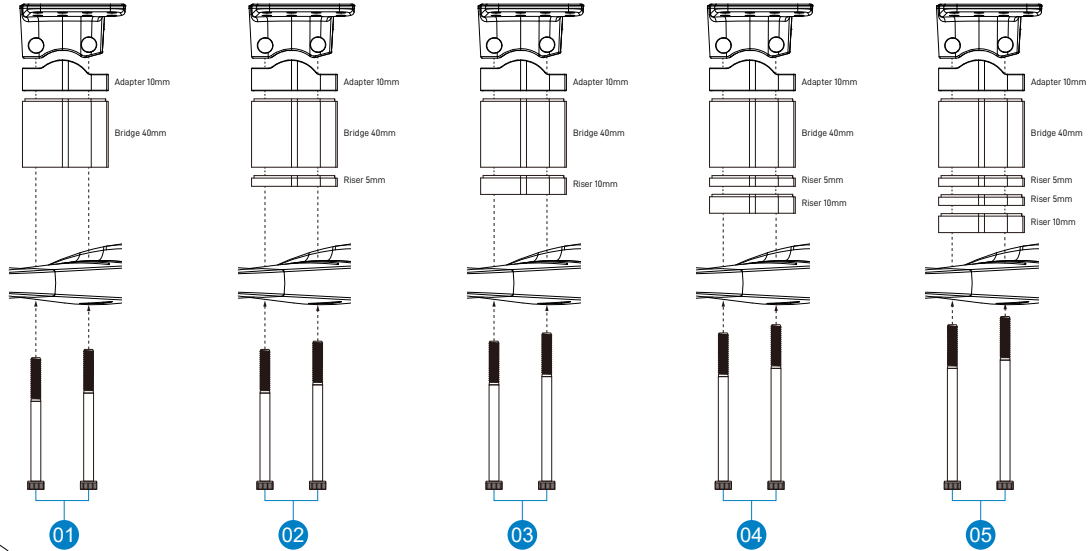

A3c HIGH				Basebar: Wing Ult	
Ref.#	Location	Front - Bolt Size	Rear - Bolt Size	Torque	
1	Bracket mount	M6x75mm	M6x80mm	6Nm (53 inlbf)	
2		M6x80mm	M6x85mm		
3		M6x85mm	M6x90mm		
4		M6x90mm	M6x95mm		
5		M6x95mm	M6x100mm		

INSTALLATION INSTRUCTIONS

1. Consult the bolt length table to ensure you use the correct length bolt for your setup. Apply grease to the contact surfaces of the risers.
 - Note that the risers are directional, the flat end faces to the rear of the bar.
2. Assemble the risers with the A3 adaptor at the top.
 - Note that the notch in the A3 adaptor should be on the stem side of the riser stack.
 - If fitting to an Aeria Ultimate bar, install the A2-A3 adaptor under the risers.
 - If using electronic gears, route the cable through the basebar and risers prior to installing the brackets.
3. Assemble the brackets
 - Assembly tip – it is usually easier to start with the bolt at the front of the bracket.
 - Use the locator groove on the side of the threaded barrel (in the aero bar bracket) to aid in aligning the barrel for bolt installation.
 - If using electronic gears, ensure the cable is sitting in the notch on the A3 adaptor before tightening the riser bolts.
4. Tighten the bolts until the aero bar bracket is firmly in place and repeat with the other side.
5. Check the placement of the brackets then use the torque wrench with a 5mm fitting to tighten the aero bar bracket clamp to 6Nm.

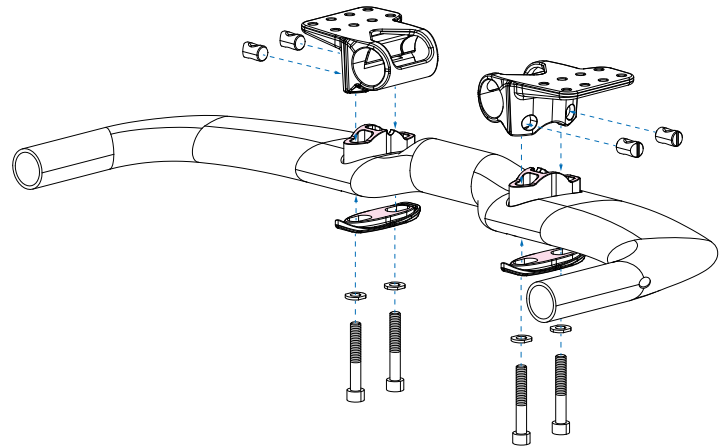

WARNING:
Using bolts that are too long for the risers and bracket will prevent correct installation.
Bolts that are too short may lead to failure during use.

WARRANTY POLICY

- Profile Design Worldwide Two Year Limited Warranty.
- Profile Design, LLC (distributor) warrants to the original retail purchaser ("you") that the Profile Design product for which you received this warranty is free from defects in material and workmanship for (2) two years from the date of original retail purchase. For more details on this warranty, its exclusions and/or how to make a claim under the warranty please call +1 310.747.0085 extension 161 or visit www.profile-design.com/pages/warranty



2677 El Presidio Street
Long Beach, CA 90810
Ph: 310-884-7756

www.profile-design.com

© Profile Design LLC