



— THE —
ELECTRICIANZ®

 READ BEFORE
USING!







—THE—
ELECTRICIANZ®

WELCOME !



INSIDE THIS BOOK...

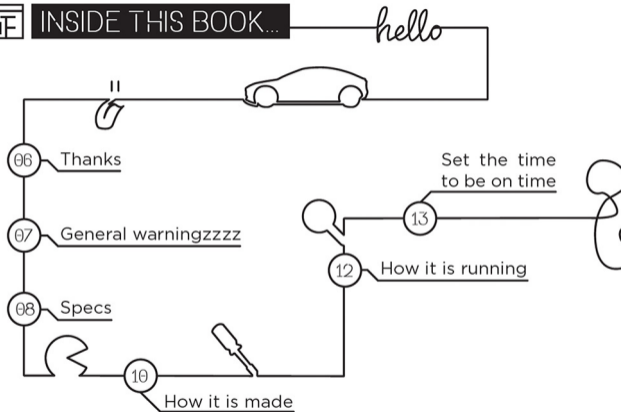

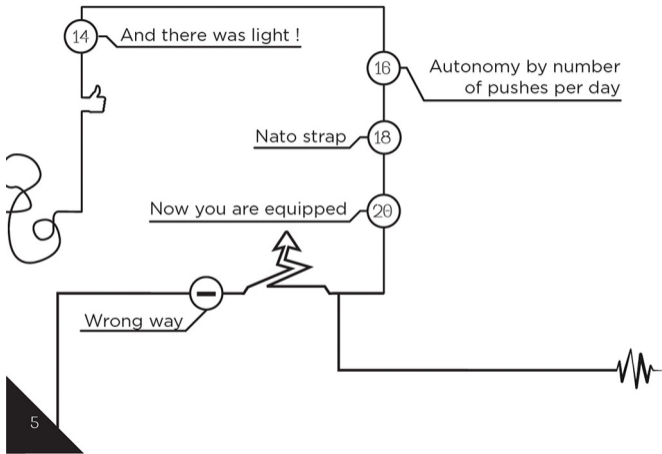



THANKS !!!

⊕ The diagram below depicts our brand principle and our design language...

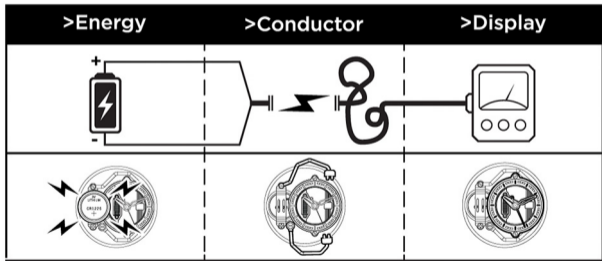



GENERAL WARNINGZZZZ

- ⊕ **T**he water resistance to 3 ATM is only guaranteed if the crown is correctly clipped.
- ⊕ **Y**ou should not use the setting functions & the light of your watch when it is humid or immersed in water.
- ⊕ **W**e recommend you to properly rinse your watch in clear water after it has been in contact with sea water.
- ⊕ **A**void exposing your watch to direct sunlight for a long time and immerse it in water. This action could cause condensation under the glass, this natural phenomenon due to the water resistance of the watch will evaporate after a few days.



SPECS

Single Battery

Case : 45.5mm ⊕

Lithium
battery
3V
48mAh ⊕

Hardened ⊕
Mineral glass K1
AR coating



⊕ Opening : 38mm

Light function ⊕

Time setting ⊕

⊕ Strap : 22mm

👍 Rain, water splash, wash hands

👎 Dive, swim , shower





SPECS

Double Battery

Case : 45.5mm ⊕

Switcher ⊕

Double-battery lighting system

When battery #1 runs off, a red LED invites you to switch to battery #2

Warning LED ⊕

2x Lithium battery 3V
48mAh ⊕

Hardened ⊕
Mineral glass K1
AR coating



⊕ Opening : 38mm

Light function ⊕

Time setting ⊕

⊕ Strap : 22mm

👍 Rain, water splash, wash hands

👎 Dive, swim, shower ⊕





HOW IT IS MADE

⊕ Reasonable price does not always rhyme with simplified construction... ;-)

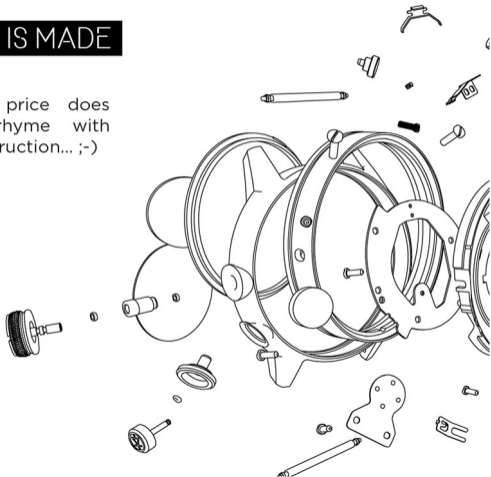

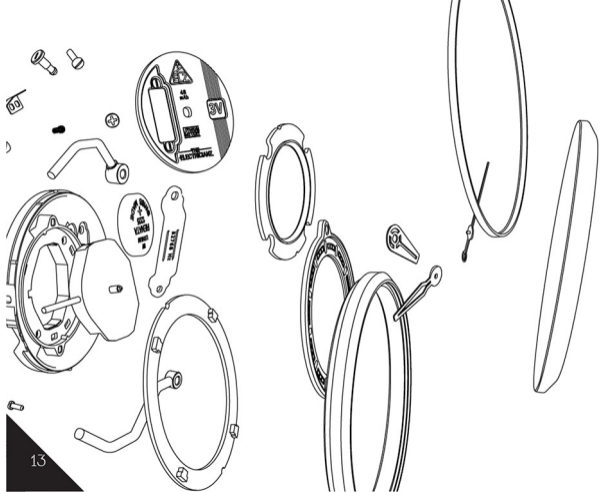



HOW IT IS RUNNING

⊕ This electric module was designed by the THE ELECTRICIANZ (based on the Japanese movement Miyota 2033). This exclusive movement has an accuracy of between +/-20 seconds per month and a frequency of 32'768 Hz.

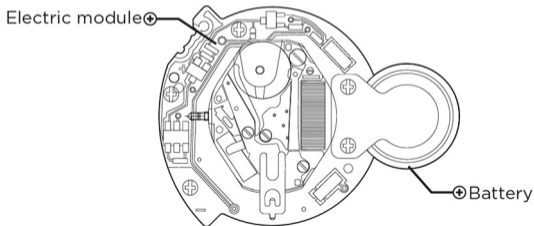



SET THE TIME TO BE ON TIME

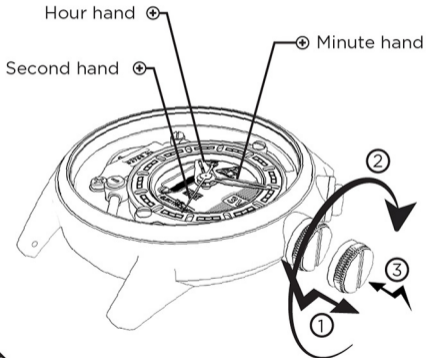

- ⊕ 1_Pull the crown to the click position.
- ⊕ 2_Turn the crown to set hour and minute hands.
- ⊕ 3_Push the crown back to initial position.



AND THERE WAS LIGHT !

⊕ If you are curious, you have already pushed that «magic» button and seen your watch come to life with our light function.

A simple impulsion will result in a few seconds of light. Pressing longer will not result in longer lighting.

4 LEDs backlight the hour ring and yes, it will affect the autonomy of your watch (turn the page for more info about that topic).





AUTONOMY BY N° OF PUSHES PER DAY



1 PER DAY
= around 25
months



3 PER DAY
= around 20
months

*We know it's a really long title but we haven't found any better... Sorry for that.



5 PER DAY
= around 17
months



10 PER DAY
= around 10
months



NATO STRAP

⊕ Please follow the instructions to avoid scratching the strap.

1/ Slide down the strap perpendicularly to the watch.

Keep a distance around 4 to 5 cm (1½ to 2 in) from the pin bar to the first metal loop.

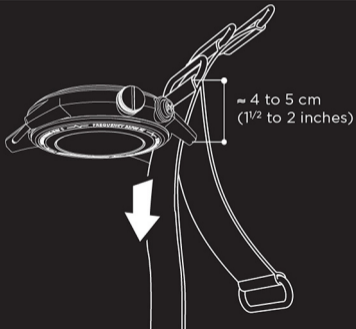

2/ Pass it through the other side vertically

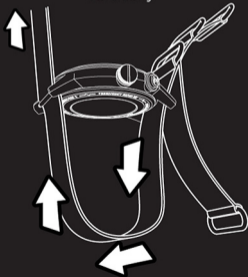

3/ Go through the loop

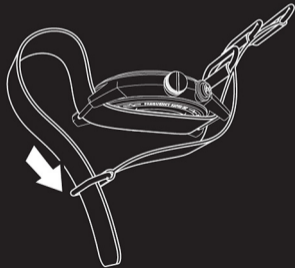



ALMOST DONE !

⊕ **F** or any inquiry about your THE ELECTRICIANZ watch, please contact an authorized dealer, visit our website or email us directly at **contact@the-electricianz.com**

⊕ **F** or legal terms visit : **the-electricianz.com/terms-warranty**

⊕ **J**oin us on social media @**the-electricianz** and please don't forget to share your best shots using **#theelectricianz** =)



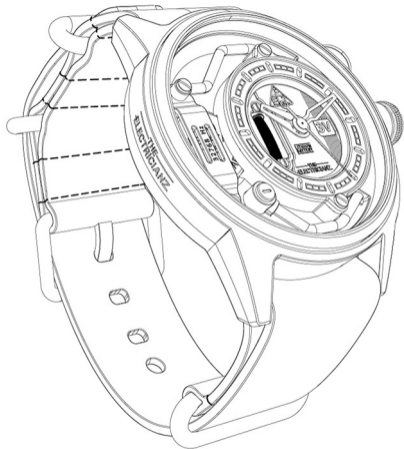





— THE —
ELECTRICIANZ®