

Overview.

The Hills Reliance TouchNav is an intuitive graphical touch screen interface for users of the Hills Reliance Security System. Offering simple fingertip control of the security system, via its clear 3.5" touch screen with easy to understand graphics.



Arming your security system.

To arm your system when you are leaving, touch the "Away Icon", while the status screen displays "Area Ready". If the status of the system is not ready, you will not be able to arm the system and will need to close the open device. Once armed, the system will give you time to exit your home.

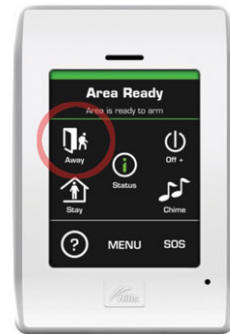

Arming when you are staying.

When you want to arm your security system while you are still in the house, simply press the "Stay" icon. The system will then only arm the devices set for perimeter protection. Your system will then chime once, and arm but the codepad will not beep during the exit delay.

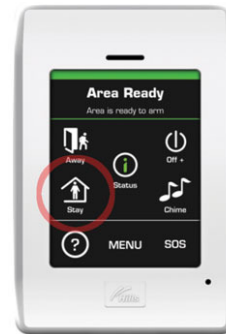

Disarming the Alarm.

When you want to turn off your security system, tap the "Off" button on the screen. You will then be prompted to enter your 4 digit code. Once your code is entered correctly the system will disarm.

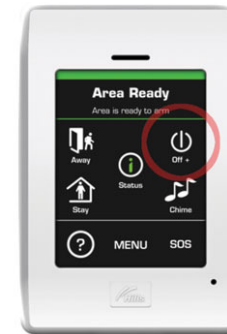

SOS Function.

The Hills TouchNav keypad has a feature that if enabled, allows the user to signal the alarm monitoring control room in the event of an emergency. These emergency buttons can be located by tapping the "SOS" key on the codepad.

When the "SOS" key is selected, you will be presented with 3 option, Fire, Medical and Police. To activate a SOS function, press and hold the selected key for 3 seconds. The selected key will change colour and announce the selection. To reset the SOS alarm, you will need to enter your 4 digit code.

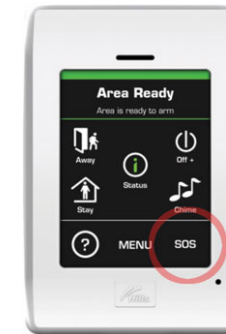

Advanced Features.

Pressing the "Menu" key will display several features helpful in controlling your Hills home security system. The following features showcased will enable you to bypass zones, add users and adjust system settings.

Bypassing Zones. (From Menu Screen)

If there is a detector un-sealed and you are unable to seal it but and you need to arm your security system, you will need to bypass the un-sealed detector. The first step in doing this is to press "Menu" and then the "Controls" icon on your keypad.

Changing Users.

To change, add or delete a user, press "Menu" then "Controls" and then press the "Users" key. You will then be prompted to enter your 4 digit security code. You will then be prompted to select a user from the list of filled and empty user spaces. To select more users than are displayed, press the right arrow key located at the top of the screen.

User Configuration.

From the "modify user screen" you are able to change the name, the code or simply delete the selected user. For advanced configuration press the "Config Account" option. This menu gives you further options in setting what specific control that particular user might have. For example by selecting the "arm only code" that user will only be able to arm the security system, not disarm.

System Settings.

By pressing the "menu" key from the main screen, the Settings options key is displayed. From "Settings" you are able to configure how the keypad sounds and looks. From this menu you are also able to customize text for individual zones, Set the time and date, adjust your entry and exit delays and program entry and exit messages.

Other useful functions

- Displays history of past events. MENU → History
- System Testing. MENU → Testing
- Reset Smoke Detector. MENU → Testing → Smoke Reset
- Show status of system. Status
- Show installer contact details. MENU → Help
- Set Entry/Exit Message. MENU → Settings → Message
- Clean keypad. MENU → Clean Me

