

Flotilla 6

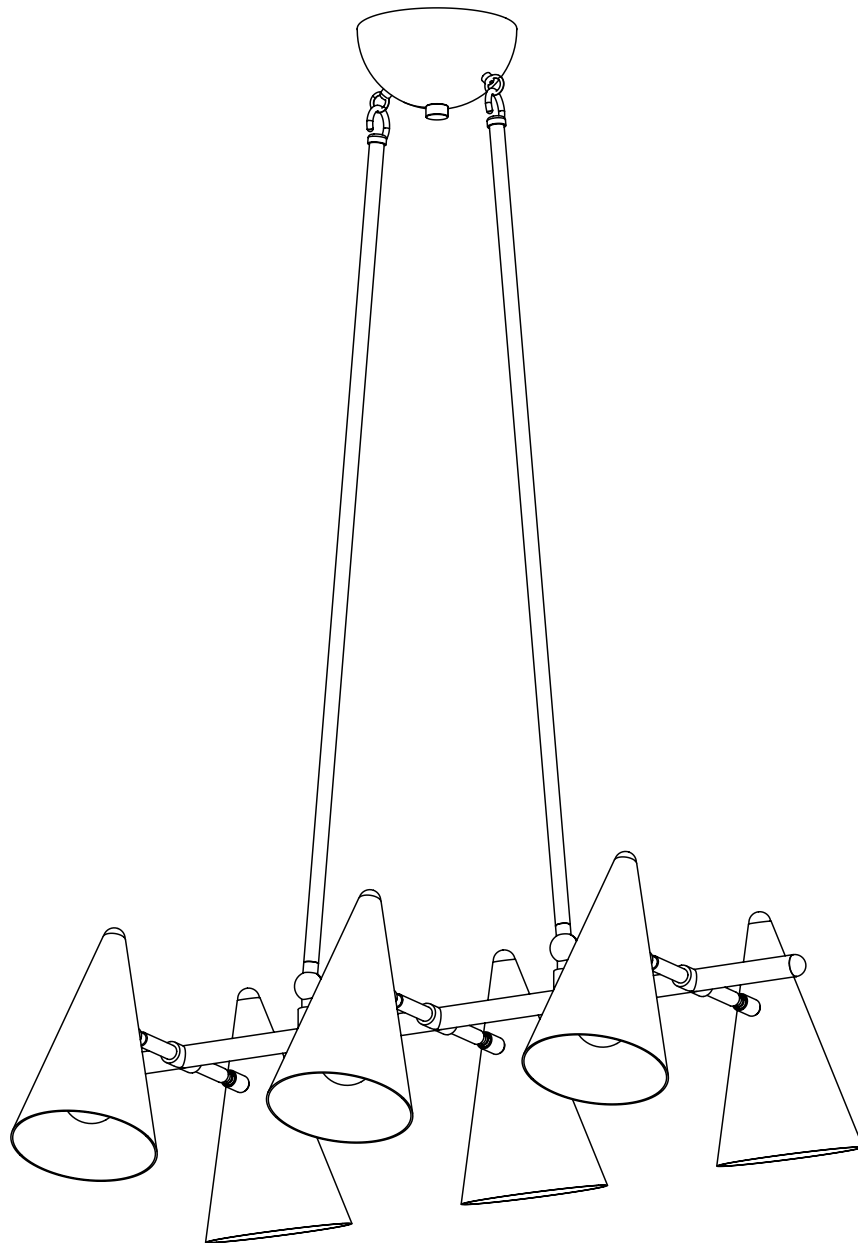

Flotilla 6 Contents

Remove all parts from box onto a clean, soft surface and inspect for defects or damage.

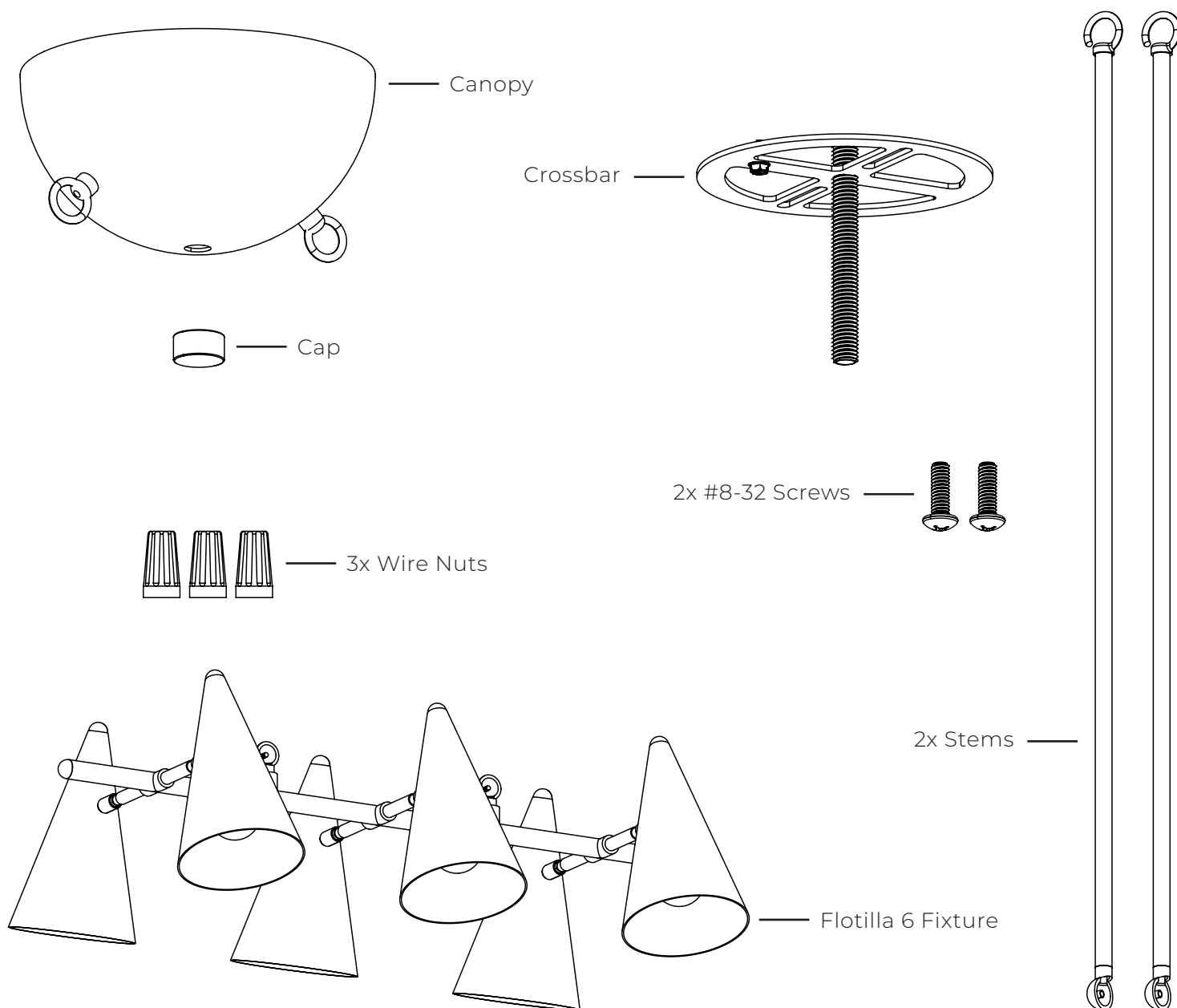

1. Mount the crossbar-nipple assembly to the junction box using the provided #8-32 screws.

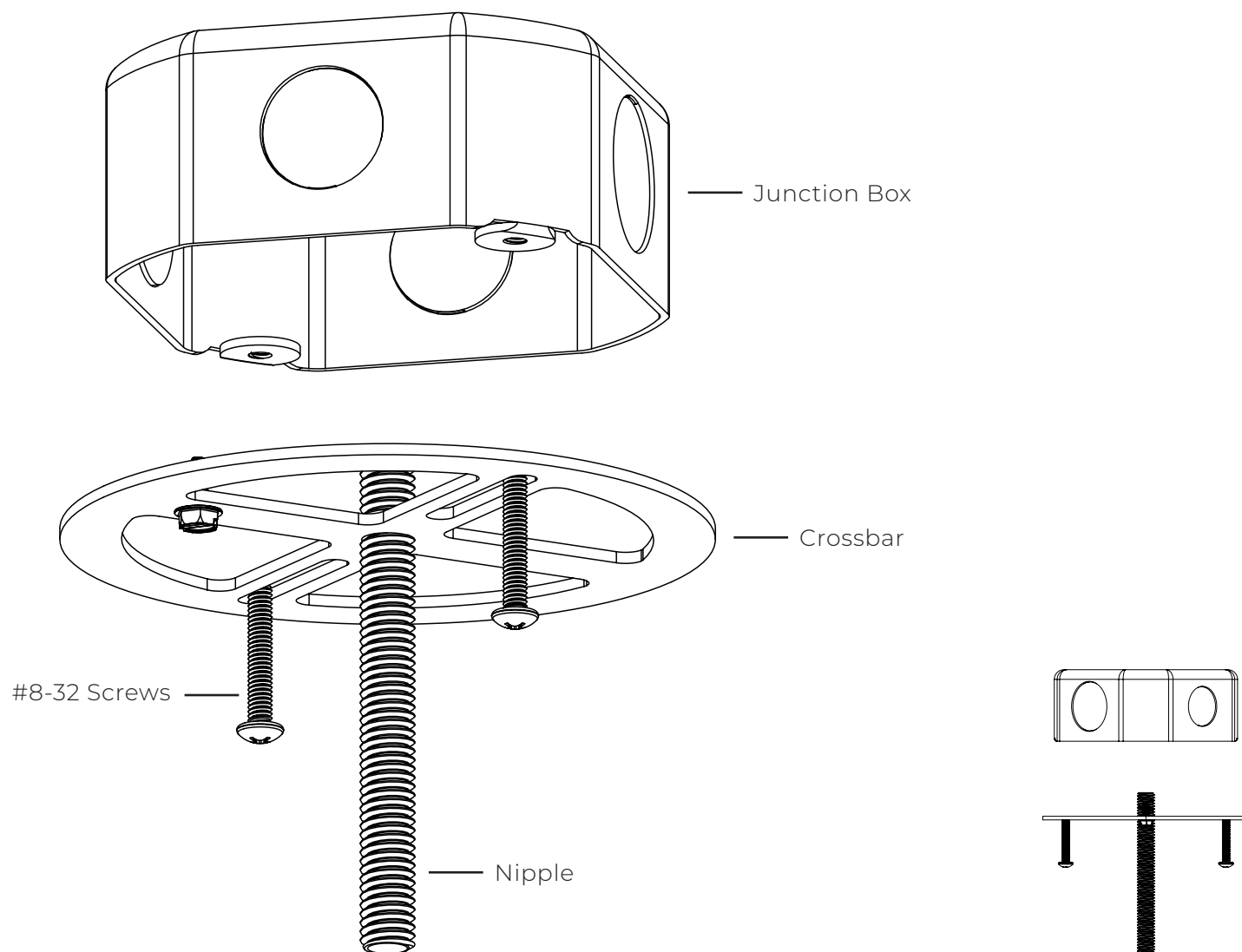

2. Connect the stems to the Flotilla fixture by screwing both halves of the knuckle together using the flat head screw provided. Be sure to position the wires around the screw when tightening so they do not get pinched.

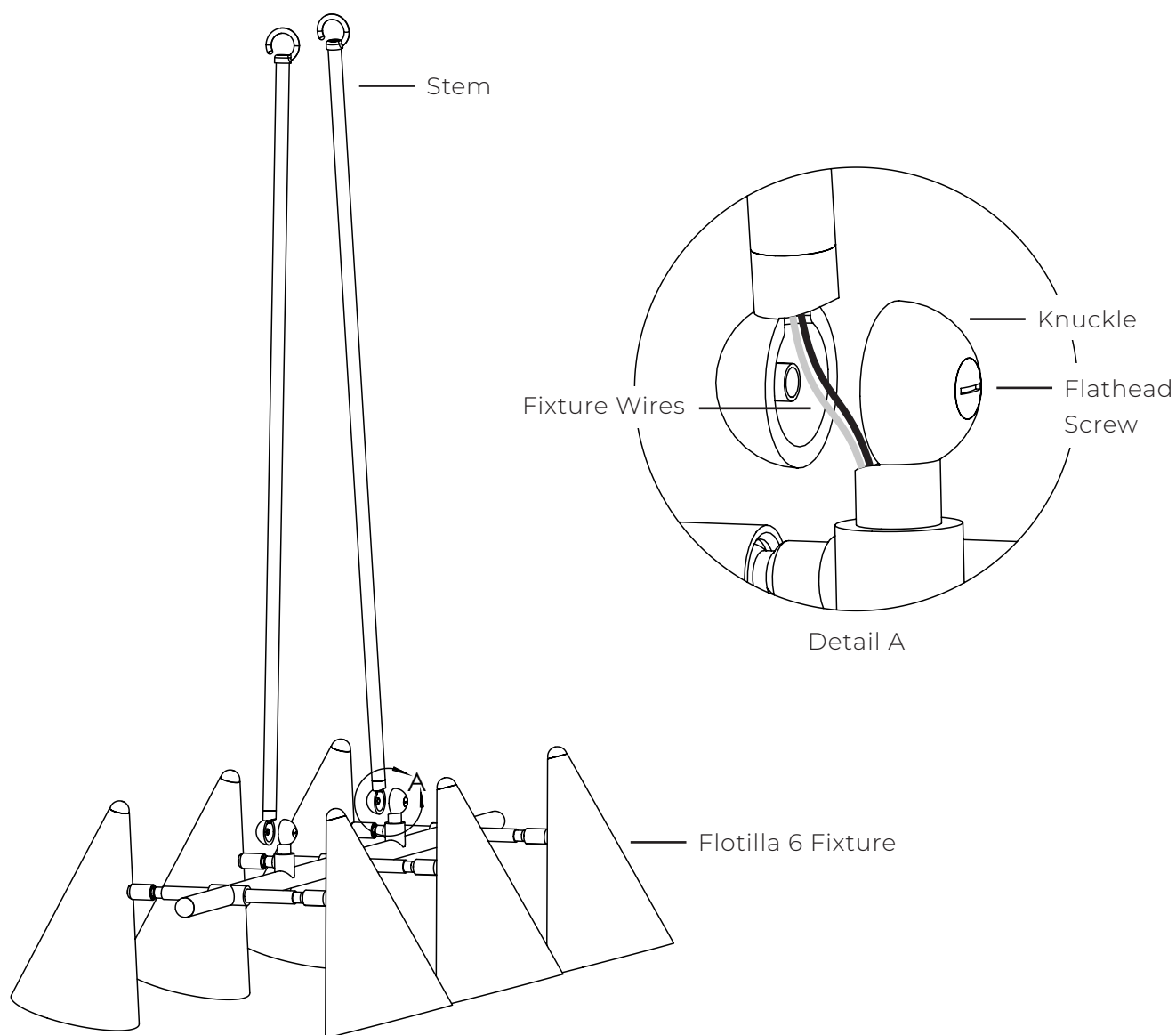

3. Person 1 will hold the canopy while person 2 holds the Flotilla 6 fixture.
4. Take the fixture wires coming out of the hook on the stem and pass them through the hole in the loop on the canopy.
5. Hook both stems onto both loops on the canopy.

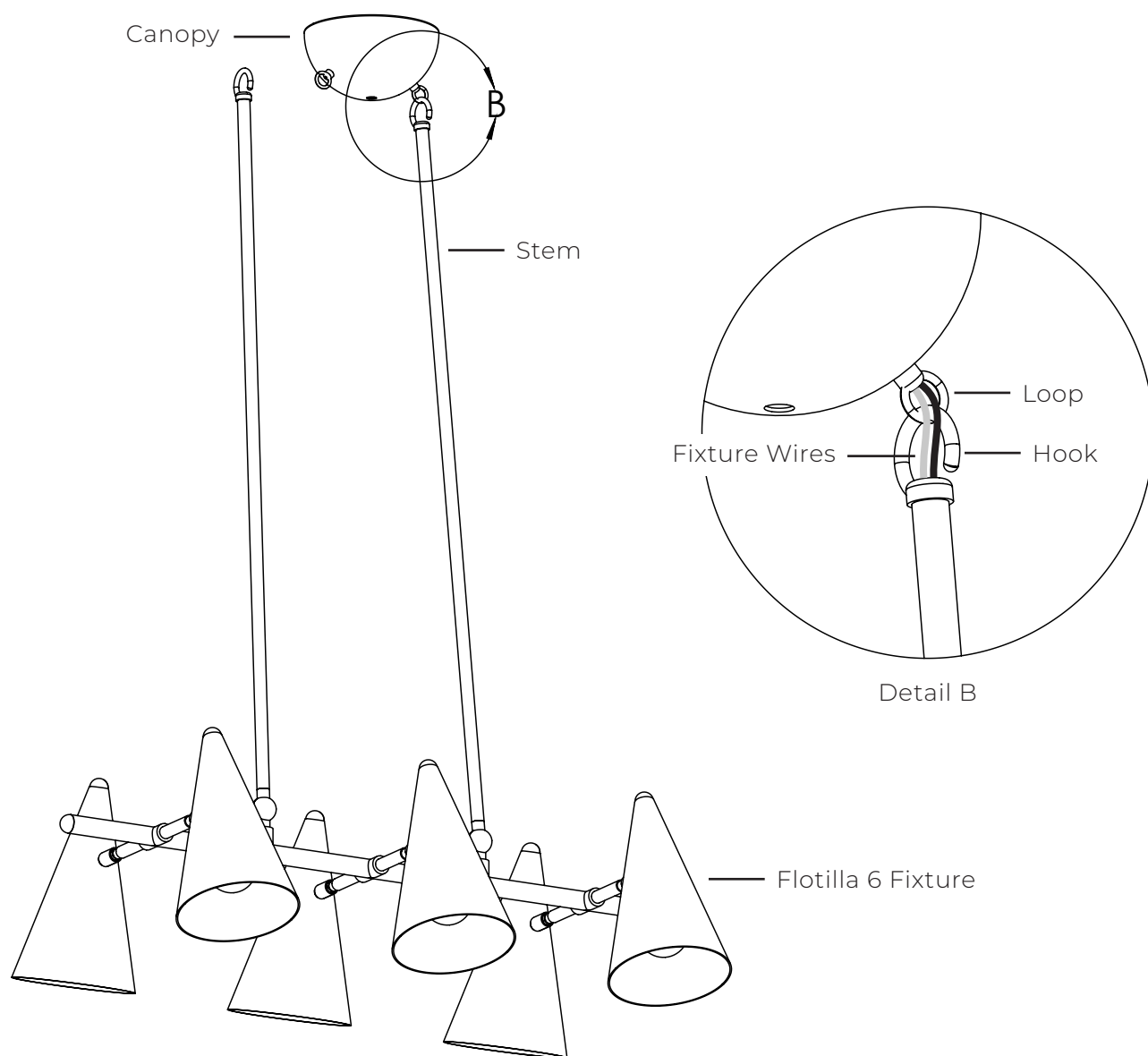

6. Person 1 lifts the fixture by the canopy up close to the junction box.
7. Person 2 connects the fixture ground wire to the ceiling ground wire.
8. Person 2 connects the +/- fixture wires to the +/- ceiling wires.

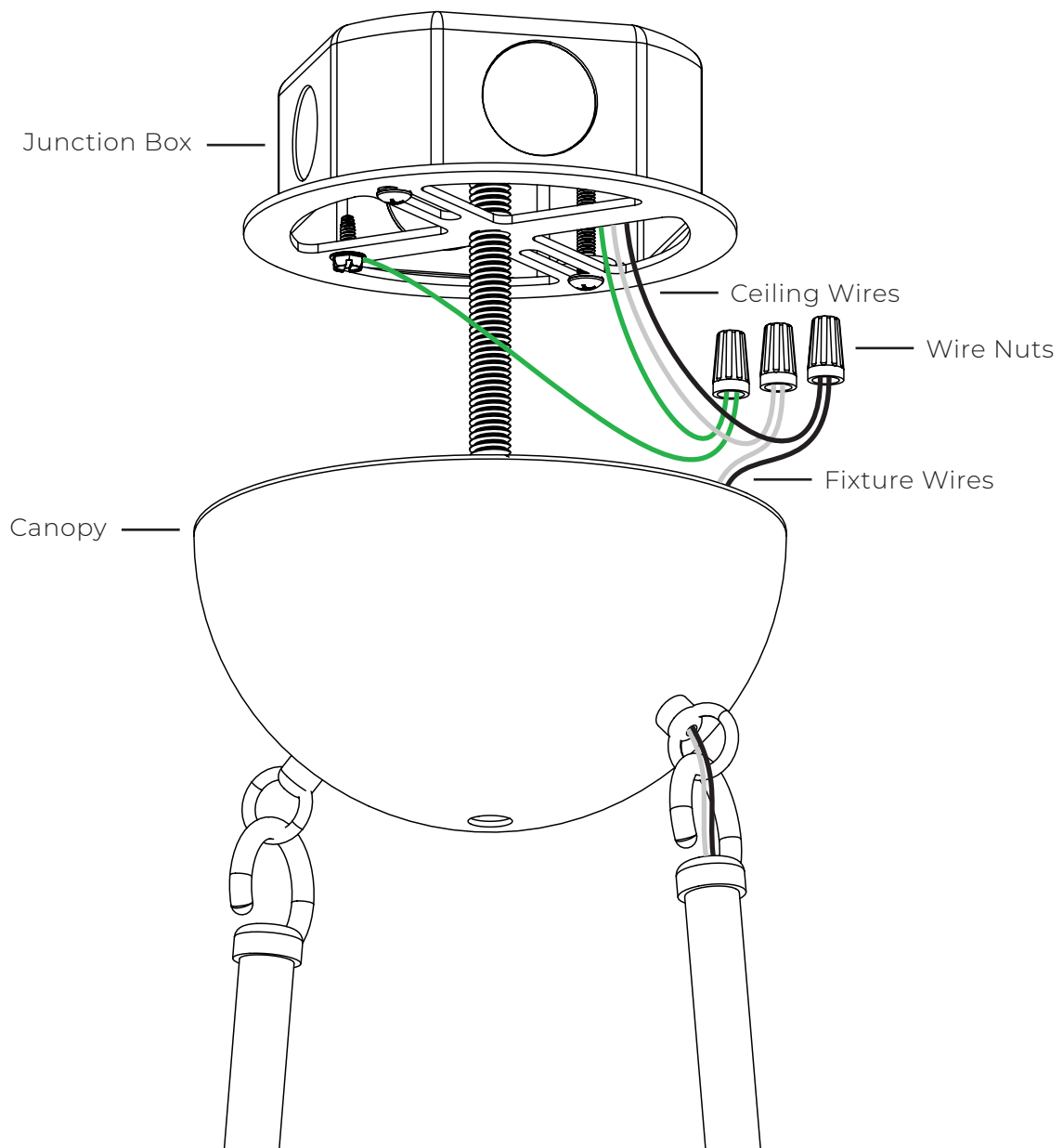

9. Feed the nipple through the canopy until it is exposed at the bottom.
10. Attach the canopy cap to the nipple and tighten until it is flush with the canopy.

