

Dual camera allows for either side view or front view with just a switch. No mirror attachment necessary.

Using Switch Key, you can toggle between front and side views. Indicator Light with arrow will show which view you are using at the time.

To attach to the video scope monitor, simply align probe and Control Head Connector red dots and hand tighten the threaded connector nut.

Text

www.ANSEDdiagnostics.com

©2013 ANSED Diagnostic Solutions LLC. All rights reserved.

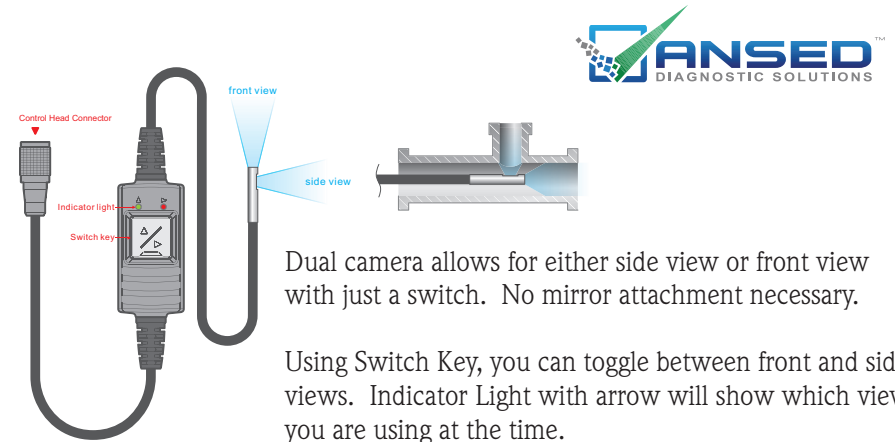

Dual camera allows for either side view or front view with just a switch. No mirror attachment necessary.

Using Switch Key, you can toggle between front and side views. Indicator Light with arrow will show which view you are using at the time.

To attach to the video scope monitor, simply align probe and Control Head Connector red dots and hand tighten the threaded connector nut.

www.ANSEDdiagnostics.com

©2013 ANSED Diagnostic Solutions LLC. All rights reserved.

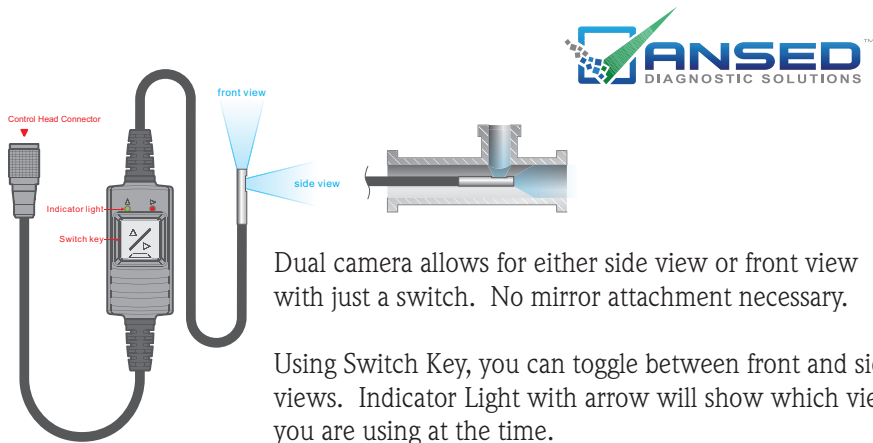

Dual camera allows for either side view or front view with just a switch. No mirror attachment necessary.

Using Switch Key, you can toggle between front and side views. Indicator Light with arrow will show which view you are using at the time.

To attach to the video scope monitor, simply align probe and Control Head Connector red dots and hand tighten the threaded connector nut.

www.ANSEDdiagnostics.com

©2013 ANSED Diagnostic Solutions LLC. All rights reserved.

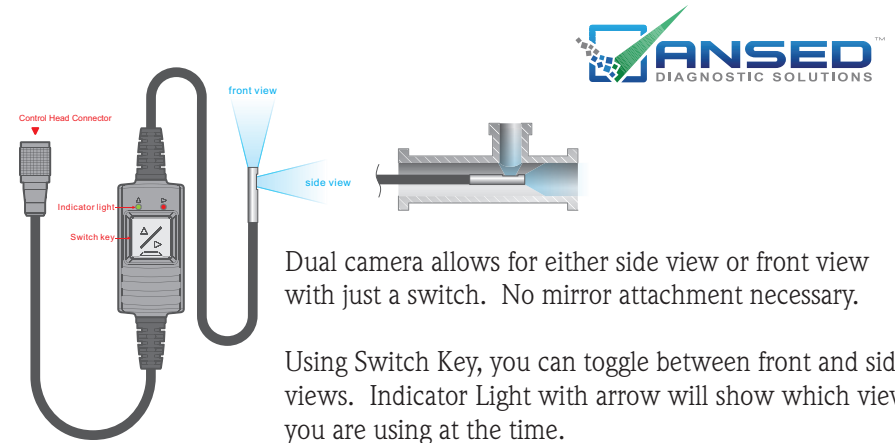

Dual camera allows for either side view or front view with just a switch. No mirror attachment necessary.

Using Switch Key, you can toggle between front and side views. Indicator Light with arrow will show which view you are using at the time.

To attach to the video scope monitor, simply align probe and Control Head Connector red dots and hand tighten the threaded connector nut.

www.ANSEDdiagnostics.com

©2013 ANSED Diagnostic Solutions LLC. All rights reserved.