

KIIRO°

WITH
FLESHLIGHT®



PEARL2

MANUAL

The Pearl2 is to be used with authorized Feel Apps only. These apps are: FeelConnect, FeelPerformer and FeelVR. Please be advised that this list may be updated in the future. Visit the following link for the most up-to-date list: www.kiiroo.com/compatible-software

Downloading any third-party applications to control or interact with the Pearl2 that are not mentioned above is done entirely at your own risk. In the event that a third-party application is downloaded and it damages either the device software or hardware or leads to personal injury, neither Kiiroo nor any of their partners will be held liable. In the event that third-party applications are downloaded, the device warranty will be void.

Table of Contents

1. Set up your device	2
2. Using your device	3
3. Download the FeelConnect App	4
4. Services	5
5. Modes	6
5.1 Bluetooth Mode	7
5.2 Touch-Sensitive Mode	7
5.3 Manual Mode	7
6. Charging and LED indicator	8
6.1 To charge your device	8
6.2 LED Indicator	8
7. Handling and Lubrication	9
8. Cleaning	10
9. Disclaimer and Warnings	11
10. Disposal Specifications	12
11. Aftercare and Help	13
Specifications	13
Help	13
Opening hours	13

1. Setup your device

1. Using the Pin USB charger provided, charge your device until the light turns green; about 2 hours. We recommend charging the device fully prior to the first use.

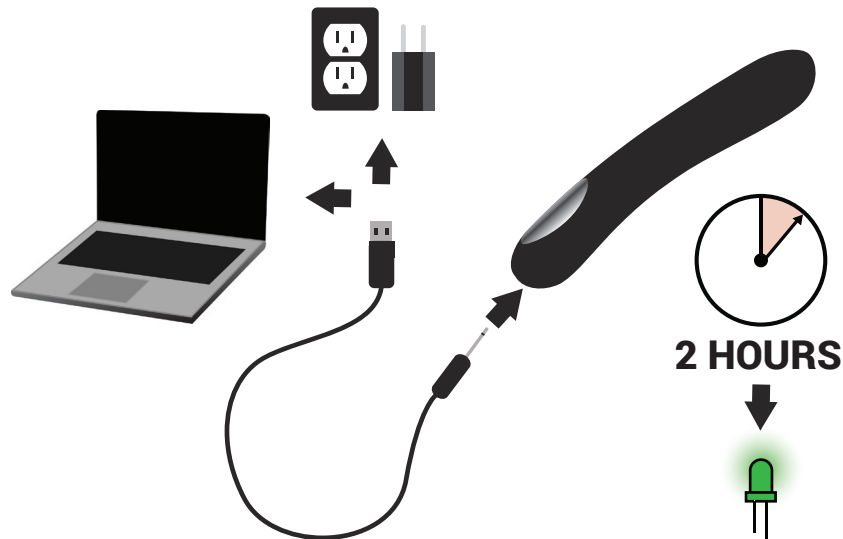

- The charging port can be found at the bottom of Pearl2.
 - Insert the Pin into the small hole at the bottom of the Pearl2.
2. Go to www.kiiroo.com to create your user account.
(<https://www.kiiroo.com/my-account/>)
 3. Once you have created an account, please go to:
<https://www.kiiroo.com/register-your-device/> to register your device and activate your one (1) year warranty.
 4. Download the FeelConnect App to pair your device with your mobile phone.

android

iphone

2. Using your device

1. Power on by pressing the multifunctional button at the bottom of the device and hold for 4 seconds.

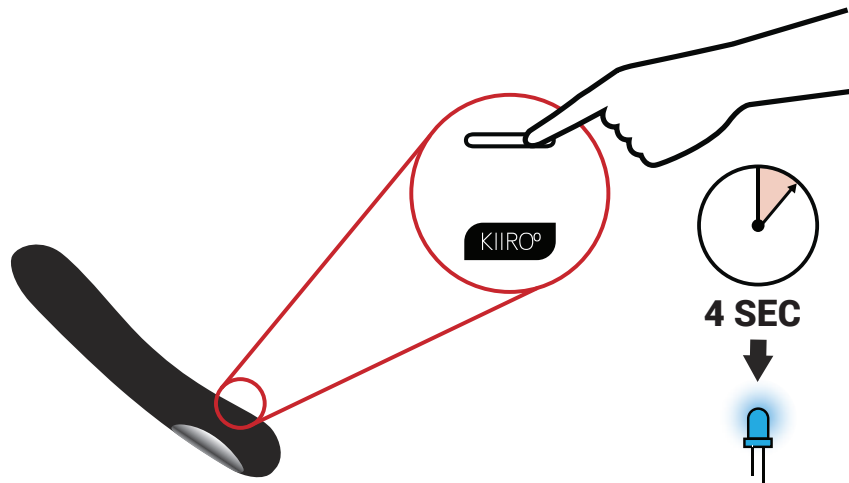

2. A solid blue color will show and the device is now in Bluetooth Mode (go to page 7).
3. Push the button once. The light will turn white and now the device is in Touch-Sensitive Mode (go to page 7).
4. To turn off the device, hold the multifunctional button for 4 seconds until the light goes off.

**Please note: Pearl2 is waterproof, so take your pleasure to the shower or bath and live up some of your wildest fantasies...

3. Download the FeelConnect App

Please download the FeelConnect App and follow the instructions on how to pair your Pearl2 to the app.

android

iphone

4. Services

Feel Your Lover

When paired online, the corresponding device(s) give you the touch and intimacy you crave, from anywhere in the world, mimicking intimacy in real-time.

Feel Videos

Our exclusively encoded porn videos will let you not only see your favorite stars, but feel them too. The vibrations of Pearl2 sync with the motions you see on the screen.

Feel Virtual Reality

Use the Pearl2 in combination with VR glasses and VR Porn. Experience high quality adult videos filmed in 180 and 360-degrees with 3D stereoscopic views. The sensory experience becomes as immersive and mind-blowing as can be.

Feel Webcam Models





Our webcam partners have a special interactive section on their website with hot cam models' ready to control your device. Every move cam models make can be felt on the device and vice versa.



Go to [FeelMe.com](https://www.feelme.com) to find a variety of interactive content.

5. Modes

Pearl2 has 7 modes;

- Bluetooth Mode	0 CLICKS*	BLUETOOTH MODE
- Touch-Sensitive Mode	1 CLICK	TOUCH-SENSITIVE MODE
- Slow	2 CLICK	
- Medium	3 CLICK	
- Fast	4 CLICK	
- Pattern 1	5 CLICK	
- Pattern 2	6 CLICK	

** Please note that Bluetooth Mode is the only mode where you can send & receive signals to and from partners or content.*

To cycle through each mode, click the single multifunctional button until you reach the mode of your choice.

5.1 Bluetooth Mode: Indicated by blue light.

1. To pair the Pearl2 with content, follow the instructions on the FeelConnect App.
2. Go to [FeelMe.com](https://www.feelme.com), click on "My Devices" in the top right corner, and scan the QR code to connect to the content of your choice.



5.2 Touch-Sensitive Mode: Indicated by white light*

Pearl2 responds intuitively to touch; its surface will vibrate whenever it comes into contact with your body. Move the upper surface of the device over your clitoris to enjoy precise sensations delivered exactly where contact is made. Move Pearl2 deeper inside, to feel the entire shaft respond with more widespread vibrations.

** Depending on the color of your device, the white light will have a different glow*

5.3 Manual Mode

Once the device is in Manual Mode you can click through the pre-set modes.

- Bluetooth Mode	0 CLICKS*	BLUETOOTH MODE
- Touch-Sensitive Mode	1 CLICK	TOUCH-SENSITIVE MODE
- Slow	2 CLICK	
- Medium	3 CLICK	
- Fast	4 CLICK	
- Pattern 1	5 CLICK	
- Pattern 2	6 CLICK	

6. Charging and LED Indicator

6.1 Charging

1. Insert the Pin Charger cable into the Pearl2s charging point. The Pin point is located at the very bottom of Pearl2.
2. Insert the other end into a USB port. This can be in a computer or wall adapter [Please note: wall adapter is NOT included in the box.]
3. Wait for the LED light to blink slowly; thus, indicating that the Pearl2 is charging.
4. The LED light will glow solid **green** when Pearl2 is fully charged.
5. When the battery is low, the LED light will prompt you to charge by flashing **red** quickly. You will have 5 minutes before Pearl2 disconnects from Bluetooth and turns off.
6. The LED light will blink **yellow** continually if an update is available or if something has gone wrong.

6.2 LED Indicator

BLUE	Bluetooth mode
WHITE	Touch-Sensitive Mode
GREEN	Fully charged
RED	Battery low
BLINKING RED	Battery critically low- 5minutes until disconnect
YELLOW	Pearl2 is in Bootloader mode and needs updating
BLINKING YELLOW	Pearl2 is updating

**For the Black Pearl2 the LED indicator for the pre-set modes will turn red*

7. Handling and Lubrication

Hold Pearl2 at the base of the device and apply a generous amount of water-based lubricant.

***Please note:*

- Pearl2 is not a hands free device.*
- Pearl2 is intended for vaginal use only.*

Recommended:

1. Always use FleshLube or any other water-based lubricant.
2. Always use lubricant as it will prolong the lifespan of Pearl2 and give you the most comfortable experience.

Do not use:

1. Silicone lubricant as it will deteriorate the silicone of Pearl2.
2. Massage oils or hand cream as lubricants.
3. Pearl2 anally. It does not have a tapered base and might get stuck.

8. Cleaning

Always clean Pearl2 thoroughly after each use. Use warm water along with antibacterial soap, dish soap or a specialized toy cleaner.

Try to avoid cleaners containing alcohol, petrol or acetone and harsh soaps as this might damage the silicone of the Pearl2.

** Hygiene silicone is an easy material to clean. It will last for years when taken care of properly.*

9. Disclaimer & Warning

- We, Kiiroo, make no medical claims with our devices.
- Our devices are not to be used by or on minors (anyone under 18), or anyone who is unable or unwilling to express consent.
- Follow all directions as set forth by the manual, and do not attempt to make any technical adjustments to your Kiiroo device at home.
- Kiiroo will not be held responsible for any undesirable results of misuse.

Do NOT use your Pearl2:

- If there are exposed electronic elements
 - On inflamed or irritated areas
 - If it is excessively hot to touch
 - Anally

- Avoid leaving your Pearl2 in direct sunlight and NEVER expose it to extreme heat.
- Never use cleansers containing alcohol, petrol or acetone.
- Do not use heating appliances to dry the device.
- Avoid using harsh soaps as they can damage the silicone material.
- Always store the device out of reach of children.
- The Bluetooth module is located in the handle. For personal safety and optimal reception, avoid inserting the handle (only use the top 13cm).

10. Disposal Specifications

While Pearl2 is made of eco-conscious materials, you should not dispose of Pearl2 in your waste bin. Like any electronic device with a rechargeable battery, there are disposal regulations. These vary by city and local municipality. Be aware of how electronics are disposed of where you live.

Also consider that in your locality, Pearl2 may be considered biowaste because of its intimate nature. Kiiroo suggests asking your local council center.

11. Aftercare and Help

Specifications:

Materials:	ABS, silicone
Finish:	Matte chrome for ABS, matt finish for silicone
Size:	200 x 39 x 36.5 mm
Weight:	139 grams for device, 159g for device + USB cable
Battery:	Lithium-ion 540 MAH 3.7V
Charging:	2 hours
User time:	1 hour

Help

If you have any further problems with setup and installation, or issues with using your device, do not hesitate to contact our customer service team. Our technical team is there for your support, to explain problems in detail, and to make sure your online experience runs as smoothly as possible. We try to answer all questions within 48 hours of receiving them.

For frequently asked questions visit:

www.kiiroo.com/faq

www.kiiroo.com

info@kiiroo.com

+31207371194

Opening hours are:

Mon - Fri, 9AM - 5PM CET.