



***How to Connect your Interactive Toy
with the FeelConnect app.***



- 1. Connect Your toy to Interactive Videos.** (page 2)
- 2. Connect to Your Partner from a Distance.** (page 4)
- 3. Connect 2 or more toys in the same proximity.** (page 6)
- 4. Connect Your toy to Interactive VR content.** (page 7)

1. Connect Your toy to Interactive Content.



1. Turn on your device.
It is in Bluetooth mode.

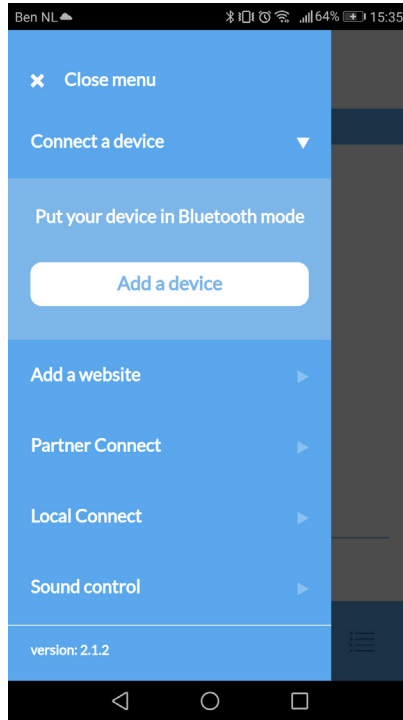

2. Open the menu bar in the FeelConnect app and tap 'connect a device'

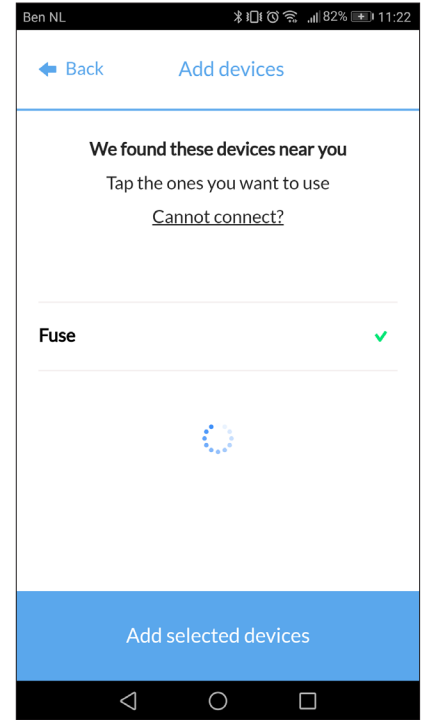

3. Click on the product you would like to connect. Then tap on 'add selected devices'.

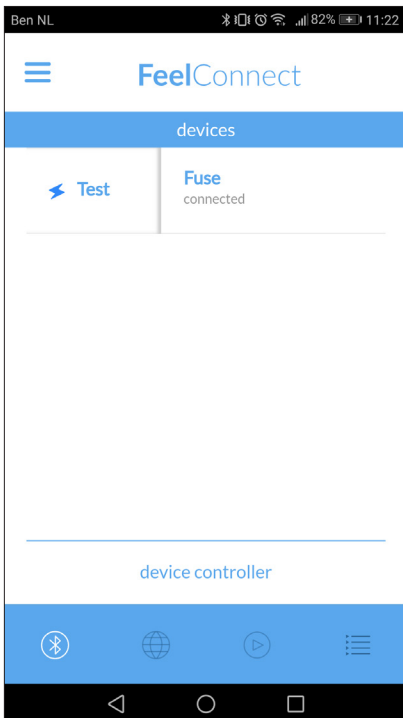

4. Slide the slider right, the "test" option shows, click it to ensure your device is working properly.

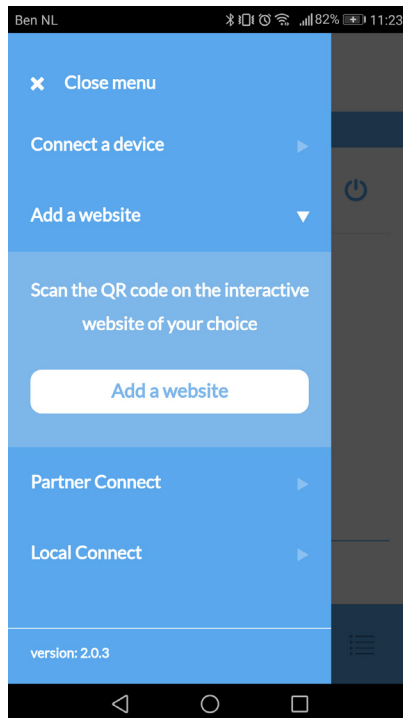

5. Now, to add your favorite content website, open the menu bar and select 'add a website'.

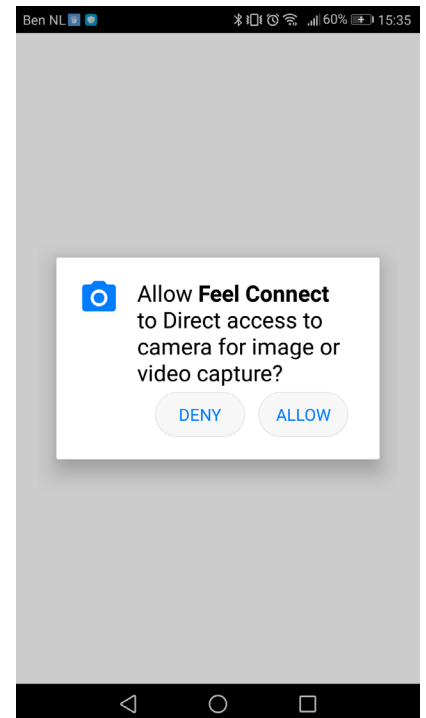

6. The app will ask you to access the camera, tap allow; It will open a QR code scanner.

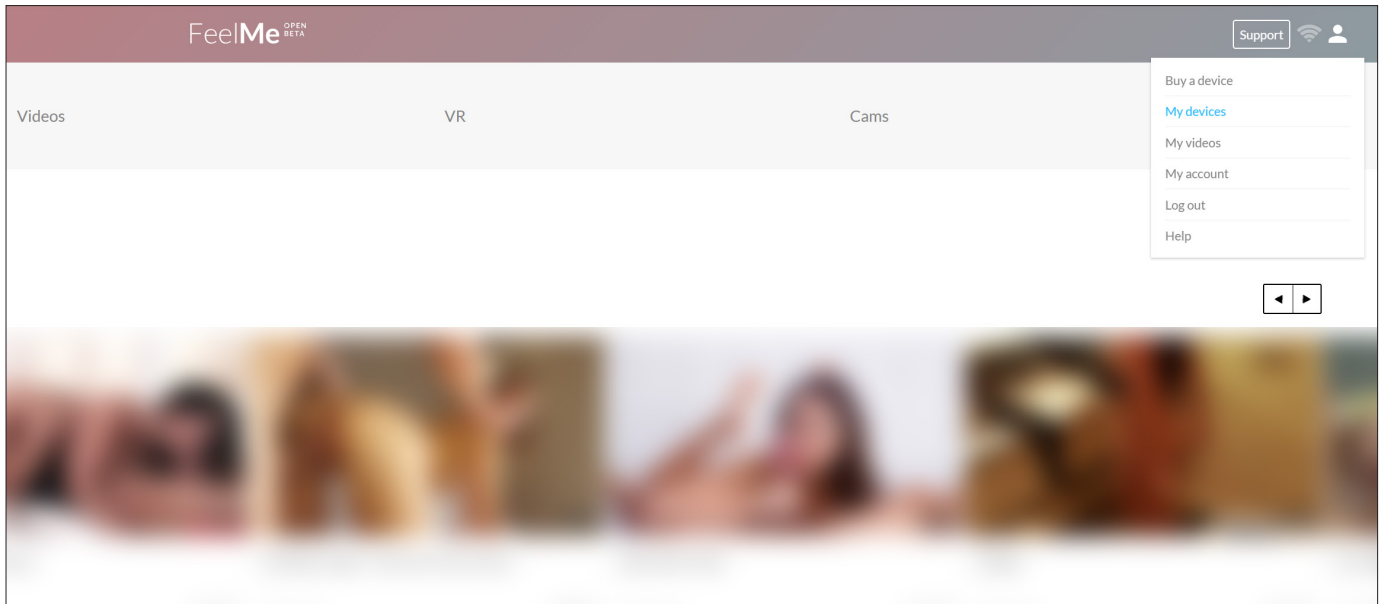

7. Go to FeelMe.com, register your free account and then click on “My devices”.

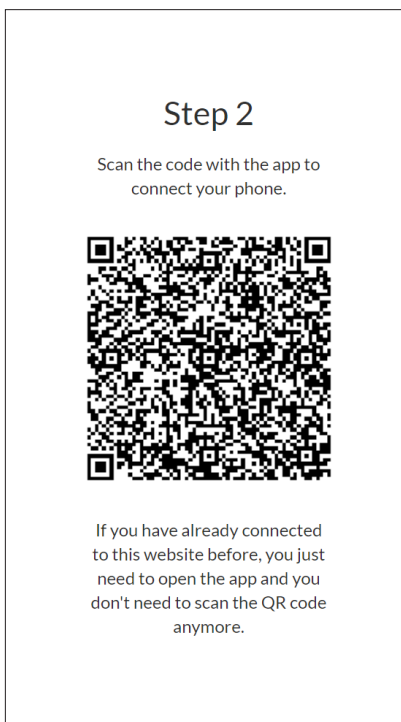

8. The website will open a QR code in a new page.

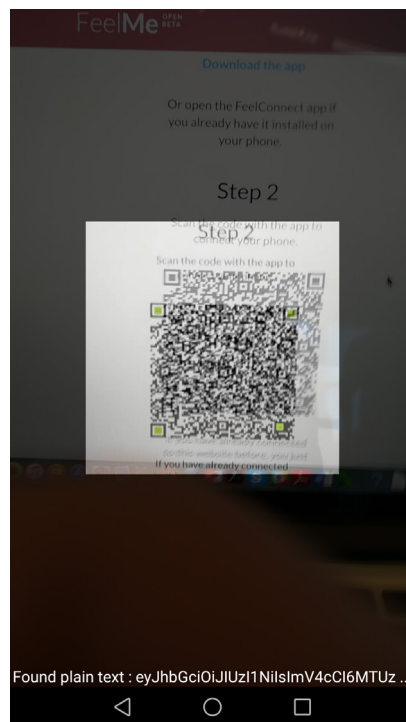

9. Scan the QR code with your smartphone.

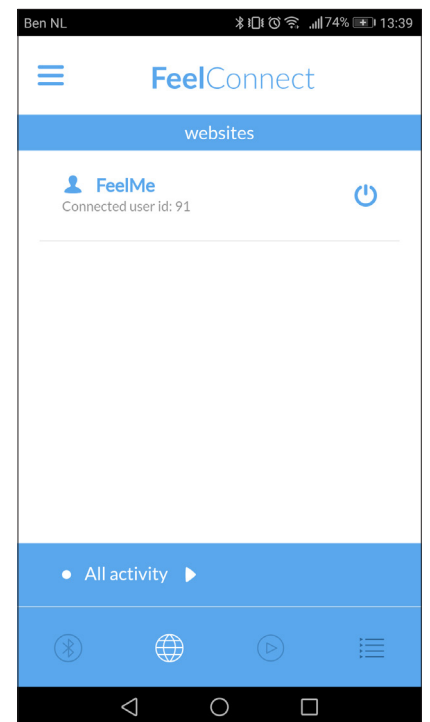

10. Congratulations! Your Toy will now respond to interactive content on FeelMe.com.

*This process only needs to be done once.
Enjoy your new interactive journey!*

2. Connect to Your Partner from a Distance.



1. Turn on your device. It is in bluetooth mode.

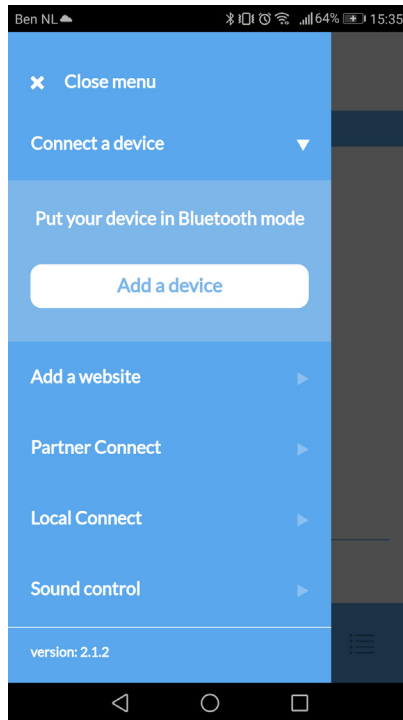

2. Open the menu bar in the FeelConnect app and tap 'connect a device'

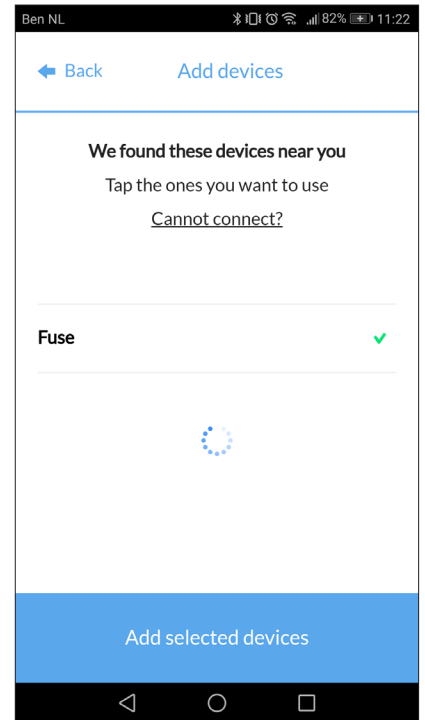

3. Click on the product you would like to connect. Then tap on 'add selected devices'.

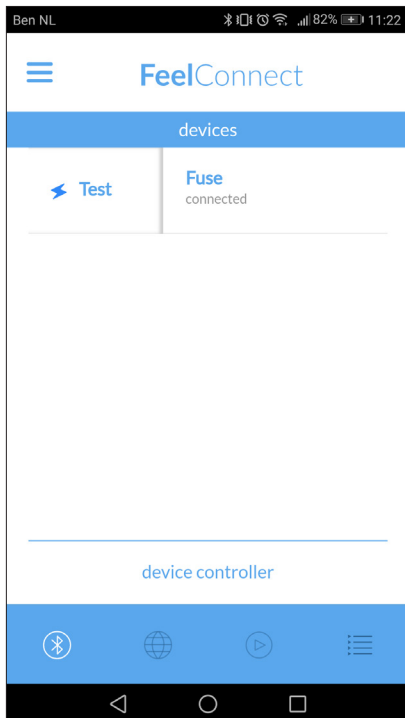

4. Slide the slider right, the 'test' option shows, click it to ensure your device is working properly.

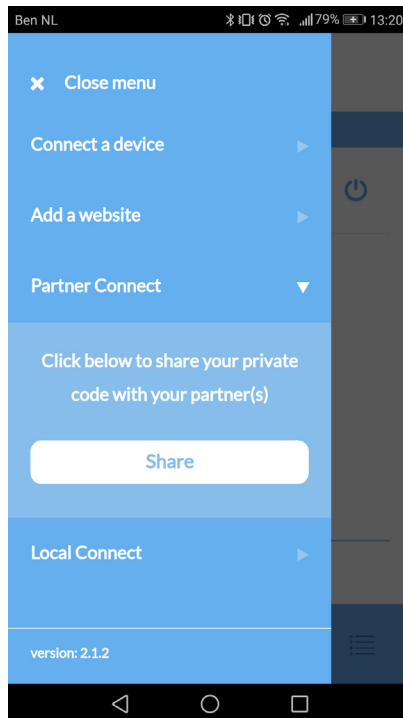

5. Now, to share your pleasure with your lover, open 'partner connect' in the menu bar, and tap 'Share'.

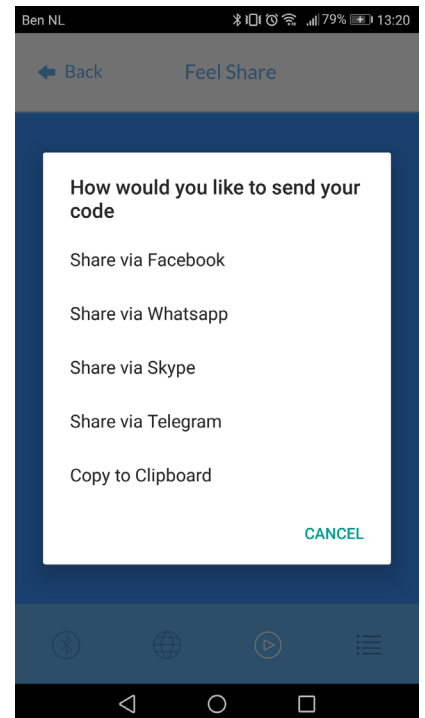

6. Choose your favorite platform to share your unique code with your partner(s).

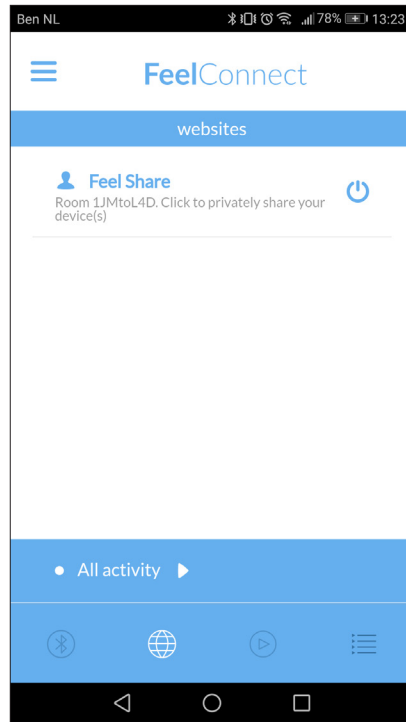

7. Once your partner accepts the invitation, you are connected and your toy will respond to your partner's toy, and vice versa.



*This process only needs to be done once.
Enjoy your new interactive journey!*

3. Connect 2 or more toys in the same proximity.



1. Turn on your devices. They are in Bluetooth mode.

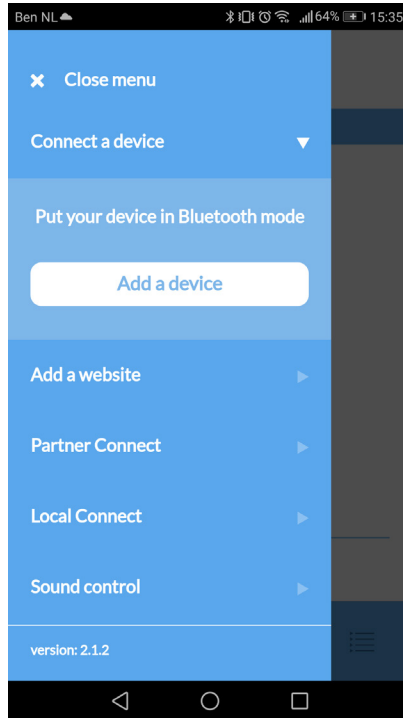

2. Open the menu bar in the FeelConnect app and tap 'connect a device'

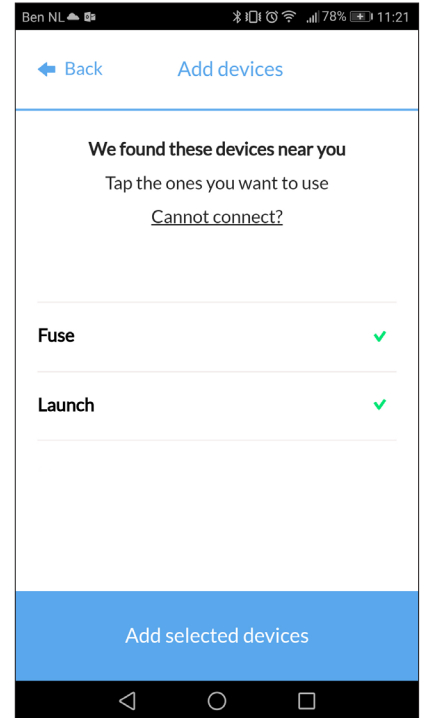

3. Click on the products you would like to connect. Then tap on 'add selected devices'.

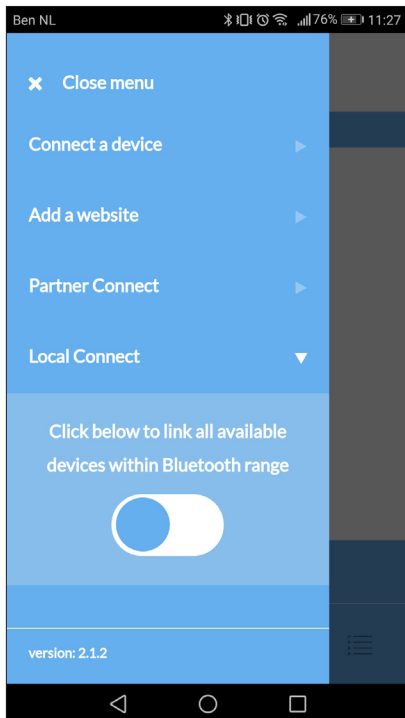

4. Open the menu bar and select 'local connect'.

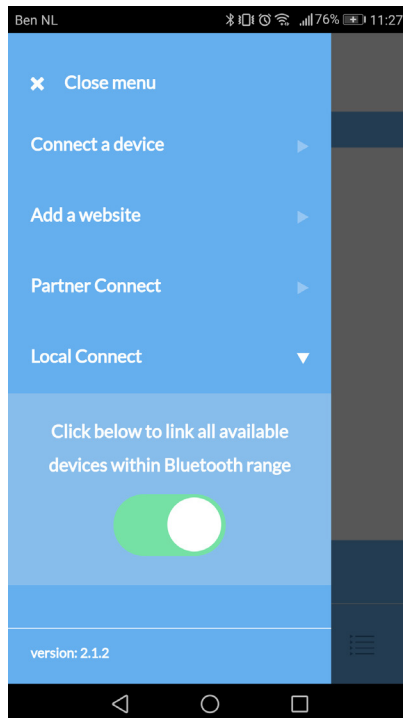

5. Slide the button, it will turn green.

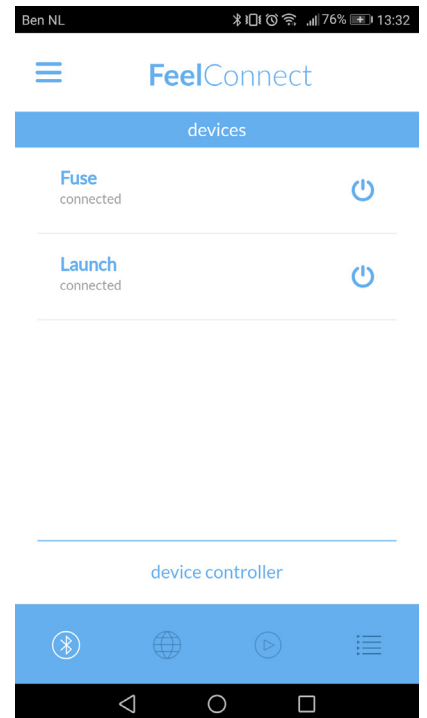

6. Now your toys are connected within the same room (proximity) and they will respond to each other.

4. Connect Your toy to interactive VR content.



1. Turn on your device. It is in Bluetooth mode.

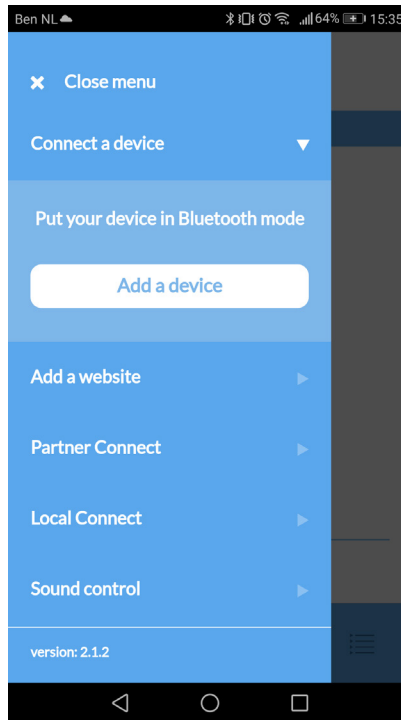

2. Open the menu bar in the FeelConnect app and tap 'connect a device'

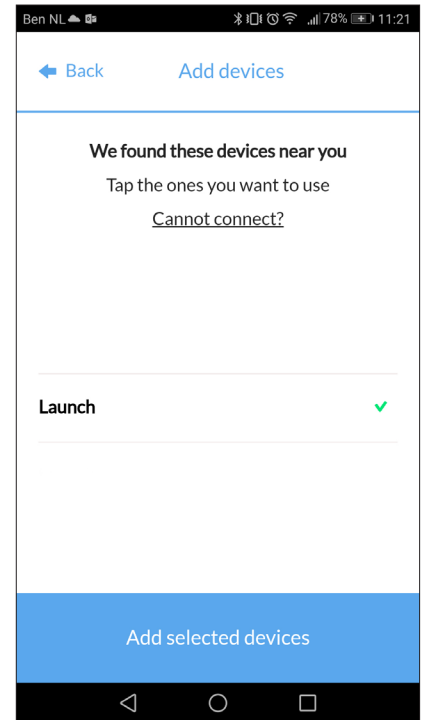

3. Click on the product you would like to connect. Then tap on 'add selected devices'.

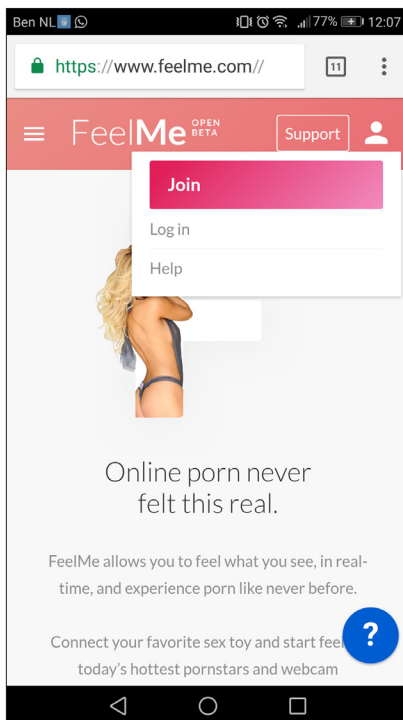

4. Go to www.feelme.com on your phone; either join if you are a brand new user or if you already have your account, please log in.

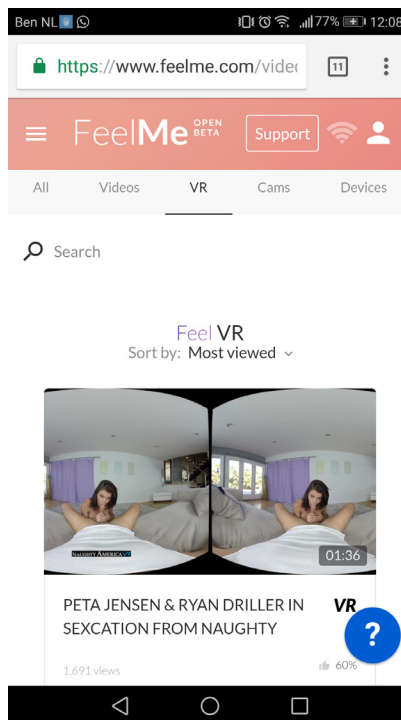

5. Once you have logged in, please select the VR video you would like to interact with.

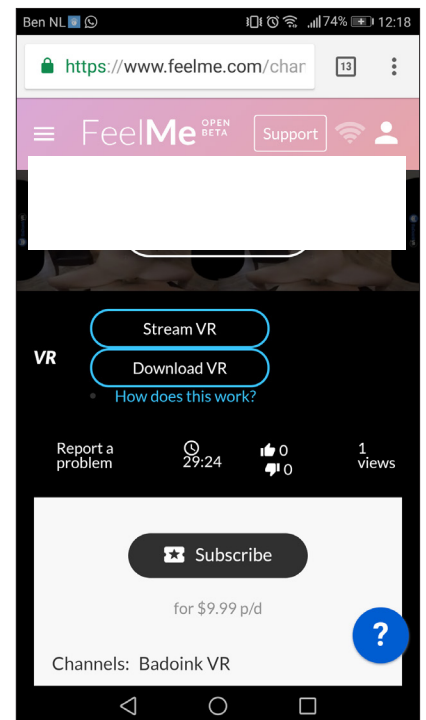

6. If the video is a paid subscription, please select the subscribe button, and it will redirect you to the payment process.

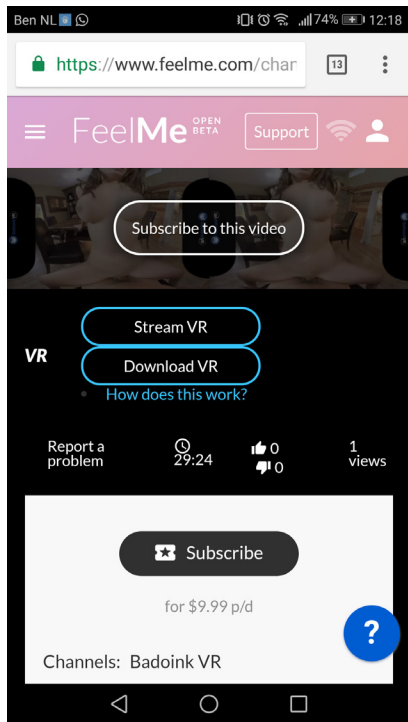

7. After you have subscribed to the video, please select either "StreamVR" or "DownloadVR"

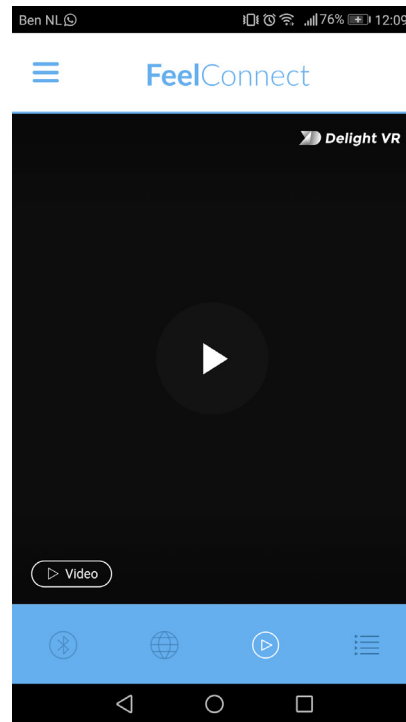

8. The video will open on the FeelConnect app.

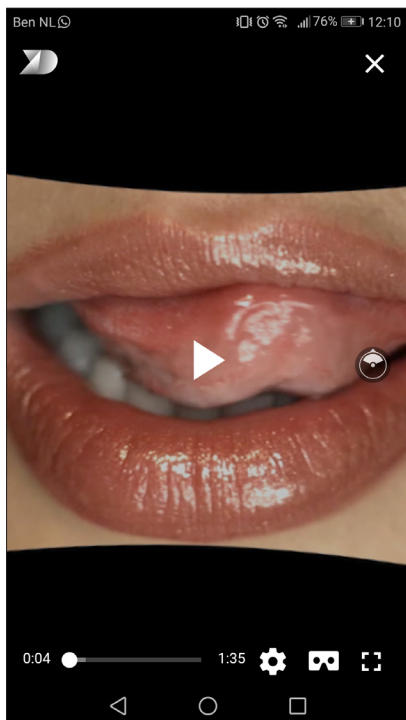

9. Once you have pushed play, there will be options at the bottom right hand corner to be able to watch it in VR cardboard mode. Please select it.

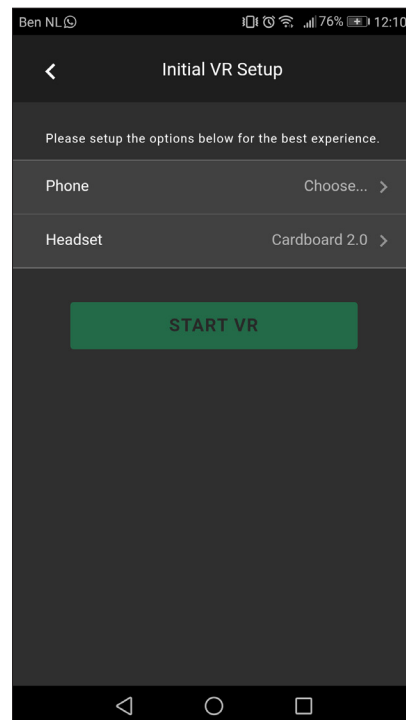

10. Select your phone model and push the "Start VR" button. After that, please put your phone in the VR cardboard.



Enjoy your new interactive journey!

