

INSTRUCTIONS

4FT LED W-CANNEL

ULMBH00006

LED W-CANNEL U FITTING, 4FT, 8500LM DIFFUSER V S (60W)



Read the instructions before commencing installation and retain for future reference.

INSTALLATION INSTRUCTIONS:

! Electrical products can cause death, injury, damage to property. Installation of this product must be carried out by a qualified electrician, in accordance with SANS 10142. On completion of installation, ensure that the Certificate of Compliance is updated.

⚡ CAUTION: Risk of electric shock.

NOTE: The light source contained on this luminaire shall only be replaced by the manufacturer or the service agent or a similar qualified person.

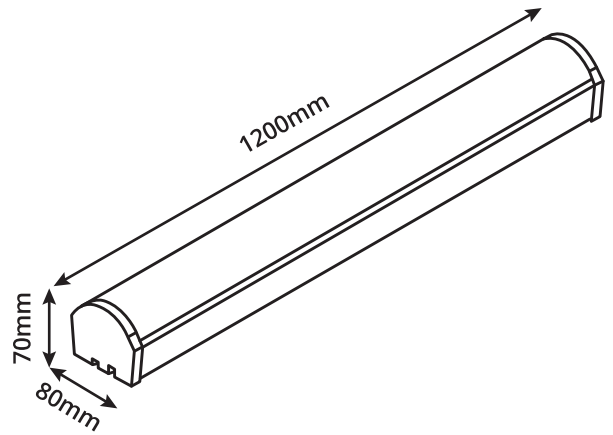

! IMPORTANT

WHEN INSTALLING MULTIPLE FITTINGS ON ONE LINE:

- Use 1.5mm diameter cable for up to 10 fittings on a 10 amp breaker.
- Use 2.5mm diameter cable for up to 15 fittings on a 15 amp breaker.

A. INSTALL A FITTING

Turn off Mains Power Supply

1. Open the diffuser cover
2. Connect to mains power
 - a. Brown (live) – to Brown or Red
 - b. Blue (neutral) – to Blue or Black
 - c. Green/Yellow (Earth) – to Green/Yellow or Copper
3. Fix the screws through the channel fitting to the installation surface. Ensure the installation surface is strong enough to carry at least 10kg.
WARNING: Ensure all items and screws are secure and fitted correctly.

B. CLOSE THE FITTING

4. Press the diffuser cover onto the fitting. Ensure all items and screws are secure and fitted correctly. Installation Complete

TURN ON MAINS SUPPLY and test fitting

C. CONNECT LIGHTS AS A LINEAR LIGHTING SYSTEM

5. Turn off Mains Power Supply
H Connectors are available to connect lights as a Linear Lighting System.
TURN ON MAINS SUPPLY and test fitting

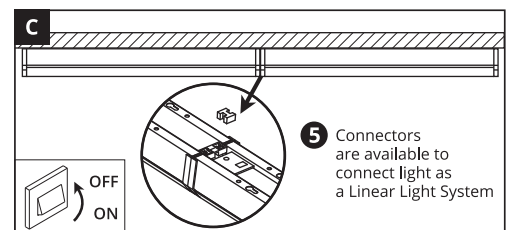
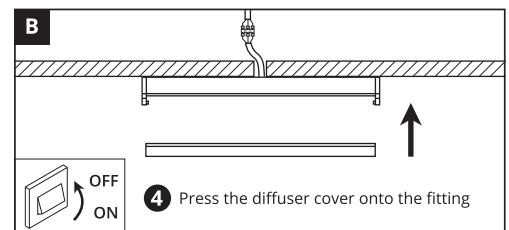
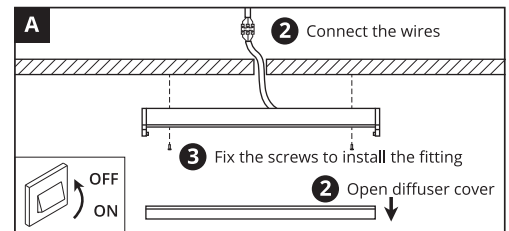

SPECIFICATIONS

Fitting:	Body made from Airon, Lens made from PC
Lamp Types:	60W, Integrated LEDs, 8900 lm 6500K, CRI>80,
Protection against electric shock:	CLASS I. Requires earth connection
Input Voltage:	AC 220V-240V 50/60Hz
Surge Protection:	No surge protection
Ingress Protection:	n/a
Ballast:	CE Standard Driver, Non-flicker
Quality/Corrosive rating:	Suitable for commercial use and indoor applications
Ambient Temperature Range:	-20°C~+40°
Weight	1.79kg
Power Factor:	> 0.9
Warranty:	Five Year