



User Instructions

Refer to

www.extremelights.co.za

for User Instructions
containing complete
features, specifications
and instructions

Extreme Lights

Shop 8A

The Woodmill

Vredenburg Rd

Stellenbosch

7600

South Africa

QUICK
START
GUIDE



+ 27 (0)21 886 5479



33.942725, 18.827600



info@extremelights.co.za



www.extremelights.co.za

CYCLE
LIGHTS

Charging

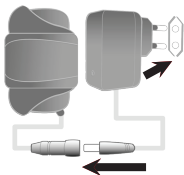

- Connect 8.4V battery and charger
 - Plug charger into wall socket
 - Switch wall socket ON
- LED on charger shows:
- Red** - Charging
 - Green** - Fully charged
- Charging time: 6 Hrs
-
- Always charge battery before storage
 - Never leave charging battery unattended

Mounting

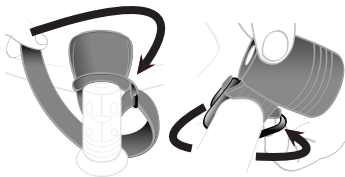

- Mount battery onto stem
 - Mount light
- O-Rings** - use small / large O-Ring, or
- Quick Release Bracket** - use thin / thick rubber shims
-
- Ensure battery & light are mounted securely before EVERY ride
 - Never blind oncoming traffic
 - Clean with damp cloth only
 - Never submerge or pressure spray clean
 - Always ensure proper air flow
- Light will dim when too hot

Modes

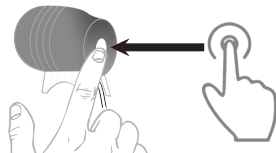

- Press & Hold For 3 Sec: **ON**
 - Press Once for:
-
- Double Click: **PULSE**
 - Press & Hold For 3 Sec: **OFF**