

1 TOP VIEW OF BENCH
Scale: 1/16" = 1"

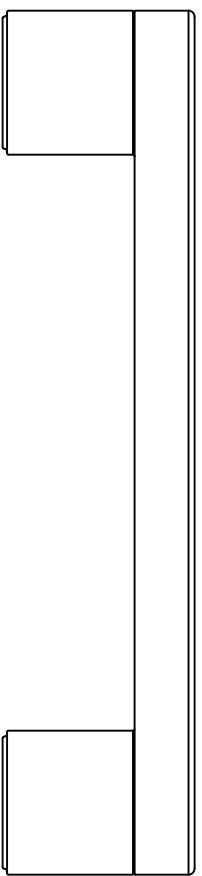

2 FRONT & BACK ELEVATION VIEW
Scale: 1/16" = 1"

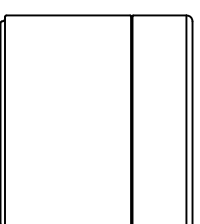

4 END VIEW OF BENCH
Scale: 1/16" = 1"

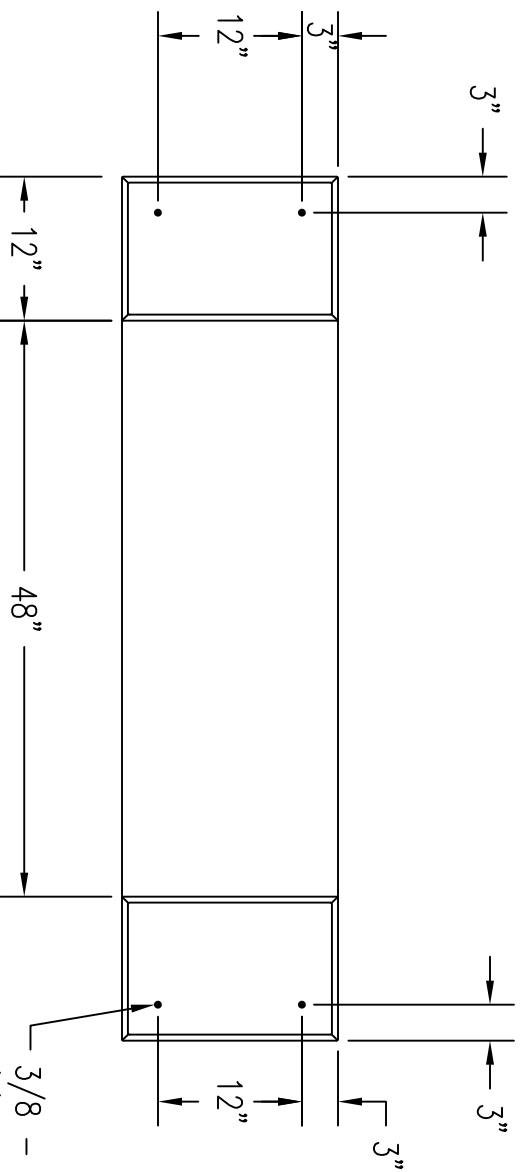

3 BOTTOM VIEW OF BENCH
Scale: 1/16" = 1"

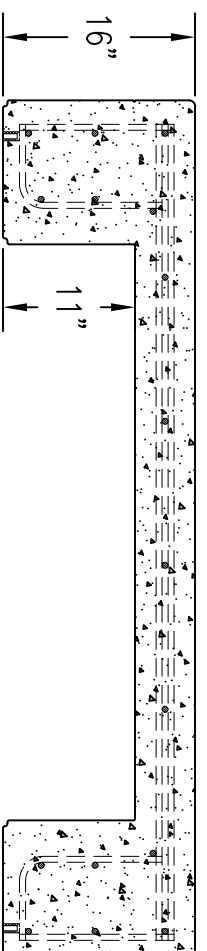

5 SECTION VIEW OF BENCH
Scale: 1/16" = 1"

3/8" - 16 S.S. INSERT
(4) REQ'D. TO BE WELDED
TO REBAR CAGE



MANUFACTURED BY:
CROWD CONTROL WAREHOUSE

REVISION		
DRAWN BY	DATE	NOTES
1	PAW	2/28/11 CHANGED REBAR LAYOUT. DOUBLE REBAR ON THE 2 LONG SIDES
2		
3		
4		
5		
6		
7		

CONFIDENTIAL INFORMATION
THESE DRAWING, SPECIFICATIONS AND OTHER INFORMATION AND DOCUMENTS ACCOMPANYING THEM ARE THE CONFIDENTIAL AND PROPRIETARY PROPERTY OF WAUSAU TILE, INC. THE DRAWINGS THEMSELVES SHALL BELONG TO THE OWNER FOR USE ONLY ON THE PROJECT. ANY ADDITIONAL USE SHALL REQUIRE THE PRIOR WRITTEN APPROVAL OF WAUSAU TILE, INC. THE PROPRIETARY INFORMATION CONTAINED WITHIN THE DRAWINGS AND THE DOCUMENTS IS AND SHALL REMAIN THE SOLE PROPERTY OF WAUSAU TILE, INC

JOB NAME

LOCATION

UNLESS OTHERWISE SPECIFIED
DIMENSIONS ARE IN INCHES
FRACTIONS ± 1/8"

DRAWN BY: TAS

DATE: 1/28/15

CO NUMBER:

WEIGHT: 920 LBS

SHEET NO.

TF5027