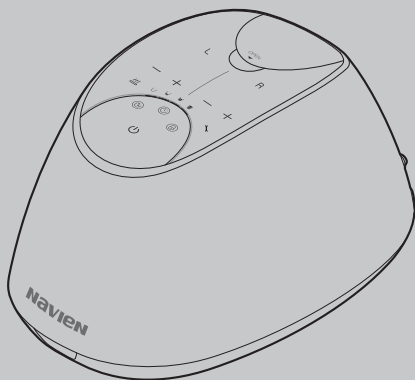

Comfort-Mate™

**MODEL**

EQM301-SSUS/QSUS/KSUS

- Please read the user manual carefully in order to use the product as intended.
- Store this manual in a place where it can easily be found.
- There may be a change in appearance or dimensions of the product without prior notice for improvement of product quality.
- Purchased product may not be exactly as shown in figures in the manual.

NAVIENTM Quick Start Guide



CHECK POINT

- ✓ Place the heating unit on a flat surface and avoid placing on fluffy or soft carpet.
- ✓ Use of clean water (purified water, mineral water) is recommended.
- ✓ Do NOT use distilled water or underground water.
- ✓ Tap water can be used but it may cause partial discoloration.

Product Components



Heating Unit

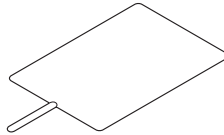

Pad

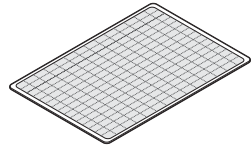

Pad Cover

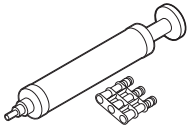

Water Removal Kit



Instruction Manual



Remote Control



Storage Bag

Name of Each Parts

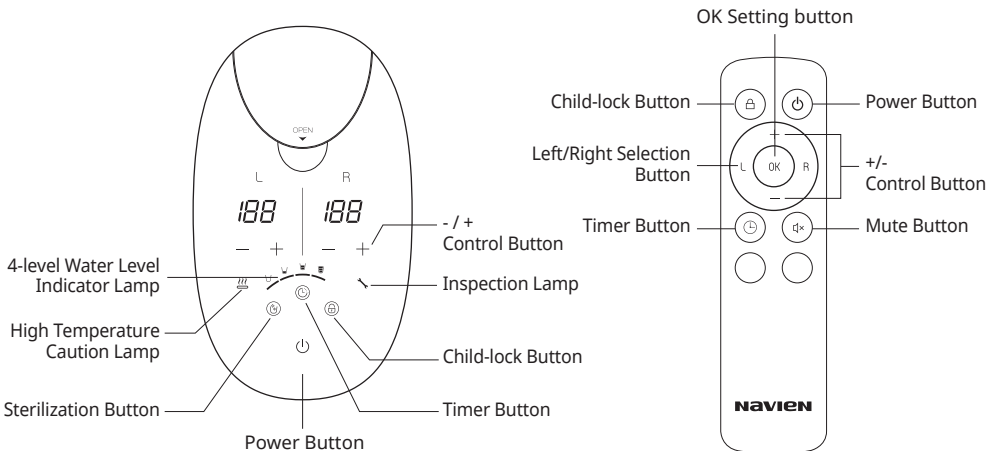

※ The single-type does not support dual temperature function.

01

Product Installation Guide

1. Install

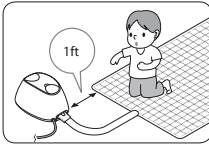

- ① Put the cover on the pad.
- ② Place the host of the pad toward the feet, and leave the space between the heating unit and the pad over 1 ft. (30cm)

2. Connect

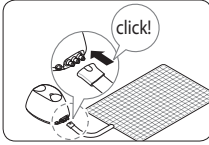

- ① Lay down the hose of the pad flat facing the "Navien Logo" upward without tangling.
- ② Push the pad hose connector to the back of the heating unit water outlet/inlet connector firmly all the way until you hear a "click" sound.
 - ※ To prevent a deviation risk of the connector, rubber ring is attached to the water outlet/inlet connector. Although you can feel a stiffness when approach to the connector for the first time, softer connection is available with the moisture.

3. Filling Water

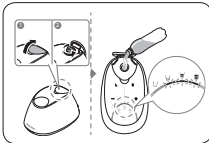

- ① Pull the water inlet cover and turn the water cap counter clockwise to open.
- ② Check the water level lamp and slowly pour down the water.
 - ※ The amount of water to be filled is 1,500ml for king size, 1,300ml for queen size, and 1,100ml for single size.
- ③ If the 4th-level water lamp is on, stop filling the water and wait for a little bit.
- ④ When the 1st water level lamp blinks again, fill the water until the 4th water level lamp is turned on.
- ⑤ Close the water cap by turning it clockwise until there is a "click" sound, and close the cover.

02

Setting Temperatures

1. Setting the left/right temperature

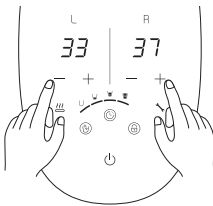

The left/right temperatures of the pad can be set at intervals of 1°F by touching the "- / +" buttons on the L/R display windows.

※ Heating temperature can be set from 82°F to 113°F.

2. Setting temperatures over 100°F

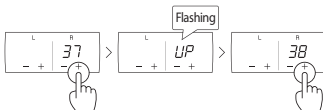

- ① When 'UP' is displayed on the screen and a notification sound is on after setting the temperature at 98.6°F (37°C), wait for about 2 seconds.
- ② Press the "+" button again after 2 seconds and temperature will be set over 100°F (38°C).

3. To turn off the heating on one side, touch the "-" button once more at 77°F.

03 Setting Timer

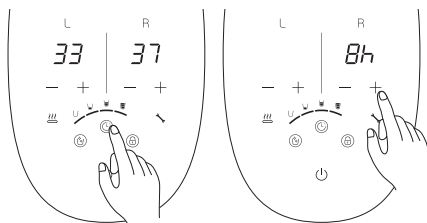

- ① Touch the [⌚] button and set the desired time by touching the “-/+” buttons on the “R” display window.
- ② The time is set after 3 seconds when the desired time is displayed, and the display window transitions to a temperature display.
- ③ The timer is deactivated if the timer button is touched again while the timer mode is activated.

04 Setting Sterilization Mode

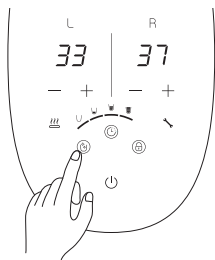

- ① Touch the [⌚] button for 2 seconds to initiate sterilization mode.
- ② When sterilization mode is activated, the remaining time is shown on display window showing minutes and seconds.
- ③ Sterilization mode lasts for 30 minutes.
- ④ Once the mode is complete, the heating unit automatically turns off.

05 Setting Child-lock Mode

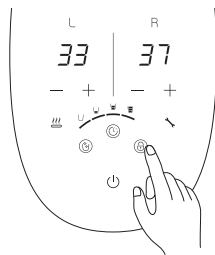

- ① Touch the [⏻] button for 2 seconds to activate the child-lock mode.
- ② When child-lock is activated, none of the buttons on the heating unit controller work.

NAVIEN CUSTOMER SUPPORT CENTER
(US / Canada)

877-689-1541

 **NAVIEN**