

# Smart Wi-Fi Weather Station

Quick Start Guide

1



IOS



Android

Download the WeatherSense APP.

2

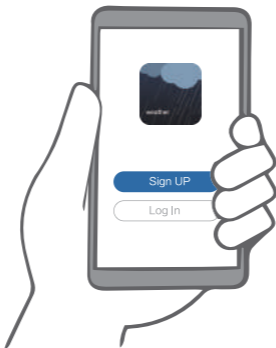

Register for an account.

3



Make sure you're connected to a **2.4GHz** WiFi network.

4

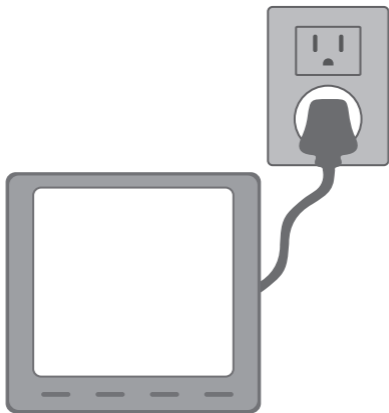

Plug in your device with AC/DC power.

5

WiFi button location may be difference for defferent products

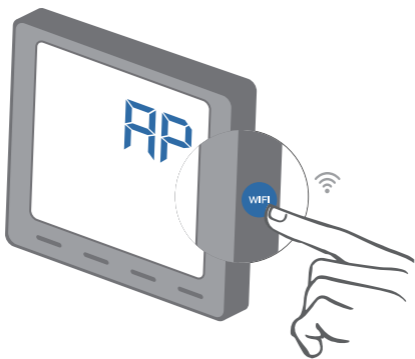

Press and hold WiFi button for 3 seconds until "AP" freshed on the display.

6



Follow the in-app instructions to pair the device.

## Troubleshooting Q&A

**Q: Why can't I connect my weather station to my WiFi network during set up?**

1. Make sure your phone is connected to a 2.4GHz WiFi network, WiFi weather station currently only support 2.4GHz WiFi network during configuration.
2. Try moving your WiFi router closer to your weather station (98ft / 30m visible range is best).
3. Make sure you have turned off MAC address filtering with your router.
4. Make sure you don't have more than 10 devices connected to your router.
5. Close and reopen the Weathersense app.
6. Clear your app cache



7. Hard reset your WiFi weather station, by take off battery and remove AC/DC power from weather station . wait for 1 minute and plug in back.
8. Make sure the WiFi password you're inputting is correct.

### **Q: How do I change my WiFi network to a 2.4GHz WiFi network?**

1. Make sure your router is dual band router (most dual band routers support both 5GHz and 2.4GHz networks).
2. Under your phone settings, set your WiFi network to 2.4GHz. Most 5GHz WiFi are suffixed by “\_5G”, so select the network that does not have “5G” in It's name.
3. Some routers hide the 2.4GHz WiFi network. If you have trouble finding or setting up your 2.4GHz network, please contact your router manufacturer for support.

**Q: After moving a Wifi weather station to another room or space. The weather station is appearing as offline .WiFi and signal symbol are Blinking on the weather station display. Why is this happening?**

1. Check to make sure the Wifi weather station isn't placed too far from your wireless network router. It must be within 98ft/30m visible range from router.
2. Check to make sure the wireless network has not changed and it is functioning normally.
3. If you place the weather station to a new place with a new wireless network Router, then re-configure the weather station with the new network.

**Q: Why can't I locate my town in the app during set up?**

1. Make sure your phone's Location

Services are turned on and allowed for this app.

2. Make sure that your current location city can be successfully located in the map. Some cities may fail to locate because there is no corresponding success in the app. You can manually move the location or be automatically positioned to a large administrative level city.

### **Q: Why the pairing process of the Android version always fails?**

1. Make sure "WLAN+" function is turned off; under your phone Settings--> Wireless & networks-->WLAN".
2. After weather station enters the AP mode, under your phone settings --> Connections(or Wireless & networks)--> WLAN, click the top right button into "AdvancedàManage Networks", find the "LivingSmart" hotspot and select "Forget this network";

3. Under your phone settings – Apps & notifications-->Permissions-->WeatherSense, Make sure your phone location service are turned on. go to “set individual permissions”, Make sure “access location info” and "Access list of installed apps" service are turned on.
4. Some mobile phone systems may require you to allow network connections to be turned on multiple times during device pairing.
5. Try re-pairing again , by restart your phone WLAN function, app and weather Station.

**Q: Why does the app notify "The device is already bound by another account"?**

1. The device has been reconfigured or test in factory.
2. Reconfigure the device with your home WiFi network.

## Need More Help?



Scan here to view the full digital manual for this WiFi weather station. Due to app updates and improvements, the contents of the manual are subject to change without prior notice.

## Watch The Setup Videos.



IOS



Android

Scan the QR code to get the device pairing videos.