

SELKIE

Ghost



To connect to a single device, follow steps 1–4.

To connect to multiple devices, see the back of this guide.

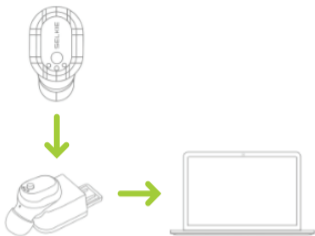

1

Charge.

Ghost charges while on the USB charger.

NOTE: Max 5V for charge



2

Connect Ghost.

Press button for 5 secs until light blinks blue repeatedly.

Then turn on Bluetooth settings and select Selkie – Ghost.

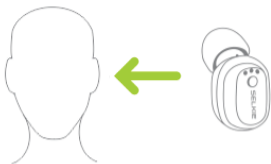

3

Start Listening.

Place in ear and adjust until comfortable. Ghost is now ready to play.

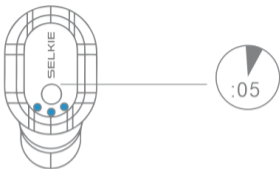

4

Power Off.

Press button for 5 secs until
light blinks blue once.



Connect to Two Devices.

Connect with first device by following step 2. Then connect to second device by repeating step 2.



Fully Charged
(No Light)



Not Fully Charged
(Blinking Blue)

Check Charge Status.

Light indicates charge status of Ghost when it is on the charger.

Ghost Button Functions

Play/Pause Music & Answer/End Call	Click Once
Redial Last Number	Double Click

Ghost Specifications

- 6 hrs continuous play
- 1 hr charge time (0 to 100%)
- 30 ft (10 m) Wireless Range
- Bluetooth v4.1
- 5V Input & Output
- 3.7 grams
- 1 year warranty

GET IN TOUCH

We're here. How can we help?
Contact us anytime via email
or live chat us from 10-6pm ET.



myselfkie.com/support



support@myselfkie.com



[@myselfkieofficial](https://www.facebook.com/myselfkieofficial)

www.myselfkie.com