

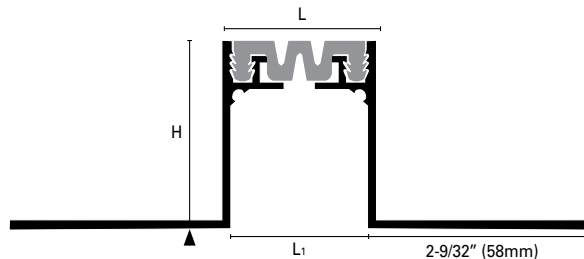

jointec™ GE

**JOINTEC GE** aluminum structural expansion joints are composed of twin metal profiles joined by a central synthetic rubber insert. Designed to bear loads of large scale buildings or building compounds, they can be installed in the interstitial space between two sections of a building or between two bays. This technical joint links these interspaces, moving vertically and horizontally to accommodate a building's structural and material settlement. The structural bays defined by this profile should be further subdivided with smaller scale movement / expansion joints, chosen according to the expected use and flooring type. For further information, see page 263.



(GE 500 AN\*)

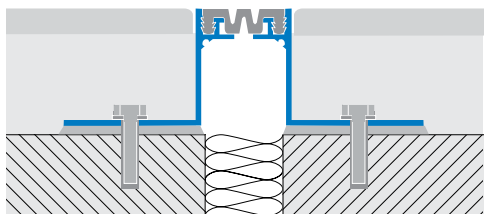

**JOINTEC GE-AN\* Natural Aluminum + Synthetic Rubber Insert**

Profile Width = 1-47/64" (44mm), bridges a 1-1/2" (38mm) gap  
 This extruded aluminum profile offers good resistance to chemical and mechanical stress and wear.  
 The 1-15/32" (37mm) - wide rubber insert guarantees high elasticity. Brass profiles are recommended for outdoor use.  
 Ribbed or smooth versions of the rubber insert are available upon request. See page 179.



**JOINTEC GEL-AN\* COFLEX CB-AN\* Natural Aluminum + Synthetic Rubber Insert**

Profile Width = 2-1/8" (54mm), bridges a 1-7/8" (48mm) gap.  
 This extruded aluminum profile offers good resistance to chemical and mechanical stress and wear. The 1-27/32" (47mm) - wide rubber insert guarantees high elasticity. Brass profiles are recommended for outdoor use.



	H = in mm		L = in mm		L1 = in mm		Art.		
Material: Aluminum extruded	3/4	20	1-47/64	44	1-1/2	38	GE	200	AN 51/23*
	2	50	1-47/64	44	1-1/2	38	GE	500	AN 51/23*
Finish: Natural (AN)									
Insert*: Resinprene Black (P51 - suggested), Cement Grey (P23)									
Length: 13' 1" (4.00meters)									

\*\*S" for the smooth insert version

Material: Aluminum extruded	3/4	20	2-1/8	54	1-7/8	48	GEL	200	AN 51/23
	2	50	2-1/8	54	1-7/8	48	GEL	500	AN 51/23
Finish: Natural (AN)									
Insert: Resinprene Black (P51 - suggested), Cement Grey (P23)									
Length: 13' 1" (4.00meters)									