

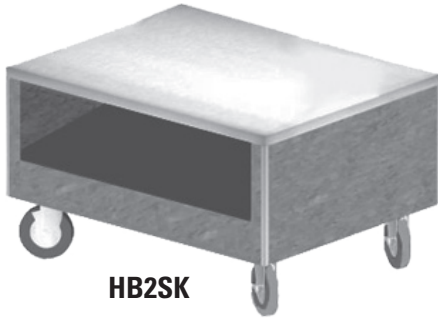

Your Solutions Partner

# Specifications

F.O.B Sedalia, Missouri 65301



HB2SK

## OPTIONS:

- Laminate finish other than standard eight (8) finishes
- Stainless steel pedestal electric outlet
- Kickplates - (stainless ), (painted), (laminate to match body)
- Legs in lieu of casters

## OVERHEAD CANOPY

- Housing of paint grip steel with powder coat painted cap must choose one of the following colros:
  - Black Matte
  - Copper
  - Brown
- Clear plexiglass canopy - flips up for ease of cleaning
- Fluorescent lights in canopy
- Paint grip steel columns - rigid, powder coat paint finish

## AGENCY LISTING:



**DUKE MANUFACTURING CO.**  
 2305 N. Broadway  
 St. Louis, MO 63102

800.735.3853 Toll Free  
 314.231.5074 Fax  
 www.dukemfg.com

**Approval Stamp(s):**

## PRODUCT INFORMATION:

PROJECT: \_\_\_\_\_

ITEM: \_\_\_\_\_

QUANTITY: \_\_\_\_\_

MODEL:

**Heritage® Buffet - Soup Kettle Stand**

- **HB2SK** 18-3/4"H x 24-1/2"W x 32" L

## TOP:

- Heavy gauge, 300 Series stainless steel
- Flanged down 2" on all four (4) sides
- 2-3/4" diameter cutout and grommet

## BODY:

- Heavy gauge paint grip steel
- Laminate patterns:
  - Stainless steel trim strips on corners
  - Flanged and channeled edges for strength
  - Welded together with reinforcements
  - Bowl storage opening on one side
  - 6' cord and plug
  - Electric duplex outlet in base, NEMA #5-15R
  - Bottom shelf powder coat painted black, brown or copper
  - Mounted on NSF listed 5" diameter swivel casters, two with locks, all non-marking polyurethane tires

# HERITAGE®

## HERITAGE® BUFFET - SOUP KETTLE STAND

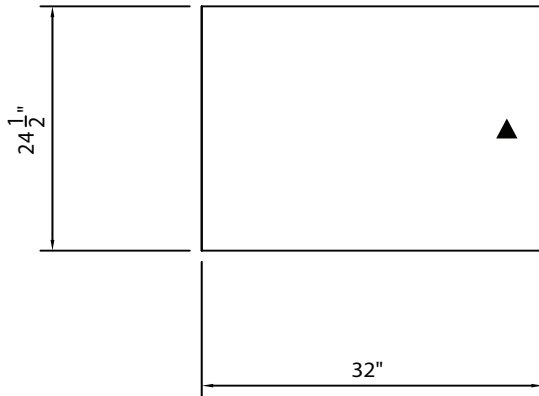

LEGEND
▲ - ELECTRICAL CONNECTION

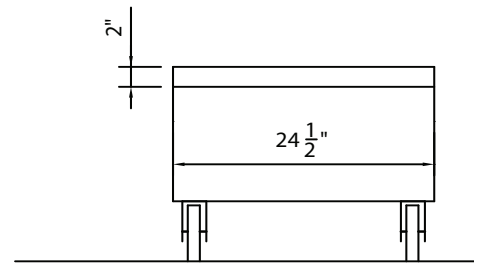
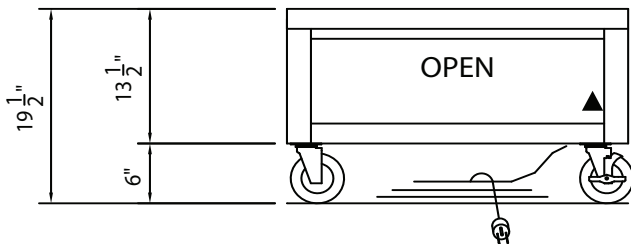

**DIMENSIONS:**

FREIGHT CLASS: 150

Model	Length		Width		Heights		Cube ft. Crated	Weight	
	in.	cm	in.	cm	in.	cm		lbs.	kg
HB2SK	32	81.3	24-1/2	62.2	18 3/4	49.5	16.6	135	61.4

Bowl Storage - in.		
Length	Width	Height
28	24-1/2	8-1/2

**ELECTRICAL SPECIFICATIONS** - with duplex outlet standard - 1 Phase

Model	120 Volt	
	amps	NEMA
HB2SK	15.0	5-15



**DUKE MANUFACTURING CO.**

2305 N. Broadway  
St. Louis, MO 63102

800.735.3853 Toll Free  
314.231.1130 In Missouri  
314.231.5074 Fax  
www.dukemfg.com

Specification subject to change

Printed in U.S.A  
© 2014, Duke Manufacturing Co.