



Your Solutions Partner

Specifications

F.O.B. Sedalia, Missouri 65301



WB303

OPTIONS:

- Cold pan style top
- Drop type brackets for cutting board
- Stainless steel feet
- Adapter plates
- Trayslides & Workshelves
- Foodshields

AGENCY LISTINGS:



UL/ANSI 4



DUKE MANUFACTURING CO.

2305 N. Broadway

St. Louis, MO 63102

800.735.3853 Toll Free

314.231.5074 Fax

www.dukemfg.com

SS-1096 Aerohot Wet Bath - Gas

Approval Stamp(s):

PRODUCT INFORMATION:

PROJECT: _____

ITEM: _____

QUANTITY: _____

MODEL:

Aerohot™ Foodservice

Hot Food Units - Gas Wet

- WB302 2 top openings
- WB303 3 top openings
- WB304 4 top openings
- WB305 5 top openings

Type of gas:

- Natural High altitude orifice available
- Propane specify elevation:

TOP:

- 20 gauge, stainless steel
- Die-stamped openings - 12" x 20"
- Poly carving board - 7"W x 1/2" thick with 18 gauge stainless steel support shelf and die-stamped brackets

LINER:

- 18 gauge, stainless steel - 8" deep
- 1" cast brass drain and valve in wet bath

BODY AND INTERIOR SHELF:

- 20 gauge, 430 Series stainless steel body
- 20 gauge, 430 Series stainless steel undershelf
- 430 Series stainless steel tubular legs with adjustable plastic feet

CONTROLS:

- Natural or Propane, as specified
- Gas safety pilots standard
- Gas pressure regulator furnished in each unit
- Burners controlled by adjustable valve

NOTE: Not available with casters

Specification subject to change



Aerohot® Food warmer - Gas - Wet

A.I.A. File No. 35-C-13

Catalog No. AFS-GASWET

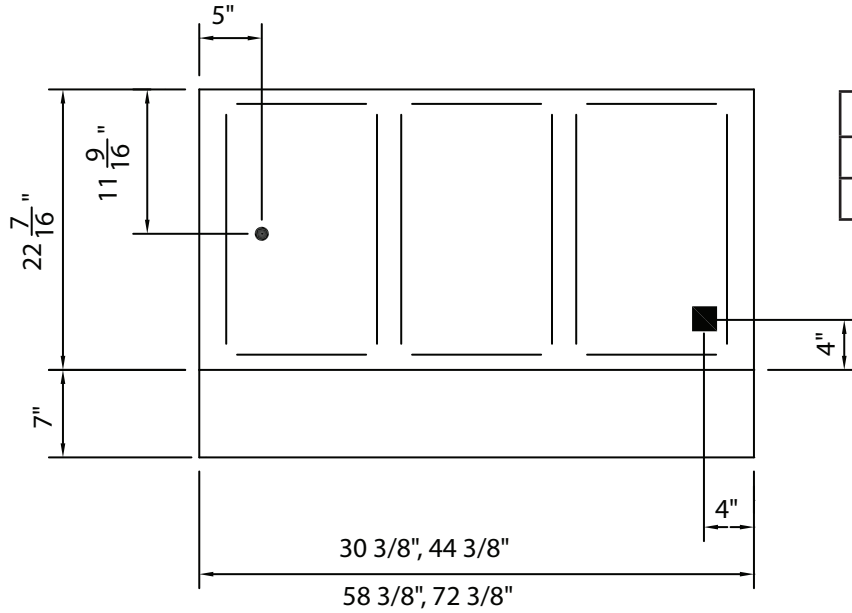

LEGEND	
	GAS CONNECTION - 1/2" Connection
●	DRAIN CONNECTION - 1" CAST BRASS

TOP VIEW

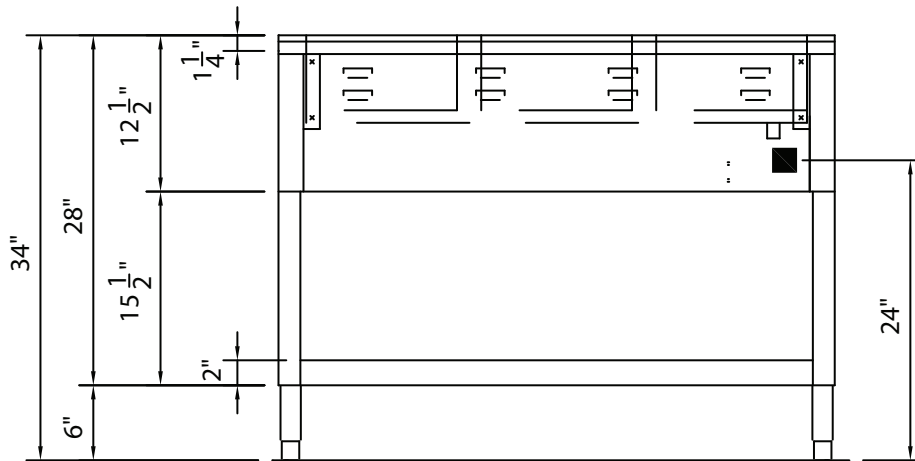

FRONT VIEW

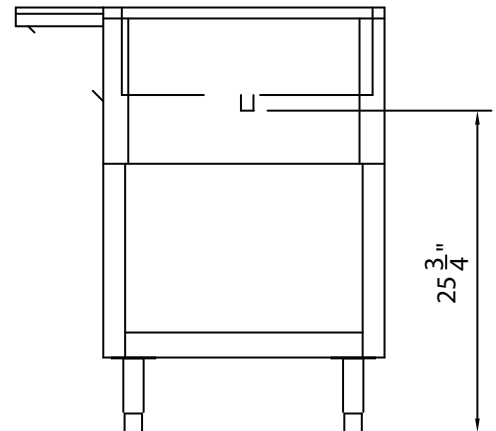

RIGHT SIDE VIEW

DIMENSIONS:

Freight Class: 85

Model	Total BTU	Length		Width		Height		Top Openings	Cube ft. Crated	Weight	
		in	cm	in	cm	in	cm			lbs	kg
WB302	15,000	30-3/8	77.2	22-7/16	57.1	34	86.4	2	27.0	110	49.9
WB303	15,000	44-3/8	112.8	22-7/16	57.1	34	86.4	3	38.1	135	61.2
WB304	27,500	58-3/8	148.3	22-7/16	57.1	34	86.4	4	49.2	160	72.6
WB305	27,500	72-3/8	183.9	22-7/16	57.1	34	86.4	5	60.2	195	88.4

AEROHOT™ FOODSERVICE - HOT FOOD UNITS - GAS



Duke Manufacturing Co.
2305 N. Broadway
St. Louis, MO 63102

Phone: 314-231-1130
Toll Free: 1-800-735-3853
Fax: 314-231-5074

www.dukemfg.com

Printed in U.S.A
© 2019, Duke Manufacturing Co.