



Your Solutions Partner

Specifications

F.O.B. Sedalia, Missouri 65301



G-6-CBPG

Shown w/optional maple cutting board

OPTIONS:

- 14 gauge tops
- Thermostat. Robertshaw
- Adaptor plates
- Spillage Pans
- Veneered panels
- Powder coat paint colors
- 7" stainless steel or maple carving boards
- 10" stainless steel or maple carving boards
- 1/2" poly cutting surface added to stainless steel carving board
- Foodshields
- Trayslides and Carving Boards

AGENCY LISTINGS:



DUKE MANUFACTURING CO.

2305 N. Broadway
 St. Louis, MO 63102
 800.735.3853 Toll Free
 314.231.5074 Fax
 www.dukemfg.com

SS-1108 Steamtable Gas - Stand

Approval Stamp(s):

PRODUCT INFORMATION:

PROJECT: _____

ITEM: _____

QUANTITY: _____

MODEL:

Thurmaduke® Steamtables

Hot Food Units - Gas - Standard

- G-2-CBPG/G-2-CBSS 2 top openings
- G-3-CBPG/G-3-CBSS 3 top openings
- G-4-CBPG/G-4-CBSS 4 top openings
- G-5-CBPG/G-5-CBSS 5 top openings
- G-6-CBPG/G-6-CBSS 6 top openings

TOP:

- One piece, 16 gauge, 300 Series stainless steel
- Top openings die - stamped. 12" x 20"

HEAT COMPARTMENTS:

- Individual burners
- Individual adjustable gas valves
- Individual galvanized steel radiation plates
- Safety pilots
- Gas pressure regulator for unit
- 3500 BTU/hour per burner
- 12" x 20" stainless steel liner, 8" deep

BODY AND INTERIOR SHELF:

- 300 Series stainless steel
- or
- paint grip steel
- End panels
- 6" polished stainless steel adjustable legs
- Stainless steel vented control panel
- Wire knob guards

Specification subject to change



REV B 10/14/2019

THURMADUKE® STEAMTABLES - HOT FOOD - GAS - STANDARD

Catalog No. TST-STGASHOT

A.I.A. File No. 35-C-13

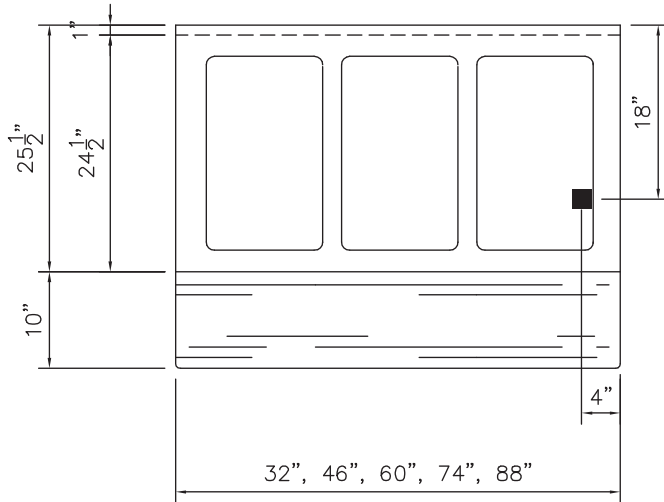

TOP VIEW

POWER SUPPLY		
Model	# of Burners	Total BTU
G-2-CBPG/SS	2	5,000
G-3-CBPG/SS	3	7,500
G-4-CBPG/SS	4	10,000
G-5-CBPG/SS	5	12,500
G-6-CBPG/SS	6	15,000
GAS CONNECTION - 1/2" I.P.S		

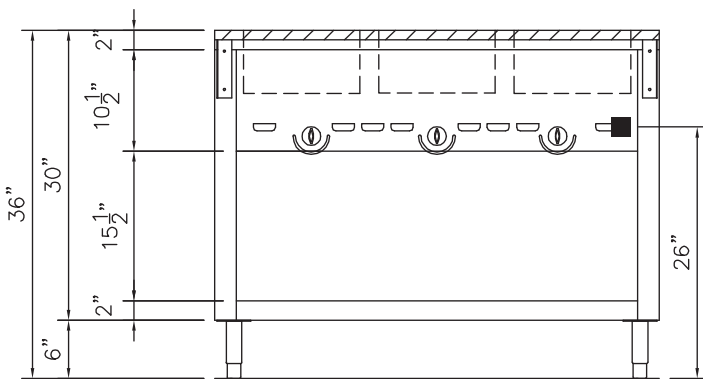

FRONT VIEW

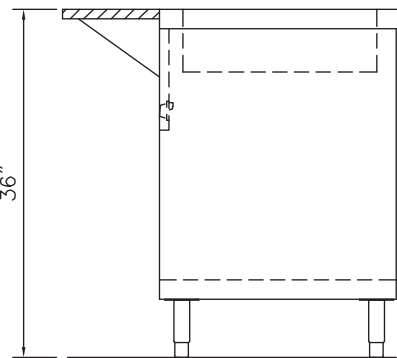

RIGHT SIDE VIEW

DIMENSIONS:

FREIGHT CLASS: 150

Model		Length		Width		Height		Top Openings	Cube ft. Crated	Weight	
Enameled	Stainless	in	cm	in	cm	in	cm			lbs	kg
G-2-CBPG	G-2-CBSS	32	81.3	25-1/2	64.8	36	91.4	2	27.0	210	95.5
G-3-CBPG	G-3-CBSS	46	116.8	25-1/2	64.8	36	91.4	3	38.1	264	120.0
G-4-CBPG	G-4-CBSS	60	152.4	25-1/2	64.8	36	91.4	4	49.2	344	156.4
G-5-CBPG	G-5-CBSS	74	188.0	25-1/2	64.8	36	91.4	5	60.2	433.5	196.8
G-6-CBPG	G-6-CBSS	88	223.5	25-1/2	64.8	36	91.4	6	71.3	527	239.5

NOTE: Specify natural gas or propane gas when ordering.

For high altitude orifice, specify elevation.
Sliding doors NOT available, casters not available

NO combustible materials should be stored on the bottom shelf of gas unit



Duke Manufacturing Co.
2305 N. Broadway
St. Louis, MO 63102

Phone: 314-231-1130
Toll Free: 1-800-735-3853
Fax: 314-231-5074

www.dukemfg.com