



Your Solutions Partner

Specifications

F.O.B Sedalia, Missouri 65301



ADI-2ESL

OPTIONS:

- 3 phase wiring (except **ADI-1E**)
- 1,000 watt element
- Designer Foodshields
- Stainless spillage pans
- Telescope covers
- Adapter Plates
- Adapter Bars

Approval Stamp(s):

PRODUCT INFORMATION:

PROJECT: _____

ITEM: _____

QUANTITY: _____

MODEL:

Drop-Ins- Slimline

Hot Food - Electric - Exposed Element Wells

- ADI-1ESL** 24 1/4"L x 17 1/4"W x 12 3/4"H
- ADI-2ESL** 46 1/4"L x 17 1/4"W x 12 3/4"H
- ADI-3ESL** 68 1/4"L x 17-1/4"W x 12 3/4"H

TOP RIM:

- Heavy gauge, 300 Series stainless steel
- Overhang on front, back and ends w/locking tabs
- Vinyl foam gasket as sealant
- Die-stamped openings - 12-1/16" x 20-1/16"

HEAT COMPARTMENTS:

- Exposed element in each compartment
- Voltage/Phase/Watt
 - 120 Volt/1 Ph/500 watt element
 - 208 Volt/1 Ph/750 watt element
 - 240 Volt/1 Ph/750 watt element
- 8" deep stainless steel liner, dry operation
- Insulated bottom
- Includes #576 aluminum spillage pans for use with water

CONTROL PANEL:

- Stainless steel face plate, plastic knobs
- UL approved
- Infinite switch controls in remote box

EXTERIOR HOUSING

- Heavy gauge paint grip steel

AGENCY LISTING:



DUKE MANUFACTURING CO.
 2305 N. Broadway
 St. Louis, MO 63102

800.735.3853 Toll Free
314.231.5074 Fax
www.dukemfg.com

SHORT FORM SPECIFICATIONS:

Duke Drop-In - Slimline - Hot Food - Electric. Top flange of heavy gauge 300 series s/s with overhang on 4 sides, 12-1/16" x 20-1/16" die-stamped hot food openings, 8" deep liner, fully insulated, with remote control panel, s/s top and interior liner, heavy gauge paint grip steel exterior housing, exposed elements, infinite switch controls, includes 576 spillage pans

DROP-IN - SLIMLINE - HOT FOOD - ELECTRIC

Catalog No. ADI-ELECHF

A.I.A. File No. 35-C-13

Duke®

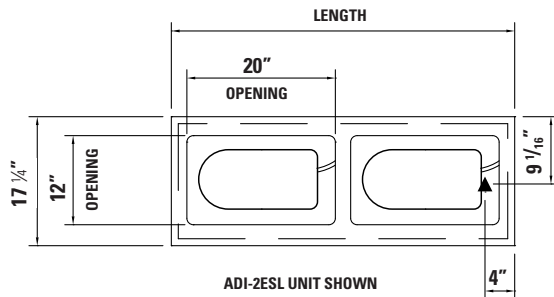

TOP VIEW

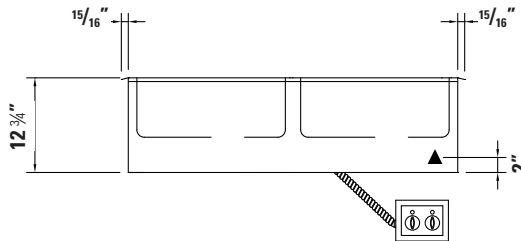

FRONT VIEW

DROP-INS - SLIMLINE HOT FOOD - ELECTRIC

- **ADI-1ESL** 24 1/4" L x 17 1/4" W x 12 3/4" H
- **ADI-2ESL** 46 1/4" L x 17 1/4" W x 12 3/4" H
- **ADI-3ESL** 68 1/4" L x 17 1/4" W x 12 3/4" H

LEGEND	
▲	- ELECTRICAL CONNECTION
Allow 4" gap between controls and unit	

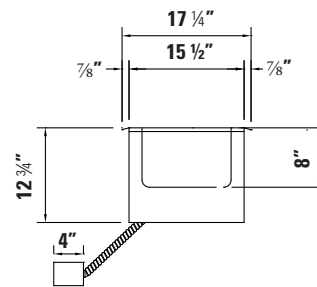

RIGHT SIDE VIEW

DIMENSIONS

FREIGHT CLASS: 100

Model	Length		Width		Height		Top Openings	Cutout Length		Cutout Width		Control Panels	Cube Crated ft.	Weight	
	in.	cm	in	cm	in	cm		in	cm	in	cm			lbs	kg
ADI-1ESL	24 1/4	61.6	17 1/4	43.8	12-3/4	32.4	1	23	58.4	16	40.6	1	7.7	80	36.4
ADI-2ESL	46 1/4	117.5	17 1/4	43.8	12-3/4	32.4	2	45	114.3	16	40.6	1	13.3	135	61.4
ADI-3ESL	68 1/4	173.1	17 1/4	43.8	12-3/4	32.4	3	67	170.2	16	40.6	1	19.0	185	84.1

REMOTE CONTROL CUTOUT IS 9" X 4-3/8"

ELECTRICAL SPECIFICATIONS: (Consult factory for 3-phase electrical requirements and other options)

Model	120 Volt/500 Watt		208 Volt/750 Watt		240 Volt/750 Watt	
	watts	amps	watts	amps	watts	amps
ADI-1ESL	500	4.2	750	3.6	750	3.1
ADI-2ESL	1000	8.3	1500	7.2	1500	6.3
ADI-3ESL	1500	12.5	2250	10.8	2250	9.4

DUKE MANUFACTURING CO.

2305 N. Broadway
St. Louis, MO 63102

800.735.3853 Toll Free
314.231.1130 In Missouri
314.231.5074 Fax
www.dukemfg.com



Specification subject to change

05/11
Printed in U.S.A.
© 2011, Duke Manufacturing Co.