



a Standex company

ITEM: \_\_\_\_\_ PROJECT NAME: \_\_\_\_\_ DATE: \_\_\_\_\_

## WALL DISPLAY NON-REFRIGERATED SELF-SERVE FULL PAN BAKERY CASE

MODEL  WDC4276SS



*Fresh solutions to your bakery merchandising needs.*

### STANDARD FEATURES

- Tempered self-closing full-view front service doors.
- Glass ends.
- All-metal base and frame construction.
- Painted finish. Standard colors are white and black. Special colors optional.
- Top mounted shielded light. Shelf lights optional.
- Four adjustable white epoxy-coated wire shelves.
- White interior back panel.
- Base storage area with doors.
- Bag bin with two dividers.
- Two tissue holders.
- Cord and plug. (NEMA 5-15P)

# WALL DISPLAY NON-REFRIGERATED SELF-SERVE FULL PAN BAKERY CASE

## OPTIONAL ACCESSORIES:

- Special Painted Finish
- Mirrored Ends
- Light Below Shelves

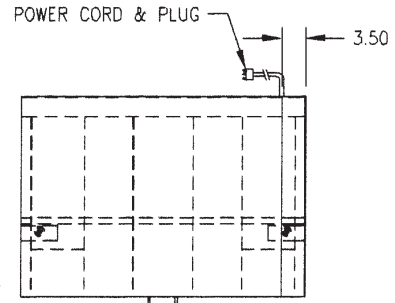

PLAN VIEW

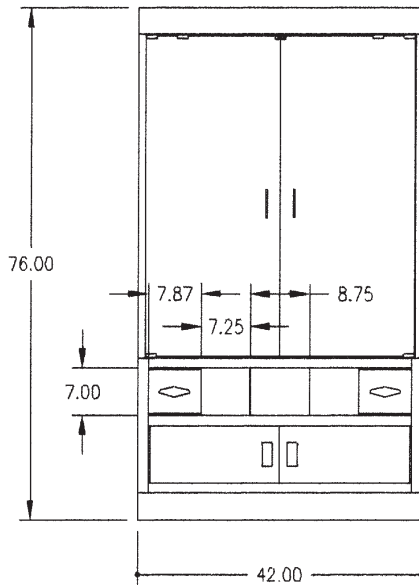

FRONT VIEW

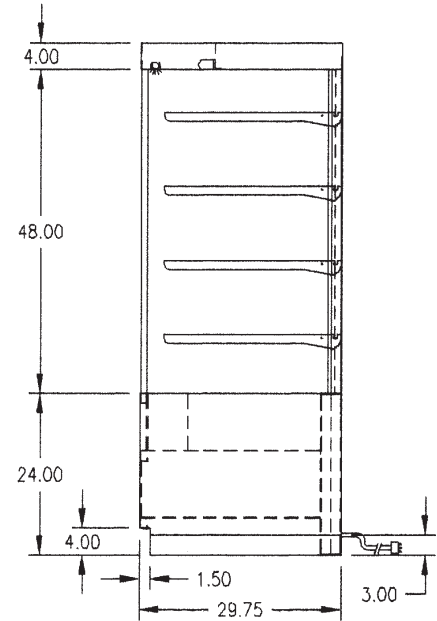

SIDE VIEW

## SPECIFICATIONS:

Model	Dimensions			Shipping Weight (lbs)	Capacity (Bakery Pans)
	L	W	H		
WDC4276SS	42"	29.75"	76"	660	10 (18" x 26")

- If a GFCI circuit is required, a GFCI Breaker Must be used instead of GFCI receptacle.
- Electrical requirement for optional lights - 120/60/1 - 2 AMPS.
- Due to continuing engineering improvements, specifications are subject to change without notice.



Look to Federal for Innovative Merchandising



*The Signature of Quality*

**FEDERAL INDUSTRIES**  
A Standex Company

215 FEDERAL AVENUE, BELLEVILLE, WISCONSIN 53508-9201

PHONE: 800-356-4206

EMAIL: [geninfo@federalind.com](mailto:geninfo@federalind.com)

FAX: 608-424-3234

WEBSITE: [www.federalind.com](http://www.federalind.com)

