

**bioBidet®**  
by **BEMIS**



**HD-4000**  
**User Manual**

# TABLE OF CONTENTS

## **PRODUCT INFORMATION**

Features.....	5
Parts.....	6
Dimensions.....	7

## **PRODUCT INSTALLATION**

Pre-Installation.....	8
Installation.....	9

## **PRODUCT OPERATION**

How To Use.....	13
-----------------	----

## **MAINTENANCE**

Cleaning.....	14
Short Term Non-Use.....	14
Warranty.....	15

# FEATURES

- Tilted control panel
- High-quality ABS material
- Premium quality metal inlet and installation parts
- Dual nozzle
- Ambient temperature bidet wash
- Adjustable water pressure
- Unified internal brass valve
- Durable braided metal cold water hose
- No electricity or batteries required
- Adjustable toilet fit
- One-year warranty

# PARTS

Bidet attachment

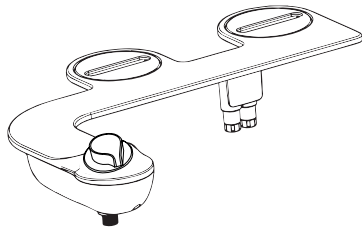

2 Adjustable mounting brackets

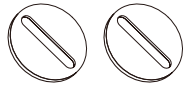

\*T-Valve connector with rubber cone washer (7/8" x 7/8" x 3/8")

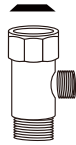

27.5" Braided metal hose



2 Non-slip mats



Teflon tape

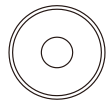

3 Toilet bumpers



# DIMENSIONS

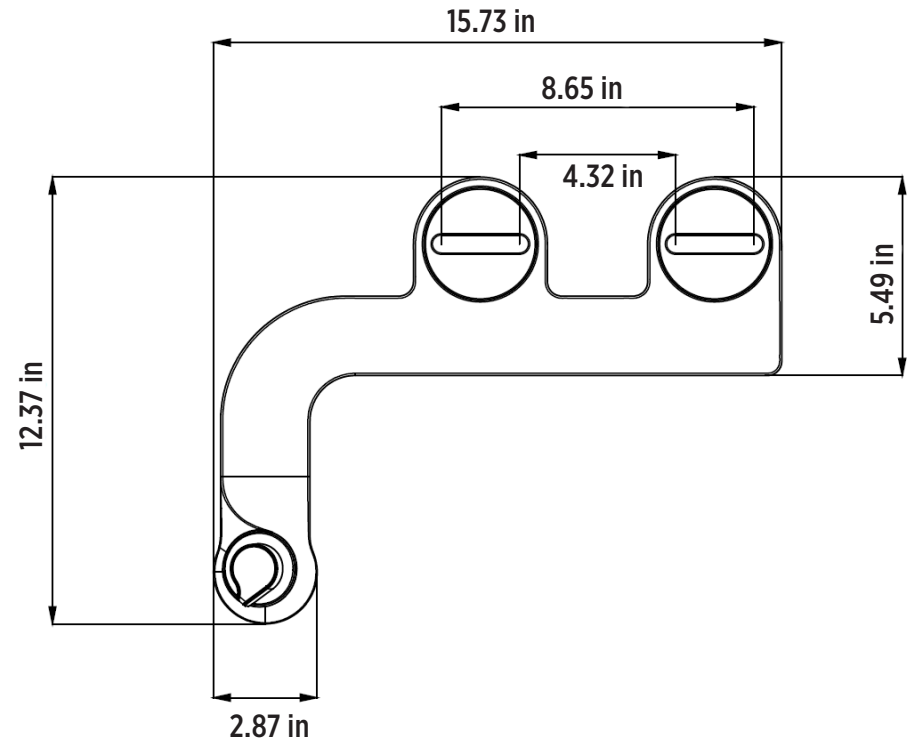
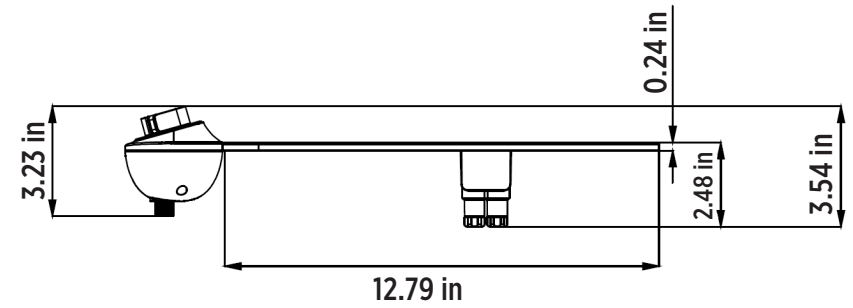

\*Alternate fittings available, contact [support@biobidet.com](mailto:support@biobidet.com)

## PRE-INSTALLATION

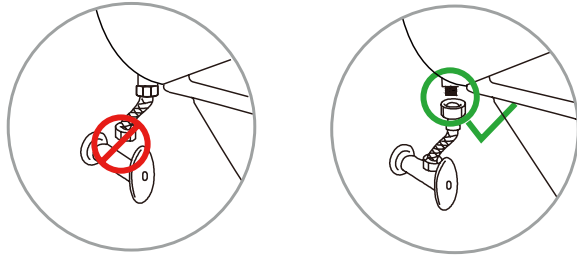

Please be advised that the provided T-Valve should be installed at the fill valve under the toilet tank, NOT down at the water supply coming from the wall.

Inspect your current water supply line that connects to the toilet tank fill valve to ensure it is a flexible water supply hose before installing the HD-4000. The hose needs to be 7/8" (to connect to the T-Valve we provided) on one end and either 3/8" or 1/2", depending on your wall valve, on the other end.

If you do not have access to the fill valve under the toilet tank, contact Bio Bidet Customer Service at 847.458.2334 and we may be able to provide alternative fittings.

**WARNING:** Use care to avoid cross threading or over tightening the connection. Over tightening can cause leaking.

**NOTICE:** Observe all local plumbing, electrical and building codes. This device is designed for connection to a cold water source with a pressure of 20-80 psi.

## INSTALLATION



1. Remove the existing toilet seat by locating the bolts and nuts, typically under a plastic cover, and removing them first.

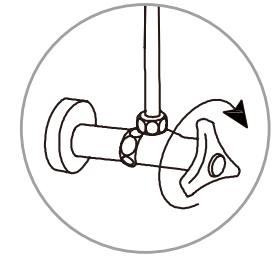

2. Close the water supply valve and flush the toilet completely so that there is little to no water left in the toilet tank.

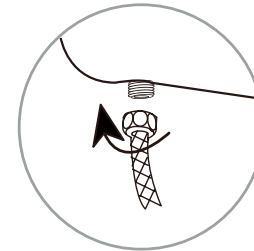

3. Disconnect the water hose from underneath the toilet tank.

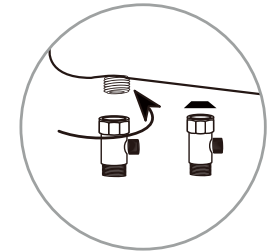

4. Connect the 7/8" T-Valve to the toilet fill valve where you just removed the water hose from.

Make sure the rubber washer is properly seated with the narrow side up.

## INSTALLATION (CONT.)

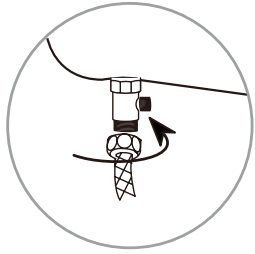

5. Attach the water supply hose that comes from the water shut off to the bottom of the T-Valve.

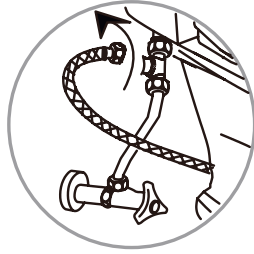

6. Connect the metal hose we supplied to the open side of the T-Valve.

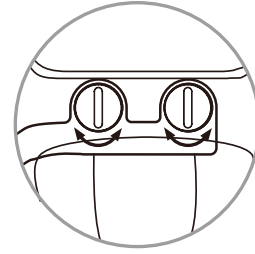

9. Place the bidet on the toilet with the mounting brackets over the bolt holes and make any needed adjustments to make sure the bidet is centered on the toilet.



10. Place the toilet seat back on the toilet over the bidet and secure the bolts down so that the seat and bidet attachment are stable.

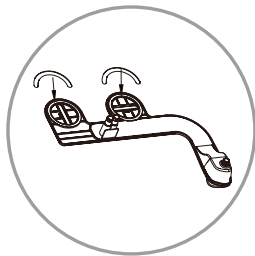

7. Insert the rubber non-slip mats to the bottom of the bidet. Place the toilet seat back on the toilet over the bidet and secure



8. Place the circular mounting brackets into the bidet attachment.



11. Connect the hose from step 6 to the bidet water connection underneath the handle of the HD-4000.

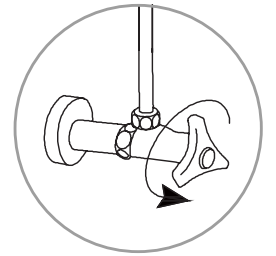

12. Slowly turn the water supply valve back on, check for leaks, and test the unit for functionality.

## INSTALLATION (CONT.)



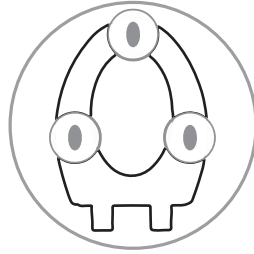

13. After installing your bidet attachment, check to see if there is a gap between the toilet base and toilet seat.



14. If necessary, place the bumpers on the underside of your toilet seat as indicated above.

## HOW TO USE

For back wash, turn the control dial to the left towards the “” position.

For front/feminine, turn the control dial to the right towards the “” position.

The further the knob is turned, the higher the water pressure will be. Adjust the control dial to choose the comfortable pressure you want. The control dial doesn't reset automatically, please turn it off manually.

If there are no immediate leaks, check again in about 5-10 minutes and your HD-4000 is ready for use!

If any leaks occur, check all rubber washers and make sure all connections are tight and secure.

# CLEANING

Your HD-4000 is made with a high grade fire-retardant ABS resin. Using hard cleaning chemicals can weaken the material, causing it to damage and develop cracks.

1. Clean the HD-4000 by wiping the surface area with a damp cloth regularly.
2. Do not use harsh detergents or any cleaning tools with bristles on your bidet.

Steam cleaning is the preferred cleaning method for your bidet. For a deep, chemical free clean, consider the BioMist Bidet Cleaner.

# SHORT TERM NON-USE

If the product will not be used for more than a few days, it is highly recommended that the water supply valve is turned off.

# WARRANTY

Your Bio Bidet is warranted against defects in materials or workmanship for 1 year from the date of original purchase. Defective parts or a defective products returned to Bio Bidet will be repaired with new or comparable rebuilt parts or exchanged for a refurbished Bio Bidet as determined by Bio Bidet in their sole discretion.

This limited warranty given by Bio Bidet covers all defects encountered in normal use of Bio Bidet, and do not apply in the following cases:

1. Loss of or damage to Bio Bidet due to abuse, misuse, tampering, mishandling, improper packaging by you, alteration and failure to follow operating instructions.
2. Use of parts or supplies (other than those by Bio Bidet's dealers) that cause damage to Bio Bidet.
3. Replacement of discolored or stained parts caused by chlorine, bleach, ammonia and other chemicals, cleaning supplies, oxidation, normal wear and tear.
4. Damage to or malfunction of the unit as a result of improper and negligent installation.
5. Any and all damages to plumbing, walls, floors, ceiling and personal properties resulting from water leaks or breakage. The product must be used at the user's own risk. Therefore, the owner hereby releases the manufacturer and distributor from any and all claims for damages where the above condition exists.

No implied warranty, including any implied warranty of merchantability or fitness or a particular purpose, applies to BBC Innovation LLC bidet after the applicable period of the express limited warranty stated above, and no other express warranty or guaranty, except as mentioned above, given by any person or entity with respect to Bio Bidet shall bind Bio Bidet. (Some States and provinces do not allow limitations on how long an implied warranty, so the above limitation may not apply to you). BBC Innovation LLC shall not be liable for revenues or profits, inconvenience, expense for substitute equipment or service, or any other special, incidental or consequential damages caused by the use or misuse of, or inability to use, Bio Bidet, regardless of the possibility and foresee-ability of such damages. In no event shall recovery of any kind against BBC Innovation LLC be greater in amount than the purchase price of the product and causing the alleged damage. Without limiting the foregoing, you assume all risk and liability for loss, damage or injury to you and your property and to others and their property arising out of use or misuse of, or inability to use, the Bio Bidet not caused directly by the negligence or BBC Innovation LLC. This limited warranty shall not extend to anyone other than the original purchaser of the Bio Bidet.



# Thank You



Technical Support/Customer Service  
7900 S Route 31 Crystal Lake, IL 60014  
T: 847.458.2334  
U.S TOLL FREE: 877.339.5214

[support@biobidet.com](mailto:support@biobidet.com)  
[www.biobidet.com](http://www.biobidet.com)